

VICINITY MAP
(NOT TO SCALE)

INTERIM GRADING AND EROSION CONTROL NOTES:

1. INSTALL SEDIMENT CONTROL BARRIERS.
2. CLEAR SITE OF ANY UNNECESSARY TREES AND DEBRIS.
3. STOCKPILE LOAM.
4. BRING SITE TO SUB-GRADE. INSTALL RETAINING WALL.
5. ALL DISTURBED SLOPES ALONG THE PARKING LOT AND WETLAND SHALL BE MULCHED IMMEDIATELY, AS A TEMPORARY MEASURE.
6. CONSTRUCT INTERIM GRADING AND EROSION CONTROL BASINS.
 - A. BASINS SHALL BE A MINIMUM OF 3 FEET IN DEPTH x 60' LONG x 20' WIDE.
 - B. SURROUND OUTLET PIPE WITH 3/4" CRUSHED STONE BY 6-INCHES ON ALL SIDES AND LINE WITH FILTER FABRIC.
 - C. INTERIM GRADING OF SITE SHALL BE DONE TO DIRECT RUNOFF TO THE TEMPORARY BASINS AND TO PROTECT THE RESOURCE AREA.
 - D. RIP-RAP SHALL BE A MINIMUM 50 LB. PER STONE.
7. TEMPORARY STONE (3/4" - 1 1/2") SHALL BE PLACED AT THE ENTRANCE TO THE SITE TO CONTROL SILT INTO THE STREET.
8. ALL DISTURBED AREAS NOT TREATED WITH PERMANENT LOAM AND SEED SHALL BE COVERED WITH MULCH.
9. THE SITE MITIGATION OF EROSION IN THOSE AREAS TO BE LANDSCAPED OR MULCHED SHALL HAVE TEMPORARY MULCH IN PLACE.
10. ONCE CURBING IS INSTALLED, THE PERMANENT MULCH AND LANDSCAPING SHALL BE INSTALLED.
11. SEDIMENT CONTROL SHALL REMAIN IN PLACE UNTIL THE SITE IS STABILIZED.
12. KEEP SITE SWEEPED AND MAINTAINED PER THE STORMWATER MANAGEMENT PLAN.
13. AFTER ALL DRAINAGE STRUCTURES AND SUB-SURFACE UTILITIES HAVE BEEN INSTALLED, REMOVE INTERIM EROSION CONTROL BASINS (STONE, FILTER FABRIC, TEMPORARY PIPING) AND BRING SITE TO SUBGRADE.
14. THE PERMANENT DRAINAGE STRUCTURES (CATCH BASINS, CULTEC INFILTRATION SYSTEM AND CULTEC DETENTION SYSTEM) SHALL BECOME ACTIVE WHEN PAVEMENT IS IN PLACE AND THE SITE HAS BEEN CLEANED/STABILIZED.

LEGEND

(27)X INTERIM SPOT GRADE

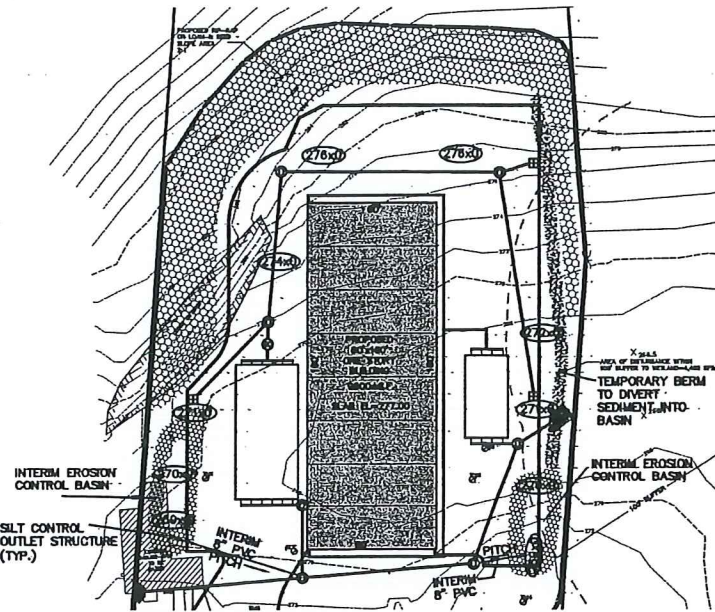

INTERIM GRADING AND EROSION CONTROL PLAN

SCALE: 1 inch = 40 feet.

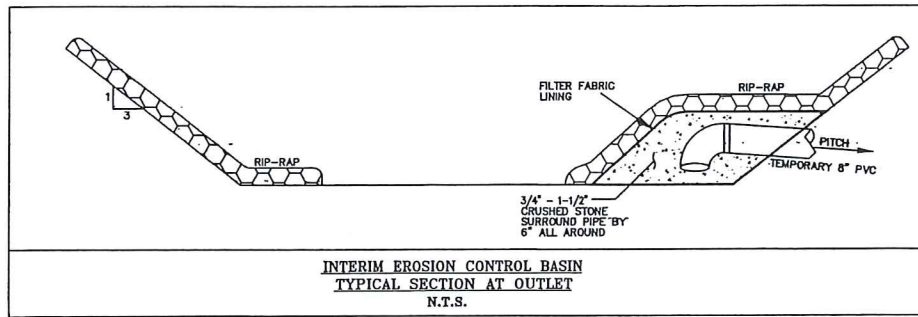

INTERIM EROSION CONTROL BASIN
TYPICAL SECTION AT OUTLET
N.T.S.

LEGEND

- PROPOSED DRAIN LINE
- W — PROPOSED SEWER LINE
- PROPOSED WATER LINE
- ⊞ PROPOSED CATCH BASIN
- ⊞ PROPOSED DRAIN MANHOLE
- ⊞ PROPOSED SEWER MANHOLE
- ⊞ PROPOSED MDC SAND & OIL SEPARATOR
- ⊞ PROPOSED STORAGE MANHOLE
- ⊞ PROPOSED SPOTGRADE
- 272.00x — EXISTING CONTOURS (NGVD OF 1929)
- X — X — PROPOSED CHAIN LINK FENCE
- — — PROPOSED HAYBALE W/ SILT FENCE

CONSTRUCTION ON THIS LAND IS SUBJECT TO ANY EASEMENTS, RIGHTS-OF-WAY, RESTRICTIONS, RESERVATIONS, OR OTHER LIMITATIONS WHICH MAY BE REVEALED BY AN EXAMINATION OF THE TITLE.

THE BUILDING OFFSETS AS SHOWN ON THIS PLAN ARE NOT TO BE USED FOR THE ESTABLISHMENT OF PROPERTY LINES OR FOR THE ESTABLISHMENT OF ANY PROPOSED CONSTRUCTION UNLESS SAID CONSTRUCTION IS SHOWN HEREON.

THIS PLAN WAS PREPARED FOR THE EXCLUSIVE USE AND PURPOSE FOR THE PARTY STATED HEREON AND SHALL NOT BE USED BY ANY THIRD PARTY WITHOUT THE EXPRESSED WRITTEN PERMISSION OF GUERRIERE AND HALNON, INC.

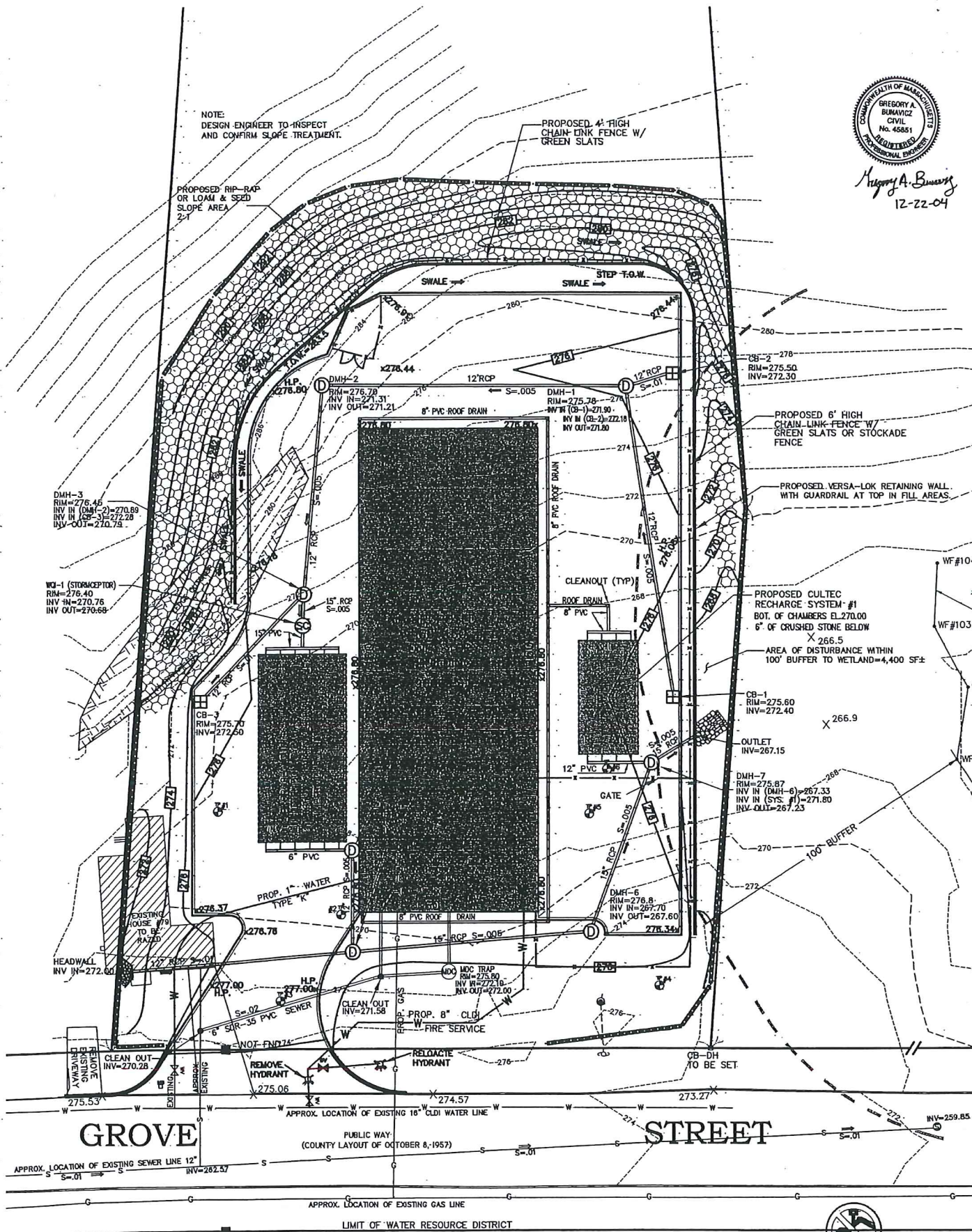

GROVE STREET

STREET

GRAPHIC SCALE

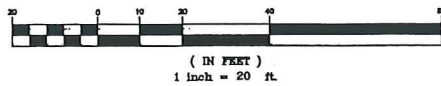

DIG SAFE NOTE:

UTILITIES ARE PLOTTED FROM FIELD LOCATION AND ANY RECORD INFORMATION AVAILABLE, AND SHOULD BE CONSIDERED APPROXIMATE. OTHER UTILITIES MAY EXIST WHICH ARE NOT SHOWN OR FOR WHICH RECORD INFORMATION WAS NOT AVAILABLE. CONTRACTORS (IN ACCORDANCE WITH MASS.G.L. CHAPTER 82 SECTION 40 AS AMENDED) MUST CONTACT ALL UTILITY COMPANIES BEFORE EXCAVATING AND DRILLING. ALSO, CALL "DIG-SAFE" AT (888)344-7233 (1(888)XG-SAFE).



Gregory A. Bowers
12-22-04



PROJECT NORTH

SITE PLAN
APPROVED
FRANKLIN PLANNING BOARD

DATE:

OWNER/APPLICANT:

ROBERT F. & SUSAN M. WEIDMAN
15 GROVE STREET
FRANKLIN, MA 02038

REVISIONS

DATE	REVISED
11/17/04	PER TOWN ENGINEER COMMENTS
11/23/04	PER PLANNING BOARD COMMENTS
12/7/04	PER CONSERVATION COMMISSION COMMENTS

Guerriere & Halnon, Inc.
Engineering & Land Surveying
Ph. (508) 528-3221 38 POND STREET, STE 206
Fx. (508) 528-7921 FRANKLIN, MASS. 02038
www.guerriereandhalnon.com

MULTI-TENANT BUILDING GRADING AND UTILITIES PLAN
OF LAND IN THE TOWN OF FRANKLIN, NORFOLK COUNTY, MASSACHUSETTS

DATE OCTOBER 12, 2004	SCALE AS SHOWN
SHEET 3 of 6	JOB NO. F2915

JOB NO. F2915