



Abbreviated Notice of Resource Area Delineation



Louise Drive Extension

Located in Franklin, MA

Applicant: Paul & Joanne Longobardi

Prepared By: DiPrete Engineering

03/04/2024

Table of Contents

Section 1	ANRAD Application Forms Property Access Signature Form WPA Form 4A ANRAD Wetland Fee Transmittal Form Local Filing Fee Calculation Worksheet Copies of Filing Fee Checks Bordering Vegetated Wetland Field Data Forms
Section 2	Resource Area Description Introduction Soils Existing Upland Land Use and Vegetation Existing Freshwater Wetlands Natural Heritage and Endangered Species Program Vernal Pool Statement Summary
Section 3	Abutter Notification Notification to Abutters Affidavit of Service Certified Abutters List
Section 4	Maps USGS Topographic Map NHESP Map
Section 5	Plans

Section 1

ANRAD Application Forms

Signature of Client Town of Franklin Conservation Commission

PROPERTY ACCESS SIGNATURE FORM

I hereby request that the Franklin Conservation Commission review this NOI/RDA/ANRAD application. I (we) grant authority to the Franklin Conservation Commission members and agents to go onto my (our) property solely for purposes directly related to the inspection and approval of this application and for follow-up compliance with the permit conditions.

Paul A Longolardi
Signature of Property Owner

2/22/24
Date

Jayne Longolardi
Signature of Property Owner

2/22/24
Date



Massachusetts Department of Environmental Protection
 Bureau of Resource Protection - Wetlands
WPA Form 4A – Abbreviated Notice of
Resource Area Delineation
 Massachusetts Wetlands Protection Act M.G.L. c. 131, §40

Provided by MassDEP:

MassDEP File Number

Document Transaction Number

City/Town

A. General Information

1. Project Location (**Note:** electronic filers will click on button for GIS locator):

Louise Drive
 a. Street Address

Franklin
 b. City/Town

02038
 c. Zip Code

Latitude and Longitude:
 42.03877
 d. Latitude

-71.44930
 e. Longitude

339; 349
 f. Assessors Map/Plat Number

9, 13, 14, 15, 16; 2
 g. Parcel /Lot Number

Important: When filling out forms on the computer, use only the tab key to move your cursor - do not use the return key.

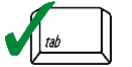

2. Applicant:

Paul & Joanne
 a. First Name

Longobardi
 b. Last Name

c. Organization
 18 James Street

d. Mailing Address
 Franklin

MA
 f. State

02038
 g. Zip Code

617-899-7697
 h. Phone Number

sammie82@comcast.net
 j. Email Address

i. Fax Number

3. Property owner (if different from applicant):

Paul A & Joanne
 a. First Name

Longobardi
 b. Last Name

— Check if more than one owner (attach additional sheet with names and contact information)

c. Organization
 18 James Street

d. Mailing Address
 Franklin

MA
 f. State

02038
 g. Zip Code

617-899-7697
 h. Phone Number

sammie82@comcast.net
 j. Email Address

i. Fax Number

Note: Before completing this form consult your local Conservation Commission regarding any municipal bylaw or ordinance.

4. Representative (if any):

Marianne
 a. Contact Person First Name

Diffin
 b. Contact Person Last Name

DiPrete Engineering
 c. Organization

2 Stafford Court
 d. Mailing Address

Cranston
 e. City/Town

RI
 f. State

02920
 g. Zip Code

401-648-2547
 h. Phone Number

mdiffin@diprete-eng.com
 j. Email Address

i. Fax Number

5. Total WPA Fee Paid (from attached ANRAD Wetland Fee Transmittal Form):

\$2,000.00
 a. Total Fee Paid

\$987.50
 b. State Fee Paid

\$1,012.50
 c. City/Town Fee Paid

Fees will be calculated for online users.



Massachusetts Department of Environmental Protection
 Bureau of Resource Protection - Wetlands
WPA Form 4A – Abbreviated Notice of
Resource Area Delineation
 Massachusetts Wetlands Protection Act M.G.L. c. 131, §40

Provided by MassDEP:

MassDEP File Number

Document Transaction Number

City/Town

B. Area(s) Delineated

1. Bordering Vegetated Wetland (BVW) 791 LF
Linear Feet of Boundary Delineated
2. Check all methods used to delineate the Bordering Vegetated Wetland (BVW) boundary:
 - a. MassDEP BVW Field Data Form (attached)
 - b. Other Methods for Determining the BVW boundary (attach documentation):
 1. 50% or more wetland indicator plants
 2. Saturated/inundated conditions exist
 3. Groundwater indicators
 4. Direct observation
 5. Hydric soil indicators
 6. Credible evidence of conditions prior to disturbance
3. Indicate any other resource area boundaries that are delineated:

<u>Isolated Vegetated Wetland</u>	<u>700</u>
a. Resource Area	b. Linear Feet Delineated
c. Resource Area	d. Linear Feet Delineated

C. Additional Information

Applicants must include the following plans with this Abbreviated Notice of Resource Area Delineation. See instructions for details. **Online Users:** Attach the Document Transaction Number (provided on your receipt page) for any of the following information you submit to the Department.

1. ANRAD (Delineation Plans only)
2. USGS or other map of the area (along with a narrative description, if necessary) containing sufficient information for the Conservation Commission and the Department to locate the site. (Electronic filers may omit this item.)
3. Plans identifying the boundaries of the Bordering Vegetated Wetlands (BVW) (and/or other resource areas, if applicable).
4. List the titles and final revision dates for all plans and other materials submitted with this Abbreviated Notice of Resource Area Delineation.



Massachusetts Department of Environmental Protection
 Bureau of Resource Protection - Wetlands
WPA Form 4A – Abbreviated Notice of
Resource Area Delineation
 Massachusetts Wetlands Protection Act M.G.L. c. 131, §40

Provided by MassDEP:

MassDEP File Number

Document Transaction Number

City/Town

D. Fees

The fees for work proposed under each Abbreviated Notice of Resource Area Delineation must be calculated and submitted to the Conservation Commission and the Department (see Instructions and Wetland Fee Transmittal Form).

- 1. Fee Exempt: No filing fee shall be assessed for projects of any city, town, county, or district of the Commonwealth, federally recognized Indian tribe housing authority, municipal housing authority, or the Massachusetts Bay Transportation Authority.

Applicants must submit the following information (in addition to the attached Wetland Fee Transmittal Form) to confirm fee payment:

1054
2. Municipal Check Number

2/23/2024
3. Check date

1053
4. State Check Number

2/23/2024
5. Check date

Paul
6. Payor name on check: First Name

Longobardi
7. Payor name on check: Last Name



Massachusetts Department of Environmental Protection
Bureau of Resource Protection - Wetlands

WPA Form 4A – Abbreviated Notice of Resource Area Delineation

Massachusetts Wetlands Protection Act M.G.L. c. 131, §40

Provided by MassDEP:

MassDEP File Number

Document Transaction Number

City/Town

E. Signatures

I certify under the penalties of perjury that the foregoing Abbreviated Notice of Resource Area Delineation and accompanying plans, documents, and supporting data are true and complete to the best of my knowledge. I understand that the Conservation Commission will place notification of this Notice in a local newspaper at the expense of the applicant in accordance with the wetlands regulations, 310 CMR 10.05(5)(a).

I further certify under penalties of perjury that all abutters were notified of this application, pursuant to the requirements of M.G.L. c. 131, § 40. Notice must be made in writing by hand delivery or certified mail (return receipt requested) to all abutters within 100 feet of the property line of the project location.

I hereby grant permission, to the Agent or member of the Conservation Commission and the Department of Environmental Protection, to enter and inspect the area subject to this Notice at reasonable hours to evaluate the wetland resource boundaries subject to this Notice, and to require the submittal of any data deemed necessary by the Conservation Commission or Department for that evaluation.

I acknowledge that failure to comply with these certification requirements is grounds for the Conservation Commission or the Department to take enforcement action.

<i>Paul A Longolardi</i>	<i>Paul A Longolardi</i>	<i>2-22-24</i>
1. Signature of Applicant		2. Date
<i>Paul A Longolardi</i>	<i>Paul A Longolardi</i>	<i>2/22/24</i>
3. Signature of Property Owner (if different)		4. Date
<i>M. D. K.</i>		<i>2/22/24</i>
5. Signature of Representative (if any)		6. Date

For Conservation Commission:

Two copies of the completed Abbreviated Notice of Resource Area Delineation (Form 4A), including supporting plans and documents; two copies of the ANRAD Wetland Fee Transmittal Form; and the city/town fee payment must be sent to the Conservation Commission by certified mail or hand delivery.

For MassDEP:

One copy of the completed Abbreviated Notice of Resource Area Delineation (Form 4A), including supporting plans and documents; one copy of the ANRAD Wetland Fee Transmittal Form; and a copy of the state fee payment must be sent to the MassDEP Regional Office (see Instructions) by certified mail or hand delivery. (E-filers may submit these electronically.)

The original and copies must be sent simultaneously. Failure by the applicant to send copies in a timely manner may result in dismissal of the Notice of Intent.



Massachusetts Department of Environmental Protection
 Bureau of Resource Protection - Wetlands
ANRAD Wetland Fee Transmittal Form
 Massachusetts Wetlands Protection Act M.G.L. c. 131, §40

Important:
 When filling out forms on the computer, use only the tab key to move your cursor - do not use the return key.

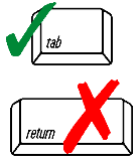

A. Applicant Information

1. Location of Project:

Louise Drive Franklin
 a. Street Address b. City/Town
\$987.50 (State) \$1012.50 (Town) 1053 & 1054
 c. Fee amount d. Check number

2. Applicant:

Paul & Joanne Longobardi
 a. First Name b. Last Name c. Company
18 James Street
 d. Mailing Address
Franklin MA 02038
 e. City/Town f. State g. Zip Code
617-899-7697
 h. Phone Number

3. Property Owner (if different):

Paul A & Joanne Longobardi
 a. First Name b. Last Name c. Company
18 James Street
 d. Mailing Address
Franklin MA 02038
 e. City/Town f. State g. Zip Code
617-899-7697
 h. Phone Number

B. Fees

The fee is calculated as follows for each Resource Area Delineation included in the ANRAD (check applicable project type). The maximum fee for each ANRAD, regardless of the number of Resource Area Delineations, is \$200 activities associated with a single-family house and \$2,000 for any other activity.

Bordering Vegetated Wetland Delineation Fee:

1. <input type="checkbox"/>	single family house project	<u> </u>	x \$2.00 =	<u> </u>	b. Fee for BVW
2. <input checked="" type="checkbox"/>	all other projects	<u>791</u>	<u>\$1,582.00</u>	<u> </u>	<u>\$1,582.00</u>
		a. feet of BVW	x \$2.00 =	<u> </u>	b. Fee for BVW

Other Resource Area (e.g., bank, riverfront area, etc.):

3. <input type="checkbox"/>	single family house project	<u> </u>	x \$2.00 =	<u> </u>	b. Fee
4. <input checked="" type="checkbox"/>	all other projects	<u>700</u>	<u>\$1,400.00</u>	<u> </u>	<u>\$1,400.00</u>
		a. linear feet	x \$2.00 =	<u> </u>	b. Fee
		<u> </u>	<u> </u>	<u> </u>	<u>\$2,000.00 (\$2,982.00 total)</u>

Total Fee for all Resource Areas:

Fee
\$987.50

State share of filing fee:

5. 1/2 of total fee **less** \$12.50

City/Town share of filing fee:

\$1,012.50
 6. 1/2 of total fee **plus** \$12.50

Online users: check box if fee exempt.



Massachusetts Department of Environmental Protection
Bureau of Resource Protection - Wetlands
ANRAD Wetland Fee Transmittal Form
Massachusetts Wetlands Protection Act M.G.L. c. 131, §40

C. Submittal Requirements

- a.) Send a copy of this form, with a check or money order for the state share of the fee, payable to the Commonwealth of Massachusetts, to:

Department of Environmental Protection
Box 4062
Boston, MA 02211

- b.) **To the Conservation Commission:** Send the Abbreviated Notice of Resource Area Delineation; a **copy** of this form; and the city/town fee payment.
- c.) **To DEP Regional Office:** Send one copy of the Abbreviated Notice of Resource Area Delineation (and any additional documentation required as part of a Simplified Review Buffer Zone Project); a **copy** of this form; and a **copy** of the state fee payment. (E-filers of Notices of Intent may submit these electronically.)

Town of Franklin Conservation Commission

LOCAL FILING FEE CALCULATION WORKSHEET

1. NOTICE OF INTENT (NOI)

1.1. New Individual Single Family Home (SFH) \$200.00 _____
This includes all projects associated with a SFH

1.2. Work Associated with Existing Residential Property \$50.00 _____
Above-ground pools, fences or other incidental projects
involving land disturbance that are not covered by the MBZA

1.3. Control of Nuisance Vegetation \$50.00 _____
This category shall not apply to any non-natural
deposition of material e.g. vegetative debris

1.4. Subdivisions

Base Fee \$600.00 _____
Infrastructure in Buffer Zone or Resource Area
Roads _____ linear feet x \$2.00 = _____
*Drainage Structures _____ X \$10.00 each = _____
Wetland Resource Area Disturbed _____ square feet x \$0.50= _____

(If single family homes are proposed as part of a subdivision
application, for each house in jurisdiction, individual NOI fees will apply.)

1.5. Multifamily Dwellings, including Condominium Units:
_____ MFDU x \$100.00 _____

1.6. Commercial/Industrial

Base Fee \$600.00 _____
Infrastructure in Buffer Zone or Resource Area

Roads	___ linear feet x \$2.00	= _____
*Drainage Structures	___ X \$10.00 each	= _____
Wetland Resource Area Disturbed	___ square feet x \$0.50	= _____
Buildings	___ X \$125 each	= _____
All Accessory Improvements	\$100.00	= _____

- 2. REQUEST FOR DETERMINATION (RDA) \$100.00
- 3. MINOR BUFFER ZONE ACTIVITY (MBZA) \$50.00

4. ABBREVIATED NOTICE OF RESOURCE AREA DETERMINATION (ANRAD)

\$0.50/foot/resource area: = \$1,332.50

- 5. OTHER PERMITS/SERVICES
 - Isolated Vegetated Wetland = 700 LF
 - BVW Length = 791 LF
 - 100' Buffer Zone Length = 1174 LF
 - Order of Conditions Extension \$50.00 _____
 - Certificate of Compliance Request \$50.00 _____
 - Certificate Re-Inspection \$50.00 _____
 - Status Letter for Financial Institution \$100.00 _____
 - Permit Amendment \$100.00 _____

6. FILING FEE CALCULATION

Town Share of State Fees (See NOI Wetland Fee Transmittal Form) \$ 1,012.50
 Local Filing Fee Calculated Above \$ 1,332.50
 TOTAL Due Town of Franklin (Check No.1) \$ 2,345.00

State Share of Filing Fee (See NOI Wetland Fee Transmittal Form)
 TOTAL Due DEP (Check No. 2) \$ 987.50

- 7. ADVERTISING FEE (Check No. 3) TBD
 The fee will be the exact amount the newspaper charges for that specific advertisement. Once the advertisement is placed with the paper, by the Conservation Commission, the applicant will be notified of the cost and will be expected to submit a check for that exact amount, payable to the Town of Franklin, to the Conservation Department prior to the first hearing.

*Drainage structures: catch basins, manholes, leaching basins, gutter inlet or any other man-made structure (other than a pipe) for purposes of controlling drainage.

BORDERING VEGETATED WETLAND DETERMINATION FORM

Project/Site: Louise Drive City/Town: Franklin Sampling Date: 10/4/2023
 Applicant/Owner: Paul Longobardi Sampling Point or Zone: A13
 Investigator(s): Tim Twohig Latitude/Longitude: 42.0381422, -71.4495923
 Soil Map Unit Name: 103D - Chariton-Hollis and 104C - Hollis Rock Outcrop NWI or DEP Classification: No wetlands mapped

Are climatic/hydrologic conditions on the site typical for this time of year? Yes No (If no, explain in Remarks)
 Are Vegetation _____, Soil _____, or Hydrology _____ significantly disturbed? (If yes, explain in Remarks)
 Are Vegetation _____, Soil _____, or Hydrology _____ naturally problematic? (If yes, explain in Remarks)

SUMMARY OF FINDINGS – Attach site map and photograph log showing sampling locations, transects, etc.

Wetland vegetation criterion met?	Yes <input checked="" type="checkbox"/> No <input type="checkbox"/>	Is the Sampled Area within a Wetland? Yes <input checked="" type="checkbox"/> No <input type="checkbox"/>
Hydric Soils criterion met?	Yes <input checked="" type="checkbox"/> No <input type="checkbox"/>	
Wetlands hydrology present?	Yes <input checked="" type="checkbox"/> No <input type="checkbox"/>	
Remarks, Photo Details, Flagging, etc.:		
MA-F2W well shows water levels well above 75-90 percentile.		

HYDROLOGY

Field Observations:		
Surface Water Present?	Yes <input checked="" type="checkbox"/> No <input type="checkbox"/>	Depth (inches) <u>1"</u>
Water Table Present?	Yes <input checked="" type="checkbox"/> No <input type="checkbox"/>	Depth (inches) <u>1"</u>
Saturation Present (including capillary fringe)?	Yes <input checked="" type="checkbox"/> No <input type="checkbox"/>	Depth (inches) <u>0"</u>
Wetland Hydrology Indicators		
Reliable Indicators of Wetlands Hydrology <input checked="" type="checkbox"/> Water-stained leaves <input type="checkbox"/> Evidence of aquatic fauna <input type="checkbox"/> Iron deposits <input type="checkbox"/> Algal mats or crusts <input type="checkbox"/> Oxidized rhizospheres/pore linings <input type="checkbox"/> Thin muck surfaces <input type="checkbox"/> Plants with air-filled tissue (aerenchyma) <input type="checkbox"/> Plants with polymorphic leaves <input type="checkbox"/> Plants with floating leaves <input type="checkbox"/> Hydrogen sulfide odor	Indicators that can be Reliable with Proper Interpretation <input type="checkbox"/> Hydrological records <input checked="" type="checkbox"/> Free water in a soil test hole <input checked="" type="checkbox"/> Saturated soil <input type="checkbox"/> Water marks <input type="checkbox"/> Moss trim lines <input type="checkbox"/> Presence of reduced iron <input type="checkbox"/> Woody plants with adventitious roots <input type="checkbox"/> Trees with shallow root systems <input type="checkbox"/> Woody plants with enlarged lenticels	Indicators of the Influence of Water <input checked="" type="checkbox"/> Direct observation of inundation <input checked="" type="checkbox"/> Drainage patterns <input type="checkbox"/> Drift lines <input type="checkbox"/> Scoured areas <input type="checkbox"/> Sediment deposits <input type="checkbox"/> Surface soil cracks <input type="checkbox"/> Sparsely vegetated concave surface <input type="checkbox"/> Microtopographic relief <input type="checkbox"/> Geographic position (depression, toe of slope, fringing lowland)
Remarks (describe recorded data from stream gauge, monitoring well, aerial photos, previous inspections, if available):		

This form is only for BVW delineations. Other wetland resource areas may be present and should be delineated according to the applicable regulatory provisions.

VEGETATION – Use both common and scientific names of plants.

<u>Tree Stratum</u>		Plot size <u>30' radius</u>			
Common name	Scientific name	Indicator Status	Absolute % Cover	Dominant? (yes/no)	Wetland Indicator? (yes/no)
1. Red maple	<i>Acer rubrum</i>	FAC	63	Yes	Yes
2.					
3.					
4.					
5.					
6.					
7.					
8.					
9.					
		63% = Total Cover			
<u>Shrub/Sapling Stratum</u>		Plot size <u>15' radius</u>			
Common name	Scientific name	Indicator Status	Absolute % Cover	Dominant? (yes/no)	Wetland Indicator? (yes/no)
1. High bush blueberry	<i>Vaccinium corymbosum</i>	FACW	20.5	Yes	Yes
2.					
3.					
4.					
5.					
6.					
7.					
8.					
9.					
		20.5 = Total Cover			
<u>Herb Stratum</u>		Plot size <u>5' radius</u>			
Common name	Scientific name	Indicator Status	Absolute % Cover	Dominant? (yes/no)	Wetland Indicator? (yes/no)
1. Cinnamon fern	<i>Osmundastrum cinnamomeum</i>	FACW	38	Yes	Yes
2. New York fern	<i>Parathelypteris noveboracensis</i>	FAC	38	Yes	Yes
3.					
4.					
5.					
6.					
7.					
8.					
9.					
10.					
11.					
12.					
		56% = Total Cover			

VEGETATION – continued.

<u>Woody Vine Stratum</u>		Plot size 30' radius			
Common name	Scientific name	Indicator Status	Absolute % Cover	Dominant? (yes/no)	Wetland Indicator? (yes/no)
1.					
2.					
3.					
4.					
0% _____ = Total Cover					

Rapid Test: Do all dominant species have an indicator status of OBL or FACW?		Yes _____ No <input checked="" type="checkbox"/>	
Dominance Test:	Number of dominant species	Number of dominant species that are wetland indicator plants	Do wetland indicator plants make up ≥ 50% of dominant plant species? Yes <input checked="" type="checkbox"/> No _____
	4	4	
Prevalence Index:		Total % Cover (all strata)	Multiply by:
	OBL species		X 1 =
	FACW species		X 2 =
	FAC species		X 3 =
	FACU species		X 4 =
	UPL species		X 5 =
	Column Totals	(A)	(B)
	Prevalence Index	B/A =	
		Is the Prevalence Index ≤ 3.0? Yes _____ No _____	
Wetland vegetation criterion met?		Yes <input checked="" type="checkbox"/> No _____	

Definitions of Vegetation Strata

- Tree - Woody plants 3 in. (7.62 cm) or more in diameter at breast height (DBH), regardless of height
- Shrub/Sapling - Woody plants less than 3 in. (7.62 cm) DBH and greater than or equal to 3.3 ft. (1 m) tall
- Herb - All herbaceous (non-woody) plants, regardless of size, and woody plants less than 3.3 ft. (1 m) tall
- Woody vines - All woody vines greater than 3.3 ft. (1 m) in height

Cover Ranges	
Range	Midpoint
1-5 %	3.0 %
6-15 %	10.5 %
15-25 %	20.5 %
26-50 %	38.0 %
51-75 %	63.0 %
76-95 %	85.5 %
96-100 %	98.0 %

SOIL

Profile Description: (Describe to the depth needed to document the indicator or confirm the absence of indicators)								
Depth (inches)	Matrix		Redox Features				Texture	Remarks
	Color (moist)	%	Color (moist)	%	Type ¹	Location ²		
0-4	10YR 2/2	100	-	-	-	-	sl	
6-16	2.5Y 5/2	90%	7.5YR 5/6	10	C	M	sl	

¹Type: C=Concentration, D=Depletion, RM=Reduced Matrix, MS=Masked Sand Grains ²Location: PL=Pore Lining, M=Matrix

Hydric Soil Indicators (Check all that apply)		Indicators for Problematic Hydric Soils
<input type="checkbox"/> Histosol (A1)	<input type="checkbox"/> Sandy Redox (S5)	<input type="checkbox"/> 2 cm Muck (A10)
<input type="checkbox"/> Histic Epipedon (A2)	<input type="checkbox"/> Stripped Matrix (S6)	<input type="checkbox"/> 5 cm Mucky Peat or Peat (S3)
<input type="checkbox"/> Black Histic (A3)	<input type="checkbox"/> Polyvalue Below Surface (S8)	<input type="checkbox"/> Dark Surface (S7)
<input type="checkbox"/> Hydrogen Sulfide (A4)	<input type="checkbox"/> Thin Dark Surface (S9)	<input type="checkbox"/> Polyvalue Below Surface (S8)
<input type="checkbox"/> Stratified Layers (A5)	<input type="checkbox"/> Loamy Mucky Mineral (F1)	<input type="checkbox"/> Thin Dark Surface (S9)
<input type="checkbox"/> Depleted Below Dark Surface (A11)	<input type="checkbox"/> Loamy Gleyed Matrix (F2)	<input type="checkbox"/> Iron-Manganese Masses (F12)
<input type="checkbox"/> Thick Dark Surface (A12)	<input checked="" type="checkbox"/> Depleted Matrix (F3)	<input type="checkbox"/> Mesic Spodic (A17)
<input type="checkbox"/> Sandy Mucky Mineral (S1)	<input type="checkbox"/> Redox Dark Surface (F7)	<input type="checkbox"/> Red Parent Material (F21)
<input type="checkbox"/> Sandy Gleyed Matrix (S4)	<input type="checkbox"/> Depleted Dark Surface (F8)	<input type="checkbox"/> Very Shallow Dark Surface (TF12)
<input type="checkbox"/> Dark Surface (S7)		<input type="checkbox"/> Other (Include Explanation in Remarks)

Restrictive Layer (if observed) Type: _____ Depth (inches): _____

Remarks:

Hydric Soils criterion met? Yes No _____

BORDERING VEGETATED WETLAND DETERMINATION FORM

Project/Site: Louise Drive City/Town: Franklin Sampling Date: 10/4/2023
 Applicant/Owner: Paul Longobardi Sampling Point or Zone: B34
 Investigator(s): Tim Twohig Latitude/Longitude: 42.0383262, -71.4489441
 Soil Map Unit Name: 103D - Chariton-Hollis and 104C - Hollis Rock Outcrop NWI or DEP Classification: No wetlands mapped

Are climatic/hydrologic conditions on the site typical for this time of year? Yes No (If no, explain in Remarks)
 Are Vegetation _____, Soil _____, or Hydrology _____ significantly disturbed? (If yes, explain in Remarks)
 Are Vegetation _____, Soil _____, or Hydrology _____ naturally problematic? (If yes, explain in Remarks)

SUMMARY OF FINDINGS – Attach site map and photograph log showing sampling locations, transects, etc.

Wetland vegetation criterion met?	Yes <input checked="" type="checkbox"/> No <input type="checkbox"/>	Is the Sampled Area within a Wetland? Yes <input checked="" type="checkbox"/> No <input type="checkbox"/>
Hydric Soils criterion met?	Yes <input checked="" type="checkbox"/> No <input type="checkbox"/>	
Wetlands hydrology present?	Yes <input checked="" type="checkbox"/> No <input type="checkbox"/>	
Remarks, Photo Details, Flagging, etc.:		
MA-F2W well shows water levels well above 75-90 percentile.		

HYDROLOGY

Field Observations:		
Surface Water Present?	Yes <input checked="" type="checkbox"/> No <input type="checkbox"/>	Depth (inches) <u>1"</u>
Water Table Present?	Yes <input checked="" type="checkbox"/> No <input type="checkbox"/>	Depth (inches) <u>1"</u>
Saturation Present (including capillary fringe)?	Yes <input checked="" type="checkbox"/> No <input type="checkbox"/>	Depth (inches) <u>0"</u>
Wetland Hydrology Indicators		
Reliable Indicators of Wetlands Hydrology <input checked="" type="checkbox"/> Water-stained leaves <input type="checkbox"/> Evidence of aquatic fauna <input type="checkbox"/> Iron deposits <input type="checkbox"/> Algal mats or crusts <input type="checkbox"/> Oxidized rhizospheres/pore linings <input type="checkbox"/> Thin muck surfaces <input type="checkbox"/> Plants with air-filled tissue (aerenchyma) <input type="checkbox"/> Plants with polymorphic leaves <input type="checkbox"/> Plants with floating leaves <input type="checkbox"/> Hydrogen sulfide odor	Indicators that can be Reliable with Proper Interpretation <input type="checkbox"/> Hydrological records <input checked="" type="checkbox"/> Free water in a soil test hole <input checked="" type="checkbox"/> Saturated soil <input type="checkbox"/> Water marks <input type="checkbox"/> Moss trim lines <input type="checkbox"/> Presence of reduced iron <input type="checkbox"/> Woody plants with adventitious roots <input type="checkbox"/> Trees with shallow root systems <input type="checkbox"/> Woody plants with enlarged lenticels	Indicators of the Influence of Water <input checked="" type="checkbox"/> Direct observation of inundation <input checked="" type="checkbox"/> Drainage patterns <input type="checkbox"/> Drift lines <input type="checkbox"/> Scoured areas <input type="checkbox"/> Sediment deposits <input type="checkbox"/> Surface soil cracks <input type="checkbox"/> Sparsely vegetated concave surface <input type="checkbox"/> Microtopographic relief <input type="checkbox"/> Geographic position (depression, toe of slope, fringing lowland)
Remarks (describe recorded data from stream gauge, monitoring well, aerial photos, previous inspections, if available):		

This form is only for BVW delineations. Other wetland resource areas may be present and should be delineated according to the applicable regulatory provisions.

VEGETATION – Use both common and scientific names of plants.

<u>Tree Stratum</u>		Plot size <u>30' radius</u>			
Common name	Scientific name	Indicator Status	Absolute % Cover	Dominant? (yes/no)	Wetland Indicator? (yes/no)
1. Red maple	<i>Acer rubrum</i>	FAC	63	Yes	Yes
2. Red oak	<i>Quercus rubra</i>	FACU	20.5	Yes	No
3.					
4.					
5.					
6.					
7.					
8.					
9.					
			83.5 = Total Cover		
<u>Shrub/Sapling Stratum</u>		Plot size <u>15' radius</u>			
Common name	Scientific name	Indicator Status	Absolute % Cover	Dominant? (yes/no)	Wetland Indicator? (yes/no)
1. Winterberry	<i>Ilex verticillata</i>	FACW	38	Yes	Yes
2. Spicebush	<i>Lindera benzoin</i>	FACW	10.5	No	Yes
3. White pine	<i>Pinus strobus</i>	FACU	10.5	No	No
4. Green ash	<i>Fraxinus pennsylvanica</i>	FACW	3	No	Yes
5.					
6.					
7.					
8.					
9.					
			62% = Total Cover		
<u>Herb Stratum</u>		Plot size <u>5' radius</u>			
Common name	Scientific name	Indicator Status	Absolute % Cover	Dominant? (yes/no)	Wetland Indicator? (yes/no)
1. Sensitive fern	<i>Onoclea sensibilis</i>	FACW	20.5	Yes	Yes
2. Poison ivy	<i>Toxicodendron radicans</i>	FAC	3	No	Yes
3.					
4.					
5.					
6.					
7.					
8.					
9.					
10.					
11.					
12.					
			23.5% = Total Cover		

VEGETATION – continued.

<u>Woody Vine Stratum</u>		Plot size 30' radius			
Common name	Scientific name	Indicator Status	Absolute % Cover	Dominant? (yes/no)	Wetland Indicator? (yes/no)
1.					
2.					
3.					
4.					
0% _____ = Total Cover					

Rapid Test: Do all dominant species have an indicator status of OBL or FACW?		Yes _____ No <input checked="" type="checkbox"/>	
Dominance Test:	Number of dominant species	Number of dominant species that are wetland indicator plants	Do wetland indicator plants make up ≥ 50% of dominant plant species? Yes <input checked="" type="checkbox"/> No _____
	4	3	
Prevalence Index:		Total % Cover (all strata)	Multiply by:
	OBL species		X 1 =
	FACW species		X 2 =
	FAC species		X 3 =
	FACU species		X 4 =
	UPL species		X 5 =
	Column Totals	(A)	(B)
	Prevalence Index	B/A =	
		Is the Prevalence Index ≤ 3.0? Yes _____ No _____	
Wetland vegetation criterion met?		Yes <input checked="" type="checkbox"/> No _____	

Definitions of Vegetation Strata

- Tree - Woody plants 3 in. (7.62 cm) or more in diameter at breast height (DBH), regardless of height
- Shrub/Sapling - Woody plants less than 3 in. (7.62 cm) DBH and greater than or equal to 3.3 ft. (1 m) tall
- Herb - All herbaceous (non-woody) plants, regardless of size, and woody plants less than 3.3 ft. (1 m) tall
- Woody vines - All woody vines greater than 3.3 ft. (1 m) in height

Cover Ranges	
Range	Midpoint
1-5 %	3.0 %
6-15 %	10.5 %
15-25 %	20.5 %
26-50 %	38.0 %
51-75 %	63.0 %
76-95 %	85.5 %
96-100 %	98.0 %

SOIL

Profile Description: (Describe to the depth needed to document the indicator or confirm the absence of indicators)								
Depth (inches)	Matrix		Redox Features				Texture	Remarks
	Color (moist)	%	Color (moist)	%	Type ¹	Location ²		
0-3	10YR 2/1	100	-	-	-	-	Mucky sl	
3-12	2.5Y 4/1	90%	10YR 5/6	10	C	M	sl	

¹Type: C=Concentration, D=Depletion, RM=Reduced Matrix, MS=Masked Sand Grains ²Location: PL=Pore Lining, M=Matrix

Hydric Soil Indicators (Check all that apply)		Indicators for Problematic Hydric Soils
<input type="checkbox"/> Histosol (A1)	<input type="checkbox"/> Sandy Redox (S5)	<input type="checkbox"/> 2 cm Muck (A10)
<input type="checkbox"/> Histic Epipedon (A2)	<input type="checkbox"/> Stripped Matrix (S6)	<input type="checkbox"/> 5 cm Mucky Peat or Peat (S3)
<input type="checkbox"/> Black Histic (A3)	<input type="checkbox"/> Polyvalue Below Surface (S8)	<input type="checkbox"/> Dark Surface (S7)
<input type="checkbox"/> Hydrogen Sulfide (A4)	<input type="checkbox"/> Thin Dark Surface (S9)	<input type="checkbox"/> Polyvalue Below Surface (S8)
<input type="checkbox"/> Stratified Layers (A5)	<input type="checkbox"/> Loamy Mucky Mineral (F1)	<input type="checkbox"/> Thin Dark Surface (S9)
<input type="checkbox"/> Depleted Below Dark Surface (A11)	<input type="checkbox"/> Loamy Gleyed Matrix (F2)	<input type="checkbox"/> Iron-Manganese Masses (F12)
<input type="checkbox"/> Thick Dark Surface (A12)	<input checked="" type="checkbox"/> Depleted Matrix (F3)	<input type="checkbox"/> Mesic Spodic (A17)
<input type="checkbox"/> Sandy Mucky Mineral (S1)	<input type="checkbox"/> Redox Dark Surface (F7)	<input type="checkbox"/> Red Parent Material (F21)
<input type="checkbox"/> Sandy Gleyed Matrix (S4)	<input type="checkbox"/> Depleted Dark Surface (F8)	<input type="checkbox"/> Very Shallow Dark Surface (TF12)
<input type="checkbox"/> Dark Surface (S7)		<input type="checkbox"/> Other (Include Explanation in Remarks)

Restrictive Layer (if observed) Type: _____ Depth (inches): _____

Remarks:

Hydric Soils criterion met? Yes No _____

Resource Area Description

Introduction:

Louise Drive is a partially developed private drive located on AP 339 Lot 0 servicing an existing subdivision. An extension of the existing drive to extend service to five currently undeveloped lots is proposed. The five undeveloped lots total approximately 6.5 acres and are located on AP 339, Lots 9, 13, 14, 15 and 16, and AP 349, Lot 2 in Franklin, Massachusetts. The lots are intended to be developed once access to the lots has been established. A field visit and wetland delineation were performed by DiPrete Engineering on 10/04/2023. The purpose of this narrative is to document existing natural resources present on and surrounding the property.

Soils:

The soils on the property have been mapped by the USDA Soil Conservation Service. They are:

103D and 104C – Charlton-Hollis Rock Outcrop and Hollis Rock Outcrop-Charlton Complex – Charlton soils are well drained soils formed in loamy melt-out till. They are found on nearly level to very steep soils on moraines, hills, and ridges. Hollis soils are well drained and somewhat excessively drained soils formed in a thin mantle of till overlying bedrock on bedrock-controlled hills and ridges. Bedrock outcrops are common within these map units. Saturated hydraulic conductivity is moderately high or high. This complex is suitable for community development but may be limited due to shallow depth to bedrock. Unit 103D has slopes typically ranging from 15 to 25%, and Unit 104C has slopes typically ranging from 0 to 15%.



Area of Soil Map Units from the USDA NRCS Web Soil Survey

301C – Montauk Fine Sandy Loam, Extremely Stony – Montauk soils are well drained soils formed in lodgment or flow till. They are found on upland hills and moraines. Saturated hydraulic conductivity is moderately high or high in the mineral solum and low to moderately high in the substratum. Slopes range from 8 to 15%. These soils are suitable for community development. Agricultural activities can be limited by the presence of surface stones.

Existing Upland Landuse and Vegetation:

Louise Drive is a partially developed private road associated with a partially developed subdivision. The proposed portion of the subdivision, where the road extension will be completed, consists of five vacant wooded lots located approximately 400 feet southeast of Washington Street. Residential homes are found north and east of the lots. The Oak Hill Village Conservation Area is located south of the property. Presently, the upland habitat within the properties consists primarily of deciduous forest. Observed tree species include red oak (*Quercus rubra*), black oak (*Quercus velutina*), mockernut hickory (*Carya tomentosa*), red maple (*Acer rubrum*), and white pine (*Pinus strobus*). Common shrub species include

white pine saplings, mapleleaf viburnum (*Viburnum acerifolium*), highbush blueberry (*Vaccinium corymbosum*), and witchhazel (*Hamamelis virginiana*).

Existing Freshwater Wetlands:

Two freshwater wetlands were identified on the subject property. Wetlands were identified and delineated using methods outlined in the Regional Supplement to the Corps of Engineers Wetland Delineation Manual: Northcentral and Northeast Region Version 2.0 and the Massachusetts Handbook for Delineation of Bordering Vegetated Wetlands, 2022. Each wetland is described in greater detail below.

A Series Wetland –

The A Series wetland is an approximately 0.3-acre isolated deciduous forested swamp located near the southwestern corner of the property and is flagged with pink wetland delineation flags A1 through A23. The wetland originates offsite to the south and extends north into the property before transitioning back to upland habitat. The wetland has a seasonally saturated hydrology that is likely a result of groundwater seepage within a poorly defined drainageway. Groundwater is likely riding atop shallow bedrock or dense till.

Dominant plants within the wetland include red maple, highbush blueberry, cinnamon fern (*Osmundastrum cinnamomeum*), and New York fern (*Thelypteris noveboracensis*). Pockets of standing water were observed within the wetland at the time of investigation. Soil profiles examined within the wetland were consistent with hydric soil indicator F3 (Depleted Matrix).

B Series Wetland –

The B Series wetland is an approximately 0.75-acre bordering vegetated wetland located in the eastern half of the property and is flagged with pink wetland delineation flags B1 through B41. Please note that only 0.3 acres of this wetland are within the subject property. Like the A Series, the wetland appears to be the result of groundwater seepage from the hillside within a poorly defined drainageway. The wetland continues to the north and moves offsite. Offsite wetland edges were not flagged but were collected with a GPS unit and marked as AWE (approximate wetland edge). The wetland is contained within a narrow channel for much of the length from B15 to AWE-B21. This narrow channel likely contains water during major storm events or during the springtime and is best classified as an intermittent stream. At AWE-B21, the topography flattens and more extensive deciduous forested wetland is present to Washington Street. The wetland has a hydrologic connection to another wetland east of Byron's Way. This wetland, through several other wetland complexes and hydrologic connections eventually connects with a large wetland within Franklin State Forest and Miscoe Brook.

Dominant plants within the wetland include red maple and red oak. Winterberry (*Ilex verticillata*) is the dominant shrub species, with spicebush (*Lindera benzoin*) and saplings of white pine and green ash (*Fraxinus pennsylvanica*) also observed within the wetland. Standing water was present within portions of the wetland at the time of the site visit. Soil profiles examined within the wetland were consistent with hydric soil indicator F3 (Depleted Matrix).

Natural Heritage and Endangered Species Program:

Mapping available from MassGIS indicates that the site is not within an NHESP Estimated Habitat of Rare Wildlife or within an NHESP Priority Habitat for Rare Species.

Vernal Pool Statement:

Mapping available from MassGIS does not depict the presence of any potential or certified vernal pools within the subject property. Site investigations carried out at the time of the wetland delineation did not reveal any areas within the subject property that could potentially support obligate vernal pool species.

Summary:

Freshwater wetland resources, including an isolated deciduous forested wetland and a bordering vegetated wetland are located within the subject property. The wetland resources identified are typical of those found within this region of Massachusetts. The subject property is not within estimated rare habitat or priority for rare species. In addition, vernal pool habitat was not identified within the subject property.

Please do not hesitate to contact me with any questions.

DiPrete Engineering Associates, Inc.



Timothy Twohig
Environmental Scientist
ttwohig@DiPrete-eng.com

Abutter Notification

Town of Franklin Conservation Commission

NOTIFICATION TO ABUTTERS

Under the Massachusetts Wetlands Protection Act And The Franklin Wetlands Protection Bylaw

In accordance with the second paragraph of Massachusetts General Laws Chapter 131, Section 40, you are hereby notified of the following proposed project:

Paul & Joanne Longobardi has filed an Abbreviated Notice of Resource Area Delineation with the Franklin Conservation Commission for the extension of Louise Drive on March 21, 2024, under the Wetlands Protection Act (M.G.L c.131 §40).

Copies of the Abbreviated Notice of Resource Area Delineation may be examined during regular office hours from the Applicant's representative: DiPrete Engineering by contacting Marianne Diffin at mdiffin@diprete-eng.com
Copies may also be examined by contacting the Franklin Conservation Department located at 355 East Central Street, Franklin, MA, (508) 520-4929.

Notice of the public hearing including the date, time, and place will be published at least five (5) days in advance in the Milford Daily News.

Notice of the public hearing including the date, time, and place will be posted in the Franklin Town Hall at least forty eight (48) hours in advance of the public hearing.

The public hearing will be held on Thursday, March 21, 2024, at 7:00 pm at the Town Council Chambers, located on the Second Floor of the Municipal Building on 355 East Central Street. The meeting is also available via Zoom, and can be accessed through the Conservation Commission agenda for that night, which will be posted on the Town's website 48 hours prior to the meeting. Please call the Conservation Department at (508) 520-4929 if you have any questions.

You may also contact the Massachusetts Department of Environmental Protection, Central Regional Office, Worcester, MA at (508) 792-7650.

Town of Franklin Conservation Commission

AFFIDAVIT OF SERVICE

Under the Massachusetts Wetlands Protection Act

(To be submitted to the Massachusetts Department of Environmental Protection and the Franklin Conservation Commission when filing a an Abbreviated Notice of Resource Area Delineation)

I, Marianne Diffin hereby certify under the pains and penalties of perjury that on March 4, 2024, I gave Notification to Abutters in compliance with second paragraph of Massachusetts General Laws Chapter 131, Section 40 in connection with the following matter:

An Abbreviated Notice of Resource Area Delineation filed under the Massachusetts Wetlands Protection Act by Longobardi Realty LLC with the Franklin Conservation Commission on March 4, 2024 for property located on Louise Drive, Franklin, MA.

The Notification to Abutters form and list of the abutters to whom it was given and their addresses are attached to the Affidavit of Service.

 March 4, 2024
Signature Date



114-122 LOUISE DR 300' ABUTTERS

Franklin, MA



February 23, 2024

1 inch = 500 Feet

www.cai-tech.com

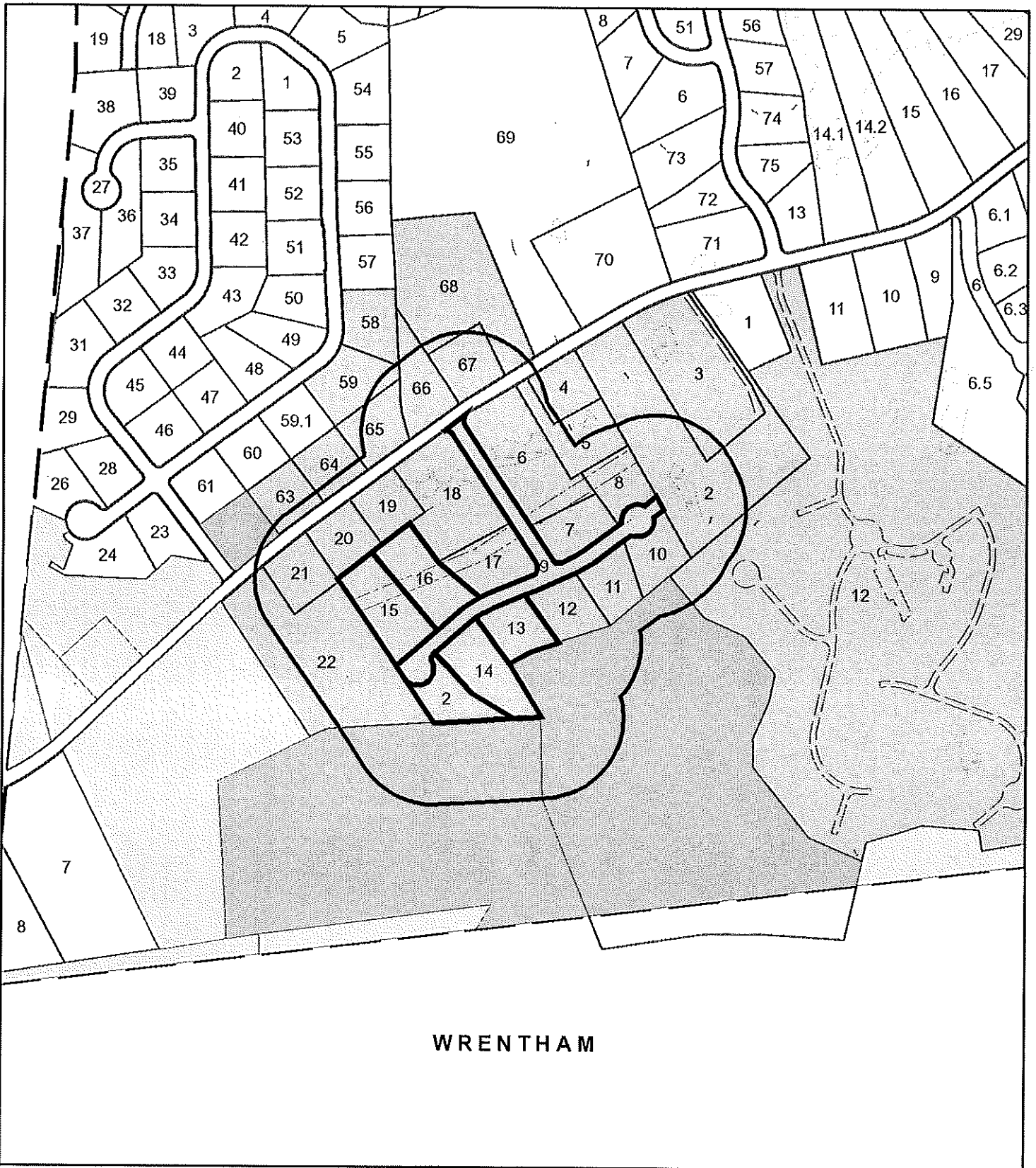

WRENTHAM

This information is believed to be correct but is subject to change and is not warranted.



300 foot Abutters List Report

Franklin, MA
February 23, 2024

Subject Properties:

Parcel Number: 339-009-000 CAMA Number: 339-009-000-000 Property Address: LOUISE DR	Mailing Address: LONGOBARDI PAUL A LONGOBARDI JOANNE 18 JAMES ST FRANKLIN, MA 02038
Parcel Number: 339-013-000 CAMA Number: 339-013-000-000 Property Address: 114 LOUISE DR	Mailing Address: LONGOBARDI PAUL A LONGOBARDI JOANNE 18 JAMES ST FRANKLIN, MA 02038
Parcel Number: 339-014-000 CAMA Number: 339-014-000-000 Property Address: 118 LOUISE DR	Mailing Address: LONGOBARDI PAUL A LONGOBARDI JOANNE 18 JAMES ST FRANKLIN, MA 02038
Parcel Number: 339-015-000 CAMA Number: 339-015-000-000 Property Address: 121 LOUISE DR	Mailing Address: LONGOBARDI PAUL A LONGOBARDI JOANNE 18 JAMES ST FRANKLIN, MA 02038
Parcel Number: 339-016-000 CAMA Number: 339-016-000-000 Property Address: 117 LOUISE DR	Mailing Address: LONGOBARDI PAUL A LONGOBARDI JOANNE 18 JAMES ST FRANKLIN, MA 02038
Parcel Number: 349-002-000 CAMA Number: 349-002-000-000 Property Address: 122 LOUISE DR	Mailing Address: LONGOBARDI PAUL A LONGOBARDI JOANNE 18 JAMES ST FRANKLIN, MA 02038

Abutters:

Parcel Number: 339-002-000 CAMA Number: 339-002-000-000 Property Address: 920 WASHINGTON ST	Mailing Address: MALHOTRA MRINAL DJALEVA- MALHOTRA VALENTINA A 920 WASHINGTON ST FRANKLIN, MA 02038
Parcel Number: 339-003-000 CAMA Number: 339-003-000-000 Property Address: 916 WASHINGTON ST	Mailing Address: SLOAN II STEPHEN FLAHERTY SLOAN STEPHANIE 916 WASHINGTON ST FRANKLIN, MA 02038
Parcel Number: 339-004-000 CAMA Number: 339-004-000-000 Property Address: 924 WASHINGTON ST	Mailing Address: GRILLO MARY JANE 924 WASHINGTON ST FRANKLIN, MA 02038
Parcel Number: 339-005-000 CAMA Number: 339-005-000-000 Property Address: 928 WASHINGTON ST	Mailing Address: LEWIS STEVEN E PELLEGRINI NINA E 928 WASHINGTON ST FRANKLIN, MA 02038

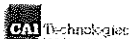

www.cai-tech.com

This information is believed to be correct but is subject to change and is not warranted.

2/23/2024

Page 1 of 14



300 foot Abutters List Report

Franklin, MA
February 23, 2024

Parcel Number: 339-006-000 CAMA Number: 339-006-000-000 Property Address: 4 BYRONS WAY	Mailing Address: ZICKO JOHN M & LINDA M TRS ZICKO LIVING TRUST 4 BYRONS WAY FRANKLIN, MA 02038
Parcel Number: 339-007-000 CAMA Number: 339-007-000-000 Property Address: 6 BYRONS WAY	Mailing Address: HURLEY KATHLEEN&DANIEL TRS KATHLEEN T HURLEY FAMILY TRUST 6 BYRONS WAY FRANKLIN, MA 02038
Parcel Number: 339-008-000 CAMA Number: 339-008-000-000 Property Address: 101 LOUISE DR	Mailing Address: PARIKH VIRAL & VISHRUTA TRS PARIKH FAMILY TRUST 101 LOUISE DR FRANKLIN, MA 02038
Parcel Number: 339-009-000 CAMA Number: 339-009-000-000 Property Address: LOUISE DR	Mailing Address: LONGOBARDI PAUL A LONGOBARDI JOANNE 18 JAMES ST FRANKLIN, MA 02038
Parcel Number: 339-010-000 CAMA Number: 339-010-000-000 Property Address: 102 LOUISE DR	Mailing Address: RICHARDSON PAUL C III RICHARDSON JULIA G 102 LOUISE DRIVE FRANKLIN, MA 02038
Parcel Number: 339-011-000 CAMA Number: 339-011-000-000 Property Address: 105 LOUISE DR	Mailing Address: HOMAN FLORIS HOMAN PEGGY 105 LOUISE DR FRANKLIN, MA 02038
Parcel Number: 339-012-000 CAMA Number: 339-012-000-000 Property Address: 110 LOUISE DR	Mailing Address: GABRIEL HOMES COMPANY INC 10 SHEFFIELD DR BRAintree, MA 02184
Parcel Number: 339-013-000 CAMA Number: 339-013-000-000 Property Address: 114 LOUISE DR	Mailing Address: LONGOBARDI PAUL A LONGOBARDI JOANNE 18 JAMES ST FRANKLIN, MA 02038
Parcel Number: 339-014-000 CAMA Number: 339-014-000-000 Property Address: 118 LOUISE DR	Mailing Address: LONGOBARDI PAUL A LONGOBARDI JOANNE 18 JAMES ST FRANKLIN, MA 02038
Parcel Number: 339-015-000 CAMA Number: 339-015-000-000 Property Address: 121 LOUISE DR	Mailing Address: LONGOBARDI PAUL A LONGOBARDI JOANNE 18 JAMES ST FRANKLIN, MA 02038
Parcel Number: 339-016-000 CAMA Number: 339-016-000-000 Property Address: 117 LOUISE DR	Mailing Address: LONGOBARDI PAUL A LONGOBARDI JOANNE 18 JAMES ST FRANKLIN, MA 02038
Parcel Number: 339-017-000 CAMA Number: 339-017-000-000 Property Address: 5 BYRONS WAY	Mailing Address: DEL SIGNORE GEORGE & ELIZABETH A TRS DEL SIGNORE REALTY TRUST 5 BYRONS WAY FRANKLIN, MA 02038

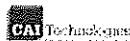

www.cai-tech.com

This information is believed to be correct but is subject to change and is not warranted.



300 foot Abutters List Report

Franklin, MA
February 23, 2024

Parcel Number: 339-018-000 CAMA Number: 339-018-000-000 Property Address: 3 BYRONS WAY	Mailing Address: BALARAMAN SADAGOPAN 3 BYRONS WAY FRANKLIN, MA 02038
Parcel Number: 339-019-000 CAMA Number: 339-019-000-000 Property Address: 944 WASHINGTON ST	Mailing Address: ORTIZ CHRISTOPHER ORTIZ COLLEEN 944 WASHINGTON ST FRANKLIN, MA 02038
Parcel Number: 339-020-000 CAMA Number: 339-020-000-000 Property Address: 950 WASHINGTON ST	Mailing Address: CARROLL FRANCIS C 950 WASHINGTON ST FRANKLIN, MA 02038
Parcel Number: 339-021-000 CAMA Number: 339-021-000-000 Property Address: 956 WASHINGTON ST	Mailing Address: CAMPOS LOUIS M TR LOUIS M CAMPOS REALTY TRUST P O BOX 461 FRANKLIN, MA 02038
Parcel Number: 339-022-000 CAMA Number: 339-022-000-000 Property Address: WASHINGTON ST	Mailing Address: CAMPOS LOUIS M TR LOUIS M CAMPOS REALTY TRUST P O BOX 461 FRANKLIN, MA 02038
Parcel Number: 339-058-000 CAMA Number: 339-058-000-000 Property Address: 36 TOWN LINE RD	Mailing Address: BRESSLER BRITTANY A DODDS JOHN C 36 TOWN LINE RD FRANKLIN, MA 02038
Parcel Number: 339-059-000 CAMA Number: 339-059-000-000 Property Address: 38 TOWN LINE RD	Mailing Address: GONZALEZ SANDOVAL CARLOS E 38 TOWN LINE RD FRANKLIN, MA 02038
Parcel Number: 339-062-000 CAMA Number: 339-062-000-000 Property Address: WASHINGTON ST	Mailing Address: FRANKLIN TOWN OF 355 EAST CENTRAL STREET FRANKLIN, MA 02038
Parcel Number: 339-063-000 CAMA Number: 339-063-000-000 Property Address: 965 WASHINGTON ST	Mailing Address: NEVILLE RICHARD E NEVILLE JENNIFER 965 WASHINGTON ST FRANKLIN, MA 02038
Parcel Number: 339-064-000 CAMA Number: 339-064-000-000 Property Address: 953 WASHINGTON ST	Mailing Address: CASTELLEZ CASEY CASTELLEZ KARI CASSANDRA 953 WASHINGTON ST FRANKLIN, MA 02038
Parcel Number: 339-065-000 CAMA Number: 339-065-000-000 Property Address: 947 WASHINGTON ST	Mailing Address: MCFARLAND PAUL ANDERSON ELAINE 947 WASHINGTON ST FRANKLIN, MA 02038
Parcel Number: 339-066-000 CAMA Number: 339-066-000-000 Property Address: 941 WASHINGTON ST	Mailing Address: KIRBY RONALD JR 941 WASHINGTON ST FRANKLIN, MA 02038

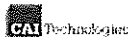

www.cai-tech.com

This information is believed to be correct but is subject to change and is not warranted.

2/23/2024

Page 3 of 14



300 foot Abutters List Report

Franklin, MA
February 23, 2024

Parcel Number: 339-067-000
CAMA Number: 339-067-000-000
Property Address: 925 WASHINGTON ST

Mailing Address: TOPHAM CHARLES F
925 WASHINGTON ST
FRANKLIN, MA 02038

Parcel Number: 339-068-000
CAMA Number: 339-068-000-000
Property Address: 923 WASHINGTON ST

Mailing Address: TOMAINO RICHARD S
923 WASHINGTON ST
FRANKLIN, MA 02038

Parcel Number: 340-012-000
CAMA Number: 340-012-000-000
Property Address: 19-25 INNSBRUCK WAY

Mailing Address: VILLAGES AT OAK HILL CONDO TR C/O
BARKAN MANAGEMENT CO
7 WELLS AVE, SUITE 11
NEWTON, MA 02459

Parcel Number: 340-012-000
CAMA Number: 340-012-000-001
Property Address: 25 INNSBRUCK WAY

Mailing Address: DEFRANZO DEBRA TR DEBRA
DEFRANZO REVOCABLE TRUST
25 INNSBRUCK WAY
FRANKLIN, MA 02038

Parcel Number: 340-012-000
CAMA Number: 340-012-000-002
Property Address: 23 INNSBRUCK WAY

Mailing Address: JOSEPH ROBERT R & JOANNE TR
JOSEPH FAMILY 2023 REVO TR
23 INNSBRUCK WAY
FRANKLIN, MA 02038

Parcel Number: 340-012-000
CAMA Number: 340-012-000-003
Property Address: 21 INNSBRUCK WAY

Mailing Address: BROUWER CLAIRE MARIE
21 INNSBRUCK WAY
FRANKLIN, MA 02038

Parcel Number: 340-012-000
CAMA Number: 340-012-000-004
Property Address: 19 INNSBRUCK WAY

Mailing Address: BOYLAN HERTA
19 INNSBRUCK WAY
FRANKLIN, MA 02038

Parcel Number: 340-012-000
CAMA Number: 340-012-000-005
Property Address: 1 FRANCESCO AVE

Mailing Address: HENDRICK WILLIAM S HENDRICK
ROBERTA E
1 FRANCESCO AV
FRANKLIN, MA 02038

Parcel Number: 340-012-000
CAMA Number: 340-012-000-006
Property Address: 3 FRANCESCO AVE

Mailing Address: MCKINLEY CHRISTOPHER J TR
MCKINLEY IRREVOCABLE TRUST
6186 BLUE BELLE DR
CENTER VALLEY, PA 18034

Parcel Number: 340-012-000
CAMA Number: 340-012-000-007
Property Address: 5 FRANCESCO AVE

Mailing Address: HEALY STEPHEN J TYBURSKI LYNN A
5 FRANCESCO AV
FRANKLIN, MA 02038

Parcel Number: 340-012-000
CAMA Number: 340-012-000-008
Property Address: 7 FRANCESCO AVE

Mailing Address: MESSIER ROBERT F & PATRICIA C TRS
ROBERT & PATRICIA MESSIER TRST
7 FRANCESCO AVE
FRANKLIN, MA 02038

Parcel Number: 340-012-000
CAMA Number: 340-012-000-009
Property Address: 2 FRANCESCO AVE

Mailing Address: HARKINS KERRY F HARKINS DAWN O
2 FRANCESCO AV
FRANKLIN, MA 02038

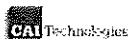

www.cai-tech.com

This information is believed to be correct but is subject to change and is not warranted.

2/23/2024

Page 4 of 14



300 foot Abutters List Report

Franklin, MA
February 23, 2024

Parcel Number: 340-012-000
CAMA Number: 340-012-000-010
Property Address: 4 FRANCESCO AVE

Mailing Address: ASSNER LEONARD J & NANCY J TRS
LEONARD & NANCY ASSNER LIV TR
4 FRANCESCO AV
FRANKLIN, MA 02038

Parcel Number: 340-012-000
CAMA Number: 340-012-000-011
Property Address: 6 FRANCESCO AVE

Mailing Address: PROCTOR BETH A
6 FRANCESCO AV
FRANKLIN, MA 02038

Parcel Number: 340-012-000
CAMA Number: 340-012-000-012
Property Address: 8 FRANCESCO AVE

Mailing Address: MOSS JAMES III & JOANNE TRS JAMES
L MOSS III LIVING TRUST JOANNE A
MOSS LIVING
8 FRANCESCO AV
FRANKLIN, MA 02038

Parcel Number: 340-012-000
CAMA Number: 340-012-000-013
Property Address: 7 TUSCANY DR

Mailing Address: CANISIUS PETER CANISIUS MADELINE
A
7 TUSCANY DR
FRANKLIN, MA 02038

Parcel Number: 340-012-000
CAMA Number: 340-012-000-014
Property Address: 5 TUSCANY DR

Mailing Address: REED STEVEN P & WILLIAM J TRS
REED IRREVOCABLE HOME TRUST
2 APPLEWOOD LN
MENDON, MA 01756

Parcel Number: 340-012-000
CAMA Number: 340-012-000-015
Property Address: 3 TUSCANY DR

Mailing Address: MORREALE RICHARD J MORREALE KIM
E
3 TUSCANY DR
FRANKLIN, MA 02038

Parcel Number: 340-012-000
CAMA Number: 340-012-000-016
Property Address: 1 TUSCANY DR

Mailing Address: PERROTTA ROBERT PERROTTA ANN
1 TUSCANY DRIVE
FRANKLIN, MA 02038

Parcel Number: 340-012-000
CAMA Number: 340-012-000-017
Property Address: 17 TUSCANY DR

Mailing Address: WRIGHT ALICE R & FRANK P TRS
WRIGHT FAMILY REVOCABLE TRUST
17 TUSCANY DR
FRANKLIN, MA 02038

Parcel Number: 340-012-000
CAMA Number: 340-012-000-018
Property Address: 15 TUSCANY DR

Mailing Address: BERGESEN ROY BERGESEN JUDITH
15 TUSCANY DR
FRANKLIN, MA 02038

Parcel Number: 340-012-000
CAMA Number: 340-012-000-019
Property Address: 13 TUSCANY DR

Mailing Address: COUTINHO KIMBERLY
13 TUSCANY DR
FRANKLIN, MA 02038

Parcel Number: 340-012-000
CAMA Number: 340-012-000-020
Property Address: 11 TUSCANY DR

Mailing Address: HURLEY PATRICIA L/E HARRINGTON
DEREK P
11 TUSCANY DRIVE
FRANKLIN, MA 02038

Parcel Number: 340-012-000
CAMA Number: 340-012-000-021
Property Address: 21 CASSANDRA AVE

Mailing Address: CUMMINGS STEPHEN N
21 CASSANDRA AV
FRANKLIN, MA 02038

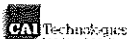

www.cai-tech.com

This information is believed to be correct but is subject to change and is not warranted.



300 foot Abutters List Report

Franklin, MA
February 23, 2024

Parcel Number: 340-012-000 CAMA Number: 340-012-000-022 Property Address: 19 CASSANDRA AVE	Mailing Address: BERMACK DENNIS TR DENNIS I BERMACK REV TR 19 CASSANDRA AVE FRANKLIN, MA 02038
Parcel Number: 340-012-000 CAMA Number: 340-012-000-023 Property Address: 17 CASSANDRA AVE	Mailing Address: RAPOSA ARTHUR J RAPOSA MARY C 17 CASSANDRA AV FRANKLIN, MA 02038
Parcel Number: 340-012-000 CAMA Number: 340-012-000-024 Property Address: 15 CASSANDRA AVE	Mailing Address: BLIMMEL WILLIAM C & ANNAMARIE TRS BLIMMEL REVOCABLE TRUST 15 CASSANDRA AV FRANKLIN, MA 02038
Parcel Number: 340-012-000 CAMA Number: 340-012-000-025 Property Address: 33 CASSANDRA AVE	Mailing Address: SARAPAS ALAN SARAPAS CYNTHIA 33 CASSANDRA AV FRANKLIN, MA 02038
Parcel Number: 340-012-000 CAMA Number: 340-012-000-026 Property Address: 31 CASSANDRA AVE	Mailing Address: SCHROEDER KATHLEEN 31 CASSANDRA AV FRANKLIN, MA 02038
Parcel Number: 340-012-000 CAMA Number: 340-012-000-027 Property Address: 28 CASSANDRA AVE	Mailing Address: REMILLARD JAMES F & JOYCE A TRS JOYCE A REMILLARD LIVING TRUST 28 CASSANDRA AV FRANKLIN, MA 02038
Parcel Number: 340-012-000 CAMA Number: 340-012-000-028 Property Address: 30 CASSANDRA AVE	Mailing Address: LEFEBVRE RENE & LINDA L/E LEFEBVRE FAMILY IRREVOCABLE TR WALSH, WILLIAM T TR 30 CASSANDERA AVE FRANKLIN, MA 02038
Parcel Number: 340-012-000 CAMA Number: 340-012-000-029 Property Address: 32 CASSANDRA AVE	Mailing Address: TING ANASTASIA TR ANASTASIA TING FAMILY TRUST 32 CASSANDRA AV FRANKLIN, MA 02038
Parcel Number: 340-012-000 CAMA Number: 340-012-000-030 Property Address: 34 CASSANDRA AVE	Mailing Address: DASILVA ANTHONY C & JOYCE J TRS JOYCE J DASILVA IRREVOCABLE TRST 34 CASSANDRA AV FRANKLIN, MA 02038
Parcel Number: 340-012-000 CAMA Number: 340-012-000-031 Property Address: 20 CASSANDRA AVE	Mailing Address: DALICANDRO JOSEPH, DONNA TRS DALICANDRO REVOCABLE TRUST 20 CASSANDRA AV FRANKLIN, MA 02038
Parcel Number: 340-012-000 CAMA Number: 340-012-000-032 Property Address: 22 CASSANDRA AVE	Mailing Address: GRANT LINDA J TR 22 CASSANDRA AVE REALTY TRUST 22 CASSANDRA AV FRANKLIN, MA 02038
Parcel Number: 340-012-000 CAMA Number: 340-012-000-033 Property Address: 24 CASSANDRA AVE	Mailing Address: CYR JOHN F CYR DENISE M 24 CASSANDRA AV FRANKLIN, MA 02038

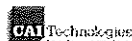

www.cai-tech.com

This information is believed to be correct but is subject to change and is not warranted.

2/23/2024

Page 6 of 14



300 foot Abutters List Report

Franklin, MA
February 23, 2024

Parcel Number: 340-012-000
CAMA Number: 340-012-000-034
Property Address: 26 CASSANDRA AVE

Mailing Address: HATEM MICHAEL HATEM MARY ANN
26 CASSANDRA AV
FRANKLIN, MA 02038

Parcel Number: 340-012-000
CAMA Number: 340-012-000-035
Property Address: 8 CASSANDRA AVE

Mailing Address: STEWART SUSAN
8 CASSANDRA AVE
FRANKLIN, MA 02038

Parcel Number: 340-012-000
CAMA Number: 340-012-000-036
Property Address: 10 CASSANDRA AVE

Mailing Address: BRAY KENNETH A & MARIE T TRS
KENNETH A BRAY LIVING TRUST MARIE
T BRAY LIVING TR
10 CASSANDRA AV
FRANKLIN, MA 02038

Parcel Number: 340-012-000
CAMA Number: 340-012-000-037
Property Address: 12 CASSANDRA AVE

Mailing Address: STEARNS PAULINE M STEARNS
REVOCABLE FAM TRUST
12 CASSANDRA AVE
FRANKLIN, MA 02038

Parcel Number: 340-012-000
CAMA Number: 340-012-000-038
Property Address: 14 CASSANDRA AVE

Mailing Address: FERSTENFELD WILLIAM FERSTENFELD
NANCY
14 CASSANDRA AV
FRANKLIN, MA 02038

Parcel Number: 340-012-000
CAMA Number: 340-012-000-039
Property Address: 2 CASSANDRA AVE

Mailing Address: GILSTEIN ROBERT & BARBARA TR
GILSTEIN LIVING TRUST
2 CASSANDRA AVENUE
FRANKLIN, MA 02038

Parcel Number: 340-012-000
CAMA Number: 340-012-000-040
Property Address: 4 CASSANDRA AVE

Mailing Address: DILL MARVIN H DILL JOAN B
4 CASSANDRA AVENUE
FRANKLIN, MA 02038

Parcel Number: 340-012-000
CAMA Number: 340-012-000-041
Property Address: 37 TUSCANY DR

Mailing Address: KUCICH ANTHONY, JOHN&ROBERT TRS
ANTHONY KUCICH REVOC TRUST
37 TUSCANY DR
FRANKLIN, MA 02038

Parcel Number: 340-012-000
CAMA Number: 340-012-000-042
Property Address: 35 TUSCANY DR

Mailing Address: GRASSO EILEEN
35 TUSCANY DR
FRANKLIN, MA 02038

Parcel Number: 340-012-000
CAMA Number: 340-012-000-043
Property Address: 33 TUSCANY DR

Mailing Address: FERRANTI MICHAEL FERRANTI IRENE P
33 TUSCANY DR
FRANKLIN, MA 02038

Parcel Number: 340-012-000
CAMA Number: 340-012-000-044
Property Address: 7 CLUBHOUSE DR

Mailing Address: PIELECH ROBERT M PIELECH MARILYN
W
7 CLUBHOUSE DR
FRANKLIN, MA 02038

Parcel Number: 340-012-000
CAMA Number: 340-012-000-045
Property Address: 22 TUSCANY DR

Mailing Address: MONTANA STEPHEN & P CHRISTINE
TRS MONTANA FAMILY LIVING TRUST
22 TUSCANY DR
FRANKLIN, MA 02038

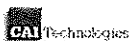

www.cai-tech.com

This information is believed to be correct but is subject to change and is not warranted.

2/23/2024

Page 7 of 14



300 foot Abutters List Report

Franklin, MA
February 23, 2024

Parcel Number: 340-012-000 CAMA Number: 340-012-000-046 Property Address: 26 TUSCANY DR	Mailing Address: IACOVELLI RICHARD A & JANET I TRS RICHARD A IACOVELLI 2021 TRUST JANET G IACOVELLI 2 26 TUSCANY DR FRANKLIN, MA 02038
Parcel Number: 340-012-000 CAMA Number: 340-012-000-047 Property Address: 28 TUSCANY DR	Mailing Address: BOROWIEC PETER J JR BOROWIEC SANDRA A 28 TUSCANY DR FRANKLIN, MA 02038
Parcel Number: 340-012-000 CAMA Number: 340-012-000-048 Property Address: 7 FAITH WAY	Mailing Address: BOIARDI STEVEN C BOIARDI MARY K 7 FAITH WAY FRANKLIN, MA 02038
Parcel Number: 340-012-000 CAMA Number: 340-012-000-049 Property Address: 5 FAITH WAY	Mailing Address: OTOOLE MICHAEL F & JUDITH ANN TRS OTOOLE TRUST 5 FAITH WAY FRANKLIN, MA 02038
Parcel Number: 340-012-000 CAMA Number: 340-012-000-050 Property Address: 3 FAITH WAY	Mailing Address: DACEY JR JAMES P TR THE CAROL ANN DACEY REVOC TR DACEY, CAROL ANN TR 3 FAITH WAY FRANKLIN, MA 02038
Parcel Number: 340-012-000 CAMA Number: 340-012-000-051 Property Address: 1 FAITH WAY	Mailing Address: WHITE MARK J WHITE CATHERINE J 1 FAITH WAY FRANKLIN, MA 02038
Parcel Number: 340-012-000 CAMA Number: 340-012-000-052 Property Address: 67 TUSCANY DR	Mailing Address: MCCRACKEN ERNESTINE E 67 TUSCANY DR FRANKLIN, MA 02038
Parcel Number: 340-012-000 CAMA Number: 340-012-000-053 Property Address: 65 TUSCANY DR	Mailing Address: KULIG JOHN W TR THE JOHN W KULIG REVOC TRUST 65 TUSCANY DR FRANKLIN, MA 02038
Parcel Number: 340-012-000 CAMA Number: 340-012-000-054 Property Address: 6 FAITH WAY	Mailing Address: CONNOR JAMES G TR JAMES G CONNOR REVOC TRUST 75 JOHN REED RD WESTPORT, MA 02790
Parcel Number: 340-012-000 CAMA Number: 340-012-000-055 Property Address: 8 FAITH WAY	Mailing Address: GRILLO JENNIFER D 8 FAITH WAY FRANKLIN, MA 01581
Parcel Number: 340-012-000 CAMA Number: 340-012-000-056 Property Address: 58 TUSCANY DR	Mailing Address: JANTZEN DEANNA PINNEY 58 TUSCANY DR FRANKLIN, MA 02038

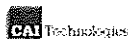

www.cai-tech.com

This information is believed to be correct but is subject to change and is not warranted.



300 foot Abutters List Report

Franklin, MA
February 23, 2024

Parcel Number: 340-012-000 CAMA Number: 340-012-000-057 Property Address: 60 TUSCANY DR	Mailing Address: REILLY GERTRUDE RUTH TR REILLY 2018 FAMILY REVOC TRUST REILLY, KENNETH J T 60 TUSCANY DRIVE FRANKLIN, MA 02038
Parcel Number: 340-012-000 CAMA Number: 340-012-000-058 Property Address: 62 TUSCANY DR	Mailing Address: KELLY DONALD J KELLY LISA M 62 TUSCANY DR FRANKLIN, MA 02038
Parcel Number: 340-012-000 CAMA Number: 340-012-000-059 Property Address: 66 TUSCANY DR	Mailing Address: MALMBERG JUDITH TR JUDITH A MALMBERG REVOCABLE TR 66 TUSCANY DR FRANKLIN, MA 02038
Parcel Number: 340-012-000 CAMA Number: 340-012-000-060 Property Address: 32 TUSCANY DR	Mailing Address: WALSH RICHARD WALSH REGINA C 32 TUSCANY DR FRANKLIN, MA 02038
Parcel Number: 340-012-000 CAMA Number: 340-012-000-061 Property Address: 34 TUSCANY DR	Mailing Address: ALESSI GINA 34 TUSCANY DR FRANKLIN, MA 02038
Parcel Number: 340-012-000 CAMA Number: 340-012-000-062 Property Address: 68 TUSCANY DR	Mailing Address: HODGSON DEBORAH L & GARY D TRS HODGSON FAMILY TRUST GARY D & DEBORAH L 68 TUSCANY DR FRANKLIN, MA 02038
Parcel Number: 340-012-000 CAMA Number: 340-012-000-063 Property Address: 4 TUSCANY DR	Mailing Address: PATEL ASHIK 4 TUSCANY DR FRANKLIN, MA 02038
Parcel Number: 340-012-000 CAMA Number: 340-012-000-064 Property Address: 6 TUSCANY DR	Mailing Address: DEMELLE NANCY J 6 TUSCANY DR FRANKLIN, MA 02038
Parcel Number: 340-012-000 CAMA Number: 340-012-000-065 Property Address: 8 TUSCANY DR	Mailing Address: PATRICK SUZANNE M 8 TUSCANY DR FRANKLIN, MA 02038
Parcel Number: 340-012-000 CAMA Number: 340-012-000-066 Property Address: 10 TUSCANY DR	Mailing Address: ZABOROWSKI TERESE M TR NANCY M BOUCHER IRREVOC TRUST GIBBONS, CHERYL A TR 10 TUSCANY DR FRANKLIN, MA 02038
Parcel Number: 340-012-000 CAMA Number: 340-012-000-067 Property Address: 10 VANDO WAY	Mailing Address: DINATALE LEANNE & CHRISTINE TRS M&M TRUST 10 VANDO WAY FRANKLIN, MA 02038

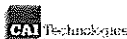

www.cai-tech.com

This information is believed to be correct but is subject to change and is not warranted.



300 foot Abutters List Report

Franklin, MA
February 23, 2024

Parcel Number: 340-012-000 CAMA Number: 340-012-000-068 Property Address: 12 VANDO WAY	Mailing Address: OPPENHEIM SAMUEL A OPPENHEIM ALYNE F 12 VANDO WAY FRANKLIN, MA 02038
Parcel Number: 340-012-000 CAMA Number: 340-012-000-069 Property Address: 14 VANDO WAY	Mailing Address: SCAMPOLI LOUIS SCAMPOLI DIANE 14 VANDO WAY FRANKLIN, MA 02038
Parcel Number: 340-012-000 CAMA Number: 340-012-000-070 Property Address: 16 VANDO WAY	Mailing Address: O'DONNELL JOHN F & PATRICIA A TRS O'DONNELL FAMILY REALTY TRUST 16 VANDO WAY FRANKLIN, MA 02038
Parcel Number: 340-012-000 CAMA Number: 340-012-000-071 Property Address: 17 DANTE AVE	Mailing Address: SMIT ROBERT SMIT SYLVIA A 17 DANTE AV FRANKLIN, MA 02038
Parcel Number: 340-012-000 CAMA Number: 340-012-000-072 Property Address: 15 DANTE AVE	Mailing Address: BEHESHTI SAM GILANSHAH FATANEH 15 DANTE AV FRANKLIN, MA 02038
Parcel Number: 340-012-000 CAMA Number: 340-012-000-073 Property Address: 13 DANTE AVE	Mailing Address: DUTHE RICHARD G BAKER ANNA M 13 DANTE AV FRANKLIN, MA 02038
Parcel Number: 340-012-000 CAMA Number: 340-012-000-074 Property Address: 21 VAIL DR	Mailing Address: SOLOMON JOANNE S 21 VAIL DR FRANKLIN, MA 02038
Parcel Number: 340-012-000 CAMA Number: 340-012-000-075 Property Address: 19 VAIL DR	Mailing Address: FONTAINE ROBERT FONTAINE DENISE 19 VAIL DR FRANKLIN, MA 02038
Parcel Number: 340-012-000 CAMA Number: 340-012-000-076 Property Address: 17 VAIL DR	Mailing Address: GAFFNEY REBECCA G 17 VAIL DR FRANKLIN, MA 02038
Parcel Number: 340-012-000 CAMA Number: 340-012-000-077 Property Address: 15 VAIL DR	Mailing Address: RADLER GREGORY L & SANDRA M TRS RADLER REVOCABLE TRUST 15 VAIL DR FRANKLIN, MA 02038
Parcel Number: 340-012-000 CAMA Number: 340-012-000-078 Property Address: 55 VAIL DR	Mailing Address: CAGGIANO ANTHONY G TR CAGGIANO LIVING TRUST 55 VAIL DR FRANKLIN, MA 02038
Parcel Number: 340-012-000 CAMA Number: 340-012-000-079 Property Address: 53 VAIL DR	Mailing Address: HOLT ELAINE & EUGENE L TRS ELAINE HOLT 2010 TRUST 53 VAIL DR FRANKLIN, MA 02038

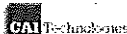

www.cai-tech.com

This information is believed to be correct but is subject to change and is not warranted.

2/23/2024

Page 10 of 14



300 foot Abutters List Report

Franklin, MA
February 23, 2024

Parcel Number: 340-012-000 CAMA Number: 340-012-000-080 Property Address: 51 VAIL DR	Mailing Address: KERAS CAROL A & ROBERT F TRS CAROL A KERAS REVOCABLE TRUST 51 VAIL DR FRANKLIN, MA 02038
Parcel Number: 340-012-000 CAMA Number: 340-012-000-081 Property Address: 49 VAIL DR	Mailing Address: MACKIE DENNIS M MACKIE JUDITH T 49 VAIL DR FRANKLIN, MA 02038
Parcel Number: 340-012-000 CAMA Number: 340-012-000-082 Property Address: 73 VAIL DR	Mailing Address: ROGALIN STEPHANIE SILBERT ROCHELLE 73 VAIL DR FRANKLIN, MA 02038
Parcel Number: 340-012-000 CAMA Number: 340-012-000-083 Property Address: 71 VAIL DR	Mailing Address: BRODEUR GLENN WHITEHOUSE- BRODEUR NANCY 71 VAIL DR FRANKLIN, MA 02038
Parcel Number: 340-012-000 CAMA Number: 340-012-000-084 Property Address: 69 VAIL DR	Mailing Address: WILGA PETER J & NANCY L TRS NANCY WILGA 2011 IRREVOC TRUST PETER WILGA 2011 IR 69 VAIL DR FRANKLIN, MA 02038
Parcel Number: 340-012-000 CAMA Number: 340-012-000-085 Property Address: 62 VAIL DR	Mailing Address: ANDERSON ROBERT D ANDERSON LAURA A 62 VAIL DR FRANKLIN, MA 02038
Parcel Number: 340-012-000 CAMA Number: 340-012-000-086 Property Address: 64 VAIL DR	Mailing Address: TROTIN GAIL V & DOMINIQUE R CURLEY IRREVOCABLE TRUST TROTIN,GAIL&MITCHELL, CYN 64 VAIL DR FRANKLIN, MA 02038
Parcel Number: 340-012-000 CAMA Number: 340-012-000-087 Property Address: 66 VAIL DR	Mailing Address: MULLEN JOSEPH L SHERIDAN-MULLEN NANCY 66 VAIL DR FRANKLIN, MA 02038
Parcel Number: 340-012-000 CAMA Number: 340-012-000-088 Property Address: 68 VAIL DR	Mailing Address: POWERS CARLYN M TR HALEY IRREVOCABLE TRUST 101 RODNEY LECOURS DRIVE NORTH ATTLEBORO, MA 02760
Parcel Number: 340-012-000 CAMA Number: 340-012-000-089 Property Address: 52 VAIL DR	Mailing Address: GRIFFIN ROBERT C GRIFFIN BETH M 52 VAIL DR FRANKLIN, MA 02038
Parcel Number: 340-012-000 CAMA Number: 340-012-000-090 Property Address: 54 VAIL DR	Mailing Address: FISK CHESTER W & ELIZABETH P TR FISK TRUST 54 VAIL DR FRANKLIN, MA 02038
Parcel Number: 340-012-000 CAMA Number: 340-012-000-091 Property Address: 56 VAIL DR	Mailing Address: YOUNG GEORGE L JR & PAMELA J TR YOUNG FAMILY TRUST 56 VAIL DR FRANKLIN, MA 02038



www.cai-tech.com

This information is believed to be correct but is subject to change and is not warranted.

2/23/2024

Page 11 of 14



300 foot Abutters List Report

Franklin, MA
February 23, 2024

Parcel Number: 340-012-000 CAMA Number: 340-012-000-092 Property Address: 58 VAIL DR	Mailing Address: OCONNOR JOHN M & KATHLEEN F TRS OCONNOR FAMILY TRUST 58 VAIL DR FRANKLIN, MA 02038
Parcel Number: 340-012-000 CAMA Number: 340-012-000-093 Property Address: 7 HAILEY AVE	Mailing Address: FRANK JEFFREY A & ELLEN L TRS ELLEN LINER FRANK FAMILY TRUST 7 HAILEY AV FRANKLIN, MA 02038
Parcel Number: 340-012-000 CAMA Number: 340-012-000-094 Property Address: 5 HAILEY AVE	Mailing Address: POIRIER JOHN M TR THE POIRIER FAMILY REALTY TRST SANDBERG, CAROL A T 135 BRALEY JENKINS ROAD CENTERVILLE, MA 02632-2128
Parcel Number: 340-012-000 CAMA Number: 340-012-000-095 Property Address: 3 HAILEY AVE	Mailing Address: GATTI CAROLE A TR GATTI FAMILY LIVING TRUST 3 HAILEY AV FRANKLIN, MA 02038
Parcel Number: 340-012-000 CAMA Number: 340-012-000-096 Property Address: 8 HAILEY AVE	Mailing Address: BOND ROBERT & DOROTHY TRS ROBERT BOND 2013 IRREVOC TRUST DOROTHY BOND 2013 I 8 HAILEY AV FRANKLIN, MA 02038
Parcel Number: 340-012-000 CAMA Number: 340-012-000-097 Property Address: 10 HAILEY AVE	Mailing Address: MCGUIRE EDWARD J MCGUIRE KARAEN L 10 HAILEY AV FRANKLIN, MA 02038
Parcel Number: 340-012-000 CAMA Number: 340-012-000-098 Property Address: 12 HAILEY AVE	Mailing Address: HUEMPFNER LINDA POOLE TR LINDA POOLE HUEMPFNER LIV TR 12 HAILEY AV FRANKLIN, MA 02038
Parcel Number: 340-012-000 CAMA Number: 340-012-000-099 Property Address: 68 DANTE AVE	Mailing Address: MUCCIARONE JANET A 68 DANTE AV FRANKLIN, MA 02038
Parcel Number: 340-012-000 CAMA Number: 340-012-000-100 Property Address: 70 DANTE AVE	Mailing Address: KAYAJANIAN HARRY KAYAJANIAN CHARLOTTE 70 DANTE AV FRANKLIN, MA 02038
Parcel Number: 340-012-000 CAMA Number: 340-012-000-101 Property Address: 72 DANTE AVE	Mailing Address: GILBERT SUSANNE LEE 72 DANTE AV FRANKLIN, MA 02038
Parcel Number: 340-012-000 CAMA Number: 340-012-000-102 Property Address: 24 DANTE AVE	Mailing Address: ROUSLIN MARCIA L TR 24 DANTE AVENUE REALTY TRUST 24 DANTE AVE FRANKLIN, MA 02038
Parcel Number: 340-012-000 CAMA Number: 340-012-000-103 Property Address: 26 DANTE AVE	Mailing Address: BRENNAN JOANNE 26 DANTE AV FRANKLIN, MA 02038

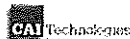

www.cai-tech.com

This information is believed to be correct but is subject to change and is not warranted.



300 foot Abutters List Report

Franklin, MA
February 23, 2024

Parcel Number: 340-012-000 CAMA Number: 340-012-000-104 Property Address: 28 DANTE AVE	Mailing Address: HOLMES KEVIN G & EUGENE L III TR TWENTY EIGHT REALTY TRUST 28 DANTE AV FRANKLIN, MA 02038
Parcel Number: 340-012-000 CAMA Number: 340-012-000-105 Property Address: 30 DANTE AVE	Mailing Address: MOLGARD MELVYN A & JANICE MELVYN & JANICE MOLGARD LIV TR 30 DANTE AV FRANKLIN, MA 02038
Parcel Number: 340-012-000 CAMA Number: 340-012-000-106 Property Address: 14 DANTE AVE	Mailing Address: RAPKO STEPHEN A RAPKO JEANNINE H 14 DANTE AV FRANKLIN, MA 02038
Parcel Number: 340-012-000 CAMA Number: 340-012-000-107 Property Address: 16 DANTE AVE	Mailing Address: ETESSAMI, FARHAD TR RAMYAR, ROYA TR ETESSAMI & RAMYAR REVOC TRUST 16 DANTE AVE FRANKLIN, MA 02038
Parcel Number: 340-012-000 CAMA Number: 340-012-000-108 Property Address: 18 DANTE AVE	Mailing Address: KEANE KATHLEEN M 18 DANTE AV FRANKLIN, MA 02038
Parcel Number: 340-012-000 CAMA Number: 340-012-000-109 Property Address: 20 DANTE AVE	Mailing Address: DOYLE JOHN E TR JOHN E DOYLE 2017 REVOC TRUST 20 DANTE AVE FRANKLIN, MA 02038
Parcel Number: 340-012-000 CAMA Number: 340-012-000-110 Property Address: 6 DANTE AVE	Mailing Address: NATAN MARGARET L/E MARGARET NATAN REVOCABLE TRUST NATAN, MARGARET & S 6 DANTE AV FRANKLIN, MA 02038
Parcel Number: 340-012-000 CAMA Number: 340-012-000-111 Property Address: 8 DANTE AVE	Mailing Address: OSBORNE JOANN 8 DANTE AVE FRANKLIN, MA 02038
Parcel Number: 340-012-000 CAMA Number: 340-012-000-112 Property Address: 10 DANTE AVE	Mailing Address: ROMANO ROSEMARY ROMANO KEITH 12315 TRANQUILITY PARK TERRACE BRADENTON, FL 34211
Parcel Number: 340-012-000 CAMA Number: 340-012-000-113 Property Address: 26 INNSBRUCK WAY	Mailing Address: GOUNARIS JOHN GOUNARIS JACQUELINE 26 INNSBRUCK WAY FRANKLIN, MA 02038
Parcel Number: 340-012-000 CAMA Number: 340-012-000-114 Property Address: 28 INNSBRUCK WAY	Mailing Address: MIGDAL MICHAEL MIGDAL DONNA 28 INNSBRUCK WAY FRANKLIN, MA 02038
Parcel Number: 349-001-000 CAMA Number: 349-001-000-000 Property Address: INNSBRUCK WAY	Mailing Address: FRANKLIN TOWN OF 355 EAST CENTRAL STREET FRANKLIN, MA 02038

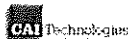

www.cai-tech.com

This information is believed to be correct but is subject to change and is not warranted.

2/23/2024

Page 13 of 14



300 foot Abutters List Report

Franklin, MA
February 23, 2024

Parcel Number: 349-002-000
CAMA Number: 349-002-000-000
Property Address: 122 LOUISE DR

Mailing Address: LONGOBARDI PAUL A LONGOBARDI
JOANNE
18 JAMES ST
FRANKLIN, MA 02038

Parcel Number: 349-003-000
CAMA Number: 349-003-000-000
Property Address: WASHINGTON ST

Mailing Address: FRANKLIN TOWN OF
355 EAST CENTRAL STREET
FRANKLIN, MA 02038

Kevin W. Doyle, 2-23-24

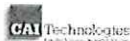

www.cai-tech.com

This information is believed to be correct but is subject to change and is not warranted.

2/23/2024

Page 14 of 14

Section 4

Maps

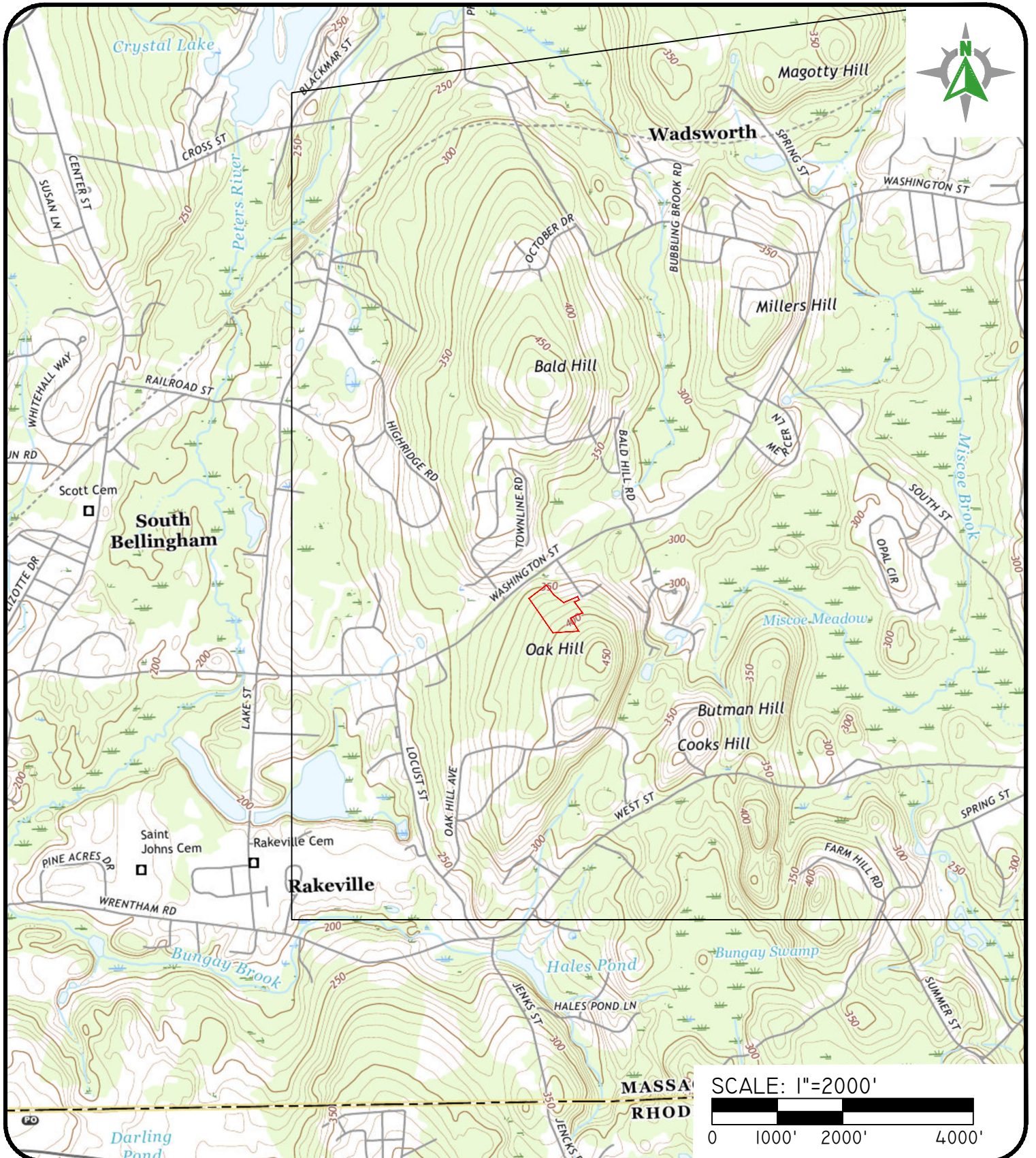

USGS TOPOGRAPHIC MAP
LOUISE DRIVE
 FRANKLIN, MASSACHUSETTS
 PREPARED FOR:
PAUL LONGOBARDI
 18 JAMES STREET
 FRANKLIN, MASSACHUSETTS 02038
 DATE:
 11-01-2023

 **DiPrete Engineering**

Two Stafford Court Cranston, RI 02920
 tel 401-943-1000 fax 401-464-6006 www.diprete-eng.com

Boston • Providence • Newport



NHESP and Vernal Pool Map

Franklin, MA



February 28, 2024

1 inch = 500 Feet



www.cai-tech.com



 Potential Vernal Pools

This information is believed to be correct but is subject to change and is not warranted.

Section 5

Plans
(Bound Separately)