



Guerriere & Halnon, Inc.

ENGINEERING & LAND SURVEYING

www.gandhengineering.com

Est. 1972

Whitinsville Office
1029 Providence Road
Whitinsville, MA 01588-2121
Phone: (508) 234-6834
Fax: (508) 234-6723

Milford Office
333 West Street
P.O. Box 235
Milford, MA 01757-0235
Phone: (508) 473-6630
Fax: (508) 473-8243

Franklin Office
55 West Central Street
Franklin, MA 02038-3807
Phone (508) 528-3221
Fax (508) 528-7921

F-4598

April 5, 2024

Town of Franklin Conservation Commission
Attn: Breeka Li Goodlander
355 East Central Street
Franklin, Massachusetts 02038

Re: Notice of Intent – Veterans Memorial Drive Extension and Definitive Subdivision

Dear Commission Members:

As the applicant's representative, Guerriere & Halnon, Inc. (G & H) hereby submits the Notice of Intent for Veterans Memorial Drive Extension and Definitive Subdivision. We have provided the following documentation for your review and approval.

As part of the submittal G & H has included the following:

- (2) Notice of Intent Packets
 - Application Process Signature Form
 - Property Access Signature Form
 - Local Filing Fee Calculation Worksheet
 - Resource Area Impact Summary Form
 - Notification to Abutters
 - Affidavit of Service
 - MassDEP WPA Form 3 and Fee Transmittal Form
 - Project Narrative
 - Wetland Replication Plan
- (2) 24x36 Plan Sets
- (7) 11x17 Plan Sets
- (2) Stormwater Reports
- Filing Fee: Exempt

We trust this meets with your requirements. Please contact us at our Franklin office at (508) 528-3221 if you have any questions or require additional information.

Sincerely,
Guerriere & Halnon, Inc.

Amanda Cavaliere
Franklin Office Manager

Enclosures



**Guerriere &
Halnon, Inc.**
ENGINEERING & LAND SURVEYING

www.gandhengineering.com

Milford Office
333 West Street, P. O. Box 235
Milford, MA 01757-0235
(508) 473-6630/Fax (508) 473-8243

Franklin Office
55 West Central Street
Franklin, MA 02038-2101
(508) 528-3221/Fax (508) 528-7921

Whitinsville Office
1029 Providence Road
Whitinsville, MA 01588-2121
(508) 234-6834/Fax (508) 234-6723

**Notice of Intent
For
Veterans Memorial Drive Extension
& Definitive Subdivision**

Date: April 1, 2024

Owner:

*Franklin Municipal Affordable Housing Trust
355 East Central Street
Franklin, MA 02038*

Applicant:

*Town of Franklin
355 East Central Street
Franklin, MA 02038*

Prepared by:

*Guerriere & Halnon, Inc.
Engineering and Land Surveying
55 West Central Street
Franklin, Massachusetts 02038*

Project Narrative
Veterans Memorial Drive Extension and Definitive Subdivision
Franklin, Massachusetts

Project Description

The Applicant is proposing to construct a Town owned road extension to Veterans Memorial Drive, approximately 1,110' in length, starting from Eaton Place and extending northwest across the project parcel to connect to the existing stub of Irondequoit Road. The connection to Irondequoit Road is to be gated and for emergency use only. The new road is proposed to service the 40B "Franklin Ridge Senior Housing" residential development and two additional lots. Drainage infrastructure associated with the new development will also be constructed.

The land to be subdivided and developed encompasses an area of 736,120 +/- sf. (16.90 +/-Ac.). The property is bordered by a residential neighborhood to the north, Franklin High School to the east, Eaton Place to the southeast, condominiums/apartments to the south, and a solar farm associated with Tri-County High School to the west. The site is located within the Rural Residential II zoning district and has primary site access from Veterans Memorial Drive, and secondary access is possible from Irondequoit Road. Portions of the site contain bordering vegetated wetlands and their associated jurisdictional buffers, and the site is not located within the Franklin water resource district. The site is presently undeveloped. A 40B Development, "Franklin Ridge Senior Housing", is in the permitting phase for construction on Lot 1A by the developer JNJuhl and Assoc., LLC. Due to the interconnected nature of these two projects, the site and drainage design for Franklin Ridge is included within this project's stormwater report and site plans so that the full buildout of the site is more easily understood.

The connection to Irondequoit Road will include filling approximately 980 sf +/- of an isolated vegetated wetland (IVW) area, which was delineated in August 2023 by Goddard Consulting, LLC and an Order of Resource Area Delineation (ORAD) was issued September 8, 2023 (MassDEP File No. 159-1273). A copy of the ORAD is included for your reference. A Wetland Replication Plan dated January 31, 2024 prepared by Goddard Consulting; LLC is also included as part of the submittal.

Mitigation Measures

Erosion control will be installed and maintained throughout construction activities as depicted on the attached plans.

Town of Franklin Conservation Commission

APPLICATION PROCESS SIGNATURE FORM

There are three different applications that can be submitted to undertake work in a jurisdictional area: a Notice of Intent (NOI), a Request for Determination (RDA) and a Minor Buffer Zone Activity (MBZA). All three applications have different criteria for submission and approval and the NOI and RDA are governed by both the state law and the local bylaw. The MBZA is issued under the local bylaw only.

When a potential applicant requests advice from the Conservation Agent on which application to file, the opinion of the Agent is based on the information given by the potential applicant and any other information available to the Agent, e.g. the town's GIS system. The Agent has no legal right to go onto private property at any time until after an application is filed or permission of the property owner is given.

It is important that all applicants understand that after an application is filed, additional information may come to light e.g. via a field inspection or a review of the application, that may impact the scope of the submitted application and the approval process. **Therefore, it is the ultimate responsibility of the applicant to decide which application to file.**

In light of the above, please sign below indicating an understanding of this policy and submit it with the application.



Signature of Property Owner

2-22-24

Date

Town of Franklin Conservation Commission

PROPERTY ACCESS SIGNATURE FORM

I hereby request that the Franklin Conservation Commission review this NOI/RDA/ANRAD application. I (we) grant authority to the Franklin Conservation Commission members and agents to go onto my (our) property solely for purposes directly related to the inspection and approval of this application and for follow-up compliance with the permit conditions.



Signature of Property Owner

2-22-24

Date

Roads	___ linear feet x \$2.00	=	_____
*Drainage Structures	___ X \$10.00 each	=	_____
Wetland Resource Area Disturbed	___ square feet x \$0.50	=	_____
Buildings	___ X \$125 each	=	_____
All Accessory Improvements	\$100.00	=	_____

2. **REQUEST FOR DETERMINATION (RDA)** \$100.00

3. **MINOR BUFFER ZONE ACTIVITY (MBZA)** \$50.00

4. **ABBREVIATED NOTICE OF RESOURCE AREA DETERMINATION (ANRAD)**

\$0.50/foot/resource area: = _____

5. **OTHER PERMITS/SERVICES**

Order of Conditions Extension	\$50.00	_____
Certificate of Compliance Request	\$50.00	_____
Certificate Re-Inspection	\$50.00	_____
Status Letter for Financial Institution	\$100.00	_____
Permit Amendment	\$100.00	_____

6. **FILING FEE CALCULATION**

Town Share of State Fees (See NOI Wetland Fee Transmittal Form) \$ Fee Exempt

Local Filing Fee Calculated Above \$ Fee Exempt

TOTAL Due Town of Franklin (Check No.1) \$ Fee Exempt

State Share of Filing Fee (See NOI Wetland Fee Transmittal Form)

TOTAL Due DEP (Check No. 2) \$ Fee Exempt

7. **ADVERTISING FEE (Check No. 3)**

TBD

The fee will be the exact amount the newspaper charges for that specific advertisement. Once the advertisement is placed with the paper, by the Conservation Commission, the applicant will be notified of the cost and will be expected to submit a check for that exact amount, payable to the Town of Franklin, to the Conservation Department prior to the first hearing.

*Drainage structures: catch basins, manholes, leaching basins, gutter inlet or any other man-made structure (other than a pipe) for purposes of controlling drainage.

Town of Franklin Conservation Commission

RESOURCE AREA IMPACT SUMMARY FORM

**The Franklin Wetlands Protection Bylaw
Franklin Town Code Section 181**

Resource Area	Alteration Proposed	Mitigation Proposed
Bordering Vegetated Wetland (SF)		
Bank (LF)		
Land Under Water Bodies (SF)		
Isolated Wetland (SF)	980+/-sf.	1,960+/-
Vernal Pool (SF)		
Buffer Zone (SF)	***	
Riverfront (SF)		
100-Year Floodplain (CF)		
(SF) = Square Feet (LF) = Linear Feet (CF) = Cubic Feet Flood Storage		

No Disturb Buffer = 3188+/- sf.
 No build Buffer = 5708+/- sf.
 100ft Buffer Disturbance = 9095+/-sf.

Total disturbances = 19,021+/-sf.

Notification to Abutters

Town of Franklin Conservation Commission

AFFIDAVIT OF SERVICE

Under the Massachusetts Wetlands Protection Act

(To be submitted to the Massachusetts Department of Environmental Protection and the Franklin Conservation Commission when filing a Notice of Intent)

I, Amanda Cavaliere hereby certify under the pains and penalties of perjury that on April 8, 2024, I gave Notification to Abutters in compliance with second paragraph of Massachusetts General Laws Chapter 131, Section 40 in connection with the following matter:

A Notice of Intent filed under the Massachusetts Wetlands Protection Act by the Town of Franklin with the Franklin Conservation Commission on April 5, 2024 for property located on Veterans Memorial Drive Franklin, MA.

The Notification to Abutters form and list of the abutters to whom it was given and their addresses are attached to the Affidavit of Service.

Amanda Cavaliere
Signature

April 5, 2024
Date

Town of Franklin Conservation Commission

NOTIFICATION TO ABUTTERS

Under the Massachusetts Wetlands Protection Act And The Franklin Wetlands Protection Bylaw

In accordance with the second paragraph of Massachusetts General Laws Chapter 131, Section 40, you are hereby notified of the following proposed project:

The Town of Franklin has filed a Notice of Intent with the Franklin Conservation Commission for the Veterans Memorial Drive Extension on April 5, 2024, under the Wetlands Protection Act (M.G.L c.131 §40).

Copies of the Notice of Intent may be examined during regular office hours at Guerriere & Halnon, Inc. 55 West Central Street, Franklin, MA 02038 between 8am - 3pm

Copies may also be examined by contacting the Franklin Conservation Department located at 355 East Central Street, Franklin, MA, (508) 520-4929.

Notice of the public hearing including the date, time, and place will be published at least five (5) days in advance in the Milford Daily News.

Notice of the public hearing including the date, time, and place will be posted in the Franklin Town Hall at least forty eight (48) hours in advance of the public hearing.

The public hearing will be held on Thursday, May 2, 2024, at 7:00 pm at the Town Council Chambers, located on the Second Floor of the Municipal Building on 355 East Central Street. The meeting is also available via Zoom, and can be accessed through the Conservation Commission agenda for that night, which will be posted on the Town's website 48 hours prior to the meeting. Please call the Conservation Department at (508) 520-4929 if you have any questions.

You may also contact the Massachusetts Department of Environmental Protection, Central Regional Office, Worcester, MA at (508) 792-7650.



300 foot Abutters List Report

Franklin, MA
April 04, 2024

Subject Property:

Parcel Number: 259-007-002
CAMA Number: 259-007-002-000
Property Address: VETERANS MEMORIAL DR

Mailing Address: FRANKLIN MUNICIPAL AFFORDABLE
HOUSING TRUST FUND
355 EAST CENTRAL STREET
FRANKLIN, MA 02038

Abutters:

Parcel Number: 259-004-000
CAMA Number: 259-004-000-000
Property Address: 147 POND ST

Mailing Address: TRI-COUNTY REG VOCATIONAL
147 POND ST
FRANKLIN, MA 02038

Parcel Number: 259-005-000
CAMA Number: 259-005-000-000
Property Address: 138-147 HIGHWOOD DR

Mailing Address: HIGHWOOD CONDOMINIUM III GREAT
NORTH PROPERTY MGMT JACK
DONAHUE
138 HIGHWOOD DR
FRANKLIN, MA 02038

Parcel Number: 259-005-000
CAMA Number: 259-005-000-001
Property Address: 138 HIGHWOOD DR

Mailing Address: BRITTINGHAM CHARLES KENZERSKI
AMANDA
138 HIGHWOOD DR
FRANKLIN, MA 02038

Parcel Number: 259-005-000
CAMA Number: 259-005-000-002
Property Address: 139 HIGHWOOD DR

Mailing Address: HORNSBY MALCOLM
139 HIGHWOOD DR
FRANKLIN, MA 02038

Parcel Number: 259-005-000
CAMA Number: 259-005-000-003
Property Address: 140 HIGHWOOD DR

Mailing Address: REDFERN LAUREN K
140 HIGHWOOD DR
FRANKLIN, MA 02038

Parcel Number: 259-005-000
CAMA Number: 259-005-000-004
Property Address: 141 HIGHWOOD DR

Mailing Address: COLACE MICHAEL A
141 HIGHWOOD DR
FRANKLIN, MA 02038

Parcel Number: 259-005-000
CAMA Number: 259-005-000-005
Property Address: 142 HIGHWOOD DR

Mailing Address: LAU KAI
11 SHAFFNER LN
DOVER, MA 02030

Parcel Number: 259-005-000
CAMA Number: 259-005-000-006
Property Address: 143 HIGHWOOD DR

Mailing Address: LAU KAI
11 SCHAFFNER
DOVER, MA 02030

Parcel Number: 259-005-000
CAMA Number: 259-005-000-007
Property Address: 144 HIGHWOOD DR

Mailing Address: PEPERO LAWRENCE R PEPERO DIANE
M
144 HIGHWOOD DR
FRANKLIN, MA 02038

Parcel Number: 259-005-000
CAMA Number: 259-005-000-008
Property Address: 145 HIGHWOOD DR

Mailing Address: PANTER MICHELLE MARIE
145 HIGHWOOD DR
FRANKLIN, MA 02038



www.cai-tech.com

This information is believed to be correct but is subject to change and is not warranted.



300 foot Abutters List Report

Franklin, MA
April 04, 2024

Parcel Number: 259-005-000
CAMA Number: 259-005-000-009
Property Address: 146 HIGHWOOD DR

Mailing Address: ROBBINS LINDA B
146 HIGHWOOD DR
FRANKLIN, MA 02038

Parcel Number: 259-005-000
CAMA Number: 259-005-000-010
Property Address: 147 HIGHWOOD DR

Mailing Address: WOODRING DONALD M WOODRING
ANNE MARIE
147 HIGHWOOD DR
FRANKLIN, MA 02038

Parcel Number: 259-005-000
CAMA Number: 259-005-000-011
Property Address: 148 HIGHWOOD DR

Mailing Address: TOLLAND JEAN M TR JEAN TOLLAND
REVOCABLE TRUST
148 HIGHWOOD DR
FRANKLIN, MA 02038

Parcel Number: 259-005-000
CAMA Number: 259-005-000-012
Property Address: 149 HIGHWOOD DR

Mailing Address: DODD JOSHUA C
149 HIGHWOOD DR
FRANKLIN, MA 02038

Parcel Number: 259-005-000
CAMA Number: 259-005-000-013
Property Address: 150 HIGHWOOD DR

Mailing Address: COCHRANE KIM
150 HIGHWOOD DR
FRANKLIN, MA 02038

Parcel Number: 259-005-000
CAMA Number: 259-005-000-014
Property Address: 151 HIGHWOOD DR

Mailing Address: SIMON KIRK D
12 MARGARETS CV
FRANKLIN, MA 02038

Parcel Number: 259-005-000
CAMA Number: 259-005-000-015
Property Address: 152 HIGHWOOD DR

Mailing Address: GIBEAU LAURIE ANN
152 HIGHWOOD DR
FRANKLIN, MA 02038

Parcel Number: 259-005-000
CAMA Number: 259-005-000-016
Property Address: 153 HIGHWOOD DR

Mailing Address: MARKHAM JENNIFER MARKHAM
AUBREY
153 HIGHWOOD DR
FRANKLIN, MA 02038

Parcel Number: 259-005-000
CAMA Number: 259-005-000-017
Property Address: 154 HIGHWOOD DR

Mailing Address: ADAMS ANDREA
154 HIGHWOOD DR
FRANKLIN, MA 02038-2923

Parcel Number: 259-005-000
CAMA Number: 259-005-000-018
Property Address: 155 HIGHWOOD DR

Mailing Address: KERRIGAN GEORGE F III
155 HIGHWOOD DR
FRANKLIN, MA 02038

Parcel Number: 259-005-000
CAMA Number: 259-005-000-019
Property Address: 156 HIGHWOOD DR

Mailing Address: CHEN SIWEI
8 NICHOLAS RD
HOPKINTON, MA 01748

Parcel Number: 259-005-000
CAMA Number: 259-005-000-020
Property Address: 157 HIGHWOOD DR

Mailing Address: FASULO TAMMY LEE FASULO,
RICHARD J FASULO, CAROL LYN
157 HIGHWOOD DR
FRANKLIN, MA 02038

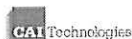

www.cai-tech.com

This information is believed to be correct but is subject to change and is not warranted.



300 foot Abutters List Report

Franklin, MA
April 04, 2024

Parcel Number: 259-005-000 CAMA Number: 259-005-000-021 Property Address: 158 HIGHWOOD DR	Mailing Address: BURKINSHAW ROBERT W II BURKINSHAW KATHLEEN M 158 HIGHWOOD DR FRANKLIN, MA 02038
Parcel Number: 259-005-000 CAMA Number: 259-005-000-022 Property Address: 159 HIGHWOOD DR	Mailing Address: NAG KAUSHIK PRIYADARSHINI CHINMAYEE 159 HIGHWOOD DR FRANKLIN, MA 02038
Parcel Number: 259-005-000 CAMA Number: 259-005-000-023 Property Address: 160 HIGHWOOD DR	Mailing Address: TAYLOR SHAD E TAYLOR AUDRA L 160 HIGHWOOD DR FRANKLIN, MA 02038
Parcel Number: 259-005-000 CAMA Number: 259-005-000-024 Property Address: 161 HIGHWOOD DR	Mailing Address: LIU KANG LIU NA 161 HIGHWOOD DR FRANKLIN, MA 02038
Parcel Number: 259-005-000 CAMA Number: 259-005-000-025 Property Address: 162 HIGHWOOD DR	Mailing Address: REGAN JOHN REGAN MOIRA 162 HIGHWOOD DR FRANKLIN, MA 02038
Parcel Number: 259-005-000 CAMA Number: 259-005-000-026 Property Address: 163 HIGHWOOD DR	Mailing Address: SULLIVAN ELLEN S 372 LAMPLIGHTER DR MARCO ISLAND, FL 34145-4542
Parcel Number: 259-006-000 CAMA Number: 259-006-000-000 Property Address: 164-171 HIGHWOOD DR	Mailing Address: HIGHWOOD CONDOMINIUM III C/O LARKIN, JOHN B 164 HIGHWOOD DR FRANKLIN, MA 02038
Parcel Number: 259-006-000 CAMA Number: 259-006-000-001 Property Address: 164 HIGHWOOD DR	Mailing Address: LARKIN JOHN B 164 HIGHWOOD DR FRANKLIN, MA 02038
Parcel Number: 259-006-000 CAMA Number: 259-006-000-002 Property Address: 165 HIGHWOOD DR	Mailing Address: BLISS HARRIETT C TR BLISS FAMILY REALTY TRUST 165 HIGHWOOD DR FRANKLIN, MA 02038
Parcel Number: 259-006-000 CAMA Number: 259-006-000-003 Property Address: 166 HIGHWOOD DR	Mailing Address: RAJAGOPAL RAJASEKARAN 166 HIGHWOOD DR FRANKLIN, MA 02038
Parcel Number: 259-006-000 CAMA Number: 259-006-000-004 Property Address: 167 HIGHWOOD DR	Mailing Address: MARTIN TIMOTHY HURLEY MARYELLEN 40 TURNER ST NORFOLK, MA 02056
Parcel Number: 259-006-000 CAMA Number: 259-006-000-005 Property Address: 168 HIGHWOOD DR	Mailing Address: ZHELEZCHEVA DESISLAVA 168 HIGHWOOD DR FRANKLIN, MA 02038

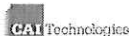

www.cai-tech.com

This information is believed to be correct but is subject to change and is not warranted.



300 foot Abutters List Report

Franklin, MA
April 04, 2024

Parcel Number: 259-006-000 CAMA Number: 259-006-000-006 Property Address: 169 HIGHWOOD DR	Mailing Address: JONES GARY F CARLUCCI-JONES THERESA 381 OAKLAND PARKWAY FRANKLIN, MA 02038
Parcel Number: 259-006-000 CAMA Number: 259-006-000-007 Property Address: 170 HIGHWOOD DR	Mailing Address: ALEXANDER MICHAEL J TR MICHAEL J ALEXANDER REVO TR 170 HIGHWOOD DR FRANKLIN, MA 02038
Parcel Number: 259-006-000 CAMA Number: 259-006-000-008 Property Address: 171 HIGHWOOD DR	Mailing Address: NUNEZ SHANNON LYN 171 HIGHWOOD DR FRANKLIN, MA 02038
Parcel Number: 259-006-000 CAMA Number: 259-006-000-009 Property Address: 172 HIGHWOOD DR	Mailing Address: MCVICAR VICTORIA MCVICAR BRITNEY L 172 HIGHWOOD DR FRANKLIN, MA 02038
Parcel Number: 259-006-000 CAMA Number: 259-006-000-010 Property Address: 173 HIGHWOOD DR	Mailing Address: HUANG XIAONAN 173 HIGHWOOD DR FRANKLIN, MA 02038
Parcel Number: 259-006-000 CAMA Number: 259-006-000-011 Property Address: 174 HIGHWOOD DR	Mailing Address: JANUK LLC 11 FLYNN RD FRANKLIN, MA 02038
Parcel Number: 259-006-000 CAMA Number: 259-006-000-012 Property Address: 175 HIGHWOOD DR	Mailing Address: TILGREN MICHELLE PETROZZI MICHAEL 175 HIGHWOOD DR FRANKLIN, MA 02038
Parcel Number: 259-006-000 CAMA Number: 259-006-000-013 Property Address: 176 HIGHWOOD DR	Mailing Address: 176 HIGHWOOD DRIVE LLC 34 LITTLE TREE LN FRAMINGHAM, MA 01701
Parcel Number: 259-006-000 CAMA Number: 259-006-000-014 Property Address: 177 HIGHWOOD DR	Mailing Address: THORNHILL JAMES JR & SUZANNE E TRS ONE JUNA WAY REALTY TRUST 177 HIGHWOOD DR FRANKLIN, MA 02038
Parcel Number: 259-007-000 CAMA Number: 259-007-000-000 Property Address: 60-69 HIGHWOOD DR	Mailing Address: HIGHWOOD CONDOMINIUM II C/O PIONEER PROP. MGT 146 FOREST STREET FRANKLIN, MA 02038
Parcel Number: 259-007-000 CAMA Number: 259-007-000-001 Property Address: 60 HIGHWOOD DR	Mailing Address: LEAMAN MATTHEW 61 SHORT ST TAUNTON, MA 02780
Parcel Number: 259-007-000 CAMA Number: 259-007-000-002 Property Address: 61 HIGHWOOD DR	Mailing Address: FRUIN PAUL 61 HIGHWOOD DR FRANKLIN, MA 02038



www.cai-tech.com

This information is believed to be correct but is subject to change and is not warranted.



300 foot Abutters List Report

Franklin, MA
April 04, 2024

Parcel Number: 259-007-000
CAMA Number: 259-007-000-003
Property Address: 62 HIGHWOOD DR

Mailing Address: MULLANEY BRIAN G
14 COTTAGE ST
MEDWAY, MA 02053

Parcel Number: 259-007-000
CAMA Number: 259-007-000-004
Property Address: 63 HIGHWOOD DR

Mailing Address: YOUNIS MICHELLE
63 HIGHWOOD DR
FRANKLIN, MA 02038

Parcel Number: 259-007-000
CAMA Number: 259-007-000-005
Property Address: 64 HIGHWOOD DR

Mailing Address: RICE KAREN A
64 HIGHWOOD DR BLDG 8
FRANKLIN, MA 02038

Parcel Number: 259-007-000
CAMA Number: 259-007-000-006
Property Address: 65 HIGHWOOD DR

Mailing Address: MERCADANTE MICHAEL
94 WALNUT ST
PLAINVILLE, MA 02762

Parcel Number: 259-007-000
CAMA Number: 259-007-000-007
Property Address: 66 HIGHWOOD DR

Mailing Address: GHELLI JUSTIN C
66 HIGHWOOD DR
FRANKLIN, MA 02038

Parcel Number: 259-007-000
CAMA Number: 259-007-000-008
Property Address: 67 HIGHWOOD DR

Mailing Address: LISS REBECCA L
67 HIGHWOOD DR
FRANKLIN, MA 02038

Parcel Number: 259-007-000
CAMA Number: 259-007-000-009
Property Address: 68 HIGHWOOD DR

Mailing Address: BANDARU SATHYAJIT SAI
RAVINUTHALA MADHURI
68 HIGHWOOD DR
FRANKLIN, MA 02038

Parcel Number: 259-007-000
CAMA Number: 259-007-000-010
Property Address: 69 HIGHWOOD DR

Mailing Address: FERULLO MICHELLE L
69 HIGHWOOD DR
FRANKLIN, MA 02038

Parcel Number: 259-007-000
CAMA Number: 259-007-000-011
Property Address: 70 HIGHWOOD DR

Mailing Address: ALLARD ALLISON
70 HIGHWOOD DR
FRANKLIN, MA 02038

Parcel Number: 259-007-000
CAMA Number: 259-007-000-012
Property Address: 71 HIGHWOOD DR

Mailing Address: CAMPBELL CHELSEA E
71 HIGHWOOD DR
FRANKLIN, MA 02038

Parcel Number: 259-007-000
CAMA Number: 259-007-000-013
Property Address: 72 HIGHWOOD DR

Mailing Address: GARDENIER NICOLE C
72 HIGHWOOD DR
FRANKLIN, MA 02038

Parcel Number: 259-007-000
CAMA Number: 259-007-000-014
Property Address: 73 HIGHWOOD DR

Mailing Address: BLANCHARD KAREN E
73 HIGHWOOD DR
FRANKLIN, MA 02038

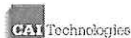

www.cai-tech.com

This information is believed to be correct but is subject to change and is not warranted.



300 foot Abutters List Report

Franklin, MA
April 04, 2024

Parcel Number: 259-007-000 CAMA Number: 259-007-000-015 Property Address: 74 HIGHWOOD DR	Mailing Address: BUCHANAN JOHN S 74 HIGHWOOD DR FRANKLIN, MA 02038
Parcel Number: 259-007-000 CAMA Number: 259-007-000-016 Property Address: 75 HIGHWOOD DR	Mailing Address: CARBONE CHRISTINE 75 HIGHWOOD DR FRANKLIN, MA 02038
Parcel Number: 259-007-000 CAMA Number: 259-007-000-017 Property Address: 76 HIGHWOOD DR	Mailing Address: JANUK LLC 11 FLYNN RD FRANKLIN, MA 02038
Parcel Number: 259-007-000 CAMA Number: 259-007-000-018 Property Address: 77 HIGHWOOD DR	Mailing Address: BHATIA DEVYANDU & DEEPIKA TRS BHATIA LIVING TRUST 25 MARY JANE ROAD FRANKLIN, MA 02038
Parcel Number: 259-007-000 CAMA Number: 259-007-000-019 Property Address: 78 HIGHWOOD DR	Mailing Address: NECCHI CHRISTOPHER 78 HIGHWOOD DR FRANKLIN, MA 02038
Parcel Number: 259-007-000 CAMA Number: 259-007-000-020 Property Address: 79 HIGHWOOD DR	Mailing Address: GREELEY BRIAN ANTHONY 79 HIGHWOOD DRIVE FRANKLIN, MA 02038
Parcel Number: 259-007-001 CAMA Number: 259-007-001-000 Property Address: 20 VETERANS MEMORIAL DR	Mailing Address: EATON PLACE 202 INC C/O P5169 PO BOX 3608 OAK BROOK, IL 60522-3608
Parcel Number: 259-007-002 CAMA Number: 259-007-002-000 Property Address: VETERANS MEMORIAL DR	Mailing Address: FRANKLIN MUNICIPAL AFFORDABLE HOUSING TRUST FUND 355 EAST CENTRAL STREET FRANKLIN, MA 02038
Parcel Number: 259-011-000 CAMA Number: 259-011-000-000 Property Address: 346 OAK ST	Mailing Address: WARDROP KEN O WARDROP LESLIE K 346 OAK ST FRANKLIN, MA 02038
Parcel Number: 259-013-000 CAMA Number: 259-013-000-000 Property Address: 354 OAK ST	Mailing Address: CARRAGHER WILLIAM J 354 OAK ST FRANKLIN, MA 02038
Parcel Number: 259-020-000 CAMA Number: 259-020-000-000 Property Address: 10 LUCIUS ST	Mailing Address: SWEDBERG PAUL R SWEDBERG DARLEEN C 10 LUCIUS ST FRANKLIN, MA 02038
Parcel Number: 259-025-000 CAMA Number: 259-025-000-000 Property Address: 181 IRONDEQUOIT RD	Mailing Address: LAWRENCE JAMES M GRIFFIN MAUREEN P 181 IRONDEQUOIT RD FRANKLIN, MA 02038



www.cai-tech.com

This information is believed to be correct but is subject to change and is not warranted.



300 foot Abutters List Report

Franklin, MA
April 04, 2024

Parcel Number: 259-026-000
CAMA Number: 259-026-000-000
Property Address: 175 IRONDEQUOIT RD

Mailing Address: BARRY KEVIN M BARRY ERISELDA
175 IRONDEQUOIT ROAD
FRANKLIN, MA 02038

Parcel Number: 259-027-000
CAMA Number: 259-027-000-000
Property Address: 341 MUCCIARONE RD

Mailing Address: GRIFFIN RYAN M BARRON JULIANNE F
341 MUCCIARONE RD
FRANKLIN, MA 02038

Parcel Number: 259-028-000
CAMA Number: 259-028-000-000
Property Address: 349 MUCCIARONE RD

Mailing Address: ARENA CHERYL A TR CHERYL A
ARENA TRUST
349 MUCCIARONE RD
FRANKLIN, MA 02038

Parcel Number: 259-029-000
CAMA Number: 259-029-000-000
Property Address: 342 MUCCIARONE RD

Mailing Address: BREWER JEFFREY L BREWER ANNE
MARIE
342 MUCCIARONE RD
FRANKLIN, MA 02038

Parcel Number: 259-037-000
CAMA Number: 259-037-000-000
Property Address: 160 DAILEY DR

Mailing Address: FITZGERALD JAMES F FITZGERALD
JENNIFER S
160 DAILEY DR
FRANKLIN, MA 02038

Parcel Number: 259-038-000
CAMA Number: 259-038-000-000
Property Address: 357 MUCCIARONE RD

Mailing Address: DINARDO AARON D DINARDO LAUREN
N
357 MUCCIARONE ROAD
FRANKLIN, MA 02038

Parcel Number: 259-039-000
CAMA Number: 259-039-000-000
Property Address: 365 MUCCIARONE RD

Mailing Address: DRAKE PATRICK M DRAKE ELISA L
365 MUCCIARONE RD
FRANKLIN, MA 02038

Parcel Number: 260-003-000
CAMA Number: 260-003-000-000
Property Address: 218 OAK ST

Mailing Address: FRANKLIN TOWN OF HIGH SCHOOL &
POLICE STATION
355 EAST CENTRAL STREET
FRANKLIN, MA 02038

Parcel Number: 270-021-000
CAMA Number: 270-021-000-000
Property Address: 201-612 FRANKLIN CROSSING RD

Mailing Address: FRANKLIN CROSSING CONDOMINIUM
BRIGS PROPERTY MANAGEMENT RIK
LYNCH
589 CONCORD ST
HOLLISTON, MA 01746

Parcel Number: 270-021-000
CAMA Number: 270-021-000-001
Property Address: 201 FRANKLIN CROSSING RD

Mailing Address: DEVINE THOMAS A DEVINE BARBARA H
59 SOUTH ST
FRANKLIN, MA 02038

Parcel Number: 270-021-000
CAMA Number: 270-021-000-002
Property Address: 202 FRANKLIN CROSSING RD

Mailing Address: QUEZADA ARIELIS CARDONA JUSTIN
202 FRANKLIN CROSS RD
FRANKLIN, MA 02038

Parcel Number: 270-021-000
CAMA Number: 270-021-000-003
Property Address: 203 FRANKLIN CROSSING RD

Mailing Address: TRABOULSSI JOSEPH A & CHRISTINE
TRS TRABOULSSI FAMILY REVO LIV TR
415 THURSTON ST
WRENTHAM, MA 02093



www.cai-tech.com

This information is believed to be correct but is subject to change and is not warranted.



300 foot Abutters List Report

Franklin, MA
April 04, 2024

Parcel Number: 270-021-000 CAMA Number: 270-021-000-004 Property Address: 204 FRANKLIN CROSSING RD	Mailing Address: COLE DEREK ANGUS COLE DANIELE & LYDIA 204 FRANKLIN CROSSING RD FRANKLIN, MA 02038
Parcel Number: 270-021-000 CAMA Number: 270-021-000-005 Property Address: 205 FRANKLIN CROSSING RD	Mailing Address: GONZALEZ ORTIZ JOSE R 205 FRANKLIN CROSSING FRANKLIN, MA 02038
Parcel Number: 270-021-000 CAMA Number: 270-021-000-006 Property Address: 206 FRANKLIN CROSSING RD	Mailing Address: GARRITY H PHILIP III GARRITY CAROL J 421 BEVERLY RD FRANKLIN, MA 02038
Parcel Number: 270-021-000 CAMA Number: 270-021-000-007 Property Address: 207 FRANKLIN CROSSING RD	Mailing Address: BALARAMAN PRASANNA 5 DERBY LN FRANKLIN, MA 02038
Parcel Number: 270-021-000 CAMA Number: 270-021-000-008 Property Address: 208 FRANKLIN CROSSING RD	Mailing Address: ROMANO ROSA ROMANO ANTONIO 65 TILTING ROCK RD WRENTHAM, MA 02093
Parcel Number: 270-021-000 CAMA Number: 270-021-000-009 Property Address: 209 FRANKLIN CROSSING RD	Mailing Address: MCCAUL JOSEPH B 209 FRANKLIN CROSSING RD - UNIT 9 FRANKLIN, MA 02038
Parcel Number: 270-021-000 CAMA Number: 270-021-000-010 Property Address: 210 FRANKLIN CROSSING RD	Mailing Address: HOFMANN AARON MCKAY ERIKA 210 FRANKLIN CROSSING RD FRANKLIN, MA 02038
Parcel Number: 270-021-000 CAMA Number: 270-021-000-011 Property Address: 211 FRANKLIN CROSSING RD	Mailing Address: EICHIN DENNIS & NARCISA EICHIN ADRIANA & SABRINA 211 FRANKLIN CROSSING FRANKLIN, MA 02038
Parcel Number: 270-021-000 CAMA Number: 270-021-000-012 Property Address: 212 FRANKLIN CROSSING RD	Mailing Address: PAN CHIN YI LIANG YUN P 1 JR`S LN FRANKLIN, MA 02038
Parcel Number: 270-021-000 CAMA Number: 270-021-000-013 Property Address: 401 FRANKLIN CROSSING RD	Mailing Address: SASA-1 GLOBAL ENDEAVORS LLC PO BOX 71 SOUTHBOROUGH, MA 01772
Parcel Number: 270-021-000 CAMA Number: 270-021-000-014 Property Address: 402 FRANKLIN CROSSING RD	Mailing Address: BEAUREGARD KENNETH P BEAUREGARD JOANNE E 402 FRANKLIN CROSS RD FRANKLIN, MA 02038
Parcel Number: 270-021-000 CAMA Number: 270-021-000-015 Property Address: 403 FRANKLIN CROSSING RD	Mailing Address: HANSEN HILLARY ANN 403 FRANKLIN CROSS RD FRANKLIN, MA 02038



www.cai-tech.com

This information is believed to be correct but is subject to change and is not warranted.



300 foot Abutters List Report

Franklin, MA
April 04, 2024

Parcel Number: 270-021-000
CAMA Number: 270-021-000-016
Property Address: 404 FRANKLIN CROSSING RD

Mailing Address: RENAGHAN JOAN M
404 FRANKLIN CROSS RD
FRANKLIN, MA 02038

Parcel Number: 270-021-000
CAMA Number: 270-021-000-017
Property Address: 405 FRANKLIN CROSSING RD

Mailing Address: KUMAR AVINASH
405 FRANKLIN CROSSING UNIT 4-5
FRANKLIN, MA 02038

Parcel Number: 270-021-000
CAMA Number: 270-021-000-018
Property Address: 406 FRANKLIN CROSSING RD

Mailing Address: MCNULTY MATTHEW MCNULTY MARTA
8 BRETTS FARM RD
NORFOLK, MA 02056

Parcel Number: 270-021-000
CAMA Number: 270-021-000-019
Property Address: 407 FRANKLIN CROSSING RD

Mailing Address: MARTINI MORGAN
6 CEDAR CREEK
ATTLEBORO, MA 02703

Parcel Number: 270-021-000
CAMA Number: 270-021-000-020
Property Address: 408 FRANKLIN CROSSING RD

Mailing Address: KENT KRISTY L
408 FRANKLIN CROSSING RD
FRANKLIN, MA 02038

Parcel Number: 270-021-000
CAMA Number: 270-021-000-021
Property Address: 409 FRANKLIN CROSSING RD

Mailing Address: VILLIARD PAUL J
409 FRANKLIN CROSS RD
FRANKLIN, MA 02038

Parcel Number: 270-021-000
CAMA Number: 270-021-000-022
Property Address: 410 FRANKLIN CROSSING RD

Mailing Address: FIELD DONNA FIELD MICHAEL B
410 FRANKLIN CROSSING ROAD
FRANKLIN, MA 02038

Parcel Number: 270-021-000
CAMA Number: 270-021-000-023
Property Address: 411 FRANKLIN CROSSING RD

Mailing Address: SOARES STEPHEN
117 TURNPIKE ST
SOUTH EASTON, MA 02375-1123

Parcel Number: 270-021-000
CAMA Number: 270-021-000-024
Property Address: 412 FRANKLIN CROSSING RD

Mailing Address: MCALEAR STEPHEN H DELZOPPO
MARIE A
412 FRANKLIN CROSS RD
FRANKLIN, MA 02038

Parcel Number: 270-021-000
CAMA Number: 270-021-000-025
Property Address: 601 FRANKLIN CROSSING RD

Mailing Address: PRESKENIS DONNA M
601 FRANKLIN CROSS RD
FRANKLIN, MA 02038

Parcel Number: 270-021-000
CAMA Number: 270-021-000-026
Property Address: 602 FRANKLIN CROSSING RD

Mailing Address: SANTANIELLO KATHRYN SANTANIELLO
SHELLY
602 FRANKLIN CROSS RD
FRANKLIN, MA 02038

Parcel Number: 270-021-000
CAMA Number: 270-021-000-027
Property Address: 603 FRANKLIN CROSSING RD

Mailing Address: RAJAGOPAL RAJASEKARAN
2 DENA DRIVE
FRANKLIN, MA 02038



www.cai-tech.com

This information is believed to be correct but is subject to change and is not warranted.



300 foot Abutters List Report

Franklin, MA
April 04, 2024

Parcel Number: 270-021-000
CAMA Number: 270-021-000-028
Property Address: 604 FRANKLIN CROSSING RD

Mailing Address: CONNORS RYAN PALLESCHI
ALEXANDRA
604 FRANKLIN CROSSING RD
FRANKLIN, MA 02038

Parcel Number: 270-021-000
CAMA Number: 270-021-000-029
Property Address: 605 FRANKLIN CROSSING RD

Mailing Address: MARTINI NICHOLAS R
605 FRANKLIN CROSSING RD
FRANKLIN, MA 02038

Parcel Number: 270-021-000
CAMA Number: 270-021-000-030
Property Address: 606 FRANKLIN CROSSING RD

Mailing Address: SANTOS VALTER DIAS
606 FRANKLIN CROSS RD
FRANKLIN, MA 02038

Parcel Number: 270-021-000
CAMA Number: 270-021-000-031
Property Address: 607 FRANKLIN CROSSING RD

Mailing Address: ROCHA JOSE MAGNO
607 FRANKLIN CROSS RD
FRANKLIN, MA 02038

Parcel Number: 270-021-000
CAMA Number: 270-021-000-032
Property Address: 608 FRANKLIN CROSSING RD

Mailing Address: ZIEGLER CLAUDE R J
608 FRANKLIN CROSS RD
FRANKLIN, MA 02038

Parcel Number: 270-021-000
CAMA Number: 270-021-000-033
Property Address: 609 FRANKLIN CROSSING RD

Mailing Address: POISSON CHERYL A
609 FRANKLIN CROSS RD
FRANKLIN, MA 02038

Parcel Number: 270-021-000
CAMA Number: 270-021-000-034
Property Address: 610 FRANKLIN CROSSING RD

Mailing Address: PELL JOHN P
610 FRANKLIN CROSS RD
FRANKLIN, MA 02038

Parcel Number: 270-021-000
CAMA Number: 270-021-000-035
Property Address: 611 FRANKLIN CROSSING RD

Mailing Address: QUINN PATRICK J
611 FRANKLIN CROSSING
FRANKLIN, MA 02038

Parcel Number: 270-021-000
CAMA Number: 270-021-000-036
Property Address: 612 FRANKLIN CROSSING RD

Mailing Address: WRIGHT ELIZABETH & JESSICA TRS
612 FRANKLIN XING REALTY TRUST
612 FRANKLIN CROSS RD
FRANKLIN, MA 02038

Parcel Number: 270-021-000
CAMA Number: 270-021-000-037
Property Address: 801 FRANKLIN CROSSING RD

Mailing Address: SHROFF TAPAN SHROFF RAJINI
801 FRANKLIN CROSS RD
FRANKLIN, MA 02038

Parcel Number: 270-021-000
CAMA Number: 270-021-000-038
Property Address: 802 FRANKLIN CROSSING RD

Mailing Address: VERSPRILLE ANNE
802 FRANKLIN CROSS RD
FRANKLIN, MA 02038

Parcel Number: 270-021-000
CAMA Number: 270-021-000-039
Property Address: 803 FRANKLIN CROSSING RD

Mailing Address: AMR REALTY INVESTMENTS LLC
10 SPEEN STREET - 1ST FLOOR
FRAMINGHAM, MA 01701

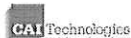

www.cai-tech.com

This information is believed to be correct but is subject to change and is not warranted.



300 foot Abutters List Report

Franklin, MA
April 04, 2024

Parcel Number: 270-021-000
CAMA Number: 270-021-000-040
Property Address: 804 FRANKLIN CROSSING RD

Mailing Address: BARROWS EDWARD A JR
PO BOX 502
MEDFIELD, MA 02052

Parcel Number: 270-021-000
CAMA Number: 270-021-000-041
Property Address: 805 FRANKLIN CROSSING RD

Mailing Address: VILLAFANE GUILLERMO
805 FRANKLIN CROSS RD - UNIT 5
FRANKLIN, MA 02038

Parcel Number: 270-021-000
CAMA Number: 270-021-000-042
Property Address: 806 FRANKLIN CROSSING RD

Mailing Address: RYAN MICHAEL F
806 FRANKLIN CROSSING RD
FRANKLIN, MA 02038

Parcel Number: 270-021-000
CAMA Number: 270-021-000-043
Property Address: 807 FRANKLIN CROSSING RD

Mailing Address: AVILES ALEXANDRIA A
807 FRANKLIN CROSS RD
FRANKLIN, MA 02038

Parcel Number: 270-021-000
CAMA Number: 270-021-000-044
Property Address: 808 FRANKLIN CROSSING RD

Mailing Address: HILL MATTHEW
808 FRANKLIN CROSS RD
FRANKLIN, MA 02038

Parcel Number: 270-021-000
CAMA Number: 270-021-000-045
Property Address: 809 FRANKLIN CROSSING RD

Mailing Address: MEKA UDAYALAKSHMI
809 FRANKLIN CROSSING
FRANKLIN, MA 02038

Parcel Number: 270-021-000
CAMA Number: 270-021-000-046
Property Address: 810 FRANKLIN CROSSING RD

Mailing Address: COMMANE BRENDA E
810 FRANKLIN CROSSING RD
FRANKLIN, MA 02038

Parcel Number: 270-021-000
CAMA Number: 270-021-000-047
Property Address: 811 FRANKLIN CROSSING RD

Mailing Address: QUAN LESTER
811 FRANKLIN CROSSING RD
FRANKLIN, MA 02038

Parcel Number: 270-021-000
CAMA Number: 270-021-000-048
Property Address: 812 FRANKLIN CROSSING RD

Mailing Address: ANTONOV PAVEL
812 FRANKLIN CROSSING RD
FRANKLIN, MA 02038

Parcel Number: 270-021-000
CAMA Number: 270-021-000-049
Property Address: 1001 FRANKLIN CROSSING RD

Mailing Address: GOLDMAN JUDITH A
1001 FRANKLIN CROSS RD
FRANKLIN, MA 02038

Parcel Number: 270-021-000
CAMA Number: 270-021-000-050
Property Address: 1002 FRANKLIN CROSSING RD

Mailing Address: SHARIFI AWESTA
1002 FRANKLIN CROSS RD
FRANKLIN, MA 02038

Parcel Number: 270-021-000
CAMA Number: 270-021-000-051
Property Address: 1003 FRANKLIN CROSSING RD

Mailing Address: KANNAR SANDRA A
1003 FRANKLIN CROSSING RD
FRANKLIN, MA 02038

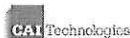

www.cai-tech.com

This information is believed to be correct but is subject to change and is not warranted.



300 foot Abutters List Report

Franklin, MA
April 04, 2024

Parcel Number: 270-021-000
CAMA Number: 270-021-000-052
Property Address: 1004 FRANKLIN CROSSING RD

Mailing Address: NEELY RICHARD E NEELY STEPHEN
1004 FRANKLIN CROSS RD
FRANKLIN, MA 02038

Parcel Number: 270-021-000
CAMA Number: 270-021-000-053
Property Address: 1005 FRANKLIN CROSSING RD

Mailing Address: MONAHAN CORINNE M TR CORINNE M
MONAHAN 2021 TRUST
35 NORTHGATE RD
WELLESLEY, MA 02481

Parcel Number: 270-021-000
CAMA Number: 270-021-000-054
Property Address: 1006 FRANKLIN CROSSING RD

Mailing Address: PURCELL JOSEPHINE A
714 PLEASANT ST - UNIT 2
NORWOOD, MA 02062-4685

Parcel Number: 270-021-000
CAMA Number: 270-021-000-055
Property Address: 1007 FRANKLIN CROSSING RD

Mailing Address: LIBSON MARY KIM
1007 FRANKLIN CROSS RD
FRANKLIN, MA 02038

Parcel Number: 270-021-000
CAMA Number: 270-021-000-056
Property Address: 1008 FRANKLIN CROSSING RD

Mailing Address: FINCHER STEPHANIE ELLEN
1008 FRANKLIN CROSS RD
FRANKLIN, MA 02038

Parcel Number: 270-021-000
CAMA Number: 270-021-000-057
Property Address: 1009 FRANKLIN CROSSING RD

Mailing Address: LEE KEVIN F
1009 FRANKLIN CROSS RD UNIT 9
FRANKLIN, MA 02038

Parcel Number: 270-021-000
CAMA Number: 270-021-000-058
Property Address: 1010 FRANKLIN CROSSING RD

Mailing Address: LEEAR BRYAN
1010 FRANKLIN CROSS RD
FRANKLIN, MA 02038

Parcel Number: 270-021-000
CAMA Number: 270-021-000-059
Property Address: 1011 FRANKLIN CROSSING RD

Mailing Address: LEE S D DANIEL & AGNES TRS LEE &
TAM-LEE REVOCABLE TRUST
17 WALNUT ST
MILLIS, MA 02054

Parcel Number: 270-021-000
CAMA Number: 270-021-000-060
Property Address: 1012 FRANKLIN CROSSING RD

Mailing Address: CARON ALEXANDRIA BAZDANES
KIERSTEN E
1012 FRANKLIN CROSS RD
FRANKLIN, MA 02038

Parcel Number: 270-021-000
CAMA Number: 270-021-000-061
Property Address: 1201 FRANKLIN CROSSING RD

Mailing Address: FEDERICO GINO & ARMANDO TRS
FEDERICO REALTY TRUST
588 EAST ST
WRENTHAM, MA 02093

Parcel Number: 270-021-000
CAMA Number: 270-021-000-062
Property Address: 1202 FRANKLIN CROSSING RD

Mailing Address: HOLT JOANNE
1202 FRANKLIN CROSSING RD
FRANKLIN, MA 02038

Parcel Number: 270-021-000
CAMA Number: 270-021-000-063
Property Address: 1203 FRANKLIN CROSSING RD

Mailing Address: DOE JONATHAN W DOE CHERYL A
1203 FRANKLIN CROSS RD
FRANKLIN, MA 02038



www.cai-tech.com

This information is believed to be correct but is subject to change and is not warranted.



300 foot Abutters List Report

Franklin, MA
April 04, 2024

Parcel Number: 270-021-000 CAMA Number: 270-021-000-064 Property Address: 1204 FRANKLIN CROSSING RD	Mailing Address: KARENSKI ALIAKSEI KARENSKI LEONID 1204 FRANKLIN CROSSING RD FRANKLIN, MA 02038
Parcel Number: 270-021-000 CAMA Number: 270-021-000-065 Property Address: 1205 FRANKLIN CROSSING RD	Mailing Address: KOZAK KRISTINA 1205 FRANKLIN CROSSING RD FRANKLIN, MA 02038
Parcel Number: 270-021-000 CAMA Number: 270-021-000-066 Property Address: 1206 FRANKLIN CROSSING RD	Mailing Address: KIERCE ROBERT F & KAREN E 3 HERITAGE DR FOXBORO, MA 02035
Parcel Number: 270-021-000 CAMA Number: 270-021-000-067 Property Address: 1207 FRANKLIN CROSSING RD	Mailing Address: RAVREBY SANDRA L 1207 FRANKLIN CROSS RD FRANKLIN, MA 02038
Parcel Number: 270-021-000 CAMA Number: 270-021-000-068 Property Address: 1208 FRANKLIN CROSSING RD	Mailing Address: MAGUIRE KERRY 1208 FRANKLIN CROSS RD FRANKLIN, MA 02038
Parcel Number: 270-021-000 CAMA Number: 270-021-000-069 Property Address: 1209 FRANKLIN CROSSING RD	Mailing Address: FRAIN MARY P 1209 FRANKLIN CROSSING RD FRANKLIN, MA 02038
Parcel Number: 270-021-000 CAMA Number: 270-021-000-070 Property Address: 1210 FRANKLIN CROSSING RD	Mailing Address: LEE DANIEL & AGNES TAM TRS SD DANIEL LEE & AGNES TAM-LEE REVOCABLE TRUST 17 WALNUT ST MILLIS, MA 02054
Parcel Number: 270-021-000 CAMA Number: 270-021-000-071 Property Address: 1211 FRANKLIN CROSSING RD	Mailing Address: URBANO MARIA A 1211 FRANKLIN CROSS RD FRANKLIN, MA 02038
Parcel Number: 270-021-000 CAMA Number: 270-021-000-072 Property Address: 1212 FRANKLIN CROSSING RD	Mailing Address: SIWRUK GARY A 1212 FRANKLIN CROSS RD FRANKLIN, MA 02038
Parcel Number: 270-021-000 CAMA Number: 270-021-000-073 Property Address: 1401 FRANKLIN CROSSING RD	Mailing Address: DELUCA THOMAS DELUCA PAMELA A 1401 FRANKLIN CROSSING RD FRANKLIN, MA 02038
Parcel Number: 270-021-000 CAMA Number: 270-021-000-074 Property Address: 1402 FRANKLIN CROSSING RD	Mailing Address: LUNN DEBORAH A 1402 FRANKLIN CROSS RD FRANKLIN, MA 02038
Parcel Number: 270-021-000 CAMA Number: 270-021-000-075 Property Address: 1403 FRANKLIN CROSSING RD	Mailing Address: JANUK LLC 11 FLYNN RD FRANKLIN, MA 02038



www.cai-tech.com

This information is believed to be correct but is subject to change and is not warranted.



300 foot Abutters List Report

Franklin, MA
April 04, 2024

Parcel Number: 270-021-000 CAMA Number: 270-021-000-076 Property Address: 1404 FRANKLIN CROSSING RD	Mailing Address: SKY ALAN 1404 FRANKLIN CROSSING RD FRANKLIN, MA 02038
Parcel Number: 270-021-000 CAMA Number: 270-021-000-077 Property Address: 1405 FRANKLIN CROSSING RD	Mailing Address: STEVENS JONATHAN 1405 FRANKLIN CROSS RD FRANKLIN, MA 02038
Parcel Number: 270-021-000 CAMA Number: 270-021-000-078 Property Address: 1406 FRANKLIN CROSSING RD	Mailing Address: SAWYER ALLAN W 1406 FRANKLIN CROSS RD FRANKLIN, MA 02038
Parcel Number: 270-021-000 CAMA Number: 270-021-000-079 Property Address: 1407 FRANKLIN CROSSING RD	Mailing Address: SULLIVAN ELLEN 1407 FRANKLIN CROSS RD FRANKLIN, MA 02038
Parcel Number: 270-021-000 CAMA Number: 270-021-000-080 Property Address: 1408 FRANKLIN CROSSING RD	Mailing Address: BATA JEFFREY J TR JEFFREY J BATA 2013 TRUST 7 PENOBSCOT RD NATICK, MA 01760
Parcel Number: 270-021-000 CAMA Number: 270-021-000-081 Property Address: 1409 FRANKLIN CROSSING RD	Mailing Address: YUAN WENMIN KUAI RUI 1409 FRANKLIN CROSSING RD FRANKLIN, MA 02038
Parcel Number: 270-021-000 CAMA Number: 270-021-000-082 Property Address: 1410 FRANKLIN CROSSING RD	Mailing Address: MADADI AMIRHOSSEIN AHI HOURIEH 1410 FRANKLIN CROSS RD FRANKLIN, MA 02038
Parcel Number: 270-021-000 CAMA Number: 270-021-000-083 Property Address: 1411 FRANKLIN CROSSING RD	Mailing Address: VINLUAN ROBERTO VINLUAN AMELIA 208 WARREN ST NEEDHAM, MA 02492
Parcel Number: 270-021-000 CAMA Number: 270-021-000-084 Property Address: 1412 FRANKLIN CROSSING RD	Mailing Address: ROSE PATRICK M SWEENEY BRIDGET A 1412 FRANKLIN CROSSING RD FRANKLIN, MA 02038/
Parcel Number: 270-021-000 CAMA Number: 270-021-000-085 Property Address: 1601 FRANKLIN CROSSING RD	Mailing Address: JANUK LLC 11 FLYNN RD FRANKLIN, MA 02038
Parcel Number: 270-021-000 CAMA Number: 270-021-000-086 Property Address: 1602 FRANKLIN CROSSING RD	Mailing Address: KELLY CHRISTOPHER JOHN 1602 FRANKLIN CROSS RD FRANKLIN, MA 02038
Parcel Number: 270-021-000 CAMA Number: 270-021-000-087 Property Address: 1603 FRANKLIN CROSSING RD	Mailing Address: RICHARD HARLOW INVESTMENTS LLC 120 ORCHARD ST MILLIS, MA 02064



www.cal-tech.com

This information is believed to be correct but is subject to change and is not warranted.



300 foot Abutters List Report

Franklin, MA
April 04, 2024

Parcel Number: 270-021-000 CAMA Number: 270-021-000-088 Property Address: 1604 FRANKLIN CROSSING RD	Mailing Address: TOMAO JOSEPH A 1604 FRANKLIN CROSS RD FRANKLIN, MA 02038
Parcel Number: 270-021-000 CAMA Number: 270-021-000-089 Property Address: 1605 FRANKLIN CROSSING RD	Mailing Address: HSIEN FRANK 101 LEGATE HILL RD LEOMINSTER, MA 01453
Parcel Number: 270-021-000 CAMA Number: 270-021-000-090 Property Address: 1606 FRANKLIN CROSSING RD	Mailing Address: FINLEY JAMES E 1606 FRANKLIN CROSS RD FRANKLIN, MA 02038
Parcel Number: 270-021-000 CAMA Number: 270-021-000-091 Property Address: 1607 FRANKLIN CROSSING RD	Mailing Address: CURRAN EILEEN M 1607 FRANKLIN CROSS RD FRANKLIN, MA 02038
Parcel Number: 270-021-000 CAMA Number: 270-021-000-092 Property Address: 1608 FRANKLIN CROSSING RD	Mailing Address: BATTA JEFFREY J TR JEFFREY J BATTA 2013 TRUST 7 PENOBSCOT RD NATICK, MA 01760
Parcel Number: 270-021-000 CAMA Number: 270-021-000-093 Property Address: 1609 FRANKLIN CROSSING RD	Mailing Address: GATTO KIMBERLY ANN 1609 FRANKLIN CROSSING RD FRANKLIN, MA 02038
Parcel Number: 270-021-000 CAMA Number: 270-021-000-094 Property Address: 1610 FRANKLIN CROSSING RD	Mailing Address: MCDONALD DEBRA A CLAYMAN BRYAN S 129 QUAKER HIGHWAY UXBRIDGE, MA 01569
Parcel Number: 270-021-000 CAMA Number: 270-021-000-095 Property Address: 1611 FRANKLIN CROSSING RD	Mailing Address: ROSEN PATRICIA A 1611 FRANKLIN CROSS RD FRANKLIN, MA 02038
Parcel Number: 270-021-000 CAMA Number: 270-021-000-096 Property Address: 1612 FRANKLIN CROSSING RD	Mailing Address: MISHAL SWARUP SHANKAR 1612 FRANKLIN CROSS RD FRANKLIN, MA 02038
Parcel Number: 270-021-000 CAMA Number: 270-021-000-097 Property Address: 2601 FRANKLIN CROSSING RD	Mailing Address: COELHO RONAN R COELHO MARLENE MARCIONILA D 2601 FRANKLIN CROSSING RD FRANKLIN, MA 02038
Parcel Number: 270-021-000 CAMA Number: 270-021-000-098 Property Address: 2602 FRANKLIN CROSSING RD	Mailing Address: MENESES JOSE A 2602 FRANKLIN CROSSING RD FRANKLIN, MA 02038
Parcel Number: 270-021-000 CAMA Number: 270-021-000-099 Property Address: 2603 FRANKLIN CROSSING RD	Mailing Address: GREGORIO ALEXANDRE 2603 FRANKLIN CROSSING RD FRANKLIN, MA 02038



www.cai-tech.com

This information is believed to be correct but is subject to change and is not warranted.



300 foot Abutters List Report

Franklin, MA
April 04, 2024

Parcel Number: 270-021-000 CAMA Number: 270-021-000-100 Property Address: 2604 FRANKLIN CROSSING RD	Mailing Address: DB NEEDHAM-FRANKLIN LLC 56 KEARNEY RD NEEDHAM, MA 02494
Parcel Number: 270-021-000 CAMA Number: 270-021-000-101 Property Address: 2605 FRANKLIN CROSSING RD	Mailing Address: SLOTNICK, BRUCE E TR CASSIDY, TAMMY J TR SLOTNICK FAMILY IRREVOC TRUST 2605 FRANKLIN CROSSING RD FRANKLIN, MA 02038
Parcel Number: 270-021-000 CAMA Number: 270-021-000-102 Property Address: 2606 FRANKLIN CROSSING RD	Mailing Address: FEDERICO GINO & ARMANDO TRS FEDERICO REALTY TRUST 588 EAST ST WRENTHAM, MA 02093
Parcel Number: 270-021-000 CAMA Number: 270-021-000-103 Property Address: 2607 FRANKLIN CROSSING RD	Mailing Address: NG SHERRI 2607 FRANKLIN CROSSING RD FRANKLIN, MA 02038
Parcel Number: 270-021-000 CAMA Number: 270-021-000-104 Property Address: 2608 FRANKLIN CROSSING RD	Mailing Address: BERARD JILLIAN ANNE 2608 FRANKLIN CROSSING RD FRANKLIN, MA 02038
Parcel Number: 270-021-000 CAMA Number: 270-021-000-105 Property Address: 2609 FRANKLIN CROSSING RD	Mailing Address: MCLELLAN JOHN 2609 FRANKLIN CROSS RD FRANKLIN, MA 02038
Parcel Number: 270-021-000 CAMA Number: 270-021-000-106 Property Address: 2610 FRANKLIN CROSSING RD	Mailing Address: MOHAMMAD DIALA MOUSA AWS 2610 FRANKLIN CROSSING RD FRANKLIN, MA 02038
Parcel Number: 270-021-000 CAMA Number: 270-021-000-107 Property Address: 2611 FRANKLIN CROSSING RD	Mailing Address: FITZPATRICK KELLIE M 2611 FRANKLIN CROSSING RD FRANKLIN, MA 02038
Parcel Number: 270-021-000 CAMA Number: 270-021-000-108 Property Address: 2612 FRANKLIN CROSSING RD	Mailing Address: BALASUBRAMANIAN CHIRANJEEV JANAKIRAMAN VIJAYA P 6 WILLIAMBURG WAY MEDWAY, MA 02053
Parcel Number: 270-021-000 CAMA Number: 270-021-000-109 Property Address: 2401 FRANKLIN CROSSING RD	Mailing Address: WOLFE KEVIN T 2401 FRANKLIN CROSS RD FRANKLIN, MA 02038
Parcel Number: 270-021-000 CAMA Number: 270-021-000-110 Property Address: 2402 FRANKLIN CROSSING RD	Mailing Address: BROYLES DAVID S SUZANNE V TRS BROYLES OXFORD REALTY TRUST 84 OXFORD DR FRANKLIN, MA 02038
Parcel Number: 270-021-000 CAMA Number: 270-021-000-111 Property Address: 2403 FRANKLIN CROSSING RD	Mailing Address: SAVOIE ERNEST JOSEPH TR ERNEST SAVOIC LIVING TRUST 255 STEELE RD UNIT 3 EASTHAM, MA 02642



www.cai-tech.com

This information is believed to be correct but is subject to change and is not warranted.



300 foot Abutters List Report

Franklin, MA
April 04, 2024

Parcel Number: 270-021-000
CAMA Number: 270-021-000-112
Property Address: 2404 FRANKLIN CROSSING RD

Mailing Address: CURRAN KAYLA
2404 FRANKLIN CROSS RD
FRANKLIN, MA 02038

Parcel Number: 270-021-000
CAMA Number: 270-021-000-113
Property Address: 2405 FRANKLIN CROSSING RD

Mailing Address: LENTINI ERICA
2405 FRANKLIN CROSSING RD
FRANKLIN, MA 02038

Parcel Number: 270-021-000
CAMA Number: 270-021-000-114
Property Address: 2406 FRANKLIN CROSSING RD

Mailing Address: MURPHY EDWARD J & SHARON H TRS
ES MURPHY LIVING TRUST
2406 FRANKLIN CROSSING RD
FRANKLIN, MA 02038

Parcel Number: 270-021-000
CAMA Number: 270-021-000-115
Property Address: 2407 FRANKLIN CROSSING RD

Mailing Address: SELLARS KARA L
76 STONE RIDGE RD
FRANKLIN, MA 02038

Parcel Number: 270-021-000
CAMA Number: 270-021-000-116
Property Address: 2408 FRANKLIN CROSSING RD

Mailing Address: PARARAS DIMITRI
2408 FRANKLIN CROSSING RD
FRANKLIN, MA 02038

Parcel Number: 270-021-000
CAMA Number: 270-021-000-117
Property Address: 2409 FRANKLIN CROSSING RD

Mailing Address: ROLLINS NATHAN
2409 FRANKLIN CROSSING
FRANKLIN, MA 02038

Parcel Number: 270-021-000
CAMA Number: 270-021-000-118
Property Address: 2410 FRANKLIN CROSSING RD

Mailing Address: PRIDHAM JASON E PRIDHAM JESSICA
A
706-C RIDGEFIELD CIR
CLINTON, MA 01510

Parcel Number: 270-021-000
CAMA Number: 270-021-000-119
Property Address: 2411 FRANKLIN CROSSING RD

Mailing Address: D`VALENTINE JEREMY D`VALENTINE
ANIKA
2411 FRANKLIN CROSSING RD
FRANKLIN, MA 02038

Parcel Number: 270-021-000
CAMA Number: 270-021-000-120
Property Address: 2412 FRANKLIN CROSSING RD

Mailing Address: DB NEEDHAM-FRANKLIN LLC
56 KEARNEY RD
NEEDHAM, MA 02492

Parcel Number: 270-021-000
CAMA Number: 270-021-000-121
Property Address: 2201 FRANKLIN CROSSING RD

Mailing Address: BAKER EILEEN
2201 FRANKLIN CROSSING RD
FRANKLIN, MA 02038

Parcel Number: 270-021-000
CAMA Number: 270-021-000-122
Property Address: 2202 FRANKLIN CROSSING RD

Mailing Address: KENNEDY JENNY L
2202 FRANKLIN CROSS RD
FRANKLIN, MA 02038

Parcel Number: 270-021-000
CAMA Number: 270-021-000-123
Property Address: 2203 FRANKLIN CROSSING RD

Mailing Address: HOWARD PETER F & KATHRYN A TRS
HOWARD FAMILY 2023 REALTY TRST
71 PRISCILLA ST
FALMOUTH, MA 02536



www.cai-tech.com

This information is believed to be correct but is subject to change and is not warranted.



300 foot Abutters List Report

Franklin, MA
April 04, 2024

Parcel Number: 270-021-000
CAMA Number: 270-021-000-124
Property Address: 2204 FRANKLIN CROSSING RD

Mailing Address: SULLIVAN PATRICIA A
2204 FRANKLIN CROSS RD
FRANKLIN, MA 02038

Parcel Number: 270-021-000
CAMA Number: 270-021-000-125
Property Address: 2205 FRANKLIN CROSSING RD

Mailing Address: GAZZOLA JENNIFER L C/O GIULIANO
JENNIFER L
2205 FRANKLIN CROSS RD
FRANKLIN, MA 02038

Parcel Number: 270-021-000
CAMA Number: 270-021-000-126
Property Address: 2206 FRANKLIN CROSSING RD

Mailing Address: GRADY JOHN P
2206 FRANKLIN CROSS RD
FRANKLIN, MA 02038

Parcel Number: 270-021-000
CAMA Number: 270-021-000-127
Property Address: 2207 FRANKLIN CROSSING RD

Mailing Address: HELMY JOSEPH GEORGE FLANAGAN
LORI
2207 FRANKLIN CROSS RD
FRANKLIN, MA 02038

Parcel Number: 270-021-000
CAMA Number: 270-021-000-128
Property Address: 2208 FRANKLIN CROSSING RD

Mailing Address: MYERS STACEY
2208 FRANKLIN CROSS RD
FRANKLIN, MA 02038

Parcel Number: 270-021-000
CAMA Number: 270-021-000-129
Property Address: 2209 FRANKLIN CROSSING RD

Mailing Address: CB FRANKLIN LLC
56 KEARNEY RD
NEEDHAM, MA 02494

Parcel Number: 270-021-000
CAMA Number: 270-021-000-130
Property Address: 2210 FRANKLIN CROSSING RD

Mailing Address: RECHT CHARLES
2210 FRANKLIN CROSSING RD
FRANKLIN, MA 02038

Parcel Number: 270-021-000
CAMA Number: 270-021-000-131
Property Address: 2211 FRANKLIN CROSSING RD

Mailing Address: THOMPSON KEVIN J RENDON-
THOMPSON ESTHER
2211 FRANKLIN CROSSING RD
FRANKLIN, MA 02038

Parcel Number: 270-021-000
CAMA Number: 270-021-000-132
Property Address: 2212 FRANKLIN CROSSING RD

Mailing Address: NOAH MICHAEL
2212 FRANKLIN CROSSING RD
FRANKLIN, MA 02038

Parcel Number: 270-021-000
CAMA Number: 270-021-000-133
Property Address: 2001 FRANKLIN CROSSING RD

Mailing Address: BEERS JEANMARIE
2001 FRANKLIN CROSSING RD
FRANKLIN, MA 02038

Parcel Number: 270-021-000
CAMA Number: 270-021-000-134
Property Address: 2002 FRANKLIN CROSSING RD

Mailing Address: VOULGARIS JOSEPH P
11 EMILIO DR
FRANKLIN, MA 02038

Parcel Number: 270-021-000
CAMA Number: 270-021-000-135
Property Address: 2003 FRANKLIN CROSSING RD

Mailing Address: MORGAN JONATHAN A MORGAN
JENNIE M
2003 FRANKLIN CROSS RD
FRANKLIN, MA 02038



www.cai-tech.com

This information is believed to be correct but is subject to change and is not warranted.



300 foot Abutters List Report

Franklin, MA
April 04, 2024

Parcel Number: 270-021-000
CAMA Number: 270-021-000-136
Property Address: 2004 FRANKLIN CROSSING RD

Mailing Address: TURIEO CHRISTOPHER E
2004 FRANKLIN CROSS RD
FRANKLIN, MA 02038

Parcel Number: 270-021-000
CAMA Number: 270-021-000-137
Property Address: 2005 FRANKLIN CROSSING RD

Mailing Address: COMOLETTI ADAM
2005 FRANKLIN CROSSING RD
FRANKLIN, MA 02038

Parcel Number: 270-021-000
CAMA Number: 270-021-000-138
Property Address: 2006 FRANKLIN CROSSING RD

Mailing Address: CALLAHAN MICHAEL
2006 FRANKLIN CROSS RD
FRANKLIN, MA 02038

Parcel Number: 270-021-000
CAMA Number: 270-021-000-139
Property Address: 2007 FRANKLIN CROSSING RD

Mailing Address: CURRIER REALTY LLC
91 ELM STREET
FRANKLIN, MA 02038

Parcel Number: 270-021-000
CAMA Number: 270-021-000-140
Property Address: 2008 FRANKLIN CROSSING RD

Mailing Address: CB FRANKLIN LLC
56 KEARNEY RD
NEEDHAM, MA 02494

Parcel Number: 270-021-000
CAMA Number: 270-021-000-141
Property Address: 2009 FRANKLIN CROSSING RD

Mailing Address: BATA JEFFREY J TR JEFFREY J
BATA 2013 TRUST
7 PENOBSCOT RD
NATICK, MA 01760

Parcel Number: 270-021-000
CAMA Number: 270-021-000-142
Property Address: 2010 FRANKLIN CROSSING RD

Mailing Address: HERTZBERG PAUL A HERTZBERG
PHALLA
2010 FRANKLIN CROSS RD
FRANKLIN, MA 02038

Parcel Number: 270-021-000
CAMA Number: 270-021-000-143
Property Address: 2011 FRANKLIN CROSSING RD

Mailing Address: OBRIEN ANDREW
2011 FRANKLIN CROSSING
FRANKLIN, MA 02038

Parcel Number: 270-021-000
CAMA Number: 270-021-000-144
Property Address: 2012 FRANKLIN CROSSING RD

Mailing Address: MAKACI AMINE
2012 FRANKLIN COSSING RD
FRANKLIN, MA 02038

Parcel Number: 270-021-000
CAMA Number: 270-021-000-145
Property Address: 1801 FRANKLIN CROSSING RD

Mailing Address: CB FRANKLIN LLC
56 KEARNEY RD
NEEDHAM, MA 02494

Parcel Number: 270-021-000
CAMA Number: 270-021-000-146
Property Address: 1802 FRANKLIN CROSSING RD

Mailing Address: PRATT CATHERINE
1802 FRANKLIN CROSS RD
FRANKLIN, MA 02038

Parcel Number: 270-021-000
CAMA Number: 270-021-000-147
Property Address: 1803 FRANKLIN CROSSING RD

Mailing Address: CACICI KATHLEEN
1803 FRANKLIN CROSSING RD
FRANKLIN, MA 02038



www.cai-tech.com

This information is believed to be correct but is subject to change and is not warranted.



300 foot Abutters List Report

Franklin, MA
April 04, 2024

Parcel Number: 270-021-000
CAMA Number: 270-021-000-148
Property Address: 1804 FRANKLIN CROSSING RD

Mailing Address: CB FRANKLIN LLC
56 KEARNEY RD
NEEDHAM, MA 02494

Parcel Number: 270-021-000
CAMA Number: 270-021-000-149
Property Address: 1805 FRANKLIN CROSSING RD

Mailing Address: GILIBERTO SHARON A
1805 FRANKLIN CROSS RD
FRANKLIN, MA 02038

Parcel Number: 270-021-000
CAMA Number: 270-021-000-150
Property Address: 1806 FRANKLIN CROSSING RD

Mailing Address: CAREY COLEEN M
1806 FRANKLIN CROSSING ROAD
FRANKLIN, MA 02038

Parcel Number: 270-021-000
CAMA Number: 270-021-000-151
Property Address: 1807 FRANKLIN CROSSING RD

Mailing Address: CHEN DE XIANG
6 HAVEN WAY
HOPEDALE, MA 01747

Parcel Number: 270-021-000
CAMA Number: 270-021-000-152
Property Address: 1808 FRANKLIN CROSSING RD

Mailing Address: UDDIN MD SALAH MAHMOOD SHAJEDA
A
1808 FRANKLIN CROSSING RD
FRANKLIN, MA 02038

Parcel Number: 270-021-000
CAMA Number: 270-021-000-153
Property Address: 1809 FRANKLIN CROSSING RD

Mailing Address: MALDONADO JEANETH
1809 FRANKLIN CROSS RD
FRANKLIN, MA 02038

Parcel Number: 270-021-000
CAMA Number: 270-021-000-154
Property Address: 1810 FRANKLIN CROSSING RD

Mailing Address: MULLINS PHILIP RYAN
1810 FRANKLIN CROSSING RD
FRANKLIN, MA 02038

Parcel Number: 270-021-000
CAMA Number: 270-021-000-155
Property Address: 1811 FRANKLIN CROSSING RD

Mailing Address: BROWN ANDREW R JOHNSON EMILY M
1811 FRANKLIN CROSSING RD
FRANKLIN, MA 02038

Parcel Number: 270-021-000
CAMA Number: 270-021-000-156
Property Address: 1812 FRANKLIN CROSSING RD

Mailing Address: NEVES-FRANKLIN CROSSING REALTY
TR NEVES JOSEPH TR
1812 FRANKLIN CROSSING RD
FRANKLIN, MA 02038

Parcel Number: 270-040-000
CAMA Number: 270-040-000-000
Property Address: 1-7 HIGHWOOD DR

Mailing Address: HIGHWOOD CONDOMINIUM PIONEER
PROPERTY MANAGEMENT ROY
BLANCHARD
146 FOREST ST
FRANKLIN, MA 02038

Parcel Number: 270-040-000
CAMA Number: 270-040-000-001
Property Address: 1 HIGHWOOD DR

Mailing Address: FERREIRA LISA V
1 HIGHWOOD DR
FRANKLIN, MA 02038

Parcel Number: 270-040-000
CAMA Number: 270-040-000-002
Property Address: 2 HIGHWOOD DR

Mailing Address: ST JOHNS EPISCOPAL CHURCH
237 PLEASANT ST
FRANKLIN, MA 02038



www.cai-tech.com

This information is believed to be correct but is subject to change and is not warranted.



300 foot Abutters List Report

Franklin, MA
April 04, 2024

Parcel Number: 270-040-000
CAMA Number: 270-040-000-003
Property Address: 3 HIGHWOOD DR

Mailing Address: EGAN RICHARD L
3 HIGHWOOD DR
FRANKLIN, MA 02038

Parcel Number: 270-040-000
CAMA Number: 270-040-000-004
Property Address: 4 HIGHWOOD DR

Mailing Address: CUSSON ERIC
4 HIGHWOOD DR
FRANKLIN, MA 02038

Parcel Number: 270-040-000
CAMA Number: 270-040-000-005
Property Address: 5 HIGHWOOD DR

Mailing Address: FORNACIARI SHERRY LEE
5 HIGHWOOD DRIVE
FRANKLIN, MA 02038

Parcel Number: 270-040-000
CAMA Number: 270-040-000-006
Property Address: 6 HIGHWOOD DR

Mailing Address: CUSHMAN CHERYL & CHARLES TRS
CUSHMAN REVOCABLE TRUST
PO BOX 540083
MILLIS, MA 02054

Parcel Number: 270-040-000
CAMA Number: 270-040-000-007
Property Address: 7 HIGHWOOD DR

Mailing Address: BAHETI SRIKANTH JAHURKER
PRANATHI
7 HIGHWOOD DR
FRANKLIN, MA 02038

Parcel Number: 270-040-000
CAMA Number: 270-040-000-008
Property Address: 8 HIGHWOOD DR

Mailing Address: CONNORS NICOLE E
8 HIGHWOOD DR
FRANKLIN, MA 02038

Parcel Number: 270-040-000
CAMA Number: 270-040-000-009
Property Address: 9 HIGHWOOD DR

Mailing Address: DUGGAN BRIAN PATRICK
9 HIGHWOOD DRIVE
FRANKLIN, MA 02038

Parcel Number: 270-040-000
CAMA Number: 270-040-000-010
Property Address: 10 HIGHWOOD DR

Mailing Address: BENNETT STEPHEN C & DAVID M TRS
SC BENNETT REALTY TRUST
10 HIGHWOOD DR
FRANKLIN, MA 02038

Parcel Number: 270-040-000
CAMA Number: 270-040-000-011
Property Address: 11 HIGHWOOD DR

Mailing Address: DEBAGGIS DAVID F & SUSAN M TRS D
& S DEBAGGIS REALTY TRUST
11 HIGHWOOD DR
FRANKLIN, MA 02038

Parcel Number: 270-040-000
CAMA Number: 270-040-000-012
Property Address: 12 HIGHWOOD DR

Mailing Address: LARNIS DEIDRA
12 HIGHWOOD DR
FRANKLIN, MA 02038

Parcel Number: 270-040-000
CAMA Number: 270-040-000-013
Property Address: 13 HIGHWOOD DR

Mailing Address: DEVINE THOMAS A DEVINE BARBARA H
59 SOUTH ST
FRANKLIN, MA 02038

Parcel Number: 270-040-000
CAMA Number: 270-040-000-014
Property Address: 14 HIGHWOOD DR

Mailing Address: HENDERSON YUDYD A
14 HIGHWOOD DR
FRANKLIN, MA 02038



www.cai-tech.com

This information is believed to be correct but is subject to change and is not warranted.



300 foot Abutters List Report

Franklin, MA
April 04, 2024

Parcel Number: 270-040-000
CAMA Number: 270-040-000-015
Property Address: 15 HIGHWOOD DR

Mailing Address: BORDEN DEREK BORDEN ANASTASIA
15 HIGHWOOD DR
FRANKLIN, MA 02038

Parcel Number: 270-040-000
CAMA Number: 270-040-000-016
Property Address: 16 HIGHWOOD DR

Mailing Address: MITCHELL JON C MITCHELL ESTER
16 HIGHWOOD DR
FRANKLIN, MA 02038

Parcel Number: 270-040-000
CAMA Number: 270-040-000-017
Property Address: 17 HIGHWOOD DR

Mailing Address: PETRILLO EMILIO
17 HIGHWOOD DR
FRANKLIN, MA 02038

Parcel Number: 270-040-000
CAMA Number: 270-040-000-018
Property Address: 18 HIGHWOOD DR

Mailing Address: PELLEGGRI GEORGE E & JANE E TRS
PELLEGGRI FAMILY REALTY TRUST
98 JORDAN RD
FRANKLIN, MA 02038

Parcel Number: 270-040-000
CAMA Number: 270-040-000-019
Property Address: 19 HIGHWOOD DR

Mailing Address: CLEAVES DIANE J L/E CLEAVES FAMILY
TRUST OF 2019 DEPTULA, ALISHA R TR
19 HIGHWOOD DR
FRANKLIN, MA 02038

Parcel Number: 270-040-000
CAMA Number: 270-040-000-020
Property Address: 20 HIGHWOOD DR

Mailing Address: HICKEY EUGENE
20 HIGHWOOD DR
FRANKLIN, MA 02038

Parcel Number: 270-040-000
CAMA Number: 270-040-000-021
Property Address: 21 HIGHWOOD DR

Mailing Address: WILSON MARGARET J
21 HIGHWOOD DR
FRANKLIN, MA 02038

Parcel Number: 270-040-000
CAMA Number: 270-040-000-022
Property Address: 22 HIGHWOOD DR

Mailing Address: GOGUEN JASON R
22 HIGHWOOD DRIVE
FRANKLIN, MA 02038

Parcel Number: 270-040-000
CAMA Number: 270-040-000-023
Property Address: 23 HIGHWOOD DR

Mailing Address: DEVLIN LORI
9 CEDAR POINT DRIVE
POCASSET, MA 02559

Parcel Number: 270-041-000
CAMA Number: 270-041-000-000
Property Address: 90-97 HIGHWOOD DR

Mailing Address: HIGHWOOD CONDOMINIUM II PIONEER
PROPERTY MANAGEMENT ROY
BLANCHARD
146 FOREST ST
FRANKLIN, MA 02038

Parcel Number: 270-041-000
CAMA Number: 270-041-000-001
Property Address: 90 HIGHWOOD DR

Mailing Address: PERDUE MELODY PERDUE, PATRICK L
MALIK, TONYA R
90 HIGHWOOD DR
FRANKLIN, MA 02038

Parcel Number: 270-041-000
CAMA Number: 270-041-000-002
Property Address: 91 HIGHWOOD DR

Mailing Address: BODAH TIMOTHY S
91 HIGHWOOD DR
FRANKLIN, MA 02038



www.cai-tech.com

This information is believed to be correct but is subject to change and is not warranted.



300 foot Abutters List Report

Franklin, MA
April 04, 2024

Parcel Number: 270-041-000 CAMA Number: 270-041-000-003 Property Address: 92 HIGHWOOD DR	Mailing Address: KRALIAN NATHAN & MEAGAN TRS THE KRALIAN FAMILY TRUST 2020 26 ROBIN HILL RD DANVERS, MA 01923-1276
Parcel Number: 270-041-000 CAMA Number: 270-041-000-004 Property Address: 93 HIGHWOOD DR	Mailing Address: DONOHOE JESSE A 93 HIGHWOOD DR FRANKLIN, MA 02038
Parcel Number: 270-041-000 CAMA Number: 270-041-000-005 Property Address: 94 HIGHWOOD DR	Mailing Address: WELLING STUART 94 HIGHWOOD DR FRANKLIN, MA 02038
Parcel Number: 270-041-000 CAMA Number: 270-041-000-006 Property Address: 95 HIGHWOOD DR	Mailing Address: KAUR KULJIT CANDELARIA MANPREET KAUR 3 NORWAY FARMS DRIVE NORFOLK, MA 02056
Parcel Number: 270-041-000 CAMA Number: 270-041-000-007 Property Address: 96 HIGHWOOD DR	Mailing Address: DIAZ-CARTAGENA BERNARDO FALCON SANTIAGO CARMEN JULIA 96 HIGHWOOD DR FRANKLIN, MA 02038
Parcel Number: 270-041-000 CAMA Number: 270-041-000-008 Property Address: 97 HIGHWOOD DR	Mailing Address: BHATIA DEVYANDU & DEEPIKA TRS BHATIA LIVING TRUST 25 MARY JANE RD FRANKLIN, MA 02038
Parcel Number: 270-041-000 CAMA Number: 270-041-000-009 Property Address: 98 HIGHWOOD DR	Mailing Address: AVELAR MARIAN C MARTINEZ NELSON U 98 HIGHWOOD DR FRANKLIN, MA 02038
Parcel Number: 270-041-000 CAMA Number: 270-041-000-010 Property Address: 99 HIGHWOOD DR	Mailing Address: CALLAN BARBARA J 99 HIGHWOOD DR FRANKLIN, MA 02038
Parcel Number: 270-041-000 CAMA Number: 270-041-000-011 Property Address: 100 HIGHWOOD DR	Mailing Address: MATHEW A. & VIDYA M.D.SOUZA TRS ARUN & VIDYA LIVING TR 100 HIGHWOOD DR FRANKLIN, MA 02038
Parcel Number: 270-041-000 CAMA Number: 270-041-000-012 Property Address: 101 HIGHWOOD DR	Mailing Address: RICHARD HARLOW INVESTMENTS LLC C/O RICHARD HARLOW - MANAGER 120 ORCHARD ST MILLIS, MA 02054
Parcel Number: 270-041-000 CAMA Number: 270-041-000-013 Property Address: 102 HIGHWOOD DR	Mailing Address: MAHONEY DIANNE W 35 VILLAGE GREEN DENNIS, MA 02638
Parcel Number: 270-041-000 CAMA Number: 270-041-000-014 Property Address: 103 HIGHWOOD DR	Mailing Address: MEADOWS JACQUELINE 103 HIGHWOOD DR FRANKLIN, MA 02038



www.cai-tech.com

This information is believed to be correct but is subject to change and is not warranted.



300 foot Abutters List Report

Franklin, MA
April 04, 2024

Parcel Number: 270-042-000 CAMA Number: 270-042-000-000 Property Address: 104-109 HIGHWOOD DR	Mailing Address: HIGHWOOD CONDOMINIUM II PIONEER PROPERTY MANAGEMENT ROY BLANCHARD 146 FOREST ST FRANKLIN, MA 02038
Parcel Number: 270-042-000 CAMA Number: 270-042-000-001 Property Address: 104 HIGHWOOD DR	Mailing Address: MCGUIRE DIANE C 104 HIGHWOOD DR FRANKLIN, MA 02038
Parcel Number: 270-042-000 CAMA Number: 270-042-000-002 Property Address: 105 HIGHWOOD DR	Mailing Address: HUNT MARY-ELLEN TR HUNT FAMILY REALTY TRUST 105 HIGHWOOD DR FRANKLIN, MA 02038
Parcel Number: 270-042-000 CAMA Number: 270-042-000-003 Property Address: 106 HIGHWOOD DR	Mailing Address: MANUEL MAXIME 106 HIGHWOOD DR FRANKLIN, MA 02038
Parcel Number: 270-042-000 CAMA Number: 270-042-000-004 Property Address: 107 HIGHWOOD DR	Mailing Address: MACALUSO SANDRA 107 HIGHWOOD DR FRANKLIN, MA 02038
Parcel Number: 270-042-000 CAMA Number: 270-042-000-005 Property Address: 108 HIGHWOOD DR	Mailing Address: MATHEW ARUN TR 108 HIGHWOOD DRIVE REALTY TRST D'SOUZA, VIDYA TR 11 EMPIRE DR FRANKLIN, MA 02038
Parcel Number: 270-042-000 CAMA Number: 270-042-000-006 Property Address: 109 HIGHWOOD DR	Mailing Address: ROY ADITI TR ROY FAMILY REALTY TRUST 109 HIGHWOOD DR FRANKLIN, MA 02038
Parcel Number: 270-042-000 CAMA Number: 270-042-000-007 Property Address: 110 HIGHWOOD DR	Mailing Address: EDGERLY LISA J 110 HIGHWOOD DR FRANKLIN, MA 02038
Parcel Number: 270-042-000 CAMA Number: 270-042-000-008 Property Address: 111 HIGHWOOD DR	Mailing Address: FLATEAU ERICHA L 111 HIGHWOOD DR FRANKLIN, MA 02038
Parcel Number: 270-042-000 CAMA Number: 270-042-000-009 Property Address: 112 HIGHWOOD DR	Mailing Address: ANNICCHIARICO PATRICIA TR 112 HIGHWOOD DR REALTY TR 112 HIGHWOOD DR FRANKLIN, MA 02038
Parcel Number: 270-042-000 CAMA Number: 270-042-000-010 Property Address: 113 HIGHWOOD DR	Mailing Address: MACKAY SARAH 113 HIGHWOOD DR FRANKLIN, MA 02038
Parcel Number: 270-042-000 CAMA Number: 270-042-000-011 Property Address: 114 HIGHWOOD DR	Mailing Address: MCCARTHY CHRISTOPHER F MCCARTHY JODI E 114 HIGHWOOD DR FRANKLIN, MA 02038



www.cai-tech.com

This information is believed to be correct but is subject to change and is not warranted.



300 foot Abutters List Report

Franklin, MA
April 04, 2024

Parcel Number: 270-042-000 CAMA Number: 270-042-000-012 Property Address: 115 HIGHWOOD DR	Mailing Address: TURPIN ZACHARY D CAPEN JILLIAN RAE 115 HIGHWOOD DR FRANKLIN, MA 02038
Parcel Number: 270-043-000 CAMA Number: 270-043-000-000 Property Address: 116-123 HIGHWOOD DR	Mailing Address: HIGHWOOD CONDOMINIUM III SHERI LEONE 138 HIGHWOOD DR FRANKLIN, MA 02038
Parcel Number: 270-043-000 CAMA Number: 270-043-000-001 Property Address: 116 HIGHWOOD DR	Mailing Address: SHEA MARYELLEN 116 HIGHWOOD DR FRANKLIN, MA 02038
Parcel Number: 270-043-000 CAMA Number: 270-043-000-002 Property Address: 117 HIGHWOOD DR	Mailing Address: IACOBUCCI DIANE F TR HIGHWOOD IRREVOCABLE TRUST 117 HIGHWOOD DR FRANKLIN, MA 02038
Parcel Number: 270-043-000 CAMA Number: 270-043-000-003 Property Address: 118 HIGHWOOD DR	Mailing Address: WYLLIE WAYNE J 118 HIGHWOOD DR FRANKLIN, MA 02038
Parcel Number: 270-043-000 CAMA Number: 270-043-000-004 Property Address: 119 HIGHWOOD DR	Mailing Address: SACKETT ROBERT A SACKETT MARY LISA 119 HIGHWOOD DR FRANKLIN, MA 02038
Parcel Number: 270-043-000 CAMA Number: 270-043-000-005 Property Address: 120 HIGHWOOD DR	Mailing Address: FICCO THOMAS J FICCO SHARON E 120 HIGHWOOD DR FRANKLIN, MA 02038
Parcel Number: 270-043-000 CAMA Number: 270-043-000-006 Property Address: 121 HIGHWOOD DR	Mailing Address: ALVES VANESSA M 121 HIGHWOOD DR FRANKLIN, MA 02038
Parcel Number: 270-043-000 CAMA Number: 270-043-000-007 Property Address: 122 HIGHWOOD DR	Mailing Address: WESMAN LAURIE WESMAN TODD 122 HIGHWOOD DR FRANKLIN, MA 02038
Parcel Number: 270-043-000 CAMA Number: 270-043-000-008 Property Address: 123 HIGHWOOD DR	Mailing Address: SASTER CAROL M TR SASTER FAM 2017 IRREVOCABLE TR LLOYD, LISA TR 123 HIGHWOOD DR FRANKLIN, MA 02038
Parcel Number: 270-043-000 CAMA Number: 270-043-000-009 Property Address: 124 HIGHWOOD DR	Mailing Address: PAPSIS STEPHEN G PAPSIS FRANCES J 124 HIGHWOOD DR FRANKLIN, MA 02038
Parcel Number: 270-043-000 CAMA Number: 270-043-000-010 Property Address: 125 HIGHWOOD DR	Mailing Address: BRADY JAMES L & VANESS TRS JAMES L BRADY REV TRUST 125 HIGHWOOD DR FRANKLIN, MA 02038

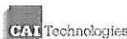

www.cai-tech.com

This information is believed to be correct but is subject to change and is not warranted.



300 foot Abutters List Report

Franklin, MA
April 04, 2024

Parcel Number: 270-043-000
CAMA Number: 270-043-000-011
Property Address: 126 HIGHWOOD DR

Mailing Address: WALKER LINDA M
126 HIGHWOOD DR
FRANKLIN, MA 02038

Parcel Number: 270-043-000
CAMA Number: 270-043-000-012
Property Address: 127 HIGHWOOD DR

Mailing Address: PEARCE MATTHEW M PETERSON ERIN
A
127 HIGHWOOD DR
FRANKLIN, MA 02038

Parcel Number: 270-043-000
CAMA Number: 270-043-000-013
Property Address: 128 HIGHWOOD DR

Mailing Address: HENRY MONA A TR HENRY RTY TR OF
128HIGHWOOD DR
128 HIGHWOOD DR
FRANKLIN, MA 02038

Parcel Number: 270-043-000
CAMA Number: 270-043-000-014
Property Address: 129 HIGHWOOD DR

Mailing Address: FLANNERY LAURA A
129 HIGHWOOD DR
FRANKLIN, MA 02038

Parcel Number: 270-043-000
CAMA Number: 270-043-000-015
Property Address: 130 HIGHWOOD DR

Mailing Address: PLANTE LISA A
130 HIGHWOOD DR
FRANKLIN, MA 02038

Parcel Number: 270-043-000
CAMA Number: 270-043-000-016
Property Address: 131 HIGHWOOD DR

Mailing Address: NORMAN TYLER
131 HIGHWOOD DR
FRANKLIN, MA 02038

Parcel Number: 270-043-000
CAMA Number: 270-043-000-017
Property Address: 132 HIGHWOOD DR

Mailing Address: STUMM JANET WILEY
132 HIGHWOOD DR
FRANKLIN, MA 02038

Parcel Number: 270-043-000
CAMA Number: 270-043-000-018
Property Address: 133 HIGHWOOD DR

Mailing Address: RYAN JOHN T SIMONE MICHELE V
133 HIGHWOOD DR
FRANKLIN, MA 02038

Parcel Number: 270-043-000
CAMA Number: 270-043-000-019
Property Address: 134 HIGHWOOD DR

Mailing Address: KALLAPPA LOKESH
134 HIGHWOOD DR
FRANKLIN, MA 02038

Parcel Number: 270-043-000
CAMA Number: 270-043-000-020
Property Address: 135 HIGHWOOD DR

Mailing Address: OCONNELL ANDREW J
135 HIGHWOOD DR
FRANKLIN, MA 02038

Parcel Number: 270-043-000
CAMA Number: 270-043-000-021
Property Address: 136 HIGHWOOD DR

Mailing Address: KENZERSKI MARTIN KENZERSKI
KATHLEEN ANN
136 HIGHWOOD DR
FRANKLIN, MA 02038

Parcel Number: 270-043-000
CAMA Number: 270-043-000-022
Property Address: 137 HIGHWOOD DR

Mailing Address: MILOT WENDY
137 HIGHWOOD DR
FRANKLIN, MA 02038

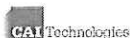

www.cai-tech.com

This information is believed to be correct but is subject to change and is not warranted.



300 foot Abutters List Report

Franklin, MA
April 04, 2024

Parcel Number: 270-044-000 CAMA Number: 270-044-000-000 Property Address: 178-183 HIGHWOOD DR	Mailing Address: HIGHWOOD CONDOMINIUM III SHERI LEONE 138 HIGHWOOD DR FRANKLIN, MA 02038
Parcel Number: 270-044-000 CAMA Number: 270-044-000-001 Property Address: 178 HIGHWOOD DR	Mailing Address: MUDREY LAWRENCE J MUDREY SUSAN E 178 HIGHWOOD DR FRANKLIN, MA 02038
Parcel Number: 270-044-000 CAMA Number: 270-044-000-002 Property Address: 179 HIGHWOOD DR	Mailing Address: LABIB NADIA K TR HIGHWOOD DR REALTY TRUST 30 GRYZBOSKA CIR FRAMINGHAM, MA 01702
Parcel Number: 270-044-000 CAMA Number: 270-044-000-003 Property Address: 180 HIGHWOOD DR	Mailing Address: MOSCATELLI ANGELINA 180 HIGHWOOD DR FRANKLIN, MA 02038
Parcel Number: 270-044-000 CAMA Number: 270-044-000-004 Property Address: 181 HIGHWOOD DR	Mailing Address: JANUK LLC 11 FLYNN RD FRANKLIN, MA 02038
Parcel Number: 270-044-000 CAMA Number: 270-044-000-005 Property Address: 182 HIGHWOOD DR	Mailing Address: GRIFFIN DIANE R MERCON GRIFFIN THOMAS 182 HIGHWOOD DR FRANKLIN, MA 02038
Parcel Number: 270-044-000 CAMA Number: 270-044-000-006 Property Address: 183 HIGHWOOD DR	Mailing Address: PATETE JOHN D PATETE EILEEN 33 LAKESHORE DR BELLINGHAM, MA 02019
Parcel Number: 270-045-000 CAMA Number: 270-045-000-000 Property Address: 80-89 HIGHWOOD DR	Mailing Address: HIGHWOOD CONDOMINIUM II PIONEER PROPERTY MANAGEMENT ROY BLANCHARD 146 FOREST ST FRANKLIN, MA 02038
Parcel Number: 270-045-000 CAMA Number: 270-045-000-001 Property Address: 80 HIGHWOOD DR	Mailing Address: YERGATIAN VERNON C 80 HIGHWOOD DR FRANKLIN, MA 02038
Parcel Number: 270-045-000 CAMA Number: 270-045-000-002 Property Address: 81 HIGHWOOD DR	Mailing Address: LANZILLO MEGAN M LANZILLO ANTHONY J 81 HIGHWOOD DR FRANKLIN, MA 02038
Parcel Number: 270-045-000 CAMA Number: 270-045-000-003 Property Address: 82 HIGHWOOD DR	Mailing Address: KANTHETI SRINIVASARAO NALLURI UMADEVI 71 PALOMINO DR FRANKLIN, MA 02038
Parcel Number: 270-045-000 CAMA Number: 270-045-000-004 Property Address: 83 HIGHWOOD DR	Mailing Address: MCSHANE JESSICA 83 HIGHWOOD DR FRANKLIN, MA 02038



www.cai-tech.com

This information is believed to be correct but is subject to change and is not warranted.



300 foot Abutters List Report

Franklin, MA
April 04, 2024

Parcel Number: 270-045-000
CAMA Number: 270-045-000-005
Property Address: 84 HIGHWOOD DR

Mailing Address: ST JEAN SHAWNA A
84 HIGHWOOD DR
FRANKLIN, MA 02038

Parcel Number: 270-045-000
CAMA Number: 270-045-000-006
Property Address: 85 HIGHWOOD DR

Mailing Address: TARQUI MULLUNI LUZ TARQUI MULLUNI
YANITZA
85 HIGHWOOD DR
FRANKLIN, MA 02038

Parcel Number: 270-045-000
CAMA Number: 270-045-000-007
Property Address: 86 HIGHWOOD DR

Mailing Address: MACASKILL KRISTIN
86 HIGHWOOD DR
FRANKLIN, MA 02038

Parcel Number: 270-045-000
CAMA Number: 270-045-000-008
Property Address: 87 HIGHWOOD DR

Mailing Address: RICHARD HARLOW INVESTMENTS LLC
C/O RICHARD HARLOW
120 ORCHARD ST
MILLIS, MA 02054

Parcel Number: 270-045-000
CAMA Number: 270-045-000-009
Property Address: 88 HIGHWOOD DR

Mailing Address: HARVEY LISA A TR LISA A HARVEY
REVOCABLE TRUST
88 HIGHWOOD DR
FRANKLIN, MA 02038

Parcel Number: 270-045-000
CAMA Number: 270-045-000-010
Property Address: 89 HIGHWOOD DR

Mailing Address: CHAHWAN ELIAS
89 HIGHWOOD DR
FRANKLIN, MA 02038

Parcel Number: 270-046-000
CAMA Number: 270-046-000-000
Property Address: 50-59 HIGHWOOD DR

Mailing Address: HIGHWOOD CONDOMINIUM PIONEER
PROPERTY MANAGEMENT ROY
BLANCHARD
146 FOREST ST
FRANKLIN, MA 02038

Parcel Number: 270-046-000
CAMA Number: 270-046-000-001
Property Address: 50 HIGHWOOD DR

Mailing Address: KHOURY GEORGE EL
50 HIGHWOOD DR
FRANKLIN, MA 02038

Parcel Number: 270-046-000
CAMA Number: 270-046-000-002
Property Address: 51 HIGHWOOD DR

Mailing Address: JOANNE FERULLO REALTY TRUST
51 HIGHWOOD DR
FRANKLIN, MA 02038

Parcel Number: 270-046-000
CAMA Number: 270-046-000-003
Property Address: 52 HIGHWOOD DR

Mailing Address: FARRAND MARINA R
369 SOUTH ST
PLAINVILLE, MA 02762

Parcel Number: 270-046-000
CAMA Number: 270-046-000-004
Property Address: 53 HIGHWOOD DR

Mailing Address: BAYER RUTH A
53 HIGHWOOD DR
FRANKLIN, MA 02038

Parcel Number: 270-046-000
CAMA Number: 270-046-000-005
Property Address: 54 HIGHWOOD DR

Mailing Address: KUTLINA ELENA
54 HIGHWOOD DR
FRANKLIN, MA 02038



www.cai-tech.com

This information is believed to be correct but is subject to change and is not warranted.



300 foot Abutters List Report

Franklin, MA
April 04, 2024

Parcel Number: 270-046-000
CAMA Number: 270-046-000-006
Property Address: 55 HIGHWOOD DR

Mailing Address: ATTUBATO LAURA
55 HIGHWOOD DR
FRANKLIN, MA 02038

Parcel Number: 270-046-000
CAMA Number: 270-046-000-007
Property Address: 56 HIGHWOOD DR

Mailing Address: MORRISSEY BRIAN E
56 HIGHWOOD DR
FRANKLIN, MA 02038

Parcel Number: 270-046-000
CAMA Number: 270-046-000-008
Property Address: 57 HIGHWOOD DR

Mailing Address: PINI PATRICK
57 HIGHWOOD DRIVE
FRANKLIN, MA 02038

Parcel Number: 270-046-000
CAMA Number: 270-046-000-009
Property Address: 58 HIGHWOOD DR

Mailing Address: CHANDLER BRIAN M CHANDLER
KATHERINE T
58 HIGHWOOD DR
FRANKLIN, MA 02038

Parcel Number: 270-046-000
CAMA Number: 270-046-000-010
Property Address: 59 HIGHWOOD DR

Mailing Address: ANSHU KUNAL ANSHU VIKTORIA
SADLOVSKA
860 MARSHALL ST
HOLLISTON, MA 01746

Parcel Number: 270-046-000
CAMA Number: 270-046-000-011
Property Address: 40 HIGHWOOD DR

Mailing Address: MAZZEO PAUL C
40 HIGHWOOD DR
FRANKLIN, MA 02038

Parcel Number: 270-046-000
CAMA Number: 270-046-000-012
Property Address: 41 HIGHWOOD DR

Mailing Address: MUNRO SAMANTHA
41 HIGHWOOD DR
FRANKLIN, MA 02038

Parcel Number: 270-046-000
CAMA Number: 270-046-000-013
Property Address: 42 HIGHWOOD DR

Mailing Address: RAYMOND ANGELIKA U
42 HIGHWOOD DR.
FRANKLIN, MA 02038

Parcel Number: 270-046-000
CAMA Number: 270-046-000-014
Property Address: 43 HIGHWOOD DR

Mailing Address: MORONTA RAUL L MORONTA GISSELL
43 HIGHWOOD DR
FRANKLIN, MA 02038

Parcel Number: 270-046-000
CAMA Number: 270-046-000-015
Property Address: 44 HIGHWOOD DR

Mailing Address: MACKINNON CAROLINE
5 LOVERING ST
MEDWAY, MA 02053

Parcel Number: 270-046-000
CAMA Number: 270-046-000-016
Property Address: 45 HIGHWOOD DR

Mailing Address: OZGUR CEM
45 HIGHWOOD DR
FRANKLIN, MA 02038

Parcel Number: 270-046-000
CAMA Number: 270-046-000-017
Property Address: 46 HIGHWOOD DR

Mailing Address: JANUS REAL ESTATE GROUP LLC
120 ORCHARD ST
MILLIS, MA 02054



www.cai-tech.com

This information is believed to be correct but is subject to change and is not warranted.



300 foot Abutters List Report

Franklin, MA
April 04, 2024

Parcel Number: 270-046-000
CAMA Number: 270-046-000-018
Property Address: 47 HIGHWOOD DR

Mailing Address: POTTER THOMAS W
47 HIGHWOOD DR
FRANKLIN, MA 02038

Parcel Number: 270-046-000
CAMA Number: 270-046-000-019
Property Address: 48 HIGHWOOD DR

Mailing Address: PATEL PRIYA J
48 HIGHWOOD DR
FRANKLIN, MA 02038

Parcel Number: 270-046-000
CAMA Number: 270-046-000-020
Property Address: 49 HIGHWOOD DR

Mailing Address: SEKULA DONNA M
49 HIGHWOOD DR
FRANKLIN, MA 02038

Parcel Number: 270-047-000
CAMA Number: 270-047-000-000
Property Address: 24-29 HIGHWOOD DR

Mailing Address: HIGHWOOD CONDOMINIUM PIONEER
PROPERTY MANAGEMENT ROY
BLANCHARD
146 FOREST ST
FRANKLIN, MA 02038

Parcel Number: 270-047-000
CAMA Number: 270-047-000-001
Property Address: 24 HIGHWOOD DR

Mailing Address: DARCY KATHERINE M
24 HIGHWOOD DR - UNIT 24
FRANKLIN, MA 02038

Parcel Number: 270-047-000
CAMA Number: 270-047-000-002
Property Address: 25 HIGHWOOD DR

Mailing Address: CHIANG LEAH CHIANG SUSAN
7 DONATO DR
FRANKLIN, MA 02038

Parcel Number: 270-047-000
CAMA Number: 270-047-000-003
Property Address: 26 HIGHWOOD DR

Mailing Address: GEARIN CATHERINE
26 HIGHWOOD DR
FRANKLIN, MA 02038

Parcel Number: 270-047-000
CAMA Number: 270-047-000-004
Property Address: 27 HIGHWOOD DR

Mailing Address: COFFIN STEPHEN P COFFIN CHERYL S
27 HIGHWOOD DR
FRANKLIN, MA 02038

Parcel Number: 270-047-000
CAMA Number: 270-047-000-005
Property Address: 28 HIGHWOOD DR

Mailing Address: MISSAL MONA
28 HIGHWOOD DR
FRANKLIN, MA 02038

Parcel Number: 270-047-000
CAMA Number: 270-047-000-006
Property Address: 29 HIGHWOOD DR

Mailing Address: DOLAN TIMOTHY PATRICK DOLAN
LAURA ELIZABETH
29 HIGHWOOD DR
FRANKLIN, MA 02038

Parcel Number: 270-047-000
CAMA Number: 270-047-000-007
Property Address: 30 HIGHWOOD DR

Mailing Address: RAMALINGESH SRILAKSHMI
BISILAHALLI GANDLA UMA
MAHESHWAR
30 HIGHWOOD DR
FRANKLIN, MA 02038

Parcel Number: 270-047-000
CAMA Number: 270-047-000-008
Property Address: 31 HIGHWOOD DR

Mailing Address: VLADYKA JOY
31 HIGHWOOD DR
FRANKLIN, MA 02038



www.cai-tech.com

This information is believed to be correct but is subject to change and is not warranted.



300 foot Abutters List Report

Franklin, MA
April 04, 2024

Parcel Number: 270-047-000
CAMA Number: 270-047-000-009
Property Address: 32 HIGHWOOD DR

Mailing Address: MUCCIARONE JUDITH M JOLLY, LUANA
M KILEY, LISA A
51 EVERETT ST
FRANKLIN, MA 02038

Parcel Number: 270-047-000
CAMA Number: 270-047-000-010
Property Address: 33 HIGHWOOD DR

Mailing Address: WALSH KAREN F
33 HIGHWOOD DR
FRANKLIN, MA 02038

Parcel Number: 270-047-000
CAMA Number: 270-047-000-011
Property Address: 34 HIGHWOOD DR

Mailing Address: TYNAN EDWARD L/E C/O TYNAN GLEN
26 ASPEN AVE
GRAFTON, MA 01560

Parcel Number: 270-047-000
CAMA Number: 270-047-000-012
Property Address: 35 HIGHWOOD DR

Mailing Address: CURRY CHAD P
35 HIGHWOOD DR
FRANKLIN, MA 02038

Parcel Number: 270-047-000
CAMA Number: 270-047-000-013
Property Address: 36 HIGHWOOD DR

Mailing Address: ABRAMSON DMITRY J
36 HIGHWOOD DR
FRANKLIN, MA 02038

Parcel Number: 270-047-000
CAMA Number: 270-047-000-014
Property Address: 37 HIGHWOOD DR

Mailing Address: NECCHI CHRISTOPHER A
37 HIGHWOOD DR
FRANKLIN, MA 02038

Parcel Number: 270-047-000
CAMA Number: 270-047-000-015
Property Address: 38 HIGHWOOD DR

Mailing Address: RICHARD HARLOW INVESTMENTS LLC
120 ORCHARD ST
MILLIS, MA 02064

Parcel Number: 270-047-000
CAMA Number: 270-047-000-016
Property Address: 39 HIGHWOOD DR

Mailing Address: GENTILI KRISTIN M
39 HIGHWOOD DR
FRANKLIN, MA 02038

Parcel Number: 270-048-000
CAMA Number: 270-048-000-000
Property Address: HIGHWOOD DR

Mailing Address: HIGHWOOD CONDOMINIUM C/O
PIONEER PROPERTY
15 FLORENCE ST
FRANKLIN, MA 02038

Kevin M Doyle, 4-4-24



www.cai-tech.com

This information is believed to be correct but is subject to change and is not warranted.

176 HIGHWOOD DRIVE LLC
34 LITTLE TREE LN
FRAMINGHAM, MA 01701

ARENA CHERYL A TR
CHERYL A ARENA TRUST
349 MUCCIARONE RD
FRANKLIN, MA 02038

BARRY KEVIN M
BARRY ERISELDA
175 IRONDEQUOIT ROAD
FRANKLIN, MA 02038

ABRAMSON DMITRY J
36 HIGHWOOD DR
FRANKLIN, MA 02038

ATTUBATO LAURA
55 HIGHWOOD DR
FRANKLIN, MA 02038

BATTA JEFFREY J TR
JEFFREY J BATTA 2013 TRUS
7 PENOBSCOT RD
NATICK, MA 01760

ADAMS ANDREA
154 HIGHWOOD DR
FRANKLIN, MA 02038-2923

AVELAR MARIAN C
MARTINEZ NELSON U
98 HIGHWOOD DR
FRANKLIN, MA 02038

BAYER RUTH A
53 HIGHWOOD DR
FRANKLIN, MA 02038

ALEXANDER MICHAEL J TR
MICHAEL J ALEXANDER REVO
170 HIGHWOOD DR
FRANKLIN, MA 02038

AVILES ALEXANDRIA A
807 FRANKLIN CROSS RD
FRANKLIN, MA 02038

BEAUREGARD KENNETH P
BEAUREGARD JOANNE E
402 FRANKLIN CROSS RD
FRANKLIN, MA 02038

ALLARD ALLISON
70 HIGHWOOD DR
FRANKLIN, MA 02038

BAHETI SRIKANTH
JAHURKER PRANATHI
7 HIGHWOOD DR
FRANKLIN, MA 02038

BEERS JEANMARIE
2001 FRANKLIN CROSSING RD
FRANKLIN, MA 02038

ALVES VANESSA M
121 HIGHWOOD DR
FRANKLIN, MA 02038

BAKER EILEEN
2201 FRANKLIN CROSSING RD
FRANKLIN, MA 02038

BENNETT STEPHEN C & DAVID
SC BENNETT REALTY TRUST
10 HIGHWOOD DR
FRANKLIN, MA 02038

AMR REALTY INVESTMENTS LL
10 SPEEN STREET - 1ST FLOOR
FRAMINGHAM, MA 01701

BALARAMAN PRASANNA
5 DERBY LN
FRANKLIN, MA 02038

BERARD JILLIAN ANNE
2608 FRANKLIN CROSSING RD
FRANKLIN, MA 02038

ANNICCHIARICO PATRICIA TR
112 HIGHWOOD DR REALTY TR
112 HIGHWOOD DR
FRANKLIN, MA 02038

BALASUBRAMANIAN CHIRANJEE
JANAKIRAMAN VIJAYA P
6 WILLIAMBURG WAY
MEDWAY, MA 02053

BHATIA DEVYANDU & DEEPIKA
BHATIA LIVING TRUST
25 MARY JANE RD
FRANKLIN, MA 02038

ANSHU KUNAL
ANSHU VIKTORIA SADLOVSKA
860 MARSHALL ST
HOLLISTON, MA 01746

BANDARU SATHYAJIT SAI
RAVINUTHALA MADHURI
68 HIGHWOOD DR
FRANKLIN, MA 02038

BHATIA DEVYANDU & DEEPIKA
BHATIA LIVING TRUST
25 MARY JANE ROAD
FRANKLIN, MA 02038

ANTONOV PAVEL
812 FRANKLIN CROSSING RD
FRANKLIN, MA 02038

BARROWS EDWARD A JR
PO BOX 502
MEDFIELD, MA 02052

BLANCHARD KAREN E
73 HIGHWOOD DR
FRANKLIN, MA 02038

BLISS HARRIETT C TR
BLISS FAMILY REALTY TRUST
165 HIGHWOOD DR
FRANKLIN, MA 02038

CACICI KATHLEEN
1803 FRANKLIN CROSSING RD
FRANKLIN, MA 02038

CHANDLER BRIAN M
CHANDLER KATHERINE T
58 HIGHWOOD DR
FRANKLIN, MA 02038

BODAH TIMOTHY S
91 HIGHWOOD DR
FRANKLIN, MA 02038

CALLAHAN MICHAEL
2006 FRANKLIN CROSS RD
FRANKLIN, MA 02038

CHEN DE XIANG
6 HAVEN WAY
HOPEDALE, MA 01747

BORDEN DEREK
BORDEN ANASTASIA
15 HIGHWOOD DR
FRANKLIN, MA 02038

CALLAN BARBARA J
99 HIGHWOOD DR
FRANKLIN, MA 02038

CHEN SIWEI
8 NICHOLAS RD
HOPKINTON, MA 01748

BRADY JAMES L & VANESS TR
JAMES L BRADY REV TRUST
125 HIGHWOOD DR
FRANKLIN, MA 02038

CAMPBELL CHELSEA E
71 HIGHWOOD DR
FRANKLIN, MA 02038

CHIANG LEAH
CHIANG SUSAN
7 DONATO DR
FRANKLIN, MA 02038

BREWER JEFFREY L
BREWER ANNE MARIE
342 MUCCIARONE RD
FRANKLIN, MA 02038

CARBONE CHRISTINE
75 HIGHWOOD DR
FRANKLIN, MA 02038

CLEAVES DIANE J L/E
CLEAVES FAMILY TRUST OF 2
19 HIGHWOOD DR
FRANKLIN, MA 02038

BRITTINGHAM CHARLES
KENZERSKI AMANDA
138 HIGHWOOD DR
FRANKLIN, MA 02038

CAREY COLEEN M
1806 FRANKLIN CROSSING ROAD
FRANKLIN, MA 02038

COCHRANE KIM
150 HIGHWOOD DR
FRANKLIN, MA 02038

BROWN ANDREW R
JOHNSON EMILY M
1811 FRANKLIN CROSSING RD
FRANKLIN, MA 02038

CARON ALEXANDRIA
BAZDANES KIERSTEN E
1012 FRANKLIN CROSS RD
FRANKLIN, MA 02038

COELHO RONAN R
COELHO MARLENE MARCIONILA
2601 FRANKLIN CROSSING RD
FRANKLIN, MA 02038

BROYLES DAVID S SUZANNE V
BROYLES OXFORD REALTY TRU
84 OXFORD DR
FRANKLIN, MA 02038

CARRAGHER WILLIAM J
354 OAK ST
FRANKLIN, MA 02038

COFFIN STEPHEN P
COFFIN CHERYL S
27 HIGHWOOD DR
FRANKLIN, MA 02038

BUCHANAN JOHN S
74 HIGHWOOD DR
FRANKLIN, MA 02038

CB FRANKLIN LLC
56 KEARNEY RD
NEEDHAM, MA 02494

COLACE MICHAEL A
141 HIGHWOOD DR
FRANKLIN, MA 02038

BURKINSHAW ROBERT W II
BURKINSHAW KATHLEEN M
158 HIGHWOOD DR
FRANKLIN, MA 02038

CHAHWAN ELIAS
89 HIGHWOOD DR
FRANKLIN, MA 02038

COLE DEREK ANGUS
COLE DANIELE & LYDIA
204 FRANKLIN CROSSING RD
FRANKLIN, MA 02038

COMMANE BRENDA E
810 FRANKLIN CROSSING RD
FRANKLIN, MA 02038

D`VALENTINE JEREMY
D`VALENTINE ANIKA
2411 FRANKLIN CROSSING RD
FRANKLIN, MA 02038

DODD JOSHUA C
149 HIGHWOOD DR
FRANKLIN, MA 02038

COMOLETTI ADAM
2005 FRANKLIN CROSSING RD
FRANKLIN, MA 02038

DARCY KATHERINE M
24 HIGHWOOD DR - UNIT 24
FRANKLIN, MA 02038

DOE JONATHAN W
DOE CHERYL A
1203 FRANKLIN CROSS RD
FRANKLIN, MA 02038

CONNORS NICOLE E
8 HIGHWOOD DR
FRANKLIN, MA 02038

DB NEEDHAM-FRANKLIN LLC
56 KEARNEY RD
NEEDHAM, MA 02492

DOLAN TIMOTHY PATRICK
DOLAN LAURA ELIZABETH
29 HIGHWOOD DR
FRANKLIN, MA 02038

CONNORS RYAN
PALLESCHI ALEXANDRA
604 FRANKLIN CROSSING RD
FRANKLIN, MA 02038

DB NEEDHAM-FRANKLIN LLC
56 KEARNEY RD
NEEDHAM, MA 02494

DONOHUE JESSE A
93 HIGHWOOD DR
FRANKLIN, MA 02038

CURRAN EILEEN M
1607 FRANKLIN CROSS RD
FRANKLIN, MA 02038

DEBAGGIS DAVID F & SUSAN
D & S DEBAGGIS REALTY TRU
11 HIGHWOOD DR
FRANKLIN, MA 02038

DRAKE PATRICK M
DRAKE ELISA L
365 MUCCIARONE RD
FRANKLIN, MA 02038

CURRAN KAYLA
2404 FRANKLIN CROSS RD
FRANKLIN, MA 02038

DELUCA THOMAS
DELUCA PAMELA A
1401 FRANKLIN CROSSING RD
FRANKLIN, MA 02038

DUGGAN BRIAN PATRICK
9 HIGHWOOD DRIVE
FRANKLIN, MA 02038

CURRIER REALTY LLC
91 ELM STREET
FRANKLIN, MA 02038

DEVINE THOMAS A
DEVINE BARBARA H
59 SOUTH ST
FRANKLIN, MA 02038

EATON PLACE 202 INC
C/O P5169
PO BOX 3608
OAK BROOK, IL 60522-3608

CURRY CHAD P
35 HIGHWOOD DR
FRANKLIN, MA 02038

DEVLIN LORI
9 CEDAR POINT DRIVE
POCASSET, MA 02559

EDGERLY LISA J
110 HIGHWOOD DR
FRANKLIN, MA 02038

CUSHMAN CHERYL & CHARLES
CUSHMAN REVOCABLE TRUST
PO BOX 540083
MILLIS, MA 02054

DIAZ-CARTAGENA BERNARDO
FALCON SANTIAGO CARMEN JU
96 HIGHWOOD DR
FRANKLIN, MA 02038

EGAN RICHARD L
3 HIGHWOOD DR
FRANKLIN, MA 02038

CUSSON ERIC
4 HIGHWOOD DR
FRANKLIN, MA 02038

DINARDO AARON D
DINARDO LAUREN N
357 MUCCIARONE ROAD
FRANKLIN, MA 02038

EICHIN DENNIS & NARCISA
EICHIN ADRIANA & SABRINA
211 FRANKLIN CROSSING
FRANKLIN, MA 02038

FARRAND MARINA R
369 SOUTH ST
PLAINVILLE, MA 02762

FITZPATRICK KELLIE M
2611 FRANKLIN CROSSING RD
FRANKLIN, MA 02038

GARRITY H PHILIP III
GARRITY CAROL J
421 BEVERLY RD
FRANKLIN, MA 02038

FASULO TAMMY LEE
FASULO, RICHARD J FASULO,
157 HIGHWOOD DR
FRANKLIN, MA 02038

FLANNERY LAURA A
129 HIGHWOOD DR
FRANKLIN, MA 02038

GATTO KIMBERLY ANN
1609 FRANKLIN CROSSING RD
FRANKLIN, MA 02038

FEDERICO GINO & ARMANDO T
FEDERICO REALTY TRUST
588 EAST ST
WRENTHAM, MA 02093

FLATEAU ERICHA L
111 HIGHWOOD DR
FRANKLIN, MA 02038

GAZZOLA JENNIFER L
C/O GIULIANO JENNIFER L
2205 FRANKLIN CROSS RD
FRANKLIN, MA 02038

FERREIRA LISA V
1 HIGHWOOD DR
FRANKLIN, MA 02038

FORNACIARI SHERRY LEE
5 HIGHWOOD DRIVE
FRANKLIN, MA 02038

GEARIN CATHERINE
26 HIGHWOOD DR
FRANKLIN, MA 02038

FERULLO MICHELLE L
69 HIGHWOOD DR
FRANKLIN, MA 02038

FRAIN MARY P
1209 FRANKLIN CROSSING RD
FRANKLIN, MA 02038

GENTILI KRISTIN M
39 HIGHWOOD DR
FRANKLIN, MA 02038

FICCO THOMAS J
FICCO SHARON E
120 HIGHWOOD DR
FRANKLIN, MA 02038

FRANKLIN CROSSING CONDOMI
BRIGS PROPERTY MANAGEMENT
589 CONCORD ST
HOLLISTON, MA 01746

GHELLI JUSTIN C
66 HIGHWOOD DR
FRANKLIN, MA 02038

FIELD DONNA
FIELD MICHAEL B
410 FRANKLIN CROSSING ROAD
FRANKLIN, MA 02038

FRANKLIN MUNICIPAL AFFORD
HOUSING TRUST FUND
355 EAST CENTRAL STREET
FRANKLIN, MA 02038

GIBEAU LAURIE ANN
152 HIGHWOOD DR
FRANKLIN, MA 02038

FINCHER STEPHANIE ELLEN
1008 FRANKLIN CROSS RD
FRANKLIN, MA 02038

FRANKLIN TOWN OF
HIGH SCHOOL & POLICE STAT
355 EAST CENTRAL STREET
FRANKLIN, MA 02038

GILIBERTO SHARON A
1805 FRANKLIN CROSS RD
FRANKLIN, MA 02038

FINLEY JAMES E
1606 FRANKLIN CROSS RD
FRANKLIN, MA 02038

FRUIN PAUL
61 HIGHWOOD DR
FRANKLIN, MA 02038

GOGUEN JASON R
22 HIGHWOOD DRIVE
FRANKLIN, MA 02038

FITZGERALD JAMES F
FITZGERALD JENNIFER S
160 DAILEY DR
FRANKLIN, MA 02038

GARDENIER NICOLE C
72 HIGHWOOD DR
FRANKLIN, MA 02038

GOLDMAN JUDITH A
1001 FRANKLIN CROSS RD
FRANKLIN, MA 02038

GONZALEZ ORTIZ JOSE R
205 FRANKLIN CROSSING
FRANKLIN, MA 02038

HENRY MONA A TR
HENRY RTY TR OF 128HIGHWO
128 HIGHWOOD DR
FRANKLIN, MA 02038

HILL MATTHEW
808 FRANKLIN CROSS RD
FRANKLIN, MA 02038

GRADY JOHN P
2206 FRANKLIN CROSS RD
FRANKLIN, MA 02038

HERTZBERG PAUL A
HERTZBERG PHALLA
2010 FRANKLIN CROSS RD
FRANKLIN, MA 02038

HOFMANN AARON
MCKAY ERIKA
210 FRANKLIN CROSSING RD
FRANKLIN, MA 02038

GREELEY BRIAN ANTHONY
79 HIGHWOOD DRIVE
FRANKLIN, MA 02038

HICKEY EUGENE
20 HIGHWOOD DR
FRANKLIN, MA 02038

HOLT JOANNE
1202 FRANKLIN CROSSING RD
FRANKLIN, MA 02038

GREGORIO ALEXANDRE
2603 FRANKLIN CROSSING RD
FRANKLIN, MA 02038

HIGHWOOD CONDOMINIUM
C/O PIONEER PROPERTY
15 FLORENCE ST
FRANKLIN, MA 02038

HORNSBY MALCOLM
139 HIGHWOOD DR
FRANKLIN, MA 02038

GRIFFIN DIANE R MERCON
GRIFFIN THOMAS
182 HIGHWOOD DR
FRANKLIN, MA 02038

HIGHWOOD CONDOMINIUM
PIONEER PROPERTY MANAGEME
146 FOREST ST
FRANKLIN, MA 02038

HOWARD PETER F & KATHRYN
HOWARD FAMILY 2023 REALTY
71 PRISCILLA ST
FALMOUTH, MA 02536

GRIFFIN RYAN M
BARRON JULIANNE F
341 MUCCIARONE RD
FRANKLIN, MA 02038

HIGHWOOD CONDOMINIUM II
C/O PIONEER PROP. MGT
146 FOREST STREET
FRANKLIN, MA 02038

HSIEN FRANK
101 LEGATE HILL RD
LEOMINSTER, MA 01453

HANSEN HILLARY ANN
403 FRANKLIN CROSS RD
FRANKLIN, MA 02038

HIGHWOOD CONDOMINIUM II
PIONEER PROPERTY MANAGEME
146 FOREST ST
FRANKLIN, MA 02038

HUANG XIAONAN
173 HIGHWOOD DR
FRANKLIN, MA 02038

HARVEY LISA A TR
LISA A HARVEY REVOCABLE T
88 HIGHWOOD DR
FRANKLIN, MA 02038

HIGHWOOD CONDOMINIUM III
C/O LARKIN, JOHN B
164 HIGHWOOD DR
FRANKLIN, MA 02038

HUNT MARY-ELLEN TR
HUNT FAMILY REALTY TRUST
105 HIGHWOOD DR
FRANKLIN, MA 02038

HELMY JOSEPH GEORGE
FLANAGAN LORI
2207 FRANKLIN CROSS RD
FRANKLIN, MA 02038

HIGHWOOD CONDOMINIUM III
GREAT NORTH PROPERTY MGMT
138 HIGHWOOD DR
FRANKLIN, MA 02038

IACOBUCCI DIANE F TR
HIGHWOOD IRREVOCABLE TRUS
117 HIGHWOOD DR
FRANKLIN, MA 02038

HENDERSON YUDYD A
14 HIGHWOOD DR
FRANKLIN, MA 02038

HIGHWOOD CONDOMINIUM III
SHERI LEONE
138 HIGHWOOD DR
FRANKLIN, MA 02038

JANUK LLC
11 FLYNN RD
FRANKLIN, MA 02038

JANUS REAL ESTATE GROUP L
120 ORCHARD ST
MILLIS, MA 02054

KENT KRISTY L
408 FRANKLIN CROSSING RD
FRANKLIN, MA 02038

LANZILLO MEGAN M
LANZILLO ANTHONY J
81 HIGHWOOD DR
FRANKLIN, MA 02038

JOANNE FERULLO REALTY TRU
51 HIGHWOOD DR
FRANKLIN, MA 02038

KENZERSKI MARTIN
KENZERSKI KATHLEEN ANN
136 HIGHWOOD DR
FRANKLIN, MA 02038

LARKIN JOHN B
164 HIGHWOOD DR
FRANKLIN, MA 02038

JONES GARY F
CARLUCCI-JONES THERESA
381 OAKLAND PARKWAY
FRANKLIN, MA 02038

KERRIGAN GEORGE F III
155 HIGHWOOD DR
FRANKLIN, MA 02038

LARNIS DEIDRA
12 HIGHWOOD DR
FRANKLIN, MA 02038

KALLAPPA LOKESH
134 HIGHWOOD DR
FRANKLIN, MA 02038

KHOURY GEORGE EL
50 HIGHWOOD DR
FRANKLIN, MA 02038

LAU KAI
11 SCHAFFNER
DOVER, MA 02030

KANNAR SANDRA A
1003 FRANKLIN CROSSING RD
FRANKLIN, MA 02038

KIERCE ROBERT F & KAREN E
3 HERITAGE DR
FOXBORO, MA 02035

LAU KAI
11 SHAFFNER LN
DOVER, MA 02030

KANTHETI SRINIVASARAO
NALLURI UMADEVI
71 PALOMINO DR
FRANKLIN, MA 02038

KOZAK KRISTINA
1205 FRANKLIN CROSSING RD
FRANKLIN, MA 02038

LAWRENCE JAMES M
GRIFFIN MAUREEN P
181 IRONDEQUOIT RD
FRANKLIN, MA 02038

KARENSKI ALIAKSEI
KARENSKI LEONID
1204 FRANKLIN CROSSING RD
FRANKLIN, MA 02038

KRALIAN NATHAN & MEAGAN T
THE KRALIAN FAMILY TRUST
26 ROBIN HILL RD
DANVERS, MA 01923-1276

LEAMAN MATTHEW
61 SHORT ST
TAUNTON, MA 02780

KAUR KULJIT
CANDELARIA MANPREET KAUR
3 NORWAY FARMS DRIVE
NORFOLK, MA 02056

KUMAR AVINASH
405 FRANKLIN CROSSING UNIT 4-
5
FRANKLIN, MA 02038

LEE DANIEL & AGNES TAM TR
SD DANIEL LEE & AGNES TAM
17 WALNUT ST
MILLIS, MA 02054

KELLY CHRISTOPHER JOHN
1602 FRANKLIN CROSS RD
FRANKLIN, MA 02038

KUTLINA ELENA
54 HIGHWOOD DR
FRANKLIN, MA 02038

LEE KEVIN F
1009 FRANKLIN CROSS RD UNIT 9
FRANKLIN, MA 02038

KENNEDY JENNY L
2202 FRANKLIN CROSS RD
FRANKLIN, MA 02038

LABIB NADIA K TR
HIGHWOOD DR REALTY TRUST
30 GRYZBOSKA CIR
FRAMINGHAM, MA 01702

LEE S D DANIEL & AGNES TR
LEE & TAM-LEE REVOCABLE T
17 WALNUT ST
MILLIS, MA 02054

LEEAR BRYAN
1010 FRANKLIN CROSS RD
FRANKLIN, MA 02038

MADADI AMIRHOSSEIN
AHI HOURIEH
1410 FRANKLIN CROSS RD
FRANKLIN, MA 02038

MATHEW A. & VIDYA M.D.SOU
ARUN & VIDYA LIVING TR
100 HIGHWOOD DR
FRANKLIN, MA 02038

LENTINI ERICA
2405 FRANKLIN CROSSING RD
FRANKLIN, MA 02038

MAGUIRE KERRY
1208 FRANKLIN CROSS RD
FRANKLIN, MA 02038

MATHEW ARUN TR
108 HIGHWOOD DRIVE REALTY
11 EMPIRE DR
FRANKLIN, MA 02038

LIBSON MARY KIM
1007 FRANKLIN CROSS RD
FRANKLIN, MA 02038

MAHONEY DIANNE W
35 VILLAGE GREEN
DENNIS, MA 02638

MAZZEO PAUL C
40 HIGHWOOD DR
FRANKLIN, MA 02038

LISS REBECCA L
67 HIGHWOOD DR
FRANKLIN, MA 02038

MAKACI AMINE
2012 FRANKLIN COSSING RD
FRANKLIN, MA 02038

MCALEAR STEPHEN H
DELZOPPO MARIE A
412 FRANKLIN CROSS RD
FRANKLIN, MA 02038

LIU KANG
LIU NA
161 HIGHWOOD DR
FRANKLIN, MA 02038

MALDONADO JEANETH
1809 FRANKLIN CROSS RD
FRANKLIN, MA 02038

MCCARTHY CHRISTOPHER F
MCCARTHY JODI E
114 HIGHWOOD DR
FRANKLIN, MA 02038

LUNN DEBORAH A
1402 FRANKLIN CROSS RD
FRANKLIN, MA 02038

MANUEL MAXIME
106 HIGHWOOD DR
FRANKLIN, MA 02038

MCCAUL JOSEPH B
209 FRANKLIN CROSSING RD -
UNIT 9
FRANKLIN, MA 02038

MACALUSO SANDRA
107 HIGHWOOD DR
FRANKLIN, MA 02038

MARKHAM JENNIFER
MARKHAM AUBREY
153 HIGHWOOD DR
FRANKLIN, MA 02038

MCDONALD DEBRA A
CLAYMAN BRYAN S
129 QUAKER HIGHWAY
UXBRIDGE, MA 01569

MACASKILL KRISTIN
86 HIGHWOOD DR
FRANKLIN, MA 02038

MARTIN TIMOTHY
HURLEY MARYELLEN
40 TURNER ST
NORFOLK, MA 02056

MCGUIRE DIANE C
104 HIGHWOOD DR
FRANKLIN, MA 02038

MACKAY SARAH
113 HIGHWOOD DR
FRANKLIN, MA 02038

MARTINI MORGAN
6 CEDAR CREEK
ATTLEBORO, MA 02703

MCLELLAN JOHN
2609 FRANKLIN CROSS RD
FRANKLIN, MA 02038

MACKINNON CAROLINE
5 LOVERING ST
MEDWAY, MA 02053

MARTINI NICHOLAS R
605 FRANKLIN CROSSING RD
FRANKLIN, MA 02038

MCNULTY MATTHEW
MCNULTY MARTA
8 BRETTS FARM RD
NORFOLK, MA 02056

MCSHANE JESSICA
83 HIGHWOOD DR
FRANKLIN, MA 02038

MOHAMMAD DIALA
MOUSA AWS
2610 FRANKLIN CROSSING RD
FRANKLIN, MA 02038

MUNRO SAMANTHA
41 HIGHWOOD DR
FRANKLIN, MA 02038

MCVICAR VICTORIA
MCVICAR BRITNEY L
172 HIGHWOOD DR
FRANKLIN, MA 02038

MONAHAN CORINNE M TR
CORINNE M MONAHAN 2021 TR
35 NORTHGATE RD
WELLESLEY, MA 02481

MURPHY EDWARD J & SHARON
ES MURPHY LIVING TRUST
2406 FRANKLIN CROSSING RD
FRANKLIN, MA 02038

MEADOWS JACQUELINE
103 HIGHWOOD DR
FRANKLIN, MA 02038

MORGAN JONATHAN A
MORGAN JENNIE M
2003 FRANKLIN CROSS RD
FRANKLIN, MA 02038

MYERS STACEY
2208 FRANKLIN CROSS RD
FRANKLIN, MA 02038

MEKA UDAYALAKSHMI
809 FRANKLIN CROSSING
FRANKLIN, MA 02038

MORONTA RAUL L
MORONTA GISSELL
43 HIGHWOOD DR
FRANKLIN, MA 02038

NAG KAUSHIK
PRIYADARSHINI CHINMAYEE
159 HIGHWOOD DR
FRANKLIN, MA 02038

MENESES JOSE A
2602 FRANKLIN CROSSING RD
FRANKLIN, MA 02038

MORRISSEY BRIAN E
56 HIGHWOOD DR
FRANKLIN, MA 02038

NECCHI CHRISTOPHER
78 HIGHWOOD DR
FRANKLIN, MA 02038

MERCADANTE MICHAEL
94 WALNUT ST
PLAINVILLE, MA 02762

MOSCATELLI ANGELINA
180 HIGHWOOD DR
FRANKLIN, MA 02038

NECCHI CHRISTOPHER A
37 HIGHWOOD DR
FRANKLIN, MA 02038

MILOT WENDY
137 HIGHWOOD DR
FRANKLIN, MA 02038

MUCCIARONE JUDITH M
JOLLY, LUANA M KILEY, LIS
51 EVERETT ST
FRANKLIN, MA 02038

NEELY RICHARD E
NEELY STEPHEN
1004 FRANKLIN CROSS RD
FRANKLIN, MA 02038

MISHAL SWARUP SHANKAR
1612 FRANKLIN CROSS RD
FRANKLIN, MA 02038

MUDREY LAWRENCE J
MUDREY SUSAN E
178 HIGHWOOD DR
FRANKLIN, MA 02038

NEVES-FRANKLIN CROSSING R
NEVES JOSEPH TR
1812 FRANKLIN CROSSING RD
FRANKLIN, MA 02038

MISSAL MONA
28 HIGHWOOD DR
FRANKLIN, MA 02038

MULLANEY BRIAN G
14 COTTAGE ST
MEDWAY, MA 02053

NG SHERRI
2607 FRANKLIN CROSSING RD
FRANKLIN, MA 02038

MITCHELL JON C
MITCHELL ESTER
16 HIGHWOOD DR
FRANKLIN, MA 02038

MULLINS PHILIP RYAN
1810 FRANKLIN CROSSING RD
FRANKLIN, MA 02038

NOAH MICHAEL
2212 FRANKLIN CROSSING RD
FRANKLIN, MA 02038

NORMAN TYLER
131 HIGHWOOD DR
FRANKLIN, MA 02038

PATETE JOHN D
PATETE EILEEN
33 LAKESHORE DR
BELLINGHAM, MA 02019

POTTER THOMAS W
47 HIGHWOOD DR
FRANKLIN, MA 02038

NUNEZ SHANNON LYN
171 HIGHWOOD DR
FRANKLIN, MA 02038

PEARCE MATTHEW M
PETERSON ERIN A
127 HIGHWOOD DR
FRANKLIN, MA 02038

PRATT CATHERINE
1802 FRANKLIN CROSS RD
FRANKLIN, MA 02038

OBRIEN ANDREW
2011 FRANKLIN CROSSING
FRANKLIN, MA 02038

PELL JOHN P
610 FRANKLIN CROSS RD
FRANKLIN, MA 02038

PRESKENIS DONNA M
601 FRANKLIN CROSS RD
FRANKLIN, MA 02038

OCONNELL ANDREW J
135 HIGHWOOD DR
FRANKLIN, MA 02038

PELLEGGRI GEORGE E & JANE
PELLEGGRI FAMILY REALTY TR
98 JORDAN RD
FRANKLIN, MA 02038

PRIDHAM JASON E
PRIDHAM JESSICA A
706-C RIDGEFIELD CIR
CLINTON, MA 01510

OZGUR CEM
45 HIGHWOOD DR
FRANKLIN, MA 02038

PEPERO LAWRENCE R
PEPERO DIANE M
144 HIGHWOOD DR
FRANKLIN, MA 02038

PURCELL JOSEPHINE A
714 PLEASANT ST - UNIT 2
NORWOOD, MA 02062-4685

PAN CHIN YI
LIANG YUN P
1 JR'S LN
FRANKLIN, MA 02038

PERDUE MELODY
PERDUE, PATRICK L MALIK,
90 HIGHWOOD DR
FRANKLIN, MA 02038

QUAN LESTER
811 FRANKLIN CROSSING RD
FRANKLIN, MA 02038

PANTER MICHELLE MARIE
145 HIGHWOOD DR
FRANKLIN, MA 02038

PETRILLO EMILIO
17 HIGHWOOD DR
FRANKLIN, MA 02038

QUEZADA ARIELIS
CARDONA JUSTIN
202 FRANKLIN CROSS RD
FRANKLIN, MA 02038

PAPSI STEPHEN G
PAPSI FRANCES J
124 HIGHWOOD DR
FRANKLIN, MA 02038

PINI PATRICK
57 HIGHWOOD DRIVE
FRANKLIN, MA 02038

QUINN PATRICK J
611 FRANKLIN CROSSING
FRANKLIN, MA 02038

PARARAS DIMITRI
2408 FRANKLIN CROSSING RD
FRANKLIN, MA 02038

PLANTE LISA A
130 HIGHWOOD DR
FRANKLIN, MA 02038

RAJAGOPAL RAJASEKARAN
166 HIGHWOOD DR
FRANKLIN, MA 02038

PATEL PRIYA J
48 HIGHWOOD DR
FRANKLIN, MA 02038

POISSON CHERYL A
609 FRANKLIN CROSS RD
FRANKLIN, MA 02038

RAJAGOPAL RAJASEKARAN
2 DENA DRIVE
FRANKLIN, MA 02038

RAMALINGESH SRILAKSHMI BI
GANDLA UMA MAHESHWAR
30 HIGHWOOD DR
FRANKLIN, MA 02038

RICHARD HARLOW INVESTMENT
C/O RICHARD HARLOW - MANA
120 ORCHARD ST
MILLIS, MA 02054

SACKETT ROBERT A
SACKETT MARY LISA
119 HIGHWOOD DR
FRANKLIN, MA 02038

RAVREBY SANDRA L
1207 FRANKLIN CROSS RD
FRANKLIN, MA 02038

ROBBINS LINDA B
146 HIGHWOOD DR
FRANKLIN, MA 02038

SANTANIELLO KATHRYN
SANTANIELLO SHELLY
602 FRANKLIN CROSS RD
FRANKLIN, MA 02038

RAYMOND ANGELIKA U
42 HIGHWOOD DR.
FRANKLIN, MA 02038

ROCHA JOSE MAGNO
607 FRANKLIN CROSS RD
FRANKLIN, MA 02038

SANTOS VALTER DIAS
606 FRANKLIN CROSS RD
FRANKLIN, MA 02038

RECHT CHARLES
2210 FRANKLIN CROSSING RD
FRANKLIN, MA 02038

ROLLINS NATHAN
2409 FRANKLIN CROSSING
FRANKLIN, MA 02038

SASA-1 GLOBAL ENDEAVORS L
PO BOX 71
SOUTHBOROUGH, MA 01772

REDFERN LAUREN K
140 HIGHWOOD DR
FRANKLIN, MA 02038

ROMANO ROSA
ROMANO ANTONIO
65 TILTING ROCK RD
WRENTHAM, MA 02093

SASTER CAROL M TR
SASTER FAM 2017 IRREVOCAB
123 HIGHWOOD DR
FRANKLIN, MA 02038

REGAN JOHN
REGAN MOIRA
162 HIGHWOOD DR
FRANKLIN, MA 02038

ROSE PATRICK M
SWEENEY BRIDGET A
1412 FRANKLIN CROSSING RD
FRANKLIN, MA 02038/

SAVOIE ERNEST JOSEPH TR
ERNEST SAVOIC LIVING TRUS
255 STEELE RD UNIT 3
EASTHAM, MA 02642

RENAGHAN JOAN M
404 FRANKLIN CROSS RD
FRANKLIN, MA 02038

ROSEN PATRICIA A
1611 FRANKLIN CROSS RD
FRANKLIN, MA 02038

SAWYER ALLAN W
1406 FRANKLIN CROSS RD
FRANKLIN, MA 02038

RICE KAREN A
64 HIGHWOOD DR BLDG 8
FRANKLIN, MA 02038

ROY ADITI TR
ROY FAMILY REALTY TRUST
109 HIGHWOOD DR
FRANKLIN, MA 02038

SEKULA DONNA M
49 HIGHWOOD DR
FRANKLIN, MA 02038

RICHARD HARLOW INVESTMENT
120 ORCHARD ST
MILLIS, MA 02064

RYAN JOHN T
SIMONE MICHELE V
133 HIGHWOOD DR
FRANKLIN, MA 02038

SELLARS KARA L
76 STONE RIDGE RD
FRANKLIN, MA 02038

RICHARD HARLOW INVESTMENT
C/O RICHARD HARLOW
120 ORCHARD ST
MILLIS, MA 02054

RYAN MICHAEL F
806 FRANKLIN CROSSING RD
FRANKLIN, MA 02038

SHARIFI AWESTA
1002 FRANKLIN CROSS RD
FRANKLIN, MA 02038

SHEA MARYELLEN
116 HIGHWOOD DR
FRANKLIN, MA 02038

STUMM JANET WILEY
132 HIGHWOOD DR
FRANKLIN, MA 02038

TOLLAND JEAN M TR
JEAN TOLLAND REVOCABLE TR
148 HIGHWOOD DR
FRANKLIN, MA 02038

SHROFF TAPAN
SHROFF RAJINI
801 FRANKLIN CROSS RD
FRANKLIN, MA 02038

SULLIVAN ELLEN
1407 FRANKLIN CROSS RD
FRANKLIN, MA 02038

TOMAO JOSEPH A
1604 FRANKLIN CROSS RD
FRANKLIN, MA 02038

SIMON KIRK D
12 MARGARETS CV
FRANKLIN, MA 02038

SULLIVAN ELLEN S
372 LAMPLIGHTER DR
MARCO ISLAND, FL 34145-4542

TRABOULSSI JOSEPH A & CHR
TRABOULSSI FAMILY REVO LI
415 THURSTON ST
WRENTHAM, MA 02093

SIWRUK GARY A
1212 FRANKLIN CROSS RD
FRANKLIN, MA 02038

SULLIVAN PATRICIA A
2204 FRANKLIN CROSS RD
FRANKLIN, MA 02038

TRI-COUNTY REG VOCATIONAL
147 POND ST
FRANKLIN, MA 02038

SKY ALAN
1404 FRANKLIN CROSSING RD
FRANKLIN, MA 02038

SWEDBERG PAUL R
SWEDBERG DARLEEN C
10 LUCIUS ST
FRANKLIN, MA 02038

TURIEO CHRISTOPHER E
2004 FRANKLIN CROSS RD
FRANKLIN, MA 02038

SLOTNICK, BRUCE E TR CASS
SLOTNICK FAMILY IRREVOC T
2605 FRANKLIN CROSSING RD
FRANKLIN, MA 02038

TARQUI MULLUNI LUZ
TARQUI MULLUNI YANITZA
85 HIGHWOOD DR
FRANKLIN, MA 02038

TURPIN ZACHARY D
CAPEN JILLIAN RAE
115 HIGHWOOD DR
FRANKLIN, MA 02038

SOARES STEPHEN
117 TURNPIKE ST
SOUTH EASTON, MA 02375-1123

TAYLOR SHAD E
TAYLOR AUDRA L
160 HIGHWOOD DR
FRANKLIN, MA 02038

TYNAN EDWARD L/E
C/O TYNAN GLEN
26 ASPEN AVE
GRAFTON, MA 01560

ST JEAN SHAWNA A
84 HIGHWOOD DR
FRANKLIN, MA 02038

THOMPSON KEVIN J
RENDON-THOMPSON ESTHER
2211 FRANKLIN CROSSING RD
FRANKLIN, MA 02038

UDDIN MD SALAH
MAHMOOD SHAJEDA A
1808 FRANKLIN CROSSING RD
FRANKLIN, MA 02038

ST JOHNS EPISCOPAL CHURCH
237 PLEASANT ST
FRANKLIN, MA 02038

THORNHILL JAMES JR & SUZA
ONE JUNA WAY REALTY TRUST
177 HIGHWOOD DR
FRANKLIN, MA 02038

URBANO MARIA A
1211 FRANKLIN CROSS RD
FRANKLIN, MA 02038

STEVENS JONATHAN
1405 FRANKLIN CROSS RD
FRANKLIN, MA 02038

TILLGREN MICHELLE
PETROZZI MICHAEL
175 HIGHWOOD DR
FRANKLIN, MA 02038

VERSPRILLE ANNE
802 FRANKLIN CROSS RD
FRANKLIN, MA 02038

VILLAFANE GUILLERMO
805 FRANKLIN CROSS RD - UNIT 5
FRANKLIN, MA 02038

WILSON MARGARET J
21 HIGHWOOD DR
FRANKLIN, MA 02038

VILLIARD PAUL J
409 FRANKLIN CROSS RD
FRANKLIN, MA 02038

WOLFE KEVIN T
2401 FRANKLIN CROSS RD
FRANKLIN, MA 02038

VINLUAN ROBERTO
VINLUAN AMELIA
208 WARREN ST
NEEDHAM, MA 02492

WOODRING DONALD M
WOODRING ANNE MARIE
147 HIGHWOOD DR
FRANKLIN, MA 02038

VLADYKA JOY
31 HIGHWOOD DR
FRANKLIN, MA 02038

WRIGHT ELIZABETH & JESSIC
612 FRANKLIN XING REALTY
612 FRANKLIN CROSS RD
FRANKLIN, MA 02038

VOULGARIS JOSEPH P
11 EMILIO DR
FRANKLIN, MA 02038

WYLLIE WAYNE J
118 HIGHWOOD DR
FRANKLIN, MA 02038

WALKER LINDA M
126 HIGHWOOD DR
FRANKLIN, MA 02038

YERGATIAN VERNON C
80 HIGHWOOD DR
FRANKLIN, MA 02038

WALSH KAREN F
33 HIGHWOOD DR
FRANKLIN, MA 02038

YOUNIS MICHELLE
63 HIGHWOOD DR
FRANKLIN, MA 02038

WARDROP KEN O
WARDROP LESLIE K
346 OAK ST
FRANKLIN, MA 02038

YUAN WENMIN
KUAI RUI
1409 FRANKLIN CROSSING RD
FRANKLIN, MA 02038

WELLING STUART
94 HIGHWOOD DR
FRANKLIN, MA 02038

ZHELEZCHEVA DESISLAVA
168 HIGHWOOD DR
FRANKLIN, MA 02038

WESMAN LAURIE
WESMAN TODD
122 HIGHWOOD DR
FRANKLIN, MA 02038

ZIEGLER CLAUDE R J
608 FRANKLIN CROSS RD
FRANKLIN, MA 02038

Wetland Replication Plan – *dated January 31, 2024*

Prepared by Goddard Consulting, LLC

January 31, 2024

WETLAND REPLICATION PLAN
Off Veterans Memorial Drive

Map 259 Parcel 007-002
Franklin, MA

PURPOSE:
NOI Supportive Document

PREPARED FOR:
Guerriere & Halnon
55 West Central Street
Franklin, MA 02038

Table of Contents:

- I. Existing Isolated Vegetated Wetland**
- II. Wetland Replication Area**
 - A. Location**
 - B. General Installation Procedure**
 - C. Planting Plan**
 - D. Conclusions**

I. EXISTING CONDITIONS

The subject parcel is a forested site located off Veteran Memorial Drive and Irondequoit Rd in Franklin MA (Map 259 Parcel 007-002). The lot is approximately 16.89 acres and consists of an oak/white pine upland forested area with three Isolated Vegetated Wetlands (IVWs) two IVWs on site and one located adjacent to the site. The two larger IVWs located on site (flagged with series GC1-26 and GC100-126) are located along the western property boundary and are not proposed to be impacted. The smaller IVW (flagged with series I 1-11) is located at the end of Irondequoit Rd along the northern property line which is to serve as the site access. All resources on site were confirmed with an ORAD issued by the Franklin Conservation Commission on September 7, 2023. The three IVWs are not classified as Isolated Land Subject to Flooding resources and are jurisdictional under the local bylaw only.

Due to the location of the IVW at the end of Irondequoit Rd, impact to this wetland is unavoidable. The proposed roadway is designed to be the minimum width practicable so to minimize the potential impact. The impacted IVW will be replicated at a 2:1 ratio between the two other IVWs along the western property line. To ensure in-kind replication, the native tree and shrub species found within the IVW (red maple trees, sweet pepper bush and wetland ferns/seed mix) are proposed to be planted and seeded within the replication area.

II. WETLAND REPLICATION AREA

A. LOCATION:

The proposed replication area measures 1,960 SF and is located between the two larger IVWs along the western property line (see attached figure). The proposed 1,960 SF wetland replication area allows for a 2:1 ratio of the 980 sf of IVW wetland fill; meeting all local performance standards. Erosion controls will be installed along the limit of work to ensure adequate protection to the adjacent wetland resource area.

The location of the replication was selected for the following reasons:

- The area can be easily accessed via the uplands located to the east of the wetland areas
- The replication area directly abuts two other IVWs with similar vegetation and soil conditions as the impact area.

- This area within the forest canopy was desirable for wetland replication due to the shade from surrounding large trees which will keep the wetland environment at a natural, cool temperature.
- The nearby topography of the uplands is a slight incline from the wetlands. Therefore, only 1-2 feet of grading will need to occur to reach desirable depths necessary for hydric soil conditions.
- This location allows the replicated wetland to fulfill more functions and values on a greater scale than the existing IVW, particularly in the sense of flood control due to its greater size and mild slope. The replication area will provide protection of the following benefits: public or private water supply, ground water supply, flood control, storm damage prevention, prevention of pollution, and plant or wildlife habitat.

B. GENERAL INSTALLATION PROCEDURES:

Supervision: All work within the replication area shall be supervised by a qualified wetland scientist with a minimum of five years' experience. The supervisor shall submit monitoring reports to the Conservation Commission as described below. Reports shall contain details of all work performed and photographs of completed conditions.

Timing: Work shall take place ideally when the wetland impact area is not saturated. If necessary, a dewatering plan shall be approved by the Conservation Commission. The planting of the replication area should be accomplished during the spring or fall growing seasons (between April and June or between September and November). The replication area grading is advised not to commence unless the contractor can guarantee completion of the work within the replication area within the same season.

Step 1: Stake Limits of Work, Confirm Wetland Flags in Place & Install ECB – At Replication Area

Staking out limits of work and confirmation of wetland flags are planned for the replication areas. Erosion control barriers shall then be installed in the form of staked siltation fence and/or mulch sock (or similar invasive-free barrier) placed at the limit of work for the replication area. These will remain in place and be maintained until the areas are completely stabilized and then may be removed after approval of the Conservation Commission. Wetland scientist shall have authority to require additional erosion control measures if deemed necessary.

Step 2a: Identify Shrubs, Woody Debris, and Boulders to be re-used in Replication Area

The wetland scientist shall identify and flag any native wetland shrubs within the replication area and the IVW impact area that may be dug up and stockpiled for use as additional plantings in the replication area. Any flagged specimens shall be removed and stockpiled in a designated area outside the replication area. Any large woody debris (rotting logs and tree stumps), moss covered boulders/rocks, ferns (royal fern, sensitive fern, cinnamon fern), and other ground cover shall also be identified and flagged for stockpiling and subsequent addition to the replication area. Wetland trees that lie or stand along the edge of the replication area may be preserved at the discretion of the wetland scientist.

Step 2b: Remove Trees and Vegetation

Once flagged trees, shrubs and woody debris specimens have all been removed and stockpiled, clear and remove all remaining vegetation within the replication area in preparation for excavation and grading.

Step 3: Excavation of Replication Area

An excavator or backhoe shall remove existing soils up to the edge of the proposed replication area boundary, to a depth at which redoximorphic features become visible in the C-horizon at the soil surface and at least one foot below proposed final grade, all of which shall be supervised and directed by the wetland scientist. Final grading will be at the same elevation as the adjacent IVWs areas to reach favorable hydrological conditions.

Step 4: Final Grading of Replication Area

Upon removal of existing soils down to the proper depth (as determined by the wetland scientist on site during the removal process), if soils are not sufficient, supplemental soils shall be imported, sourced from composted organic materials, and shall consist of a 50:50 mix of loam and organic material with an organic content between 12 and 20%. Topsoil shall be placed within the replication area to a depth 6-12" and even with the surrounding proposed elevation on design plan, to be determined by the supervising wetland scientist. Final grade shall be confirmed to be proper by the wetland scientist prior to plantings. Placement of soil shall be such that no equipment drives over or compacts placed soils. Final grading will result in micro relief of pits and mounds. Topography will create areas that pool and flood during heavy rain events and also see water near the surface during the wet season.

Step 5: Place Woody Debris and Boulders

If Woody debris, snags, and moss-covered boulders currently lay on site in the proposed replication area, these shall be preserved and randomly placed throughout the replication area to provide cover for wildlife.

Step 6: Planting

Precise citing of plants may be determined by the wetland scientist in the field prior to installation. All plantings (reference the planting list from section C) shall be distributed randomly throughout the area; trees spaced at 10-15' on center; shrubs spaced at 6-12' on center. Shrubs shall be planted in clumps of 3 the same species. As a rule, plants of the same species will be placed in groupings that more closely mimic natural conditions. Trees shall be planted on mounds and shrubs in depressions. Stockpiled shrubs will be placed first. All other plantings will be removed from burlap sacks, wire cages and plastic containers prior to planting. Each plant will have its roots loosened prior to planting to encourage root growth away from the planting bulb. Leaf litter shall be spread throughout area if available. Wetland seed mix shall be scattered evenly by hand throughout the replication area. Once all work is complete an erosion control barrier will be installed to enclose the replication area on the access side of the replication area.

Step 7: Erosion Controls Removal

Once the replication area is stable, a request shall be submitted to the Conservation Commission to remove the erosion controls around the wetland replication areas. Upon approval of stabilization, erosion controls shall be removed promptly, and any significant disturbance shall be seeded with a wetland seed mix as specified in section C.

Step 8: Replication Monitoring

a. **Seasonal monitoring reports** shall be prepared for the replication areas by a qualified wetland scientist for a period of 2 additional years after installation or every year until a COC is issued by the Franklin Conservation Commission. This monitoring program will consist of early summer and early fall inspections and will include photographs and details about the vitality of the replication areas. Monitoring reports shall be submitted to the Commission by December 15th of each year. Monitoring reports shall describe, using narratives, plans, and color photographs, the physical characteristics of the replication areas with respect to stability, soil characteristics (i.e. horizons, depths, texture, percent gravel and rock, organic matter, Munsell hue, value and chroma, consistence and evidence of hydrologic influence), survival of vegetation and plant mortality, aerial extent and distribution, species diversity and vertical stratification (i.e. herb, shrub and tree layers). Invasive species will be documented if present, monitored and removed.

b. **At least 75% of the surface area** of the replication areas shall be re-established with wetland plant species within two growing seasons. If the replication areas does not meet the 75% re-vegetation requirement by the end of the second growing season (after installation), the Applicant shall submit a remediation plan to the Commission for approval that will achieve replication goals, under the supervision of a Wetland Specialist. This plan must include an analysis of why the areas have not successfully re-vegetated and how the Applicant intends to resolve the problem.

C. PLANTING LIST:
Proposed Plantings for Replication Area 1 (1960 s.f.)

Common Name	Scientific Name	Number	Size
Trees (n= 15)*			
Red Maple (FAC)	<i>Acer rubrum</i>	4	4-5'
Shrubs (n=33)*			
Highbush Blueberry (FACW)	<i>Vaccinium corymbosum</i>	8	3 gal. pot
Sweet Pepperbush (FAC)	<i>Clethra alnifolia</i>	7	3 gal. pot
Seed Mix			
New England Wetland Plants WETMIX or equivalent*	Replication area	1.5	1 lbs

*Planting species and seed mixes may be substituted with Conservation Commission approval with similar native species with the same wetland indicator status if certain species are unavailable.

D. CONCLUSIONS

The IVW impact area will be mitigated at a ratio of 2:1 with the final replication area. All local, state and federal statutory interests and performance standards have been protected and will be met by the project, as described above. The wetland replication plan has been designed to replicate the environmental attributes of the Isolated Wetland as closely as possible and to meet or exceed the benefits to local wildlife. The native trees and shrubs found growing within the IVW are proposed within the replication area for even greater species diversity. Stockpiled shrubs and soils will be transported and used within the replication area.

Sincerely,
 Goddard Consulting, LLC.



Nicole Hayes, PWS
 Senior Wetland Scientist

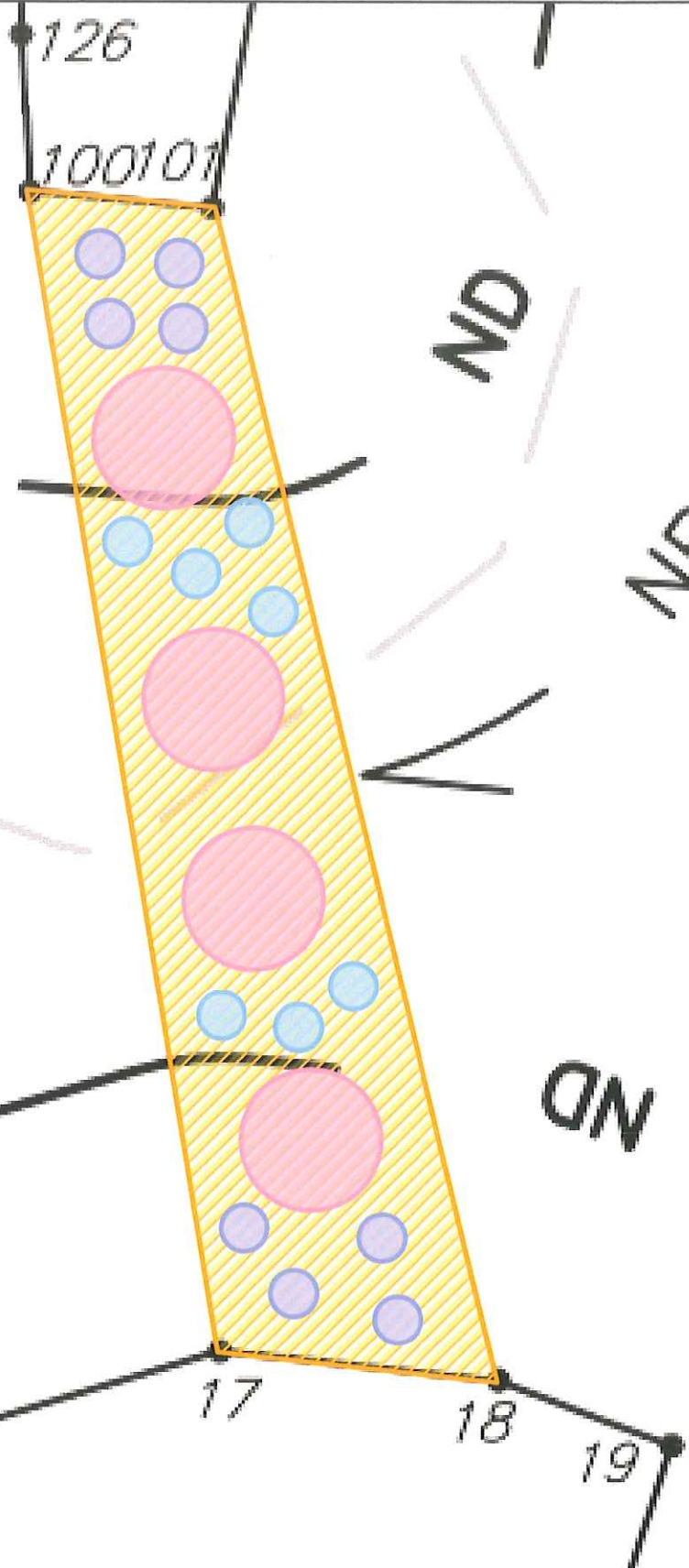

Legend

-  Replication Area
-  Ferns & Wetland Seed Mix = +/- 1,960 SF
- Trees: 4 Total
 -  Red maple (*Acer rubrum*): 4
- Shrubs: 15 Total
 -  Highbush blueberry (*Vaccinium corymbosum*): 8
 -  Sweet pepperbush (*Clethra alnifolia*): 7

GIS graphics displayed on a site plan titled Resource Area Plot Plan, prepared by Guerriere & Halnon, Inc., dated 08/10/2023

Date:
01/31/2024

GC Job Number:
101-078

Wetland Replication Plan

0 7.5 15 Feet

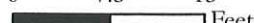

1" = 15'



Veterans Memorial Drive
Franklin, MA 02038

Property ID: 259-007-002

Franklin Conservation Commission
355 E. Central Street
Franklin, MA 02038

Re: Veterans Memorial Drive and Irondequoit Rd, Franklin, MA

Dear Franklin Conservation Commission,

1.0 REGULATORY COMPLIANCE WITH FRANKLIN'S WETLANDS PROTECTION BYLAW

1.1 FUNCTIONS AND CHARACTERISTICS STATEMENT – PROJECT COMPLIANCE

In accordance with §7.10.1 of the Town of Franklin Conservation Commission Regulations, please find below a summary of the proposed project's impacts on the functions and characteristics of wetlands. It is Goddard's opinion that the project will have no significant individual or cumulative adverse effects on these functions and characteristics.

1. **Public Water Supplies** – The nearest public well is located more than 1.5 miles from the subject site to the West. No adverse effects are anticipated to public water supplies.

2. **Private Water Supplies** – According to MassDEP's Well Drilling Database, the nearest private well that could be identified is located approximately 1500 feet away from the site. This distance is significantly greater than any setbacks for wells identified in MassDEP's Private Well Guidelines.

3. **Groundwater** – The proposed roadway will adhere to all federal, state and local laws and policies utilizing best management practices and erosion controls to protect groundwater.

4. **Flood Control** – No work of any kind is proposed in any FEMA Flood Zones. Compensatory storage is not required to be addressed.

5. **Erosion and Sedimentation** – Erosion and sedimentation controls including entrenched silt fencing and/or sediment logs will be in place and maintained in good condition throughout construction activities. Erosion controls are proposed at the limit of work.

6. **Storm Damage Prevention** – The attached stormwater report demonstrates compliance with pre and post runoff rates for each respective storm event. In addition, the system will attenuate peak rates of runoff, resulting in less damaging stormwater runoff for the site and surrounding areas.

7. **Water Quality** – There are no surface waters associated with the IVWs onsite. Stormwater runoff from portions of the proposed development area will be directed to ditches and swales, delivering water to detention basins to prevent direct discharge of untreated stormwater to any wetland resource areas or offsite. The design of the proposed stormwater management system is such that there shall be no increase in peak flows resulting from development of the site.

8. **Water Pollution Control** – During construction, erosion and sediment controls, typically in the form of entrenched silt fence and sediment logs, will minimize any potential water pollution. The proposed stormwater

management system has been designed to handle the 2-, 10-, 25- and 100-year storms, with no increases in peak runoff rates for the site. Vegetated swales deliver stormwater to on-site detention basins. As such, no biological pollution is expected to occur as a result of construction activities or post-construction use of the site.

9. **Fisheries** – No work is proposed adjacent to ponds, perennial streams, or any other fishery habitats.

10. **Shellfish** - Not applicable in Franklin, inland resource areas only.

11. **Wildlife Habitat** – In Goddard’s opinion, the natural community present on the site within the work area, as described in MassWildlife’s Classification of the Natural Communities of Massachusetts, should be classified as a White Pine – Oak Forest. This type of natural community is assigned an S Rank of S5, which means it is “demonstrably secure in Massachusetts” and is “common, widespread, and abundant.”

According to MassWildlife’s BioMap, the work area is not considered either Core Habitat (areas that are critical for the long-term persistence of rare species, exemplary natural communities, and resilient ecosystems) or Critical Natural Landscape (large landscape blocks that are minimally impacted by development and buffers to core habitats and coastal areas).

12. **Rare Species Habitat (including rare plant species)** – No rare species are mapped on or within a few miles of the project site. There are no mapped potential or certified vernal pools onsite or on the parcels adjacent to the site.

13. **Agriculture** – The project site is not located in proximity to any agricultural operations.

14. **Aquaculture** – There are no aquaculture operations on or near the project site.

15. **Recreation** – The site does have walking paths due to adjacent residential areas.

1.2 I SERIES ISOLATED VEGETATED WETLAND – BYLAW COMPLIANCE

Due to the I-Series Isolated Vegetated Wetland located within the parcel’s access area off Irondequoit Rd, the project is not able to avoid this locally regulated IVW resource area. As such, the I-series Isolated Wetland is proposed to be filled and replicated to assist with the project design and maintain a viable project with the site. As a resource area subject to the local bylaw is proposed to be filled and replicated, compliance with the local bylaw is demonstrated below.

According to Chapter 181, Section 8, paragraph 2 of the local bylaw,

To prevent wetlands loss, the Commission shall require applicants to avoid wetlands alteration wherever feasible; shall minimize wetlands alteration; and, where alteration is unavoidable, shall require full mitigation. The Commission may authorize or require replication of wetlands as a form of mitigation, but only with adequate security, professional design and monitoring to assure success, because of the high likelihood of failure of replication.

Impacts to wetland resource areas have been avoided on the site wherever feasible. No impacts to BVW are proposed with the project. However, due to the location of the GC I-Series Isolated Wetland within the site access area filling and relocating the wetland is required to achieve the project goals. To ensure proper replication of the area is achieved, the Isolated Vegetated wetland is proposed to be filled at a 2:1 ratio to ensure a net increase to wetland cover is

achieved with post-construction conditions. Goddard has submitted a wetland replication plan. The plan outlines all necessary steps and includes the supervision of a wetland scientist to ensure the correct design and likelihood of success of the replicated wetland.

According to Section 5 of the Franklin Conservation Commission Regulations, the conservation commission may grant a variance if they find that it is necessary to request the work outlined in the variance request, and that the proposed work will not result in adverse effects to the interests outlined in the local bylaw. For compliance purposes, the variance procedure is outlined below:

5. TOWN OF FRANKLIN CONSERVATION COMMISSION REGULATIONS - VARIANCE PROCEDURE

5.1. The Commission may grant a variance from these regulations upon a showing by the applicant that any proposed work, or its natural and consequential impacts and effects, will not have any adverse effect upon any of the interests protected in Chapter 181 of the Town of Franklin Wetlands Protection Bylaw. It shall be the responsibility of the applicant to provide the Commission, in writing, with any and all information, which the Commission may request, in order to enable the Commission to ascertain such adverse effects. The failure of the applicant to furnish any information, which has been requested, shall result in the denial of a request for a variance pursuant to the applicable subsection of this regulation

5.2. The Commission may grant a variance from these regulations when it is necessary to avoid so restricting the use of the property as to constitute an unconstitutional taking without compensation. If the Commission receives an application for a variance pursuant to an applicable subsection of the regulation, the Commission may request an opinion from the Town Counsel as to whether the application of these regulations to a particular project will result in such a taking without compensation.

5.3. Variance process: To request a variance, the applicant shall submit a variance request in writing at the time of the application for the Notice of Intent or Request for Determination of Applicability. The request shall explain why the variance is needed and shall describe in detail how the project can be completed without significant adverse impacts on the functions and characteristics of the resource area. Such detail must include, but is not limited to, an alternatives analysis.

As part of this supplemental submittal, all supporting documentation has been provided, including an alternatives analysis, as outlined above. A variance request has been submitted to the conservation commission for the required isolated wetland fill and 2:1 replication.

In accordance with the Town of Franklin Conservation Commission Regulations, please find below a summary of the proposed project's impacts on the functions and values being served by the GC I-Series Isolated Wetland. It is Goddard's opinion that the project as designed will have no significant individual or cumulative adverse effects on these functions and values by providing proper mitigation for each characteristic.

1.3 I SERIES ISOLATED VEGETATED WETLAND – FUNCTIONS & VALUES

Table 1: Functions and Values Analysis & Mitigation

Functions & Values Performed by the GC I-Series Isolated Wetland (980 SF)	Functions & Values Mitigated by the Proposed Wetland Replication Area (1690SF)
<p>1. Wildlife Habitat</p> <p>As a 980 Square Foot Isolated Wetland, the area delineated by the GC I-Series (I1-11) qualifies a small wetland habitat. As such, the area contains native wetland plant species that provide foraging and pollinator habitat for local wildlife. Species dominant within this habitat area consist of red maple, highbush blueberry, sweet pepperbush, sedges, and wetland ferns.</p> <p>Red Maple, highbush blueberry and sweet pepperbush provide both pollinator habitat as well as food sources through berry production and shelter opportunities. Sedges provide soil stabilization, insect habitat, and foraging through seed production. Native ferns provide soil stabilization, shading, and microhabitats.</p>	<p>1. Wildlife Habitat</p> <p>The proposed wetland replication area measures 1960 Square Feet, a 2:1 replication ratio to the required fill. The area is proposed to connect to two existing, established larger IVWs, where the soils and hydrology match that of the lost area.</p> <p>All species located within the lost IVW are proposed to be planted within the replication area. Sedges and ferns from the IVW are proposed to be dug and relocated into the wetland replication area. The planting plan includes red maple, highbush blueberry, and sweet pepperbush to maintain the pollinator, foraging and shelter habitat provided within the IVW.</p> <p>As the replication area is proposed at a 2:1 ratio, significant plantings can be proposed. The area will be planted with 4 native trees and 15 native shrubs, in addition to a native seedmix providing diversity within the understory. It is the opinion of Goddard that the wetland replication plan has been designed to replicate and exceed all wildlife benefits from the proposed fill of the GC I-Series IVW.</p>
<p>2. Flood Control</p> <p>Wetlands provide flood control through a number of ways. The breaks in topography allow for the collection and slowing of water movement, and native wetland species provide significant water uptake and water filtration.</p> <p>On the subject site, the 980 SF isolated wetland assists in flood control by providing a shallow break in topography in a surrounding upland forest. Snow melt, rain, and surface runoff slowly pitch into the isolated wetland, where native wetland species provide water uptake and filtration. This wetland is a shallow slope, and does not provide significant volumes of flood storage. The topography does not allow for such</p>	<p>2. Flood Control</p> <p>The proposed wetland replication area measures 1690 Square Feet, a 2:1 replication ratio to the required fill. The area is proposed to connect to two existing, established IVWs that provides the same flood control benefits of the lost IVW, on a larger scale.</p> <p>The two IVWs follows a slow pitch off of the existing upland forest, where snow melt, rain, and surface runoff enter a shallow system. Similar to the smaller IVW, the grade of the area does not flood to the extent of providing ¼ acre foot of water, flood storage but instead disperses the water through a relatively shallow wetland system, infiltrating and being filtered through native wetland vegetation. As the area is significantly</p>

<p>volumes of surface water to act as vernal pool habitat or to qualify for Isolated Land Subject to Flooding (ILSF).</p>	<p>larger, the flood control volume created by the 2:1 replication area exceeds that of the lost IVW.</p>
<p>3. Storm Damage Prevention</p> <p>In addition to flood control, in many of the same ways, wetlands help prevent storm damage prevention by temporarily storing runoff through the topographical breaks. The native vegetation further slows the movement of water down and provides some water uptake.</p> <p>On the subject site, the 980 SF isolated wetland assists in prevention of storm damage by providing a shallow break in topography in the surrounding upland forest. During heavy storms, water follows the natural topography toward the IVW. This helps prevent erosion or sedimentation into nearby areas.</p> <p>The storm damage prevention of the IVW is limited due to its small size. The shallow topography change does not allow significant water to be stored within the area.</p>	<p>3. Storm Damage Prevention</p> <p>The proposed wetland replication area measures 1690 Square Feet, a 2:1 replication ratio to the required fill. The area is proposed to connect to two existing, established IVWs that provides the same storm damage prevention of the lost IVW, on a larger scale.</p> <p>Additionally, the creation of a 1690 SF replication area expands the storm damage prevention capabilities of the larger IVW system.</p>

In summary, Goddard Consulting believes that the proposed project will not have any adverse impacts on the interests protected by the Town of Franklin’s Wetlands Protection Bylaw. The proposed project meets all regulatory compliance standards identified therein and has proposed mitigation for its impacts. The breakdown above has been submitted to provide additional information to the commission on the vitality of the proposed replication area, and to ensure all functions and values of lost resource areas are adequately mitigated as part of the project.

Please feel free to contact us if you have any questions about this Notice of Intent supplemental submission.

Goddard Consulting, LLC.



Nicole Hayes, PWS
Senior Wetland Scientist



January 31, 2024

Franklin Conservation Commission
355 East Central Street
Franklin, MA 02038

Re: Request for New Variance – Off Veterans Memorial Drive and Irondequoit Rd (Map: 259, Parcel: 007-002)

Dear Franklin Conservation Commission,

On behalf of the applicant, Goddard Consulting, LLC is hereby submitting this request for the required variance to fill a locally regulated Isolated Vegetated Wetland (IVW) for a site access road. This request corresponds to the Notice of Intent application submitted concurrently herein as required by the local wetlands bylaw and regulations.

As noted in the attached supplemental submittal packet, alterations to the wetland delineation were made during the ANRAD review process. Most notably, an isolated vegetated wetland jurisdictional under the local bylaw only was delineated with GC I-1 – GC I-11 in the northern portion of the site, within the proposed site access area.

1.0 Waiver Request for Fill and Replication of the GC I-Series Isolated Vegetated Wetland

As outlined above, during the ANRAD review process, an isolated vegetated wetland jurisdictional under the local bylaw was delineated with GC I-1 – GC I-11 in the northern portion of the site, within the proposed site access area. This locally regulated IVW measures 980 SF. The area is characterized by a slight break in topography forming a shallow depressional area. Rock below the surface leads to poor drainage and a high-water table. The area supports native wetland vegetation (highbush blueberry, sweet pepperbush, red maple, sedges, and ferns) and contains hydric soils. The area's topography does not show signs of potential functionality as a vernal pool or to be large enough to be classified as an Isolated Land Subject to Flooding resource and so the area has been classified as a bylaw regulated only, isolated vegetated wetland.

Most of this isolated vegetated wetland falls completely within the location of the proposed site access road. As outlined in the below alternatives analysis, multiple lot constraints create difficulty for the access to be moved to other locations on-site or to downsized its footprint.

To comply with all regulatory requirements under the local bylaw, full replication is proposed at a 2:1 ratio for the proposed filling of the IVW. A detailed wetland replication plan has been submitted by Goddard Consulting LLC to create a 1960 SF replication area between the two IVWs located along the western property boundary. The area is designed to meet all local requirements, as well as to replicate as similar conditions as possible to that of the lost isolated wetland.

The local bylaw states the following:

To prevent wetlands loss, the Commission shall require applicants to avoid wetlands alteration wherever feasible; shall minimize wetlands alteration; and, where alteration is unavoidable, shall require full mitigation. The Commission may authorize or require replication of wetlands as a form of mitigation, but only with adequate security, professional design and monitoring to assure success, because of the high likelihood of failure of replication.

To comply with the above excerpt from the local bylaw, the variance requested for this work is strictly to allow for the fill of the IVW to take place, with the approval of the 1960 SF replication area proposed. It is the opinion of Goddard that the alteration in this situation is unavoidable due to the lot constraints and available site access. To demonstrate compliance, Goddard has submitted a wetland replication plan containing design protocols to ensure a high likelihood of success. The plan requires revegetation and success within two years, or the work will be redone to ensure success of the area is achieved. Goddard believes the above standard has been met, and respectfully requests a variance to fill the isolated wetland and replicate at a 2:1 ratio.

Below is a table summarizing potential alternatives to the proposed work.

Summary of Alternatives			
Alternative option	Impact to wetland resources and buffer zone	Mitigation	Cost
Alternative 1: No change to existing conditions	No impacts to the local IVW wetland resource.	None required.	No cost, but applicant is unable to develop land as needed.
Alternative 2: Minimize roadway further	IVW would still be impacted.	Project would require 2:1 mitigation.	The road is designed at the most practicable and most minimized width allowable under planning and zoning board specifications. Further narrowing of the roadway is not possible.
Alternative 3: Different Access Road	No impacts to the local IVW wetland resource.	None required.	There is no other access/exit road available for the site.
Alternative 4: Current proposal	Impacts to IVW onsite as described.	Project replicates lost IVW at a 2:1 ratio, creating 1960 SF of additional wetland area on-site.	Current design meets the needs of the applicant and proposes the mitigation of the IVW 2:1 adhering to all state, federal and local laws.

As outlined above, during the ANRAD review process, the I-Series isolated vegetated wetland was identified and flagged on/near the site. These flags were hung after a site walk between Goddard Consulting and Breeka Li Goodlander where Goddard Consulting agreed there were hydric soils and a predominance of wetland vegetation. These additional flags led to a proposed impact to local jurisdictional wetlands since this new wetland was located in the proposed site access/exit roadway area. As a result, opportunities for additional wetland mitigation were explored around the site to provide restoration.

However, the site is subject to multiple constraints; other residential and commercial properties, that prevent the opportunity to move the entrance/exit road. As a result, it is Goddard's opinion that the applicant has made efforts to avoid and minimize wetland impacts and will mitigate the impact at a 2:1 ratio adhering to all local bylaws.

2.0 Conclusion

In summary, Goddard believes that adverse impacts to wetland resource has been avoided to the greatest extent practicable, and mitigation has been provided for the work according to local law. In kind wetland replication at a ratio of 2:1 will be performed for complete mitigation for the required IVW fill. Goddard respectfully requests that the Franklin Conservation Commission issue a variance for filling the IVW.

Goddard Consulting, LLC.



Nicole Hayes, PWS
Senior Wetland Scientist

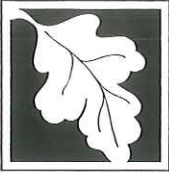

Massachusetts Department of Environmental Protection
Bureau of Resource Protection - Wetlands

WPA Form 3 – Notice of Intent

Massachusetts Wetlands Protection Act M.G.L. c. 131, §40

Provided by MassDEP:

MassDEP File Number

Document Transaction Number

Franklin

City/Town

Important:
When filling out forms on the computer, use only the tab key to move your cursor - do not use the return key.



Note:
Before completing this form consult your local Conservation Commission regarding any municipal bylaw or ordinance.

A. General Information

1. Project Location (**Note:** electronic filers will click on button to locate project site):

Veterans Memorial Drive Extension	Franklin	02038
a. Street Address	b. City/Town	c. Zip Code
Latitude and Longitude:	-71.41651	42.09532
	d. Latitude	e. Longitude
259	007-002	
f. Assessors Map/Plat Number	g. Parcel /Lot Number	

2. Applicant:

a. First Name	b. Last Name	
Town of Franklin		
c. Organization		
355 East Central Street		
d. Street Address		
Franklin	MA	02038
e. City/Town	f. State	g. Zip Code
5008-553-5500	mmaglio@franklinma.gov	
h. Phone Number	i. Fax Number	j. Email Address

3. Property owner (required if different from applicant): Check if more than one owner

a. First Name	b. Last Name	
Franklin Municipal Affordable Housing Trust		
c. Organization		
355 East Central Street		
d. Street Address		
Franklin	MA.	02038
e. City/Town	f. State	g. Zip Code
h. Phone Number	i. Fax Number	j. Email address

4. Representative (if any):

Amanda	Cavaliere	
a. First Name	b. Last Name	
Guerriere & Halnon, Inc.		
c. Company		
55 West Central Street		
d. Street Address		
Franklin	MA.	02038
e. City/Town	f. State	g. Zip Code
508.528.3221	acavaliere@gandhengineering.com	
h. Phone Number	i. Fax Number	j. Email address

5. Total WPA Fee Paid (from NOI Wetland Fee Transmittal Form):

Exempt	Exempt	Exempt
a. Total Fee Paid	b. State Fee Paid	c. City/Town Fee Paid

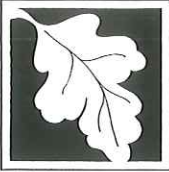

Massachusetts Department of Environmental Protection
Bureau of Resource Protection - Wetlands

WPA Form 3 – Notice of Intent

Massachusetts Wetlands Protection Act M.G.L. c. 131, §40

Provided by MassDEP:

MassDEP File Number

Document Transaction Number

Franklin

City/Town

A. General Information (continued)

6. General Project Description:

See Attached

7a. Project Type Checklist: (Limited Project Types see Section A. 7b.)

- | | |
|---|--|
| 1. <input type="checkbox"/> Single Family Home | 2. <input checked="" type="checkbox"/> Residential Subdivision |
| 3. <input type="checkbox"/> Commercial/Industrial | 4. <input type="checkbox"/> Dock/Pier |
| 5. <input type="checkbox"/> Utilities | 6. <input type="checkbox"/> Coastal engineering Structure |
| 7. <input type="checkbox"/> Agriculture (e.g., cranberries, forestry) | 8. <input type="checkbox"/> Transportation |
| 9. <input type="checkbox"/> Other | |

7b. Is any portion of the proposed activity eligible to be treated as a limited project (including Ecological Restoration Limited Project) subject to 310 CMR 10.24 (coastal) or 310 CMR 10.53 (inland)?

1. Yes No If yes, describe which limited project applies to this project. (See 310 CMR 10.24 and 10.53 for a complete list and description of limited project types)

2. Limited Project Type

If the proposed activity is eligible to be treated as an Ecological Restoration Limited Project (310 CMR 10.24(8), 310 CMR 10.53(4)), complete and attach Appendix A: Ecological Restoration Limited Project Checklist and Signed Certification.

8. Property recorded at the Registry of Deeds for:

Norfolk

a. County

34282

c. Book

b. Certificate # (if registered land)

520

d. Page Number

B. Buffer Zone & Resource Area Impacts (temporary & permanent)

1. Buffer Zone Only – Check if the project is located only in the Buffer Zone of a Bordering Vegetated Wetland, Inland Bank, or Coastal Resource Area.
2. Inland Resource Areas (see 310 CMR 10.54-10.58; if not applicable, go to Section B.3, Coastal Resource Areas).

Check all that apply below. Attach narrative and any supporting documentation describing how the project will meet all performance standards for each of the resource areas altered, including standards requiring consideration of alternative project design or location.



Massachusetts Department of Environmental Protection
 Bureau of Resource Protection - Wetlands

WPA Form 3 – Notice of Intent

Massachusetts Wetlands Protection Act M.G.L. c. 131, §40

Provided by MassDEP:

MassDEP File Number

Document Transaction Number

Franklin

City/Town

B. Buffer Zone & Resource Area Impacts (temporary & permanent) (cont'd)

For all projects affecting other Resource Areas, please attach a narrative explaining how the resource area was delineated.

<u>Resource Area</u>	<u>Size of Proposed Alteration</u>	<u>Proposed Replacement (if any)</u>
a. <input type="checkbox"/> Bank	1. linear feet	2. linear feet
b. <input checked="" type="checkbox"/> Bordering Vegetated Wetland	980+/- 1. square feet	1,960+/- 2. square feet
c. <input type="checkbox"/> Land Under Waterbodies and Waterways	1. square feet 3. cubic yards dredged	2. square feet

<u>Resource Area</u>	<u>Size of Proposed Alteration</u>	<u>Proposed Replacement (if any)</u>
d. <input type="checkbox"/> Bordering Land Subject to Flooding	1. square feet 3. cubic feet of flood storage lost	2. square feet 4. cubic feet replaced
e. <input type="checkbox"/> Isolated Land Subject to Flooding	1. square feet 2. cubic feet of flood storage lost	3. cubic feet replaced
f. <input type="checkbox"/> Riverfront Area	1. Name of Waterway (if available) - specify coastal or inland	

2. Width of Riverfront Area (check one):

- 25 ft. - Designated Densely Developed Areas only
- 100 ft. - New agricultural projects only
- 200 ft. - All other projects

3. Total area of Riverfront Area on the site of the proposed project: _____ square feet

4. Proposed alteration of the Riverfront Area:

a. total square feet _____ b. square feet within 100 ft. _____ c. square feet between 100 ft. and 200 ft. _____

5. Has an alternatives analysis been done and is it attached to this NOI? Yes No

6. Was the lot where the activity is proposed created prior to August 1, 1996? Yes No

3. Coastal Resource Areas: (See 310 CMR 10.25-10.35)

Note: for coastal riverfront areas, please complete **Section B.2.f.** above.



Massachusetts Department of Environmental Protection
Bureau of Resource Protection - Wetlands

WPA Form 3 – Notice of Intent

Massachusetts Wetlands Protection Act M.G.L. c. 131, §40

Provided by MassDEP:

MassDEP File Number

Document Transaction Number

Franklin

City/Town

B. Buffer Zone & Resource Area Impacts (temporary & permanent) (cont'd)

Check all that apply below. Attach narrative and supporting documentation describing how the project will meet all performance standards for each of the resource areas altered, including standards requiring consideration of alternative project design or location.

Online Users:
Include your document transaction number (provided on your receipt page) with all supplementary information you submit to the Department.

<u>Resource Area</u>	<u>Size of Proposed Alteration</u>	<u>Proposed Replacement (if any)</u>
a. <input type="checkbox"/> Designated Port Areas	Indicate size under Land Under the Ocean, below	
b. <input type="checkbox"/> Land Under the Ocean	_____	
	1. square feet	

	2. cubic yards dredged	
c. <input type="checkbox"/> Barrier Beach	Indicate size under Coastal Beaches and/or Coastal Dunes below	
d. <input type="checkbox"/> Coastal Beaches	_____	_____
	1. square feet	2. cubic yards beach nourishment
e. <input type="checkbox"/> Coastal Dunes	_____	_____
	1. square feet	2. cubic yards dune nourishment

	<u>Size of Proposed Alteration</u>	<u>Proposed Replacement (if any)</u>
f. <input type="checkbox"/> Coastal Banks	_____	
	1. linear feet	
g. <input type="checkbox"/> Rocky Intertidal Shores	_____	
	1. square feet	
h. <input type="checkbox"/> Salt Marshes	_____	_____
	1. square feet	2. sq ft restoration, rehab., creation
i. <input type="checkbox"/> Land Under Salt Ponds	_____	
	1. square feet	

	2. cubic yards dredged	
j. <input type="checkbox"/> Land Containing Shellfish	_____	
	1. square feet	
k. <input type="checkbox"/> Fish Runs	Indicate size under Coastal Banks, inland Bank, Land Under the Ocean, and/or inland Land Under Waterbodies and Waterways, above	

	1. cubic yards dredged	
l. <input type="checkbox"/> Land Subject to Coastal Storm Flowage	_____	
	1. square feet	

4. Restoration/Enhancement
If the project is for the purpose of restoring or enhancing a wetland resource area in addition to the square footage that has been entered in Section B.2.b or B.3.h above, please enter the additional amount here.

_____ a. square feet of BVW _____ b. square feet of Salt Marsh

5. Project Involves Stream Crossings

_____ a. number of new stream crossings _____ b. number of replacement stream crossings

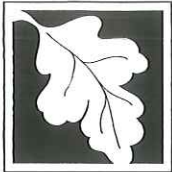

Massachusetts Department of Environmental Protection
Bureau of Resource Protection - Wetlands

WPA Form 3 – Notice of Intent

Massachusetts Wetlands Protection Act M.G.L. c. 131, §40

Provided by MassDEP:

MassDEP File Number

Document Transaction Number

Franklin

City/Town

C. Other Applicable Standards and Requirements

- This is a proposal for an Ecological Restoration Limited Project. Skip Section C and complete Appendix A: Ecological Restoration Limited Project Checklists – Required Actions (310 CMR 10.11).

Streamlined Massachusetts Endangered Species Act/Wetlands Protection Act Review

1. Is any portion of the proposed project located in **Estimated Habitat of Rare Wildlife** as indicated on the most recent Estimated Habitat Map of State-Listed Rare Wetland Wildlife published by the Natural Heritage and Endangered Species Program (NHESP)? To view habitat maps, see the *Massachusetts Natural Heritage Atlas* or go to http://maps.massgis.state.ma.us/PRI_EST_HAB/viewer.htm.

- a. Yes No **If yes, include proof of mailing or hand delivery of NOI to:**

Natural Heritage and Endangered Species Program
Division of Fisheries and Wildlife
1 Rabbit Hill Road
Westborough, MA 01581

On-line _____

b. Date of map _____

If yes, the project is also subject to Massachusetts Endangered Species Act (MESA) review (321 CMR 10.18). To qualify for a streamlined, 30-day, MESA/Wetlands Protection Act review, please complete Section C.1.c, and include requested materials with this Notice of Intent (NOI); *OR* complete Section C.2.f, if applicable. *If MESA supplemental information is not included with the NOI, by completing Section 1 of this form, the NHESP will require a separate MESA filing which may take up to 90 days to review (unless noted exceptions in Section 2 apply, see below).*

- c. Submit Supplemental Information for Endangered Species Review*
1. Percentage/acreage of property to be altered:
 - (a) within wetland Resource Area _____ percentage/acreage
 - (b) outside Resource Area _____ percentage/acreage
 2. Assessor's Map or right-of-way plan of site
2. Project plans for entire project site, including wetland resource areas and areas outside of wetlands jurisdiction, showing existing and proposed conditions, existing and proposed tree/vegetation clearing line, and clearly demarcated limits of work **
- (a) Project description (including description of impacts outside of wetland resource area & buffer zone)
 - (b) Photographs representative of the site

* Some projects **not** in Estimated Habitat may be located in Priority Habitat, and require NHESP review (see <http://www.mass.gov/eea/agencies/dfg/dfw/natural-heritage/regulatory-review/>). Priority Habitat includes habitat for state-listed plants and strictly upland species not protected by the Wetlands Protection Act.

** MESA projects may not be segmented (321 CMR 10.16). The applicant must disclose full development plans even if such plans are not required as part of the Notice of Intent process.

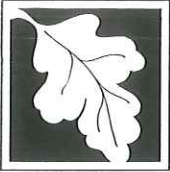

Massachusetts Department of Environmental Protection
Bureau of Resource Protection - Wetlands

WPA Form 3 – Notice of Intent

Massachusetts Wetlands Protection Act M.G.L. c. 131, §40

Provided by MassDEP:

MassDEP File Number

Document Transaction Number

Franklin

City/Town

C. Other Applicable Standards and Requirements (cont'd)

- (c) MESA filing fee (fee information available at http://www.mass.gov/dfwele/dfw/nhosp/regulatory_review/mesa/mesa_fee_schedule.htm). Make check payable to "Commonwealth of Massachusetts - NHESP" and **mail to NHESP** at above address

Projects altering 10 or more acres of land, also submit:

- (d) Vegetation cover type map of site
- (e) Project plans showing Priority & Estimated Habitat boundaries
- (f) OR Check One of the Following
1. Project is exempt from MESA review.
Attach applicant letter indicating which MESA exemption applies. (See 321 CMR 10.14, http://www.mass.gov/dfwele/dfw/nhosp/regulatory_review/mesa/mesa_exemptions.htm; the NOI must still be sent to NHESP if the project is within estimated habitat pursuant to 310 CMR 10.37 and 10.59.)
 2. Separate MESA review ongoing. a. NHESP Tracking # _____ b. Date submitted to NHESP _____
 3. Separate MESA review completed.
Include copy of NHESP "no Take" determination or valid Conservation & Management Permit with approved plan.
3. For coastal projects only, is any portion of the proposed project located below the mean high water line or in a fish run?
- a. Not applicable – project is in inland resource area only b. Yes No

If yes, include proof of mailing, hand delivery, or electronic delivery of NOI to either:

South Shore - Cohasset to Rhode Island border, and the Cape & Islands:

Division of Marine Fisheries -
Southeast Marine Fisheries Station
Attn: Environmental Reviewer
836 South Rodney French Blvd.
New Bedford, MA 02744
Email: DMF.EnvReview-South@state.ma.us

North Shore - Hull to New Hampshire border:

Division of Marine Fisheries -
North Shore Office
Attn: Environmental Reviewer
30 Emerson Avenue
Gloucester, MA 01930
Email: DMF.EnvReview-North@state.ma.us

Also if yes, the project may require a Chapter 91 license. For coastal towns in the Northeast Region, please contact MassDEP's Boston Office. For coastal towns in the Southeast Region, please contact MassDEP's Southeast Regional Office.

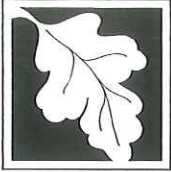

Massachusetts Department of Environmental Protection
Bureau of Resource Protection - Wetlands

WPA Form 3 – Notice of Intent

Massachusetts Wetlands Protection Act M.G.L. c. 131, §40

Provided by MassDEP:

MassDEP File Number

Document Transaction Number

Franklin

City/Town

C. Other Applicable Standards and Requirements (cont'd)

Online Users:
Include your document transaction number (provided on your receipt page) with all supplementary information you submit to the Department.

4. Is any portion of the proposed project within an Area of Critical Environmental Concern (ACEC)?
- a. Yes No If yes, provide name of ACEC (see instructions to WPA Form 3 or MassDEP Website for ACEC locations). **Note:** electronic filers click on Website.
- b. ACEC _____
5. Is any portion of the proposed project within an area designated as an Outstanding Resource Water (ORW) as designated in the Massachusetts Surface Water Quality Standards, 314 CMR 4.00?
- a. Yes No
6. Is any portion of the site subject to a Wetlands Restriction Order under the Inland Wetlands Restriction Act (M.G.L. c. 131, § 40A) or the Coastal Wetlands Restriction Act (M.G.L. c. 130, § 105)?
- a. Yes No
7. Is this project subject to provisions of the MassDEP Stormwater Management Standards?
- a. Yes. Attach a copy of the Stormwater Report as required by the Stormwater Management Standards per 310 CMR 10.05(6)(k)-(q) and check if:
1. Applying for Low Impact Development (LID) site design credits (as described in Stormwater Management Handbook Vol. 2, Chapter 3)
 2. A portion of the site constitutes redevelopment
 3. Proprietary BMPs are included in the Stormwater Management System.
- b. No. Check why the project is exempt:
1. Single-family house
 2. Emergency road repair
 3. Small Residential Subdivision (less than or equal to 4 single-family houses or less than or equal to 4 units in multi-family housing project) with no discharge to Critical Areas.

D. Additional Information

- This is a proposal for an Ecological Restoration Limited Project. Skip Section D and complete Appendix A: Ecological Restoration Notice of Intent – Minimum Required Documents (310 CMR 10.12).

Applicants must include the following with this Notice of Intent (NOI). See instructions for details.

Online Users: Attach the document transaction number (provided on your receipt page) for any of the following information you submit to the Department.

1. USGS or other map of the area (along with a narrative description, if necessary) containing sufficient information for the Conservation Commission and the Department to locate the site. (Electronic filers may omit this item.)
2. Plans identifying the location of proposed activities (including activities proposed to serve as a Bordering Vegetated Wetland [BVW] replication area or other mitigating measure) relative to the boundaries of each affected resource area.

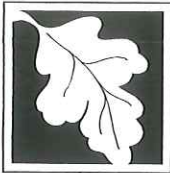

Massachusetts Department of Environmental Protection
Bureau of Resource Protection - Wetlands

WPA Form 3 – Notice of Intent

Massachusetts Wetlands Protection Act M.G.L. c. 131, §40

Provided by MassDEP:

MassDEP File Number

Document Transaction Number

Franklin
City/Town

D. Additional Information (cont'd)

3. Identify the method for BVW and other resource area boundary delineations (MassDEP BVW Field Data Form(s), Determination of Applicability, Order of Resource Area Delineation, etc.), and attach documentation of the methodology.

4. List the titles and dates for all plans and other materials submitted with this NOI.

Definitive Subdivision Plan of Land Veterans Memorial Drive Extension Franklin, Massachusetts

a. Plan Title

Guerriere & Halnon, Inc.

b. Prepared By

Dale MacKinnon

c. Signed and Stamped by

As Noted

d. Final Revision Date

e. Scale

f. Additional Plan or Document Title

g. Date

5. If there is more than one property owner, please attach a list of these property owners not listed on this form.

6. Attach proof of mailing for Natural Heritage and Endangered Species Program, if needed.

7. Attach proof of mailing for Massachusetts Division of Marine Fisheries, if needed.

8. Attach NOI Wetland Fee Transmittal Form

9. Attach Stormwater Report, if needed.

E. Fees

1. Fee Exempt: No filing fee shall be assessed for projects of any city, town, county, or district of the Commonwealth, federally recognized Indian tribe housing authority, municipal housing authority, or the Massachusetts Bay Transportation Authority.

Applicants must submit the following information (in addition to pages 1 and 2 of the NOI Wetland Fee Transmittal Form) to confirm fee payment:

2. Municipal Check Number

3. Check date

4. State Check Number

5. Check date

6. Payor name on check: First Name

7. Payor name on check: Last Name



Massachusetts Department of Environmental Protection
Bureau of Resource Protection - Wetlands

WPA Form 3 – Notice of Intent

Massachusetts Wetlands Protection Act M.G.L. c. 131, §40

Provided by MassDEP:

MassDEP File Number

Document Transaction Number



Franklin

City/Town

F. Signatures and Submittal Requirements

I hereby certify under the penalties of perjury that the foregoing Notice of Intent and accompanying plans, documents, and supporting data are true and complete to the best of my knowledge. I understand that the Conservation Commission will place notification of this Notice in a local newspaper at the expense of the applicant in accordance with the wetlands regulations, 310 CMR 10.05(5)(a).

I further certify under penalties of perjury that all abutters were notified of this application, pursuant to the requirements of M.G.L. c. 131, § 40. Notice must be made by Certificate of Mailing or in writing by hand delivery or certified mail (return receipt requested) to all abutters within 100 feet of the property line of the project location.

1. Signature of Applicant		2-22-27
3. Signature of Property Owner (if different)		2-22-24
5. Signature of Representative (if any)		4-5-24

For Conservation Commission:

Two copies of the completed Notice of Intent (Form 3), including supporting plans and documents, two copies of the NOI Wetland Fee Transmittal Form, and the city/town fee payment, to the Conservation Commission by certified mail or hand delivery.

For MassDEP:

One copy of the completed Notice of Intent (Form 3), including supporting plans and documents, one copy of the NOI Wetland Fee Transmittal Form, and a **copy** of the state fee payment to the MassDEP Regional Office (see Instructions) by certified mail or hand delivery.

Other:

If the applicant has checked the "yes" box in any part of Section C, Item 3, above, refer to that section and the Instructions for additional submittal requirements.

The original and copies must be sent simultaneously. Failure by the applicant to send copies in a timely manner may result in dismissal of the Notice of Intent.

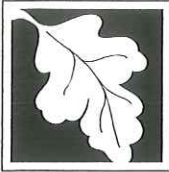

Massachusetts Department of Environmental Protection
 Bureau of Resource Protection - Wetlands
NOI Wetland Fee Transmittal Form
 Massachusetts Wetlands Protection Act M.G.L. c. 131, §40

Important: When filling out forms on the computer, use only the tab key to move your cursor - do not use the return key.



A. Applicant Information

1. Location of Project:

Veterans Memorial Drive Extension
 a. Street Address Franklin
 b. City/Town
 Exempt
 c. Check number Exempt
 d. Fee amount

2. Applicant Mailing Address:

a. First Name b. Last Name
 Town of Franklin
 c. Organization
 355 East Central Street
 d. Mailing Address
 Franklin MA 02038
 e. City/Town f. State g. Zip Code
 508-553-5500
 h. Phone Number i. Fax Number mmaglio@franklinma.gov
 j. Email Address

3. Property Owner (if different):

a. First Name b. Last Name
 Franklin Municipal Affordable Housing Trust
 c. Organization
 355 East Central Street
 d. Mailing Address
 Franklin MA 02038
 e. City/Town f. State g. Zip Code
 h. Phone Number i. Fax Number j. Email Address

B. Fees

Fee should be calculated using the following process & worksheet. **Please see Instructions before filling out worksheet.**

Step 1/Type of Activity: Describe each type of activity that will occur in wetland resource area and buffer zone.

Step 2/Number of Activities: Identify the number of each type of activity.

Step 3/Individual Activity Fee: Identify each activity fee from the six project categories listed in the instructions.

Step 4/Subtotal Activity Fee: Multiply the number of activities (identified in Step 2) times the fee per category (identified in Step 3) to reach a subtotal fee amount. Note: If any of these activities are in a Riverfront Area in addition to another Resource Area or the Buffer Zone, the fee per activity should be multiplied by 1.5 and then added to the subtotal amount.

Step 5/Total Project Fee: Determine the total project fee by adding the subtotal amounts from Step 4.

Step 6/Fee Payments: To calculate the state share of the fee, divide the total fee in half and subtract \$12.50. To calculate the city/town share of the fee, divide the total fee in half and add \$12.50.

To calculate filing fees, refer to the category fee list and examples in the instructions for filling out WPA Form 3 (Notice of Intent).

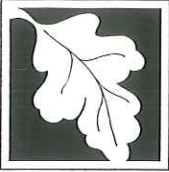

Massachusetts Department of Environmental Protection
 Bureau of Resource Protection - Wetlands
NOI Wetland Fee Transmittal Form
 Massachusetts Wetlands Protection Act M.G.L. c. 131, §40

B. Fees (continued)

Step 1/Type of Activity	Step 2/Number of Activities	Step 3/Individual Activity Fee	Step 4/Subtotal Activity Fee

Step 5/Total Project Fee: _____

Step 6/Fee Payments:

Total Project Fee: Exempt
 a. Total Fee from Step 5

State share of filing Fee: b. 1/2 Total Fee **less** \$12.50

City/Town share of filling Fee: c. 1/2 Total Fee **plus** \$12.50

C. Submittal Requirements

- a.) Complete pages 1 and 2 and send with a check or money order for the state share of the fee, payable to the Commonwealth of Massachusetts.

Department of Environmental Protection
 Box 4062
 Boston, MA 02211

- b.) **To the Conservation Commission:** Send the Notice of Intent or Abbreviated Notice of Intent; a **copy** of this form; and the city/town fee payment.

To MassDEP Regional Office (see Instructions): Send a copy of the Notice of Intent or Abbreviated Notice of Intent; a **copy** of this form; and a **copy** of the state fee payment. (E-filers of Notices of Intent may submit these electronically.)

Order of Resource Area Delineation
(MassDEP No. 159-1273)

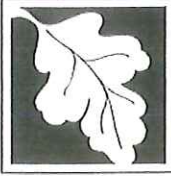

Massachusetts Department of Environmental Protection

eDEP Transaction Copy

Here is the file you requested for your records.

To retain a copy of this file you must save and/or print.

Username: FRANKLINCONCOM

Transaction ID: 1606412

Document: WPA Form 4B - ORAD

Size of File: 96.95K

Status of Transaction: In Process

Date and Time Created: 9/7/2023:10:23:59 AM

Note: This file only includes forms that were part of your transaction as of the date and time indicated above. If you need a more current copy of your transaction, return to eDEP and select to "Download a Copy" from the Current Submittals page.

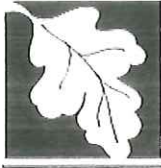

Massachusetts Department of Environmental Protection
 Bureau of Resource Protection - Wetlands
WPA Form 4B - Order of Resource Area Delineation

Provided by MassDEP:
 MassDEP File #:159-1273
 eDEP Transaction #:1606412
 City/Town:FRANKLIN

Massachusetts Wetlands Protection Act M.G.L. c. 131 S40

A. General Information

1. Conservation Commission FRANKLIN

2. This Issuance is for (Check one):

- a. Order of Resource Area Delineation
- b. Amended Order of Resource Area Delineation

3. Applicant Details

a. First Name	MICHAEL	b. Last Name	MAGLIO
c. Organization	TOWN OF FRANKLIN DEPARTMENT OF PUBLIC WORKS		
d. Mailing Address	257 FISHER STREET		
e. City/Town	FRANKLIN	f. State	MA
		g. ZIP	02038

4. Property Owner (if different from applicant):

a. First Name	MICHAEL	b. Last Name	MAGLIO
c. Organization	TOWN OF FRANKLIN DEPARTMENT OF PUBLIC WORKS		
d. Mailing Address	257 FISHER STREET		
e. City/Town	FRANKLIN	f. State	MA
		g. ZIP	02038

5. Project Location

a. Street Address	OFF VETERANS MEMORAL DRIVE		
b. City/Town	FRANKLIN	c. Zip	02038
d. Assessors Map/Plat#	259	e. Parcel/Lot#	007
f. Latitude	42.09383N	g. Longitude	71.41332W

6. Dates

a. Date ANRAD Filed	6/16/2023	b. Date Public Hearing Closed	9/7/2023	c. Date Of Issuance	9/8/2023
---------------------	-----------	-------------------------------	----------	---------------------	----------

7. Final Approved Plans and Other Documents

Plan Title	Plan Prepared By	Plan Signed By	Plan Final Date	Plan Scale
RESOURCE AREA PLOT PLAN	ROBERT E. CONSTANTINE, II PLS # 49611		08/10/2023	

B. Order of Delineation

1. The Conservation Commission has determined the following (check whichever is applicable)

a. **Accurate:** The boundaries described on the referenced plan(s) above and in the Abbreviated Notice of Resource Area Delineation are accurately drawn for the following resource area(s):

- 1. Bordering Vegetated Wetlands
- 2. Other resource area(s), specifically
 - a. THREE ISOLATED VEGETATED WETLANDS

b. **Modified:** The boundaries described on the plan(s) referenced above, as modified by the Conservation Commission from the plans contained in the Abbreviated Notice of Resource Area Delineation, are accurately drawn from the following resource area(s):

- 1. Bordering Vegetated Wetlands
- 2. Other resource area(s), specifically



Massachusetts Department of Environmental Protection
Bureau of Resource Protection - Wetlands
**WPA Form 4B - Order of Resource Area
Delineation**

Massachusetts Wetlands Protection Act M.G.L. c. 131 S40

Provided by MassDEP:
MassDEP File #:159-1273
eDEP Transaction #:1606412
City/Town:FRANKLIN

a.

c. **Γ Inaccurate::** The boundaries described on the referenced plan(s) and in the Abbreviated Notice of Resource Area Delineation were found to be inaccurate and cannot be confirmed for the following resource area(s):

1. **Γ** Bordering Vegetated Wetlands
2. **Γ** Other resource area(s), specifically

a.

3. The boundaries were determined to be inaccurate because:

C. Findings

This Order of Resource Area Delineation determines that the boundaries of those resource areas noted above, have been delineated and approved by the Commission and are binding as to all decisions rendered pursuant to the Massachusetts Wetlands Protection Act (M.G.L. c.131, S 40) and its regulations (310 CMR 10.00). This Order does not, however, determine the boundaries of any resource area or Buffer Zone to any resource area not specifically noted above, regardless of whether such boundaries are contained on the plans attached to this Order or to the Abbreviated Notice of Resource Area Delineation. This Order must be signed by a majority of the Conservation Commission. The Order must be sent by certified mail (return receipt requested) or hand delivered to the applicant. A copy also must be mailed or hand delivered at the same time to the appropriate DEP Regional Office (see <http://www.mass.gov/dep/about/region/findyour.htm>).

D. Appeals

The applicant, the owner, any person aggrieved by this Order, any owner of land abutting the land subject to this Order, or any ten residents of the city or town in which such land is located, are hereby notified of their right to request the appropriate DEP Regional Office to issue a Superseding Order of Resource Area Delineation. When requested to issue a Superseding Order of Resource Area Delineation, the Department's review is limited to the objections to the resource area delineation(s) stated in the appeal request. The request must be made by certified mail or hand delivery to the Department, with the appropriate filing fee and a completed Request for Departmental Action Fee Transmittal Form, as provided in 310 CMR 10.03(7) within ten business days from the date of issuance of this Order. A copy of the request shall at the same time be sent by certified mail or hand delivery to the Conservation Commission and to the applicant, if he/she is not the appellant. Any appellants seeking to appeal the Department's Superseding Order of Resource Area Delineation will be required to demonstrate prior participation in the review of this project. Previous participation in the permit proceeding means the submission of written information to the Conservation Commission prior to the close of the public hearing, requesting a Superseding Order or Determination, or providing written information to the Department prior to issuance of a Superseding Order or Determination. The request shall state clearly and concisely the objections to the Order which is being appealed and how the Order does not contribute to the protection of the interests identified in the Massachusetts Wetlands Protection Act, (M.G.L. c. 131, S 40) and is inconsistent with the wetlands regulations (310 CMR 10.00). To the extent that the Order is based on a municipal bylaw or ordinance, and not on the Massachusetts Wetlands Protection Act or regulations, the Department of Environmental Protection has no appellate jurisdiction.

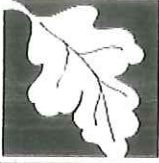

Massachusetts Department of Environmental Protection

Bureau of Resource Protection - Wetlands

WPA Form 4B - Order of Resource Area

Delineation

Massachusetts Wetlands Protection Act M.G.L. c. 131 S40

Provided by MassDEP:

MassDEP File #:159-1273

eDEP Transaction #:1606412

City/Town:FRANKLIN

E. Signatures

[Handwritten signatures]

1. Date of Original Order

2. No. of Signatures required 7

[Handwritten signature]

This Order is valid for three years from the date of issuance.

If this Order constitutes an Amended Order of Resource Area Delineation, this Order does not extend the issuance date of the original Final Order, and the Amended Order will expire on the date of the Original Final Order unless extended in writing by the Department.

This Order is issued to the applicant and the property owner (if different) as follows:

3. By hand delivery on

4. By certified mail, return receipt requested on

a. Date 9/12/2023

a. Date _____

Geodetic Map Showing Locus

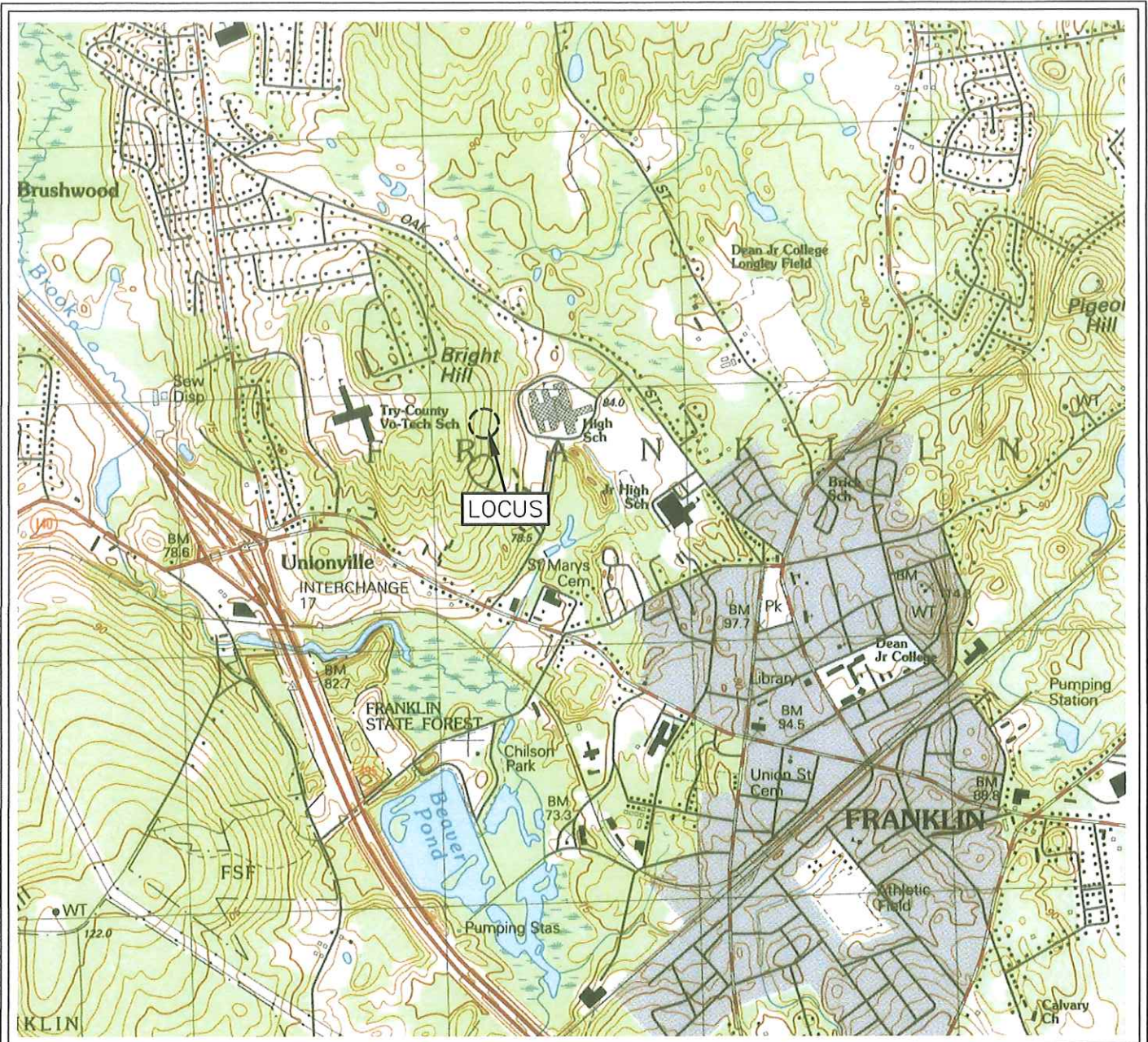

U.S.G.S.
 Quadrangle

Scale: 1"=2000'

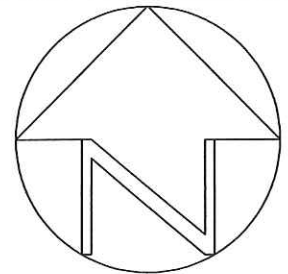

LOCUS MAP
 Veterans Memorial Drive Extension
 FRANKLIN, Massachusetts



**Guerriere
 &
 Halnon, Inc.**

Engineering & Land Surveying
 55 WEST CENTRAL STREET FRANKLIN, MA. 02038
 PH: (508) 528-3221
 WWW.GUERRIEREANDHALNON.COM

Date: December 29, 2023

Project No. F-4598



Veterans Memorial Dr. Locus

Franklin, MA



December 29, 2023

1 inch = 559 Feet

www.cai-tech.com

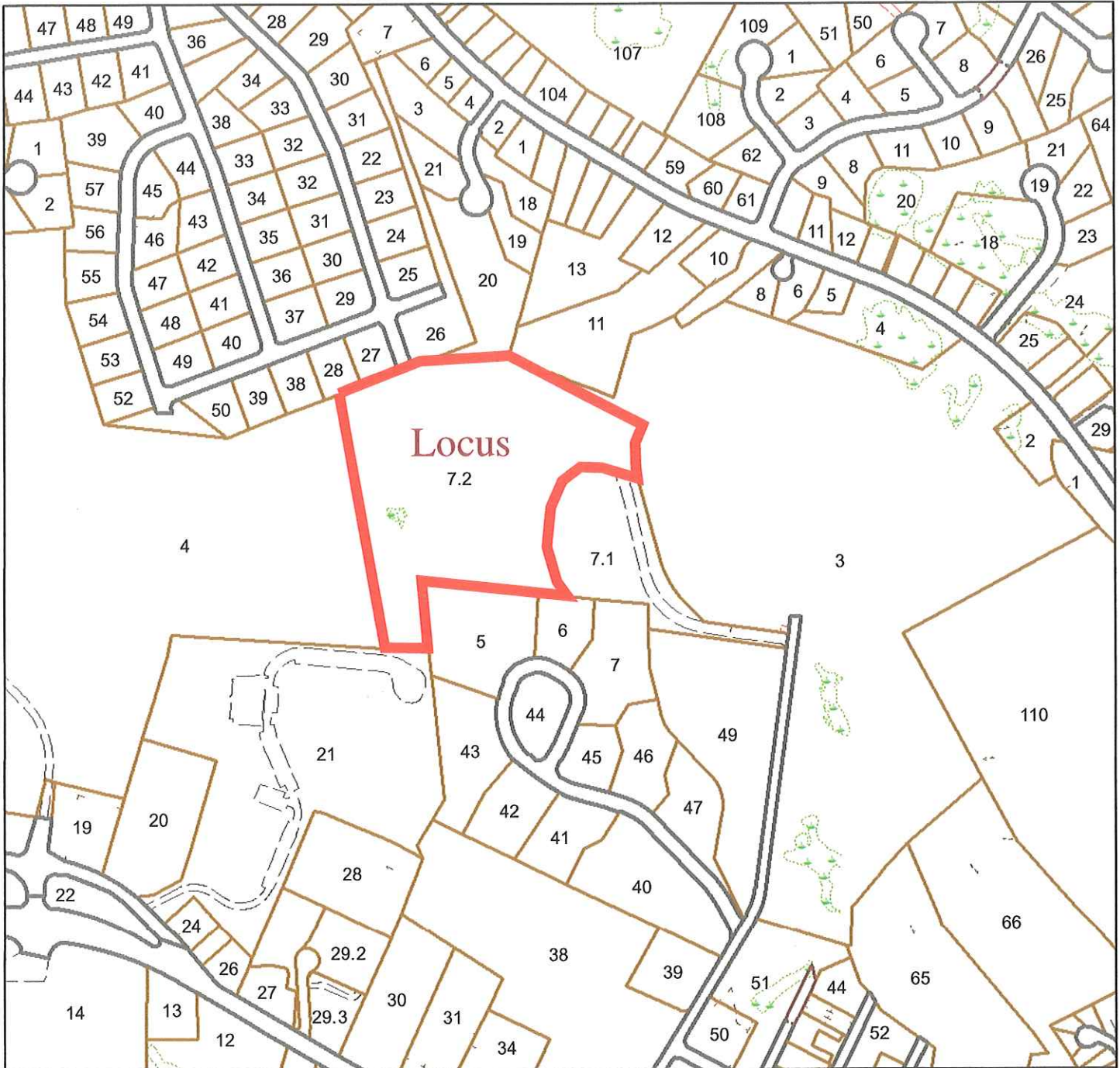

	TownPoly		Undeveloped Public Road		Wetland		Wet Areas
	Private Road		Property Hook		Private Road ROW		
	Property Line		Property TIC		Right of Way		
	Public Road		RoadNotPar		Utility		

This information is believed to be correct but is subject to change and is not warranted.

FEMA Flood Mapping

National Flood Hazard Layer FIRMette



71°25'8"W 42°55'52"N



0 250 500 1,000 1,500 2,000 Feet 1:6,000

71°24'30"W 42°55'25"N

Racoman Imagery Source: IIGSS National Map 2023

Legend

SEE FIS REPORT FOR DETAILED LEGEND AND INDEX MAP FOR FIRM PANEL LAYOUT

SPECIAL FLOOD HAZARD AREAS

- Without Base Flood Elevation (BFE) Zone A, V, A99
- With BFE or Depth Zone AE, AO, AH, VE, AR
- Regulatory Floodway

OTHER AREAS OF FLOOD HAZARD

- 0.2% Annual Chance Flood Hazard, Areas of 1% annual chance flood with average depth less than one foot or with drainage areas of less than one square mile Zone X
- Future Conditions 1% Annual Chance Flood Hazard Zone X
- Area with Reduced Flood Risk due to Levee, See Notes, Zone X
- Area with Flood Risk due to Levee Zone D

OTHER AREAS

- NO SCREEN
- Area of Minimal Flood Hazard Zone X
- Effective LOMRs
- Area of Undetermined Flood Hazard Zone I

GENERAL STRUCTURES

- Channel, Culvert, or Storm Sewer
- Levee, Dike, or Floodwall

OTHER FEATURES

- Cross Sections with 1% Annual Chance Water Surface Elevation
- Coastal Transect
- Base Flood Elevation Line (BFE)
- Limit of Study
- Jurisdiction Boundary
- Coastal Transect Baseline
- Profile Baseline
- Hydrographic Feature

MAP PANELS

- Digital Data Available
- No Digital Data Available
- Unmapped

The pin displayed on the map is an approximate point selected by the user and does not represent an authoritative property location.

This map complies with FEMA's standards for the use of digital flood maps if it is not void as described below. The basemap shown complies with FEMA's basemap accuracy standards

The flood hazard information is derived directly from the authoritative NFHL web services provided by FEMA. This map was exported on 12/29/2023 at 2:11 PM and does not reflect changes or amendments subsequent to this date and time. The NFHL and effective information may change or become superseded by new data over time.

This map image is void if the one or more of the following map elements do not appear: basemap imagery, flood zone labels, legend, scale bar, map creation date, community identifiers, FIRM panel number, and FIRM effective date. Map images for unmapped and unmodernized areas cannot be used for regulatory purposes.

NHESP Mapping

Natural Heritage Map

NHESP Estimated Habitats of Rare
Wildlife



NHESP Priority Habitats of Rare Species



Map Features for Imagery

