

PROSPECT STREET

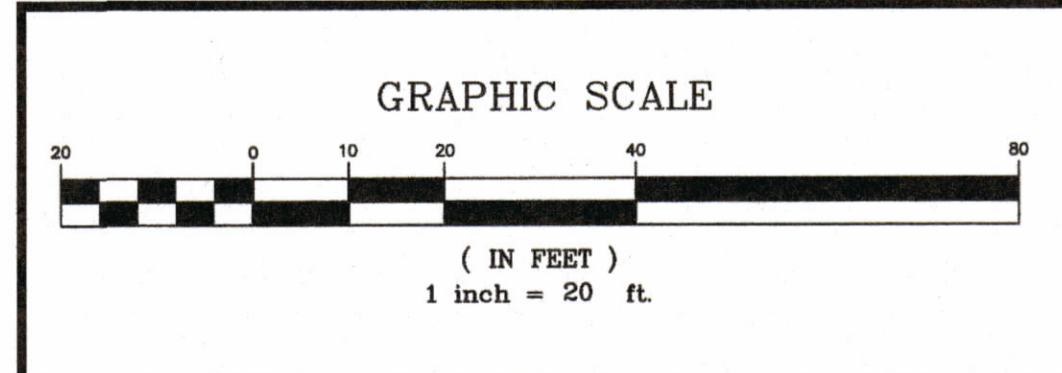

GLM Engineering Consultants, Inc.
 19 EXCHANGE STREET
 HOLLISTON, MA 01746
 P:508-429-1100 F:508-429-7160
 www.GLMengineering.com

FLD.: MBL
 DRW.: CNG
 CHKD.: JEH

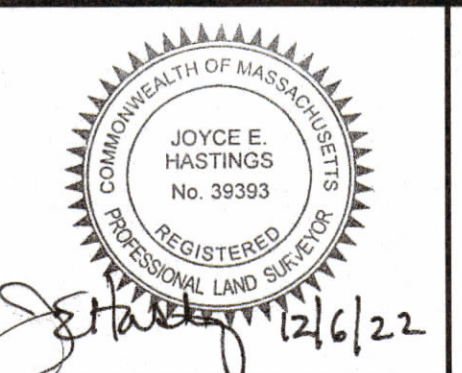

SITE AS-BUILT PLAN
#381 LOT 4 PROSPECT STREET
FRANKLIN, MASSACHUSETTS
 FOR
NEW GENERATION CUSTOM HOMES CORP.
8 PUFFER DRIVE
MENDON, MA.

JOB No. 16590-SEPTIC PLANS-4-5-6-STK.DWG
 DATE: 12/6/2022
 SCALE: 1"=20'
 PLAN No: 20,451