

**DESIGN REVIEW COMMISSION
AGENDA**

**May 18, 2021
7:00 PM.**

Virtual Meeting

Due to the growing concerns regarding the COVID-19 virus, we will be conducting a remote/virtual Design Review Commission Meeting. In an effort to ensure citizen engagement and comply with open meeting law regulations, citizens will be able to dial into the meeting using the provided phone number (Cell phone or Landline Required) OR citizens can participate by copying the link (Phone, Computer, or Tablet required). Please click on <https://us02web.zoom.us/j/87528868509> or call on your phone at 1-929-205-6099, meeting ID is 87528868509

- 7:00 PM** **Entegris – 10 Forge Parkway**
Install Non-Illuminated Monument Sign@ 15 sq. ft. (Text area approximately 4.5 sq. ft.)
- 7:05 PM** **Factory Square – 1 Fisher Street**
Install two monument signs
- 7:10 PM** **iFix Phones dba iFixonwheelz LLC – 15 East Central Sign**
Install sticker banner over existing sign

General Matters:

Approval of Minutes: May 4, 2021

Response Letter to Ms. Whalen

COMMENTS: These listing of matters are those reasonably anticipated by the Chair which may be discussed at the meeting. Not all items listed may in fact be discussed and other items not listed may also be brought up for discussion to the extent permitted by law.

This agenda is subject to change. Last updated: May 13, 2021

The next meeting of the Design Review Commission is scheduled for June 1, 2021

FORM Q

TOWN OF FRANKLIN
DESIGN REVIEW APPLICATION
FOR §185-31(2) OF THE ZONING BY-LAW

A) General Information

Name of Business or Project: ENTEGRIS.

Property Address 10 FORGE PARKWAY

Assessors' Map # 275 Parcel # 002

Zoning District (select applicable zone): _____

Zoning History: Use Variance N/A
Non-Conforming Use N/A

B) Applicant Information:

Applicant Name: HEATHER DUSKO, PHILADELPHIA SIGN

Address: 27 OLD MEETINGHOUSE ROAD
AUBURN, MA 01501

Telephone Number: 508.612.6954

Contact Person: HEATHER DUSKO

C) Owner Information (Business Owner & Property Owner if different)

Business Owner: ENTEGRIS.
Address: 10 FORGE PARK
FRANKLIN, MA.

Property Owner: GOLDMAN SACHS + Co.
200 WEST 35TH
NEW YORK, NY 10018.

All of the information is submitted according to the best of my knowledge

Heather Dusk

5/6/2021

Signature
Print Name: HEATHER DUSKO.

Date Submitted

***FOR SIGNS COMPLETE PAGES 1 & 2 ONLY.
FOR SITE PLANS, BUILDING PLANS, PROJECTS, COMPLETE PAGES 1-4**

SEE ADDENDA ATTACHED FOR ASSISTANCE IN COMPLETION OF FORM Q

D) Architect/Engineer/Sign Company Information (if not the applicant)

a. Sign Company

Business Name: PHILADELPHIA SIGN COMPANY
Contact Person: CRAGG HANSELL, PROJECT MGR.
Address: 101 W. SPRING GARDEN ST. PALMYRA, NJ
Telephone Number: 856-829-1460 x: 232

b. Architect/Engineer (when applicable)

Business Name: _____
Contact Person: _____
Address: _____
Telephone Number: _____

E) Work Summary

Summary of work to be done: INSTALL NON ILLUMINATED MONUMENT SIGN @ 1554 ST (TEXT AREA APPROX 4.5 SQ FT) TO READ: ENTEGRIS. AT ENTRANCE SIDEWALK.

F) Information & Materials to be Submitted with Application

a) FOR SIGN SUBMISSIONS ONLY:

NINE (9) COPIES OF THE FOLLOWING MUST BE SUBMITTED WITH APPLICATION

1. Drawing of Proposed Sign which must also include
type of sign (wall, pylon etc.) colors
size/dimensions materials
style of lettering lighting-illuminated, non-illuminated and style
2. Drawing and/or pictures indicating location of new sign.
3. Picture of existing location and signs (if previously existing location)

b) FOR BUILDINGS/DEVELOPMENTS OR PROJECT SUBMISSIONS:

NINE (9) COPIES OF THE FOLLOWING MUST BE SUBMITTED W/APPLICATION

1. Site Plan including Landscape Plan showing plantings. Plantings must be from Best Development Practices Guide
2. Lighting Plan indicating lighting levels & specifications of proposed lights
3. Building drawings, indicating size and height of building(s); front, rear and side elevations (when there are no adjoining buildings) and floor plans
4. Drawings or pictures of existing conditions
5. If any signage on the building or site, provide information from above Signage Checklist

Note: Please bring a sample of the following to the meeting: materials samples (brick, siding, roofing etc.) as well as samples of paint colors.

E02 ENTJMMNTNIL_15 Non-Illuminated Monument Sign - 5'0"oah x 3'0"oal e 15 sq ft.

Proposed



Sign Area:
18" x 36" e 45 sq ft.

Existing



Existing Sign Dimensions: 36" h x 36" w

(9 ft)

Signs Rendered Proportional to the Photo



CLIENT	DWG BY	DATE	DATE	REVISION	BY
Entegris	MMS	12.21.20	-		
ADDRESS	DWG NUM	SHEET			
ENTJ0026 - Franklin 10 Forge Park Franklin, MA 02038	A35570	4			

THIS IS AN ORIGINAL UNPUBLISHED DRAWING CREATED BY TSCA. IT IS SUBJECT TO YOUR PERSONAL AND COMPANY'S POLICY. NO PART OF THIS DRAWING IS TO BE REPRODUCED OR TRANSMITTED IN ANY FORM OR BY ANY MEANS, ELECTRONIC OR MECHANICAL, INCLUDING PHOTOCOPYING, RECORDING, OR BY ANY INFORMATION STORAGE AND RETRIEVAL SYSTEM. IT IS NOT TO BE SHOWN TO ANYONE OUTSIDE YOUR ORGANIZATION NOR IS IT TO BE USED, COPIED, REPRODUCED, OR EXHIBITED IN ANY MANNER.

FORM Q

TOWN OF FRANKLIN
DESIGN REVIEW APPLICATION
FOR §185-31(2) OF THE ZONING BY-LAW

A) General Information

Name of Business or Project: Factory Square

Property Address 1 Fisher Street

Assessors' Map # _____ Parcel # 278-016-000-000

Zoning District (select applicable zone): Industrial / Mixed Use

Zoning History: Use Variance _____
Non-Conforming Use _____

B) Applicant Information:

Applicant Name: Signs By Cam, Inc.
837 Upper Union Street
Suite C-18
Address: Franklin, MA 02038

Telephone Number: 508-364-2908

Contact Person: _____

C) Owner Information (Business Owner & Property Owner if different)

Business Owner: Rick Kaplan Property Owner: Same as Business
Address: 1 Fisher St. _____
Franklin, MA 02038 _____

All of the information is submitted according to the best of my knowledge
Executed as a sealed instrument this _____ day of _____ 20____

[Signature]
Signature of Applicant

[Signature]
Signature of Owner

Cam Afonso
Print name of Applicant

Rick Kaplan
Print name of Owner

***FOR SIGNS COMPLETE PAGES 1 & 2 ONLY.
FOR SITE PLANS, BUILDING PLANS, PROJECTS, COMPLETE PAGES 1-4**

SEE ADDENDA ATTACHED FOR ASSISTANCE IN COMPLETION OF FORM Q

D) Architect/Engineer/Sign Company Information (if not the applicant)

a. Sign Company

Business Name: Signs By Cam, Inc.
Contact Person: 837 Upper Union Street
Address Suite G-18
Franklin, MA 02038
Telephone Number: _____

b. Architect/Engineer (when applicable)

Business Name: _____
Contact Person: _____
Address _____
Telephone Number: _____

E) Work Summary

Summary of work to be done: Install two Monument Signs.

F) Information & Materials to be Submitted with Application

a) FOR SIGN SUBMISSIONS ONLY:

NINE (9) COPIES OF THE FOLLOWING MUST BE SUBMITTED WITH APPLICATION

1. Drawing of Proposed Sign which must also include
type of sign (wall, pylon etc.) colors
size/dimensions materials
style of lettering lighting-illuminated, non-illuminated and style
2. Drawing and/or pictures indicating location of new sign.
3. Picture of existing location and signs (if previously existing location)

b) FOR BUILDINGS/DEVELOPMENTS OR PROJECT SUBMISSIONS:

NINE (9) COPIES OF THE FOLLOWING MUST BE SUBMITTED W/APPLICATION

1. Site Plan including Landscape Plan showing plantings. Plantings must be from Best Development Practices Guide
2. Lighting Plan indicating lighting levels & specifications of proposed lights
3. Building drawings, indicating size and height of building(s); front, rear and side elevations (when there are no adjoining buildings) and floor plans
4. Drawings or pictures of existing conditions
5. If any signage on the building or site, provide information from above Signage Checklist

Note: Please bring a sample of the following to the meeting: materials samples (brick, siding, roofing etc.) as well as samples of paint colors.

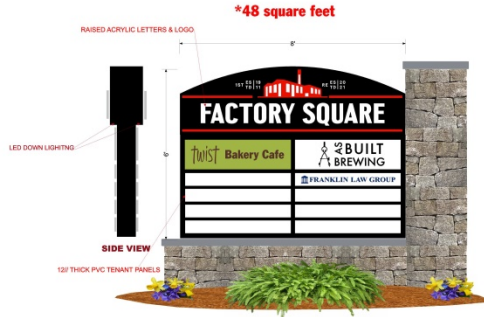

***48 square feet**

RAISED ACRYLIC LETTERS & LOGO

LED DOWN LIGHTING

SIDE VIEW

12\"/>

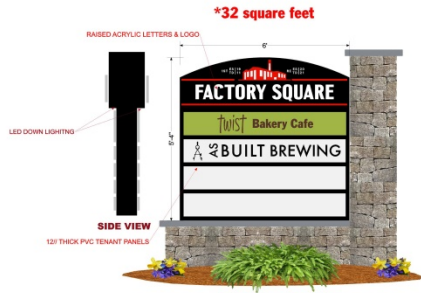

***32 square feet**

RAISED ACRYLIC LETTERS & LOGO

LED DOWN LIGHTING

SIDE VIEW

12\"/>

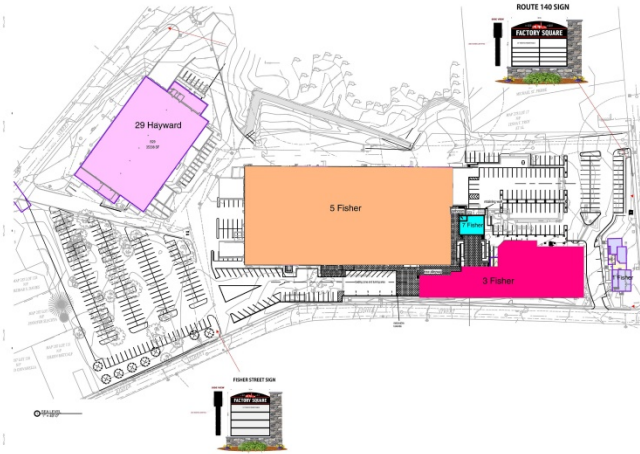

Signs By Cam

Sign & Graphic Solutions • Uncompromising Integrity

Cam Afonso

837 Upper Union St., Suite C-18
Franklin, MA 02038

Phone: 508-364-2905
Fax/Office: 508-528-0766
E-Mail: cam@signsbycam.com
Website: www.signsbycam.com

APPROVED FOR PRODUCTION:

X _____

JOB INFORMATION

JOB TITLE:
CONTACT:
PHONE:
FAX:
JOB DESCRIPTION:

SQUARE FOOTAGE=

SIGN MATERIAL SPECS

BANNER: COROPLAST: WOOD:
ACRYLIC: MAGNETIC: URETHANE:
PVC: ALUMINUM: NUEDGE:

SINGLE SIDED: DOUBLE SIDED:

OTHER: _____

© COPYRIGHT

ALL DRAWINGS ARE PROPERTY OF SIGNS BY CAM, INC. ANY DUPLICATION OF ANY KIND IS PROHIBITED. PERSONS WILL BE PROSECUTED TO THE FULL EXTENT OF THE LAW.

COLOR SPECS:

BACKGROUND:
COPY:

OUTLINE:
SHADOW:
BORDER:
LOGO:

FORM Q

TOWN OF FRANKLIN
DESIGN REVIEW APPLICATION
FOR §185-31(2) OF THE ZONING BY-LAW

A) General Information

Name of Business or Project: I Fix Phones dba / I fixonwheelz LLC

Property Address 15 East Central st, Franklin, MA

Assessors' Map # _____ Parcel # _____

Zoning District (select applicable zone): _____

Zoning History: Use Variance _____
Non-Conforming Use _____

B) Applicant Information:

Applicant Name: Allahverdi Mammadov

Address: 46 Century st, Medford
MA 02155

Telephone Number: 857 526 3102

Contact Person: Ali

C) Owner Information (Business Owner & Property Owner if different)

Business Owner: Same as above Property Owner: Anna Clarke, Maria Giorgio and
Address: _____ Siannina DeGaetano, Trustees of
_____ Ferrara family

All of the information is submitted according to the best of my knowledge
Executed as a sealed instrument this _____ day of _____ 20____

Ali
Signature of Applicant

Signature of Owner

Ali
Print name of Applicant

Print name of Owner

***FOR SIGNS COMPLETE PAGES 1 & 2 ONLY.**

FOR SITE PLANS, BUILDING PLANS, PROJECTS, COMPLETE PAGES 1 - 4

SEE ADDENDA ATTACHED FOR ASSISTANCE IN COMPLETION OF FORM Q

D) Architect/Engineer/Sign Company Information (if not the applicant)

a. Sign Company

Business Name: Excel Signs
Contact Person: Grant
Address: 259 Quincy Ave, Quincy MA 02169
Telephone Number: 617 479 8552

b. Architect/Engineer (when applicable)

Business Name: _____
Contact Person: _____
Address: _____
Telephone Number: _____

E) Work Summary

Summary of work to be done: Installation of a sign
without connecting it to a electricity

F) Information & Materials to be Submitted with Application

a) FOR SIGN SUBMISSIONS ONLY:

NINE (9) COPIES OF THE FOLLOWING MUST BE SUBMITTED WITH APPLICATION

1. Drawing of Proposed Sign which must also include:
type of sign (wall, pylon etc.) colors
size/dimensions materials
style of lettering lighting-illuminated, non-illuminated and style
2. Drawing and/or pictures indicating location of new sign.
3. Picture of existing location and signs (if previously existing location)

b) FOR BUILDINGS/DEVELOPMENTS OR PROJECT SUBMISSIONS:

NINE (9) COPIES OF THE FOLLOWING MUST BE SUBMITTED W/APPLICATION

1. Site Plan including Landscape Plan showing plantings. Plantings must be from Best Development Practices Guide
2. Lighting Plan indicating lighting levels & specifications of proposed lights
3. Building drawings, indicating size and height of building(s); front, rear and side elevations (when there are no adjoining buildings) and floor plans
4. Drawings or pictures of existing conditions
5. If any signage on the building or site, provide information from above Signage Checklist

Note: Please bring a sample of the following to the meeting: materials samples (brick, siding, roofing etc.) as well as samples of paint colors.

New Submission





- SPECIFICATIONS:**
- Face: 1/8" acrylic with vinyl overlay
 - Trim Cap: 1" black Jewelite
 - Return: .040" black alum.
 - Illumination: Internal LED
 - Flush mount



Channel Letters

This image is for general reference only, and may not accurately represent the actual product.

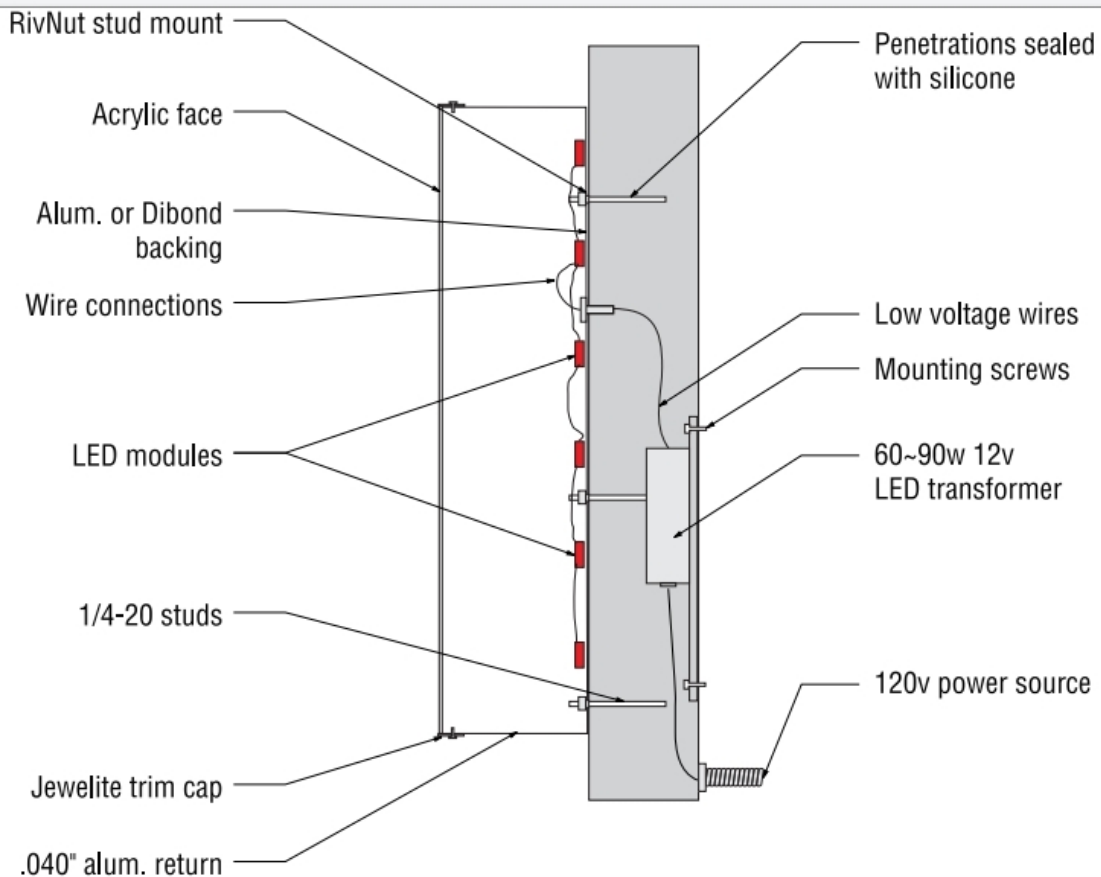

Channel Letters - Typical Cross Section - Not to Scale

This image is for general reference only, and may not accurately represent the actual product.

Helping Clients
Value, Sell and Buy
Businesses

iFixPhones



**WE FIX
YOUR
PHONE**

- SCREEN SCRATCH AND REPAIR
- ANGLE PHONE BALANCING
- LCD REPLACEMENT
- FRONT AND BACK CAMERA REPAIR
- DATA BACK UP AND SOFTWARE UPDATE
- CHARGE PORT REPAIR

15 East Central Street
Private Offices

15
The City, LLC

Town of Franklin



Design Review Commission
Tuesday, May 4, 2021
Meeting Minutes

Vice Chair Baryluk called the above-captioned meeting to order this date at 7:00 PM, **as a Remote Access Virtual Zoom Meeting**. Members in attendance: Vice Chair Chris Baryluk, James Bartro, Sam Williams, Gerald Wood, Associate Venkata Sompally. Members absent: Chair Mark Fitzgerald. Also present: Maxine Kinhart, Administrative Assistant.

As stated on the agenda, due to the continued concerns regarding the COVID-19 virus, this meeting will be conducted as a Remote/Virtual Design Review Commission meeting. In an effort to ensure citizen engagement and comply with open meeting law regulations, citizens will be able to dial into the meeting using the provided phone number, or citizens can participate by using the Zoom link provided on the agenda.

Vice Chair Baryluk authorized Associate Venkata Sompally to vote.

1. **NETA – 5 Kenwood Circle** - Install 3 post & panel directional signs (3' x 3' OAH 10') 9 sq. ft. each: NETA w/Logo – driver entrance (2' x 3' 6 sq. ft.)

Ms. Alyson Ibbotson from Lauretano Sign Group, representing the applicant, stated that the landlord provided a letter regarding the tenants occupying space at the address. No other signage will be allowed on the property other than the existing signage and/or the proposed signage as submitted by NETA. She stated that they are looking at options to increase the sign height to 10 ft. to allow for snow banks and still allow for visibility of the signage. She stated that she submitted two options. Commission members discussed the allowed height. Mr. Williams stated that the sign could be up to 25 ft. high for a free-standing sign in that zone.

Motion: To **Approve** the sign package as submitted with a note that they can do the 10 ft. tall sign. Motioned by S. Williams. Seconded by G. Wood. Roll Call Vote: Bartro-YES; Williams-YES; Wood-YES; Sompally-YES; Baryluk-YES. Voted 5-0-0.

General Matters: Mr. Williams stated that he was at the Franklin Village Plaza; the new Dollar Tree store has vinyl graphics all over their windows which is not allowed. He does not know if the graphics are there for the grand opening or if they will be more permanent. Vice Chair Baryluk stated that in such cases, an email is sent to the inspector letting him know that the Commission is cognizant that the store is in violation under normal circumstances. Ms. Kinhart stated that she thinks if it is for a grand opening, it is allowed. It was noted that this was not part of Dollar Tree's submissions. Commission members discussed that they should enforce the rules and this should be addressed. Vice Chair Baryluk suggested waiting until after the grand opening and following up in a few weeks. Mr. Bartro stated that he is okay with the non-enforcement for the grand opening. Vice Chair Baryluk stated that he could email Building Commissioner Gus Brown. He noted the Commission will keep track of the Dollar Tree store.

Approval of Meeting Minutes: April 20, 2021

Discussion regarding the meeting minutes: Ms. Kinhart stated that she has not sent the response letter to Ms. Whalen yet. When the letter is completed, she will send it to Ms. Whalen and put a copy of the letter in the meeting minutes.

Motion: To **Approve** the April 20, 2021 Meeting Minutes as presented. Motioned by S. Williams. Seconded by V. Sompally. Roll Call Vote: Bartro-ABSTAIN; Williams-YES; Wood-ABSTAIN; Sompally-YES; Baryluk-YES. Voted 3-0-2.

Motion to Adjourn by J. Bartro. Seconded by S. Williams. Roll Call Vote: Bartro-YES; Williams-YES; Wood-YES; Sompally-YES; Baryluk-YES. Voted 5-0-0.

Meeting adjourned at 7:13 PM.

Respectfully submitted,

Judith Lizardi
Recording Secretary

TOWN OF FRANKLIN

DESIGN REVIEW COMMISSION

Mark Fitzgerald, Chairman
Chris Baryluk, Vice Chairman

James Bartro
Samuel Williams
Gerald Wood

Venkata KP Sompally,
Associate

May 11, 2021

Ms. Sharon Whalen
2 Magnolia Drive
Franklin, MA 02038

Dear Ms. Whalen,

Thank you for your interest in the matter of the signage at 150 Emmons Street, Suite 2. It's great to see civic involvement and residents that care about the appearance of our community! We appreciate the time and effort it took to draft a thoughtful letter to the Commission. We immediately added your concerns to the next scheduled open meeting agenda. Prior to the meeting, board members reviewed the original submission and other documentation in order to provide you with a thoughtful response. Members also reviewed current photographs taken of the site.

When originally proposed, the building's owner controlled the whole space and dictated to his tenants what was allowable. He even determined there would be a consistent theme to the signage in terms of arrangement and placement on the building. He set the shapes and layout. At the time, he even dictated colors and fonts. Unfortunately, the building changed hands and the new developer does not have the same interest in signage. He/she/they allowed the PJ Mart applicant to propose their own sign. The DRC was able to hold them to the same foot print and shape, but because the by-law does not specify colors and fonts, we have little recourse on non-illuminated signs. We struggle with "New England Character" because that isn't really defined anywhere. We object to any "neon" colors, but it is difficult to argue that "red, white, and blue" is out of character with a New England town.

Again, thank you for your time to address your concerns and we look forward to hearing from you and the Franklin Community in the future.

Sincerely,

Mark Fitzgerald, Chairman
Chris Baryluk, Vice Chairman
James Bartro
Samuel Williams
Gerald Wood
Venkata KP Sompally, Associate
Franklin Design Review Commission