



License Transaction:

Applicant: PH Franklin d/b/a Public House

The applicant is seeking a new all alcoholic beverages restaurant license to be located at 480 Franklin village Drive. The License Manager will be Glenn J. Stowers.

The following departments have signed off on this application: Treasurer/Collector, Police Department, Town Clerk

The following departments have NOT signed off on this application: Fire Department, Building/Zoning Department and the Health Department

MOTION to approve the request by PH Franklin d/b/a Public House for a new all alcoholic beverages restaurant license and approve the Manager, Glenn J. Stowers.

DATED: _____, 2021

VOTED:

UNANIMOUS: _____

A True Record Attest:

YES: _____ **NO:** _____

ABSTAIN: _____

ABSENT: _____

Nancy Danello
Temporary Town Clerk

Glenn Jones, Clerk
Franklin Town Council

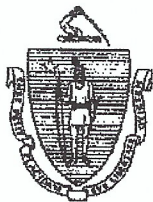

The Commonwealth of Massachusetts
 Alcoholic Beverages Control Commission
 95 Fourth Street, Suite 3, Chelsea, MA 02150-2358
 www.mass.gov/abcc

APPLICATION FOR A NEW LICENSE

Municipality

1. LICENSE CLASSIFICATION INFORMATION

ON/OFF-PREMISES	TYPE	CATEGORY	CLASS
<input type="text" value="On-Premises-12"/>	<input type="text" value="§12 Restaurant"/>	<input type="text" value="All Alcoholic Beverages"/>	<input type="text" value="Annual"/>

Please provide a narrative overview of the transaction(s) being applied for. On-premises applicants should also provide a description of the intended theme or concept of the business operation. Attach additional pages, if necessary.

Applicant seeks a bar restaurant serving casual comfort food. The premises consists of 5,682 sq. ft. with bar and restaurant with an "American Pub" concept. There is also a 700 sq. ft. outdoor deck.

Is this license application pursuant to special legislation? Yes No Chapter Acts of

2. BUSINESS ENTITY INFORMATION

The entity that will be issued the license and have operational control of the premises.

Entity Name FEIN

DBA Manager of Record

Street Address

Phone Email

Alternative Phone Website

3. DESCRIPTION OF PREMISES

Please provide a complete description of the premises to be licensed, including the number of floors, number of rooms on each floor, any outdoor areas to be included in the licensed area, and total square footage. You must also submit a floor plan.

5,682 sq. ft. on one floor consisting of restaurant and bar. There are a total of seven (7) rooms: 3 bathrooms, dining room/bar, kitchen, office and storage closet. There is also an approximate 700 sq. ft. outdoor deck.

Total Square Footage: <input type="text" value="6,382"/>	Number of Entrances: <input type="text" value="1"/>	Seating Capacity: <input type="text" value="180"/>
Number of Floors: <input type="text" value="1"/>	Number of Exits: <input type="text" value="4"/>	Occupancy Number: <input type="text" value="200"/>

4. APPLICATION CONTACT

The application contact is the person whom the licensing authorities should contact regarding this application.

Name: Phone:

Title: Email:

APPLICATION FOR A NEW LICENSE

5. CORPORATE STRUCTURE

Entity Legal Structure	<input type="text" value="Corporation"/>	Date of Incorporation	<input type="text" value="Sep 22, 2020"/>
State of Incorporation	<input type="text" value="Massachusetts"/>	Is the Corporation publicly traded?	<input type="radio"/> Yes <input checked="" type="radio"/> No

6. PROPOSED OFFICERS, STOCK OR OWNERSHIP INTEREST

List all individuals or entities that will have a direct or indirect, beneficial or financial interest in this license (E.g. Stockholders, Officers, Directors, LLC Managers, LLP Partners, Trustees etc.). Attach additional page(s) provided, if necessary, utilizing Addendum A.

- The individuals and titles listed in this section must be identical to those filed with the Massachusetts Secretary of State.
- The individuals identified in this section, as well as the proposed Manager of Record, must complete a CORI Release Form.
- Please note the following statutory requirements for Directors and LLC Managers:
On Premises (E.g. Restaurant/ Club/Hotel) Directors or LLC Managers - At least 50% must be US citizens;
Off Premises(Liquor Store) Directors or LLC Managers - All must be US citizens and a majority must be Massachusetts residents.
- If you are a Multi-Tiered Organization, please attach a flow chart identifying each corporate interest and the individual owners of each entity as well as the Articles of Organization for each corporate entity. Every individual must be identified in Addendum A.

Name of Principal	Residential Address	SSN	DOB
<input type="text" value="Glenn J. Stowers"/>	<input type="text" value="153 Washington St, E. Walpole, MA 02032"/>	<input type="text"/>	<input type="text"/>
Title and or Position	Percentage of Ownership	Director/ LLC Manager	US Citizen
<input type="text" value="President/Treasurer"/>	<input type="text" value="100"/>	<input checked="" type="radio"/> Yes <input type="radio"/> No	<input checked="" type="radio"/> Yes <input type="radio"/> No
MA Resident			
<input checked="" type="radio"/> Yes <input type="radio"/> No			
Name of Principal	Residential Address	SSN	DOB
<input type="text"/>	<input type="text"/>	<input type="text"/>	<input type="text"/>
Title and or Position	Percentage of Ownership	Director/ LLC Manager	US Citizen
<input type="text"/>	<input type="text"/>	<input type="radio"/> Yes <input type="radio"/> No	<input type="radio"/> Yes <input type="radio"/> No
MA Resident			
<input type="radio"/> Yes <input type="radio"/> No			
Name of Principal	Residential Address	SSN	DOB
<input type="text"/>	<input type="text"/>	<input type="text"/>	<input type="text"/>
Title and or Position	Percentage of Ownership	Director/ LLC Manager	US Citizen
<input type="text"/>	<input type="text"/>	<input type="radio"/> Yes <input type="radio"/> No	<input type="radio"/> Yes <input type="radio"/> No
MA Resident			
<input type="radio"/> Yes <input type="radio"/> No			
Name of Principal	Residential Address	SSN	DOB
<input type="text"/>	<input type="text"/>	<input type="text"/>	<input type="text"/>
Title and or Position	Percentage of Ownership	Director/ LLC Manager	US Citizen
<input type="text"/>	<input type="text"/>	<input type="radio"/> Yes <input type="radio"/> No	<input type="radio"/> Yes <input type="radio"/> No
MA Resident			
<input type="radio"/> Yes <input type="radio"/> No			

Additional pages attached? Yes No

CRIMINAL HISTORY
 Has any individual listed in question 6, and applicable attachments, ever been convicted of a State, Federal or Military Crime? If yes, attach an affidavit providing the details of any and all convictions. Yes No

APPLICATION FOR A NEW LICENSE

6A. INTEREST IN AN ALCOHOLIC BEVERAGES LICENSE

Does any individual or entity identified in question 6, and applicable attachments, have any direct or indirect, beneficial or financial interest in any other license to sell alcoholic beverages? Yes No If yes, list in table below. Attach additional pages, if necessary, utilizing the table format below.

Name	License Type	License Name	Municipality

6B. PREVIOUSLY HELD INTEREST IN AN ALCOHOLIC BEVERAGES LICENSE

Has any individual or entity identified in question 6, and applicable attachments, ever held a direct or indirect, beneficial or financial interest in a license to sell alcoholic beverages, which is not presently held? Yes No If yes, list in table below. Attach additional pages, if necessary, utilizing the table format below.

Name	License Type	License Name	Municipality

6C. DISCLOSURE OF LICENSE DISCIPLINARY ACTION

Have any of the disclosed licenses listed in question 6A or 6B ever been suspended, revoked or cancelled? Yes No If yes, list in table below. Attach additional pages, if necessary, utilizing the table format below.

Date of Action	Name of License	City	Reason for suspension, revocation or cancellation

7. OCCUPANCY OF PREMISES

Please complete all fields in this section. Please provide proof of legal occupancy of the premises.

- If the applicant entity owns the premises, a deed is required.
- If leasing or renting the premises, a signed copy of the lease is required.
- If the lease is contingent on the approval of this license, and a signed lease is not available, a copy of the unsigned lease and a letter of intent to lease, signed by the applicant and the landlord, is required.
- If the real estate and business are owned by the same individuals listed in question 6, either individually or through separate business entities, a signed copy of a lease between the two entities is required.

Please indicate by what means the applicant will occupy the premises

Lease

Landlord Name

Landlord Phone

Landlord Email

Landlord Address

Lease Beginning Date

Rent per Month

Lease Ending Date

Rent per Year

Will the Landlord receive revenue based on percentage of alcohol sales?

Yes No

APPLICATION FOR A NEW LICENSE

8. FINANCIAL DISCLOSURE

A. Purchase Price for Real Estate	\$36,861.00
B. Purchase Price for Business Assets	None
C. Other * (Please specify below)	\$250,000.00
D. Total Cost	\$286,861.00

*Other Cost(s): (i.e. Costs associated with License Transaction including but not limited to: Property price, Business Assets, Renovations costs, Construction costs, Initial Start-up costs, Inventory costs, or specify other costs):"

SOURCE OF CASH CONTRIBUTION

Please provide documentation of available funds. (E.g. Bank or other Financial institution Statements, Bank Letter, etc.)

Name of Contributor	Amount of Contribution
PH Franklin, Inc.	\$36,861.00
Glenn J. Stowers	\$250,000.00
Total:	\$286,861.00

SOURCE OF FINANCING

Please provide signed financing documentation.

Name of Lender	Amount	Type of Financing	Is the lender a licensee pursuant to M.G.L. Ch. 138.
			<input type="radio"/> Yes <input type="radio"/> No
			<input type="radio"/> Yes <input type="radio"/> No
			<input type="radio"/> Yes <input type="radio"/> No
			<input type="radio"/> Yes <input type="radio"/> No

FINANCIAL INFORMATION

Provide a detailed explanation of the form(s) and source(s) of funding for the cost identified above.

PH Franklin has paid the initial lease costs. Glenn J. Stowers will be providing any additional capital required from his personal assets either by way of loan to PH Franklin, Inc. or capital contribution.

9. PLEDGE INFORMATION

Please provide signed pledge documentation.

Are you seeking approval for a pledge? Yes No

Please indicate what you are seeking to pledge (check all that apply) License Stock Inventory

To whom is the pledge being made?

10. MANAGER APPLICATION

A. MANAGER INFORMATION

The individual that has been appointed to manage and control the licensed business and premises.

Proposed Manager Name Date of Birth SSN

Residential Address

Email Phone

Please indicate how many hours per week you intend to be on the licensed premises

B. CITIZENSHIP/BACKGROUND INFORMATION

Are you a U.S. Citizen? Yes No *Manager must be a U.S. Citizen

If yes, attach one of the following as proof of citizenship US Passport, Voter's Certificate, Birth Certificate or Naturalization Papers.

Have you ever been convicted of a state, federal, or military crime? Yes No

If yes, fill out the table below and attach an affidavit providing the details of any and all convictions. Attach additional pages, if necessary, utilizing the format below.

Date	Municipality	Charge	Disposition

C. EMPLOYMENT INFORMATION

Please provide your employment history. Attach additional pages, if necessary, utilizing the format below.

Start Date	End Date	Position	Employer	Supervisor Name
1991	present	owner	Mechanical Energy Co.	Glenn J. Stowers
1982	1991	manager	Cold Air Refrigeration	Robert Stowers

D. PRIOR DISCIPLINARY ACTION

Have you held a beneficial or financial interest in, or been the manager of, a license to sell alcoholic beverages that was subject to disciplinary action? Yes No If yes, please fill out the table. Attach additional pages, if necessary,utilizing the format below.

Date of Action	Name of License	State	City	Reason for suspension, revocation or cancellation

I hereby swear under the pains and penalties of perjury that the information I have provided in this application is true and accurate.

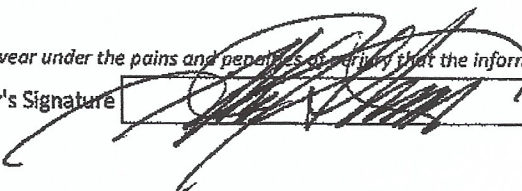
Manager's Signature  Date

11. MANAGEMENT AGREEMENT

Are you requesting approval to utilize a management company through a management agreement?

Yes No

If yes, please fill out section 11.

Please provide a narrative overview of the Management Agreement. Attach additional pages, if necessary.

IMPORTANT NOTE: A management agreement is where a licensee authorizes a third party to control the daily operations of the license premises, while retaining ultimate control over the license, through a written contract. *This does not pertain to a liquor license manager that is employed directly by the entity.*

11A. MANAGEMENT ENTITY

List all proposed individuals or entities that will have a direct or indirect, beneficial or financial interest in the management Entity (E.g. Stockholders, Officers, Directors, LLC Managers, LLP Partners, Trustees etc.).

Entity Name	Address	Phone
<div style="border: 1px solid black; height: 25px;"></div>	<div style="border: 1px solid black; height: 25px;"></div>	<div style="border: 1px solid black; height: 25px;"></div>

Name of Principal	Residential Address	SSN	DOB
<div style="border: 1px solid black; height: 25px;"></div>	<div style="border: 1px solid black; height: 25px;"></div>	<div style="border: 1px solid black; height: 25px;"></div>	<div style="border: 1px solid black; height: 25px;"></div>

Title and or Position	Percentage of Ownership	Director	US Citizen	MA Resident
<div style="border: 1px solid black; height: 25px;"></div>	<div style="border: 1px solid black; height: 25px;"></div>	<input type="radio"/> Yes <input type="radio"/> No	<input type="radio"/> Yes <input type="radio"/> No	<input type="radio"/> Yes <input type="radio"/> No

Name of Principal	Residential Address	SSN	DOB
<div style="border: 1px solid black; height: 25px;"></div>	<div style="border: 1px solid black; height: 25px;"></div>	<div style="border: 1px solid black; height: 25px;"></div>	<div style="border: 1px solid black; height: 25px;"></div>

Title and or Position	Percentage of Ownership	Director	US Citizen	MA Resident
<div style="border: 1px solid black; height: 25px;"></div>	<div style="border: 1px solid black; height: 25px;"></div>	<input type="radio"/> Yes <input type="radio"/> No	<input type="radio"/> Yes <input type="radio"/> No	<input type="radio"/> Yes <input type="radio"/> No

Name of Principal	Residential Address	SSN	DOB
<div style="border: 1px solid black; height: 25px;"></div>	<div style="border: 1px solid black; height: 25px;"></div>	<div style="border: 1px solid black; height: 25px;"></div>	<div style="border: 1px solid black; height: 25px;"></div>

Title and or Position	Percentage of Ownership	Director	US Citizen	MA Resident
<div style="border: 1px solid black; height: 25px;"></div>	<div style="border: 1px solid black; height: 25px;"></div>	<input type="radio"/> Yes <input type="radio"/> No	<input type="radio"/> Yes <input type="radio"/> No	<input type="radio"/> Yes <input type="radio"/> No

Name of Principal	Residential Address	SSN	DOB
<div style="border: 1px solid black; height: 25px;"></div>	<div style="border: 1px solid black; height: 25px;"></div>	<div style="border: 1px solid black; height: 25px;"></div>	<div style="border: 1px solid black; height: 25px;"></div>

Title and or Position	Percentage of Ownership	Director	US Citizen	MA Resident
<div style="border: 1px solid black; height: 25px;"></div>	<div style="border: 1px solid black; height: 25px;"></div>	<input type="radio"/> Yes <input type="radio"/> No	<input type="radio"/> Yes <input type="radio"/> No	<input type="radio"/> Yes <input type="radio"/> No

CRIMINAL HISTORY

Has any individual identified above ever been convicted of a State, Federal or Military Crime?

Yes No

If yes, attach an affidavit providing the details of any and all convictions.

11B. EXISTING MANAGEMENT AGREEMENTS AND INTEREST IN AN ALCOHOLIC BEVERAGES

LICENSE

Does any individual or entity identified in question 11A, and applicable attachments, have any direct or indirect, beneficial or financial interest in any other license to sell alcoholic beverages; and or have an active management agreement with any other licensees?

Yes No If yes, list in table below. Attach additional pages, if necessary, utilizing the table format below.

Name	License Type	License Name	Municipality

11C. PREVIOUSLY HELD INTEREST IN AN ALCOHOLIC BEVERAGES LICENSE

Has any individual or entity identified in question 11A, and applicable attachments, ever held a direct or indirect, beneficial or financial interest in a license to sell alcoholic beverages, which is not presently held?

Yes No If yes, list in table below. Attach additional pages, if necessary, utilizing the table format below.

Name	License Type	License Name	Municipality

11D. PREVIOUSLY HELD MANAGEMENT AGREEMENT

Has any individual or entity identified in question 11A, and applicable attachments, ever held a management agreement with any other Massachusetts licensee?

Yes No If yes, list in table below. Attach additional pages, if necessary, utilizing the table format below.

Licensee Name	License Type	Municipality	Date(s) of Agreement

11E. DISCLOSURE OF LICENSE DISCIPLINARY ACTION

Has any of the disclosed licenses listed in questions in section 11B, 11C, 11D ever been suspended, revoked or cancelled?

Yes No If yes, list in table below. Attach additional pages, if necessary, utilizing the table format below.

Date of Action	Name of License	City	Reason for suspension, revocation or cancellation

11F. TERMS OF AGREEMENT

- a. Does the agreement provide for termination by the licensee? Yes No
- b. Will the licensee retain control of the business finances? Yes No
- c. Does the management entity handle the payroll for the business? Yes No

d. Management Term Begin Date e. Management Term End Date

f. How will the management company be compensated by the licensee? (check all that apply)

- \$ per month/year (indicate amount)
- % of alcohol sales (indicate percentage)
- % of overall sales (indicate percentage)
- other (please explain)

ABCC Licensee Officer/LLC Manager

Management Agreement Entity Officer/LLC Manager

Signature:
 Title:
 Date:

Signature:
 Title:
 Date:

APPLICANT'S STATEMENT

I, Glenn J. Stowers the: sole proprietor; partner; corporate principal; LLC/LLP manager
Authorized Signatory

of PH Franklin, Inc.
Name of the Entity/Corporation

hereby submit this application (hereinafter the "Application"), to the local licensing authority (the "LLA") and the Alcoholic Beverages Control Commission (the "ABCC" and together with the LLA collectively the "Licensing Authorities") for approval.

I do hereby declare under the pains and penalties of perjury that I have personal knowledge of the information submitted in the Application, and as such affirm that all statements and representations therein are true to the best of my knowledge and belief. I further submit the following to be true and accurate:

- (1) I understand that each representation in this Application is material to the Licensing Authorities' decision on the Application and that the Licensing Authorities will rely on each and every answer in the Application and accompanying documents in reaching its decision;
- (2) I state that the location and description of the proposed licensed premises are in compliance with state and local laws and regulations;
- (3) I understand that while the Application is pending, I must notify the Licensing Authorities of any change in the information submitted therein. I understand that failure to give such notice to the Licensing Authorities may result in disapproval of the Application;
- (4) I understand that upon approval of the Application, I must notify the Licensing Authorities of any change in the ownership as approved by the Licensing Authorities. I understand that failure to give such notice to the Licensing Authorities may result in sanctions including revocation of any license for which this Application is submitted;
- (5) I understand that the licensee will be bound by the statements and representations made in the Application, including, but not limited to the identity of persons with an ownership or financial interest in the license;
- (6) I understand that all statements and representations made become conditions of the license;
- (7) I understand that any physical alterations to or changes to the size of the area used for the sale, delivery, storage, or consumption of alcoholic beverages, must be reported to the Licensing Authorities and may require the prior approval of the Licensing Authorities;
- (8) I understand that the licensee's failure to operate the licensed premises in accordance with the statements and representations made in the Application may result in sanctions, including the revocation of any license for which the Application was submitted; and
- (9) I understand that any false statement or misrepresentation will constitute cause for disapproval of the Application or sanctions including revocation of any license for which this Application is submitted.
- (10) I confirm that the applicant corporation and each individual listed in the ownership section of the application is in good standing with the Massachusetts Department of Revenue and has complied with all laws of the Commonwealth relating to taxes, reporting of employees and contractors, and withholding and remitting of child support.

Signature: 

Date: 10/5/20

Title: President

CORPORATE VOTE

The Board of Directors or LLC Managers of Entity Name
duly voted to apply to the Licensing Authority of City/Town and the
Commonwealth of Massachusetts Alcoholic Beverages Control Commission on Date of Meeting

For the following transactions (Check all that apply):

- New License
- Change of Location
- Change of Class (i.e. Annual / Seasonal)
- Change Corporate Structure (i.e. Corp / LLC)
- Transfer of License
- Alteration of Licensed Premises
- Change of License Type (i.e. club / restaurant)
- Pledge of Collateral (i.e. License/Stock)
- Change of Manager
- Change Corporate Name
- Change of Category (i.e. All Alcohol/Wine, Malt)
- Management/Operating Agreement
- Change of Officers/
Directors/LLC Managers
- Change of Ownership Interest
(LLC Members/ LLP Partners,
Trustees)
- Issuance/Transfer of Stock/New Stockholder
- Change of Hours
- Other
- Change of DBA

"VOTED: To authorize Name of Person

to sign the application submitted and to execute on the Entity's behalf, any necessary papers and do all things required to have the application granted."

"VOTED: To appoint Name of Liquor License Manager

as its manager of record, and hereby grant him or her with full authority and control of the premises described in the license and authority and control of the conduct of all business therein as the licensee itself could in any way have and exercise if it were a natural person residing in the Commonwealth of Massachusetts."

A true copy attest,

Corporate Officer / LLC Manager Signature

(Print Name)

For Corporations ONLY

A true copy attest,

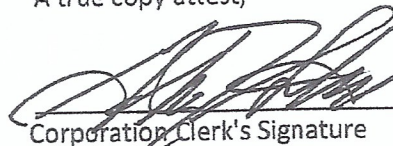
Corporation Clerk's Signature

(Print Name)



JEAN M. LORIZIO, ESQ.
CHAIRMAN

Commonwealth of Massachusetts
Alcoholic Beverages Control Commission
95 Fourth Street, Suite 3
Chelsea, MA 02150

CORI REQUEST FORM

The Alcoholic Beverages Control Commission ("ABCC") has been certified by the Criminal History Systems Board to access conviction and pending Criminal Offender Record Information ("CORI"). For the purpose of approving each shareholder, owner, licensee or applicant for an alcoholic beverages license, I understand that a criminal record check will be conducted on me, pursuant to the above. The information below is correct to the best of my knowledge.

ABCC LICENSE INFORMATION

ABCC NUMBER: <small>(IF EXISTING LICENSEE)</small>	<input type="text"/>	LICENSEE NAME:	PH Franklin Inc	CITY/TOWN:	Franklin MA
---	----------------------	----------------	-----------------	------------	-------------

APPLICANT INFORMATION

LAST NAME:	Stowers	FIRST NAME:	Glenn	MIDDLE NAME:	Joseph
MAIDEN NAME OR ALIAS (IF APPLICABLE):	<input type="text"/>	PLACE OF BIRTH:	<input type="text"/>		
DATE OF BIRTH:	<input type="text"/>	SSN:	<input type="text"/>	ID THEFT INDEX PIN (IF APPLICABLE):	<input type="text"/>
MOTHER'S MAIDEN NAME:	<input type="text"/>	DRIVER'S LICENSE #:	<input type="text"/>	STATE LIC. ISSUED:	<input type="text"/>
GENDER:	MALE	HEIGHT:	<input type="text"/>	WEIGHT:	<input type="text"/>
			<input type="text"/>	EYE COLOR:	<input type="text"/>
CURRENT ADDRESS:	<input type="text"/>				
CITY/TOWN:	<input type="text"/>	STATE:	MA	ZIP:	<input type="text"/>
FORMER ADDRESS:	<input type="text"/>				
CITY/TOWN:	<input type="text"/>	STATE:	MA	ZIP:	<input type="text"/>

PRINT AND SIGN

PRINTED NAME:	Glenn J Stowers	APPLICANT/EMPLOYEE SIGNATURE:	
---------------	-----------------	-------------------------------	--

NOTARY INFORMATION

On this December 22, 2020 before me, the undersigned notary public, personally appeared Glenn J. Stowers
(name of document signer), proved to me through satisfactory evidence of identification, which were known to me
to be the person whose name is signed on the preceding or attached document, and acknowledged to me that (he) (she) signed it voluntarily for its stated purpose.

NOTARY

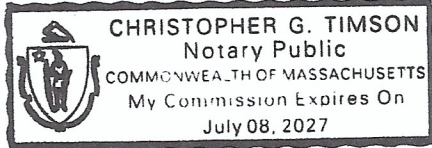

DIVISION USE ONLY

REQUESTED BY:	<input type="text"/>
	<small>SIGNATURE OF CORI-AUTHORIZED EMPLOYEE</small>

The DCJ Identify Theft Index PIN Number is to be completed by those applicants that have been issued an Identify Theft PIN Number by the DCJ. Certified agencies are required to provide all applicants the opportunity to include this information to ensure the accuracy of the CORI request process. ALL CORI request forms that include this field are required to be submitted to the DCJ via mail or by fax to (617) 660-4614.

Payment Confirmation

YOUR PAYMENT HAS PROCESSED AND THIS IS YOUR RECEIPT

Your account has been billed for the following transaction. You will receive a receipt via email.



Transaction Processed Successfully.

Description	Applicant, License or Registration Number	Amount
FILING FEES-RETAIL	PH Franklin Inc	\$200.00
		\$200.00

Total Convenience Fee: **\$4.70**

Date Paid: **10/7/2020 1:36:13 PM EDT**

Total Amount Paid: **\$204.70**

Payment On Behalf Of
License Number or Business Name:
PH Franklin Inc

Fee Type:
FILING FEES-RETAIL

Billing Information
First Name:
Glenn

Last Name:
Stowers



**The Commonwealth of Massachusetts
William Francis Galvin**

Minimum Fee: \$250.00

Secretary of the Commonwealth, Corporations Division
One Ashburton Place, 17th floor
Boston, MA 02108-1512
Telephone: (617) 727-9640

Articles of Organization

(General Laws, Chapter 156D, Section 2.02; 950 CMR 113.16)

Identification Number:

ARTICLE I

The exact name of the corporation is:

PH FRANKLIN, INC.

ARTICLE II

Unless the articles of organization otherwise provide, all corporations formed pursuant to G.L. C156D have the purpose of engaging in any lawful business. Please specify if you want a more limited purpose:

TO CARRY ON A BUSINESS THAT OWNS, MANAGES, AND DEVELOPS RESTAURANTS INCLUDING FULL SERVICE RESTAURANTS AND BARS WHICH PURCHASE, PREPARE AND SELL FOOD, MALT, WINE AND LIQUOR AND TO THAT END TO DO ANY OTHER BUSINESS AND INCIDENTAL THERETO, CONNECTED THEREWITH; AND THE DOING AND PERFORMING OF ANY AND ALL ACTS OR THINGS NECESSARY, PROPER OR CONVENIENT FOR OR INCIDENTAL TO THE FURTHERANCE OF THE CARRYING OUT OF THE POWERS OR PURPOSES HEREIN MENTIONED. TO ENTER INTO AND PERFORM ALL MANNER AND KINDS OF CONTRACTS, AGREEMENTS, AND OBLIGATIONS FOR ANY LAWFUL PURPOSE BY OR WITH ANY PERSON, FIRM, ASSOCIATION, CORPORATION, FINANCIAL INSTITUTION, LENDER, OR GOVERNMENTAL DIVISION OR SUBDIVISION. TO BUY, ACQUIRE, LEASE, OR OTHERWISE ACQUIRE REAL PROPERTY AND ANY INTEREST OR RIGHT THEREIN; AND TO TREAT SUCH PROPERTY IN ANY MANNER NECESSARY, USEFUL OR ADVANTAGEOUS FOR THE PURPOSES OF THIS CORPORATION. IN GENERAL, TO HAVE AND EXERCISE ANY AND ALL POWERS THAT CORPORATIONS HAVE AND MAY EXERCISE UNDER THE LAWS OF THE COMMONWEALTH OF MASSACHUSETTS, AS THE SAME MAY BE AMENDED. TO DO ALL AND EVERYTHING NECESSARY, SUITABLE, OR PROPER FOR THE ACCOMPLISHMENT OF ANY OF THE PURPOSES, THE ATTAINMENT OF ANY OF THE OBJECTS, OR THE EXERCISE OF ANY OF THE POWERS HEREIN SET FORTH, EITHER ALONE OR IN CONJUNCTION WITH OTHER CORPORATIONS, FIRMS, OR INDIVIDUALS, AND EITHER AS PRINCIPAL OR AGENTS, AND TO DO EVERY OTHER ACT OR ACTS, THING OR THINGS, INCIDENTAL OR APPURTENANT TO OR GROWING OUT OF OR CONNECTED WITH THE ABOVE- MENTIONED OBJECTS, PURPOSE, OR POWER.

ARTICLE III

State the total number of shares and par value, if any, of each class of stock that the corporation is authorized to issue. All corporations must authorize stock. If only one class or series is authorized, it is not necessary to specify any particular designation.

Class of Stock	Par Value Per Share Enter 0 if no Par	Total Authorized by Articles of Organization or Amendments	Total Issued and Outstanding
----------------	--	---	---------------------------------

		<i>Num of Shares</i>	<i>Total Par Value</i>	<i>Num of Shares</i>
CNP	\$0.00000	200,000	\$0.00	101,000

G.L. C156D eliminates the concept of par value, however a corporation may specify par value in Article III. See G.L. C156D Section 6.21 and the comments thereto.

ARTICLE IV

If more than one class of stock is authorized, state a distinguishing designation for each class. Prior to the issuance of any shares of a class, if shares of another class are outstanding, the Business Entity must provide a description of the preferences, voting powers, qualifications, and special or relative rights or privileges of that class and of each other class of which shares are outstanding and of each series then established within any class.

ARTICLE V

The restrictions, if any, imposed by the Articles of Organization upon the transfer of shares of stock of any class are:

"RESTRICTIONS ON TRANSFER OF SHARES OF STOCK" NO PRESENT OR FUTURE STOCKHOLDER OF THE CORPORATION OR HIS EXECUTOR, ADMINISTRATOR, OR PERSONAL REPRESENTATIVE SHALL ENCUMBER OR DISPOSE OF THE STOCK OF THE CORPORATION WHICH HE NOW OWNS OR MAY HEREAFTER ACQUIRE, EXCEPT AS FOLLOWS: (A) ANY STOCKHOLDER MAY TRANSFER ANY PART OR ALL OF SUCH STOCK BY TESTATE DIRECTION OR INTESTATE DISTRIBUTION AT THE TIME OF HIS DEATH TO OR FOR THE BENEFIT OF ANY PERSON OR PERSONS, OR BY GIFT TO, OR IN TRUST FOR THE BENEFIT OF HIMSELF, HIS SPOUSE, HIS PARENT OR PARENTS, OR ANY DESCENDANT OR DESCENDANTS OF HIS. IN CASE OF ANY SUCH TRANSFER, THE LEGATEES, HEIRS, NEXT OF KIN, DONEES, OR OTHER TRANSFEREES SHALL RECEIVE AND HOLD SUCH STOCK SUBJECT TO THE RESTRICTIONS ON ENCUMBRANCE AND DISPOSITIONS SET FORTH IN THIS ARTICLE FIFTH OF THE ARTICLES OF ORGANIZATION. (B) ANY STOCKHOLDER WHO DESIRES TO SELL ALL OR ANY PART OF SUCH STOCK SHALL FIRST OFFER IN WRITING SUCH STOCK FOR SALE TO THE CORPORATION AT THE SAME PRICE AND UPON THE SAME TERMS OFFERED TO SUCH STOCKHOLDER BY A BONA FIDE PROSPECTIVE PURCHASER OF SUCH SHARES. THE CORPORATION SHALL HAVE THE OPTION FOR TEN (10) DAYS AFTER ITS RECEIPT OF SUCH WRITTEN OFFER TO ACCEPT SUCH OFFER. IF, WITHIN SUCH TEN-DAY PERIOD, THE CORPORATION SHALL FAIL TO ACCEPT SUCH OFFER IN ITS ENTIRETY, ITS OPTION HEREUNDER AS TO SUCH OFFER SHALL TERMINATE. THEREUPON, THE STOCKHOLDERS SO DESIRING TO SELL ALL OR PART OF HIS STOCK SHALL MAKE THE SAME OFFER (BEING AN OFFER IN WRITING TO SELL SUCH STOCK AT THE SAME PRICE AND UPON THE SAME TERMS OFFERED TO SUCH STOCKHOLDER BY A BONA FIDE PROSPECTIVE PURCHASER OF SUCH SHARES) TO ALL OF THE OTHER THEN STOCKHOLDERS OF THE CORPORATION (AS A GROUP), AND SHALL GIVE WRITTEN NOTICE OF SUCH OFFER TO ALL OF THE OTHER THEN STOCKHOLDERS. SUCH OTHER STOCKHOLDERS SHALL HAVE THE OPTION FOR THIRTY (30) DAYS AFTER THEIR RECEIPT OF SUCH WRITTEN OFFER TO ACCEPT SUCH OFFER IN SUCH PROPORTIONS AMONG THEMSELVES AS THEY MAY AGREE, AND IF THEY DO NOT AGREE, THEN EACH SUCH STOCKHOLDER WHO DESIRES TO ACCEPT SUCH OFFER SHALL HAVE THE RIGHT TO PURCHASE SUCH A FRACTION OF SUCH SHARES OF STOCK AS IS COMPUTED AS FOLLOWS: (I) THE NUMERATOR OF THE FRACTION SHALL BE THE NUMBER CORRESPONDING TO THE NUMBER OF SHARES OF STOCK OF THE CORPORATION THEN OWNED BY SUCH STOCKHOLDER WHO DESIRES TO ACCEPT SUCH OFFER; (II) THE DENOMINATOR OF SUCH FRACTION SHALL BE THE NUMBER CORRESPONDING TO THE SUM OF ALL OF THE SHARES OF STOCK THEN OWNED BY ALL OF THE THEN STOCKHOLDERS WHO DESIRE TO ACCEPT SUCH OFFER; PROVIDED, HOWEVER, THAT NO STOCKHOLDER SHALL HAVE THE RIGHT TO PURCHASE ANY PART OF THE SHARES SO OFFERED FOR SALE UNLESS ALL OF SUCH SHARES SO OFFERED FOR SALE ARE PURCHASED, PURSUANT TO SUCH OFFER, BY ONE OR MORE OF SUCH OFFEREE STOCKHOLDERS. IF NO STOCKHOLDER OR STOCKHOLDERS EXERCISE SUCH OPTION WITHIN THE AFORESAID THIRTY-DAY PERIOD

D, THEN THE STOCKHOLDER SO DESIRING TO SELL PART OR ALL OF HIS STOCK SHALL HAVE THE RIGHT FOR A PERIOD ENDING ON THE SIXTIETH (60TH) DAY AFTER THE EXPIRATION OF THE AFORESAID THIRTY-DAY PERIOD, TO SELL SUCH STOCK TO, AND ONLY TO, THE AFORESAID BONA FIDE PROSPECTIVE PURCHASER IN THE SAME QUANTITY, AT THE SAME PRICE, AND UPON THE SAME TERMS AS WERE OFFERED TO THE OTHER STOCKHOLDERS AND/OR THE CORPORATION. UPON THE EXPIRATION OF SUCH 60-DAY PERIOD, IF SUCH STOCKHOLDER DOES NOT SELL SUCH STOCK, ALL OF THE RESTRICTIONS IMPOSED BY THIS ARTICLE FIFTH OF THE ARTICLES OF ORGANIZATION SHALL APPLY TO ALL OF THE STOCK OWNED BY SUCH STOCKHOLDER.

ARTICLE VI

Other lawful provisions, and if there are no provisions, this article may be left blank.

CONTINUATION SHEET VI SPECIAL PROVISIONS ONE. ALL CORPORATE POWERS OF THE CORPORATION SHALL BE EXERCISED BY THE BOARD OF DIRECTORS EXCEPT AS OTHERWISE PROVIDED BY LAW. IN FURTHERANCE AND NOT IN LIMITATION OF THE POWERS CONFERRED BY STATUTE, THE BOARD OF DIRECTORS IS EXPRESSLY AUTHORIZED TO MAKE, AMEND OR REPEAL THE BY-LAWS OF THE CORPORATION IN WHOLE OR IN PART, EXCEPT WITH RESPECT TO ANY PROVISION THEREOF WHICH BY LAW OR THE BY-LAWS REQUIRES ACTION BY THE STOCKHOLDERS, AND SUBJECT TO THE POWER OF THE STOCKHOLDERS TO AMEND OR REPEAL ANY BY-LAW ADOPTED BY THE BOARD OF DIRECTORS. TWO. IN THE ABSENCE OF FRAUD, NO CONTRACT OR OTHER TRANSACTION OF THE CORPORATION SHALL BE AFFECTED OR INVALIDATED BY THE FACT THAT ANY OF THE DIRECTORS OF THE CORPORATION ARE IN ANY WAY INTERESTED IN OR CONNECTED WITH ANY OTHER PARTY SO SUCH CONTRACT OR TRANSACTION OR ARE THEMSELVES PARTIES TO SUCH CONTRACT OR TRANSACTION, PROVIDED THAT THE INTEREST IN ANY SUCH CONTRACT OR TRANSACTION OF ANY SUCH DIRECTOR SHALL AT THE TIME BE FULLY DISCLOSED OR OTHERWISE KNOWN TO THE BOARD OF DIRECTORS. ANY DIRECTOR OF THE CORPORATION MAY BE COUNTED IN DETERMINING THE EXISTENCE OF A QUORUM AT ANY MEETING OF THE BOARD OF DIRECTORS WHICH SHALL AUTHORIZE SUCH CONTRACT OR TRANSACTION AND MAY VOTE AND ACT UPON ANY MATTER, CONTRACT OR TRANSACTION BETWEEN THE CORPORATION AND ANY OTHER PERSON WITHOUT REGARD TO THE FACT THAT HE IS ALSO A STOCKHOLDER, DIRECTOR OR OFFICER OF, OR HAS ANY INTEREST IN, SUCH OTHER PERSON WITH THE SAME FORCE AND EFFECT AS IF HE WERE NOT SUCH A STOCKHOLDER, DIRECTOR OR OFFICER OR NOT SO INTERESTED. ANY CONTRACT OR OTHER TRANSACTION OF THE CORPORATION OR OF THE BOARD OF DIRECTORS OR OF ANY COMMITTEE THEREOF WHICH SHALL BE RATIFIED BY A MAJORITY OF THE HOLDERS OF THE ISSUED AND OUTSTANDING STOCK ENTITLED TO VOTE ANY ANNUAL MEETING OR ANY SPECIAL MEETING CALLED FOR THAT PURPOSE SHALL BE AS VALID AND AS BINDING AS THOUGH RATIFIED BY EVERY STOCKHOLDER OF THE CORPORATION, PROVIDED, HOWEVER, THAT ANY FAILURE OF THE STOCKHOLDERS TO APPROVE OR RATIFY SUCH CONTRACT OR OTHER TRANSACTION, WHEN AND IF SUBMITTED, SHALL NOT BE DEEMED IN ANY WAY TO RENDER THE SAME INVALID OR DEPRIVE THE DIRECTORS AND OFFICERS OF THEIR RIGHT TO PROCEED WITH SUCH CONTRACT OR OTHER TRANSACTION. THREE. MEETINGS OF THE STOCKHOLDERS OF THE CORPORATION MAY BE HELD ANYWHERE WITHIN THE UNITED STATES. FOUR. NO CURRENT OR FORMER DIRECTOR OF THE CORPORATION SHALL BE PERSONALLY LIABLE TO THE CORPORATION OR ITS STOCKHOLDERS FOR MONETARY DAMAGES FOR OR ARISING OUT OF A BREACH OF FIDUCIARY DUTY AS A DIRECTOR NOTWITHSTANDING ANY PROVISION OF LAW IMPOSING SUCH LIABILITY; PROVIDED, HOWEVER, THAT THE FOREGOING SHALL NOT ELIMINATE OR LIMIT THE LIABILITY OF A CURRENT OR FORMER DIRECTOR (I) FOR A BREACH OF THE DIRECTOR'S DUTY OF LOYALTY TO THE CORPORATION OR ITS STOCKHOLDERS, (II) FOR ACTS OR OMISSIONS NOT IN GOOD FAITH OR WHICH INVOLVE INTENTIONAL MISCONDUCT OR A KNOWING VIOLATION OF LAW, (III) UNDER MASSACHUSETTS GENERAL LAWS CHAPTER 156D. OR (IV) FOR ANY TRANSACTION FROM WHICH THE DIRECT

OR DERIVED AN IMPROPER PERSONAL BENEFIT. THE FOREGOING PROVISION SHALL NOT ELIMINATE OR LIMIT THE LIABILITY OF A DIRECTOR FOR ANY ACT OR OMISSION OCCURRING PRIOR TO THE DATE UPON WHICH THE FOREGOING PROVISION BECAME EFFECTIVE. TO THE EXTENT PERMITTED BY LAW, NO AMENDMENT OR DELETION OF THE FOREGOING PROVISIONS OF THIS PARAGRAPH FOUR WHICH RESTRICTS OR LIMITS THE PROTECTION PROVIDED THEREUNDER TO CURRENT OR FORMER DIRECTORS SHALL BE EFFECTIVE WITH RESPECT TO ACTIONS AND OMISSIONS OF THE DIRECTORS OCCURRING PRIOR TO THE DATE SAID AMENDMENT OR DELETION BECAME EFFECTIVE.

Note: The preceding six (6) articles are considered to be permanent and may be changed only by filing appropriate articles of amendment.

ARTICLE VII

The effective date of organization and time the articles were received for filing if the articles are not rejected within the time prescribed by law. If a *later* effective date is desired, specify such date, which may not be later than the *90th day* after the articles are received for filing.

Later Effective Date: Time:

ARTICLE VIII

The information contained in Article VIII is not a permanent part of the Articles of Organization.

a,b. The street address of the initial registered office of the corporation in the commonwealth and the name of the initial registered agent at the registered office:

Name: CHRISTOPHER G. TIMSON
 No. and Street:
 City or Town:

c. The names and street addresses of the individuals who will serve as the initial directors, president, treasurer and secretary of the corporation (an address need not be specified if the business address of the officer or director is the same as the principal office location):

Title	Individual Name First, Middle, Last, Suffix	Address (no PO Box) Address, City or Town, State, Zip Code
PRESIDENT	GLENN J. STOWERS	
TREASURER	GLENN J. STOWERS	
SECRETARY	GLENN J. STOWERS	
DIRECTOR	GLENN J. STOWERS	

d. The fiscal year end (i.e., tax year) of the corporation:
 December

e. A brief description of the type of business in which the corporation intends to engage:

RESTAURANT AND BAR

f. The street address (post office boxes are not acceptable) of the principal office of the corporation:

No. and Street:

City or Town:

Country: USA

g. Street address where the records of the corporation required to be kept in the Commonwealth are located (post office boxes are not acceptable):

No. and Street:

City or Town:

Country: USA

which is

its principal office

an office of its transfer agent

an office of its secretary/assistant secretary

its registered office

Signed this 22 Day of September, 2020 at 2:58:05 PM by the incorporator(s). *(If an existing corporation is acting as incorporator, type in the exact name of the business entity, the state or other jurisdiction where it was incorporated, the name of the person signing on behalf of said business entity and the title he/she holds or other authority by which such action is taken.)*

GLENN J. STOWERS, PRESIDENT

THE COMMONWEALTH OF MASSACHUSETTS

I hereby certify that, upon examination of this document, duly submitted to me, it appears that the provisions of the General Laws relative to corporations have been complied with, and I hereby approve said articles; and the filing fee having been paid, said articles are

deemed to have been filed with me on:

September 22, 2020 02:50 PM

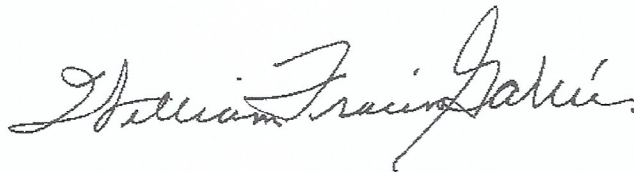
A handwritten signature in cursive script that reads "William Francis Galvin". The signature is written in dark ink and is centered on the page.

WILLIAM FRANCIS GALVIN

Secretary of the Commonwealth

ISSUED	DATE

EXHIBIT
SUBMITTAL FOR LIQUOR
LICENSE

DATE: 10/10/2020
SCALE: AS NOTED
DATE: 10/10/2020
SCALE: AS NOTED

The Public House Franklin
280 FRANKLIN VILLAGE DRIVE, FRANKLIN, MA
02038-4005

SEAT COUNT

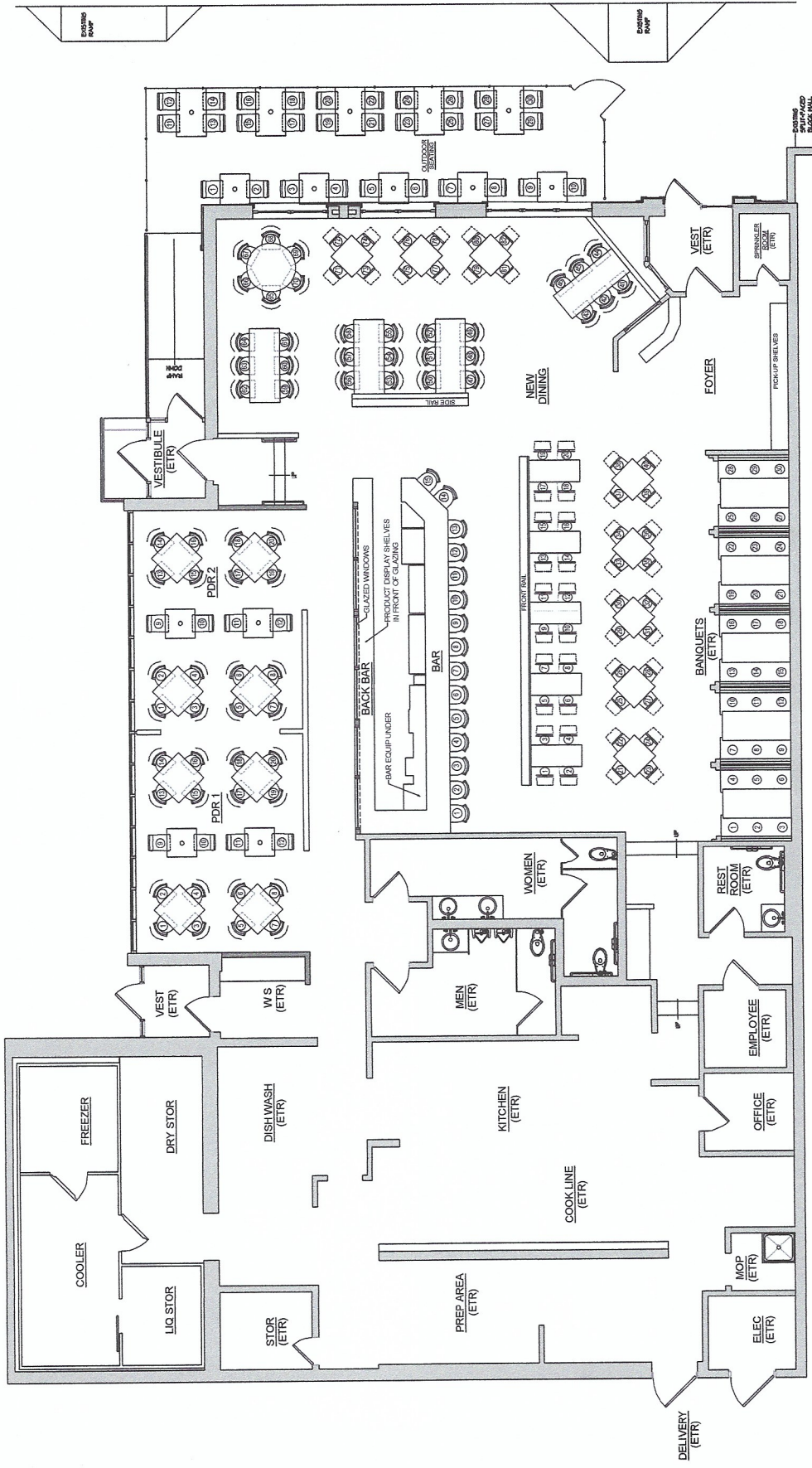

KEY

- EXISTING WALLS
- NEW WALLS
- EXISTING HALLWAYS TO REMAIN
- ETR = EXISTING TO REMAIN

1 LONG BAR SEAT COUNT (NO STANDING)
1/4" = 1'-0"

0 2 4 8 16 32

AREA	# OF SEATS	NOTES
PDR.1	25	25 MAX. 20 SHOWN
PDR.2	25	
BAR	15	
FREE-STANDING TABLE & CHAIRS	82	
BANQUETS (COZIES)	30	
SUB-TOTAL	177	
OUTDOORS	30	
	207	

Note: Seat Count is for the layout shown.
- It is not part of an egress calculation, and
- It does not include standing or waiting area

SHOPPING CENTER
LEASE AGREEMENT

Tenant: PH FRANKLIN, INC.

Landlord: CSC FRANKLIN VILLAGE LP

Center: FRANKLIN VILLAGE PLAZA SHOPPING CENTER

INDEX

<u>Paragraph</u>	<u>Title</u>
	Fundamental Lease Provisions
1	References
2	Premises
3	Term
4	Minimum Rent
5	Security Deposit
6 (a)	Percentage Rent
6 (b)	Sales Reporting
7	"Gross Sales" Defined
8	Landlord's and Tenant's Work
9	Conduct of Business
10	Common Areas; Common Area Maintenance Costs
11	Use of Premises; Compliance with Laws
12	Marketing Fund
13	Utilities and Services
14	Repairs by Landlord
15	Repairs and Maintenance by Tenant
16	Taxes
17	Tenant Fixtures; Decorations
18	Signs
19	Alterations; Liens
20	Indemnity; Liability of Tenant and Landlord
21	Insurance
22	Damage by Fire or Other Casualty
23	Assignment and Subletting
24	Condemnation
25	Default; Remedies
26	Mortgages
27	Successors and Assigns
28	Access to Premises
29	Termination
30	Estate in Land
31	Holding Over
32	Interest; Attorney's Fees
33	Recording
34	Non-Waiver
35	Time of the Essence
36	Severability
37	Relocation
38	Notices
39	Force Majeure
40	Brokerage
41	Landlord's Liability
42	Captions
43	Entire Agreement; Amendment; Consents
44	Jurisdiction and Venue
45	Tenant Obligations
46	Rules and Regulations
47	Transfer Taxes
48	Confession of Judgment; Waiver
49	Quiet Enjoyment
50	Furnishing of Financial Statements
51	Trade Name
52	Waiver of Counterclaims, Trial by Jury and Certain Damages
53	Specific Performance of Landlord's Rights
54	Execution and Authority
55	Tenant Damages
56	Payment by Electronic Transfer
57	Patriot Act

Exhibits:

- Exhibit A - Premises
- Exhibit B - Landlord's Work
- Exhibit C - Exclusives and Prohibited Uses
- Exhibit D - Sign Criteria
- Exhibit D-1 - Pylon Sign
- Exhibit E - Rules and Regulations
- Exhibit F - Form of Tender of Delivery Notice

(including reasonable attorneys' fees and costs) arising from or related to any breach of the foregoing certification.

IN WITNESS WHEREOF, the parties hereto have duly executed this Lease and exhibits thereto in duplicate, individually or through their authorized officers, agents, or attorneys-in-fact, as the case may be, causing their respective seals to be affixed hereto the day and year first above written.

WITNESS:

LANDLORD:

CSC FRANKLIN VILLAGE LP

DocuSigned by:
Karen Gerard
720C9B5A892T43B...

DocuSigned by:
Robin Zeigler
By: _____
Name: *Robin Zeigler*
Title: chief operating officer

WITNESS:

TENANT:

PH FRANKLIN, INC.

Carol F. Brown

By: _____
Name: *Carol F. Brown*
Title: *President.*

EXHIBIT A
PREMISES

Franklin Village Plaza - Site Plan

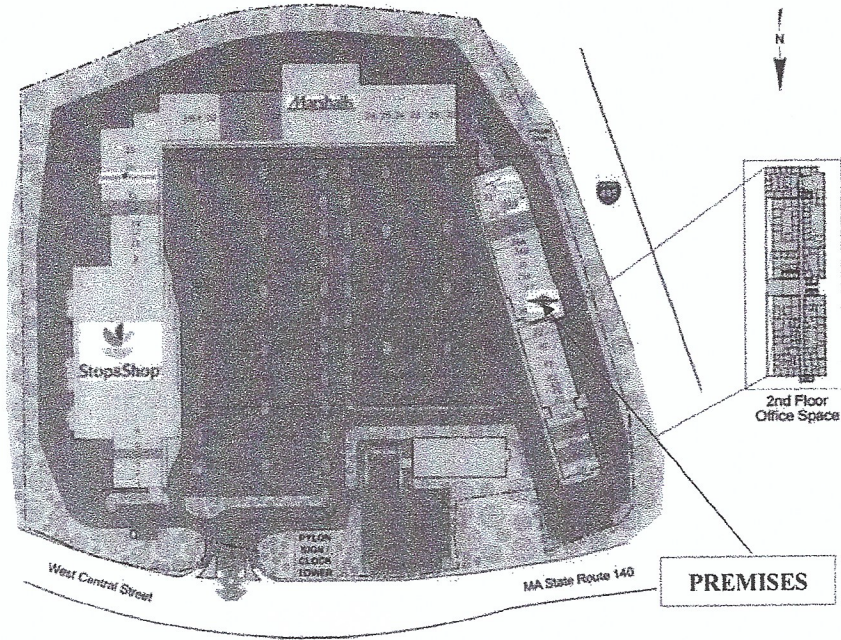

Note: All spaces depicted on this site plan are for general informational purposes only, and are not represented to be drawn to scale. No party shall rely upon this drawing with respect to the final location or size of spaces within the Shopping Center. Additionally, no representation is made with respect to the continuing occupancy of any tenant depicted on the site plan unless expressly contained in the body of the Lease.

EXECUTIVE SUMMARY

Glenn J Stowers

Accomplished executive with a vast and diverse history. Entrepreneurial spirit showcasing a quantified track record of results. Strengths are focused on identifying skills in others and nurturing them at all different levels of development. This has led to a career full of stability and eclectic ventures with a solid base concept. The items listed below are a representation of some events and time lines up to this point which have shaped the current approach to business.

Graduated from a Burr De Coe Vocational high school in East Brunswick NJ.
1977-1982

Only graduate to attend collage directly from the graduating class.

Completed 2 years Middlesex County college in NJ. No degree.

Completed field specific studies at North Eastern University. No degree.

Cool-It Refrigeration:

1978 through 1984

Technician

While in high school and immediately following I worked summers and breaks at the family owned refrigeration company in Cambridge MA learning mechanical skills and observing grass roots management styles.

Cold-Aire Refrigeration:

1984-1991

Technician

The family organization changed names as partners were augmented. I remained an employee and continued my root education in the mechanical disciplines. During this time I received my education on self-reliance and realized the results of work verses reward.

Building Environments Corporation:

1991-2000

Principal.

BEC (Building Environments Corp) was started as an attempt to stand out from the family organization and identify as an individual. The core concept was to lean on the things I had been taught and not hide in the wings but to gain the opportunity to implement all the things I felt were the correct directions. The largest learning curve of this initial experience was that nothing is as easy as it looks and the real path is a slow methodical, incremental approach.

I continued to focus and developed an affinity for larger clients, a comfort with this type of client was due to early teachings by my father who showed me through example that these larger groups need help just as the smaller do and that if you are interested in solving issues they will embrace the solution; resulting in a reward that is generally larger and ongoing.

EXECUTIVE SUMMARY

Glenn J Stowers

Americas Mortgage Group:

1993-1995

Partner.

As an equal principal Partner, this organization was conceived by me and two other individuals. One was an Accountant and the other was a Mortgage Broker. We devised an interesting view of the then mortgage landscape which included sourcing mortgage funding in one location and transferring it to a larger economic area thereby developing a lower income lending program for limited credit borrowers. The company grew quickly and serviced MA and NY clients. We developed two separate offices and introduced a telemarketing program which led to a robust account base. The conclusion of the organization was triggered by changing banking regulations which made the core profit center less appealing.

Clyde's Grill and Bar:

1995-2015

Manager.

A project that started with me and two other individuals, one of which had been involved in the Mortgage Group. We naively entered the restaurant business under the misconception that if you build it they will come. We quickly found that the landscape was less than inviting as we had a competitive audience that included large national and entrenched local establishments. The timing was not good but we developed a no-quit attitude and ultimately won over the clientele. One partner was dismissed after the initial 18 months which represented a difficult negotiation and has left a strong impression on my management style.

Ultimately the restaurant became one of the entrenched local establishments that still stands and services the community today. I am often approached by the original staff members and told that it was one of the more powerful and enriching times to their lives. I echo that comment.

Intercept Boat Company:

1993-2019

Crew/ Board member.

As a mechanical individual I surrounded myself with individuals who were interested in all things mechanical. Through one of these relationships a desire to develop a stronger faster sea going vehicle (Boat) was born. I was lucky to be invited to participate with a strong willed group of passionate people during this time. Due to this passion and after a lot of hard work we had conceived a workable strategy; this combined with the skill sets of each person involved created a stable and highly functioning prototype water vessel. We felt we had created an exciting and innovative approach to sea worthiness but lacked the testing education to verify our theories. Due to persistence and commitment to the cause we were granted an audience with the marine studies team at MIT. At the conclusion of testing it was established that what had been created was a craft with the lowest vertical acceleration rates in the world. This led to a variety of very interesting events which included getting involved with U.S. Naval Surface Warfare Center (NSWC) and being quantified as developing what would be deemed "The smoothest riding Boat in the world" along with many other classified result accolades. The Boat was intended for sea bound tactical insertion and extraction, Aerial deployment, and night mission delivery of assets. We worked with Navy Seal team 6 in Coronado CA and consulted with many branches of the US government including Navy, Coast Guard, Customs, and Law enforcement.

We were invited to and attended many tests and were one of the only private contractors to be granted use of the drag tanks and weather simulation annex in Carderock VA while working with NSWC. We

EXECUTIVE SUMMARY

Glenn J Stowers

were funded through Office of National Drug Control Policy (ONDCP), while demonstrating the vessel to military, law enforcement and riverine compliments throughout the country.

The vessel was/is used today in law enforcement protecting the harbors in NYC as well as Boston, as well as operating as deterrent vessels protecting American oil rigs in Nigeria, and is in development through a joint task force with Grumman and NASA to become an autonomous minesweeper.

Retail Environmental Technologies Corp:

2000-2010

Principal.

The name of the company was augmented to align better to my focus on retail store clientele. Retail Environmental Technologies Corp. ("RETEC") was focused entirely on national retail clients. The preferred profile of a client was small to mid-size box multi location national retail with 500 million in gross revenue and above. RETC provided national consulting, energy management with a strong physical presence providing self-performing service and maintenance to this same clientele.

Mechanical Energy Corporation:

2010-Present

Principal.

I refined the organization again into its current form under a new and more flexible name focused on general expansion to include local HVAC services as well as support for the robust clientele already enjoyed by the company. The new organization, Mechanical Energy Corporation superseded the Retail Environmental Technologies Corp but maintained the RETEC brand as a DBA. The RETEC team is lean and strong demonstrating the ability to maneuver quickly and use time proven methods to satisfy the most demanding of clients. We have secured such major clients as Apple, GAP, Old Navy, Victoria Secrets, H&M, Urban Outfitters, J. Jill, etc. We are recognized as a top vendor supplier by these organizations and are the top-rated vendor in our business sector year after year.

2017-Present

Gavel Public House

Consultant.

Participate in direction correction of overall business and advise managing members of strategic moves required to adhere to todays changing business environment. Assisted and advised regarding financials for day to day operations. Acted as general advisor on all process and procedures of the entity and participate in expansion plan to control seasonal sales deficiencies. All actions ultimately resulted in leveling sales lines and controlling spending, stabilizing the organization through best practice implementation.

Please feel free to contact me for any clarification or additional information as needed.

Public House

Franklin Village, Franklin, Ma

STARTERS

Bone-In or Boneless Wings

oven roasted wings or hand breaded tenders tossed in your choice of sauce, served with veggie sticks & bleu cheese dressing 12

Signature Sauces and Rubs

*buffalo *roasted garlic parmesan *sweet chili
*kung pao *honey bbq *teriyaki glaze *garlic
habañoero sriracha *salt n' vinegar *old bay spice
ragin cajun

note: additional charge for extra sauces

Poutine

golden fried tater tots topped with rich brown gravy, sharp Vermont cheddar cheese & chopped scallions 13

Buffalo Cauliflower

fresh cauliflower florets cooked till golden, tossed with our house-made buffalo sauce topped with cool buttermilk ranch, crumbled bleu cheese & chopped scallions 14

New Zealand Lamb Lollipops

grilled medium rare & served over our house-made mint chimichurri 15

Skillet Nachos

crispy tri colored tortilla chips topped with house-made queso, melted cheddar, sliced jalapeños, roasted corn salsa, guacamole, sour cream & chopped scallions 14
pork carnitas 4 buffalo chicken 4
roasted cauliflower 4 shrimp 5

Father Bill's Potstickers

Asian style pork dumplings, cooked till golden & served with sesame-ginger dipping sauce 12

Hummus Plate

fresh house made hummus, tabouli, cucumber-garlic tzatziki, & olive tapenade served with warm pita bread & veggie sticks 14

Steak and Cheese Rolls

grilled steak wrapped with a four cheese blend in a crispy wonton, fried till golden brown served with chipotle aioli & black beans salsa 14

Sweet Chili Calamari

lightly breaded, fried till crispy and served with cilantro cabbage, pineapple mango salsa & sweet chili sauce 15

Asian Lettuce Wraps

Thai peanut satay chicken served with fresh lettuce wraps, chilled Asian noodles, carrots, cucumbers, cabbage & trio of dipping sauces 14

Twin Crab Cakes

two pan seared house-made crab cakes served over roasted creamed corn, onions & peppers 15

Bacan Wrapped Scallops

fresh Chatham scallops wrapped in smoked bacon served with chipotle BBQ dipping sauce 14

SOUPS

New England Clam Chowder

thick, creamy Cape Cod style chowder loaded with fresh chopped clams, potatoes and fresh herbs
cup 5 bowl 7

Onion Soup Gratin

slow simmered sweet onions in rich beef stock with house baked croutons and melted Swiss cheese 7

Soup of The Day

ask your server 7

HAND CRAFTED SALADS

The House Salad

fresh mixed greens topped with chopped garden veggies, house baked croutons & your choice of dressing 12

Gavel Caesar

crisp romaine lettuce tossed with savory caesar dressing, Parmesan cheese & house baked croutons.
served in our one of a kind edible Parmesan cheese bowl 15

Roasted Beet & Goat Cheese

fresh mixed greens topped with oven roasted beets, crumbled goat cheese, crispy fried shallots & a balsamic drizzle 15

West Coast

crisp romaine lettuce topped with tomatoes, cucumbers, red onions, bacon & avocado served in a freshly fried tortilla bowl 14

Athenos Salad

crisp chopped romaine lettuce topped with cherry tomatoes, cucumbers, red onions, pepperoncinis, kalamata olives, feta cheese & creamy Greek dressing 14

Asian Noodle Salad

fresh mixed greens topped with Asian noodles, chopped garden veggies, crispy wonton strips & sesame ginger dressing 14

Harvest Salad

fresh baby spinach topped with cherry tomatoes, red onions, diced avocado, dried cranberries, walnuts, bleu cheese & apple-cider vinaigrette 14

Add to any salad

grilled chicken 4 buffalo chicken 4
roasted cauliflower 4 grilled steak tips 6
grilled shrimp 6 seared Cape Cod scallops 7

MEXICAN STREET TACOS

served on your choice of three warm tortillas or lettuce wraps with roasted corn salsa, cilantro slaw & zesty chipotle-lime aioli. red beans n' rice and grilled Mexican street corn on the side

Pork Carnitas

tender slow roasted pork marinated in garlic & jalapeños 18

I.P.A. Battered Haddock

fresh local haddock beer battered & cooked till golden 19

Carne Asada

tender skirt steak grilled with sea salt & lime juice 19

Santa Fe Shrimp

flash sauteed wild gulf shrimp with cajun spices 19

Short Rib

oven roasted short ribs 18

Cajun Salmon

grilled cajun salmon with mango salsa served with jasmine rice 18

ENTREES

Mac n' Cheese

tender cavatappi pasta tossed with our three cheese sauce, baked till bubbly with cheddar cheese & toasted bread crumbs 15

buffalo chicken 3 bbq pulled pork 3 ground beef & bacon 3

SoCal Rice Bowl

a huge bowl of our Spanish red beans n' rice topped with marinated cajun chicken, roasted corn salsa, grilled jalapeños, cheddar cheese, guacamole & chipotle aioli served with three warm tortillas 18

Chef Luis's Chipotle BBQ Ribs

slow oven roasted marinated pork ribs served with french fries and cole slaw 19

Chicken Florentine

baked with a creamy garlic sauce served over sauteed spinach, cherry tomatoes & served with your choice of two sides 18

Gavel Steak Tips

our house marinated black angus sirloin tips, grilled to your liking served with your choice of two sides 20

Seafood Mac N' Cheese

your choice of fresh Maine lobster meat or roasted garlic shrimp with tender cavatappi pasta, tossed in our creamy three cheese sauce with baby spinach, diced tomato & fresh mozzarella finished with a balsamic glaze drizzle 24

Cottage Pub Pie

lean ground sirloin, simmered in stout spiked gravy with celery, carrots, onions & corn. topped with golden mashed potato crust & cheddar cheese 24

Grilled Stir Fry

your choice of steak or chicken sauteed in a savory teriyaki sauce with peppers & onions served over jasmine rice with your choice of one side 20

Fish & Chips

I.P.A. battered local haddock cooked till golden served over a bed of fries with cole slaw & tartar sauce 18

Gavel Turkey Tips

bourbon marinated turkey tips grilled to perfection & served with your choice of two sides 18

Bourbon Roasted Scallops

fresh Chatham scallops oven roasted in a cast iron skillet with fire roasted peppers, onions & our signature bourbon sauce served with your choice of two sides 22

Little Neck Linguine

little neck clams sauteed in garlic butter, white wine, fresh scallions, crushed red pepper & Parmesan cheese served over linguine 20

Balsamic Roasted Salmon

balsamic & garlic marinated salmon filet oven roasted and topped with fresh heirloom tomato-basil salad, served with your choice of two sides 20

SANDWICHES & WRAPS

all sandwiches served with your choice of one side

Steak Tip Sandwich

shaved steak with peppers, onions & mushrooms topped with American cheese served on a toasted sub roll 14

Caprese Sandwich

grilled chicken served on Texas toast with fresh mozzarella, sliced tomato, herbed mayo & drizzled with a balsamic glaze 14

Pastrami Reuben

shaved angus pastrami grilled on thick marble rye with Swiss cheese, sauerkraut & thousand island sauce 14

Patty Melt

our prime steak burger on thick Texas toast with sharp Vermont cheddar & bacon-onion marmalade 14

Asian Noodle Wrap

teriyaki grilled chicken, chilled Asian noodles, cucumbers & mixed greens wrapped in a flour tortilla with sesame ginger sauce 14

Chicken Ceasar Wrap

your choice of grilled or crispy chicken wrapped in a flour tortilla with romaine lettuce, caesar dressing, Parmesan cheese & croutons 14

Turkey Club

slow roasted shaved turkey served on texas toast with herbed mayo, lettuce, tomato, & smoked bacon 14

Alert your server to any allergies or dietary needs.

BURGERS

8oz prime steak burgers grilled to your liking served on a toasted bun with your choice of a side. all can be substituted with turkey or veggie burger

The House Burger

Vermont sharp cheddar, applewood smoked bacon & our zesty chipotle campfire sauce 14

Backyard Burger

melted American cheese, lettuce, tomato, red onion & house made spicy pickle 14

Chimichurri Burger

white cheddar cheese, roasted onion, peppers, and mint chimichurri sauce 14

Fire and Ice Burger

bleu cheese, applewood smoked bacon & garlic habanero sriracha sauce 14

Crab Rangoon Burger

a blend of cream cheese & crab meat finished with a sweet chili sauce 15

GRILLED PUB PIZZA

Tre Formaggi

savory san marazano tomato sauce with three cheese blend 14
pepperoni 2 grilled chicken 4
steak tips 4

Chicken Bacon Ranch

grilled chicken, crumbled applewood smoked bacon, buttermilk ranch & chopped scallions 14

C.B.A

homemade alfredo sauce topped with cheese, oven roasted chicken & fresh broccoli 15

Crab Rangoon

savory blend of cream cheese, crab meat, chopped chives & cheddar-mozzarella cheese blend topped with sweet chili sauce 15

SIGNATURE SIDES

*tater tots

*french fries

*onion rings

*sweet potato fries

*steamed broccoli

*cole slaw

*red beans n' rice

*adobo roasted

cauliflower

*garden salad

*caesar salad

*veg of the day

*yukon whipped potatoes

*Jasmine rice



CERTIFICATE OF COMPLIANCE WITH STATE LAWS

Pursuant to M.G.L Chapter 62C, Sec 49A, and M.G.L. Ch. 151A, Section 19A, the undersigned acting on behalf on the License Holder, certifies under the penalty of perjury that, to the best of the undersign's knowledge and belief, the License Holder is in compliance with all laws of the Commonwealth of Massachusetts relating to taxes, reporting of employees and contractors, and withholding and remitting child support*.

P.H. Franklin, Inc. [Signature]
** Signature of Individual or Corporate License Holder (Mandatory)

*** License Holder's Social Security Number/or Federal Identification Number

By: [Signature] Date: 10-8-20
Corporate Officer
(Mandatory, if applicable)

*The provision in the Attestation of relating to child support applies only when the License Holder is an individual.

**Approval of or a renewal of a license will not be granted unless this certification clause is signed by the applicant. For all corporations, a certified copy of the vote of the Board of Directors must be provided.

*** Your social security number will be furnished to the Massachusetts Department of Revenue to determine whether you have met tax filing or tax payment obligations. Providers who fail to correct their non-filing or delinquency will not have a license or other agreement issued, renewed or extended. This request is made under the authority of Massachusetts General Laws, Chapter 62C, section 49A.



The Commonwealth of Massachusetts
 Department of Industrial Accidents
 1 Congress Street, Suite 100
 Boston, MA 02114-2017
 www.mass.gov/dia

Workers' Compensation Insurance Affidavit: General Businesses.
 TO BE FILED WITH THE PERMITTING AUTHORITY.

Applicant Information

Please Print Legibly

Business/Organization Name: PH Franklin Inc

Address: 153 Washington St

City/State/Zip: East Walpole Ma 02032

Phone #: _____

<p>Are you an employer? Check the appropriate box:</p> <p>1. <input checked="" type="checkbox"/> I am a employer with <u>1</u> employees (full and/ or part-time).*</p> <p>2. <input type="checkbox"/> I am a sole proprietor or partnership and have no employees working for me in any capacity. [No workers' comp. insurance required]</p> <p>3. <input type="checkbox"/> We are a corporation and its officers have exercised their right of exemption per c. 152, §1(4), and we have no employees. [No workers' comp. insurance required]**</p> <p>4. <input type="checkbox"/> We are a non-profit organization, staffed by volunteers, with no employees. [No workers' comp. insurance req.]</p>	<p>Business Type (required):</p> <p>5. <input type="checkbox"/> Retail</p> <p>6. <input checked="" type="checkbox"/> Restaurant/Bar/Eating Establishment</p> <p>7. <input type="checkbox"/> Office and/or Sales (incl. real estate, auto, etc.)</p> <p>8. <input type="checkbox"/> Non-profit</p> <p>9. <input type="checkbox"/> Entertainment</p> <p>10. <input type="checkbox"/> Manufacturing</p> <p>11. <input type="checkbox"/> Health Care</p> <p>12. <input type="checkbox"/> Other _____</p>
---	---

*Any applicant that checks box #1 must also fill out the section below showing their workers' compensation policy information.

**If the corporate officers have exempted themselves, but the corporation has other employees, a workers' compensation policy is required and such an organization should check box #1.

I am an employer that is providing workers' compensation insurance for my employees. Below is the policy information.

Insurance Company Name: General Casualty Insurance company

Insurer's Address: 1 General Drive

City/State/Zip: _____

Policy # or Self-ins. Lic. # _____

Expiration Date: 12/07/2021

Attach a copy of the workers' compensation policy declaration page (showing the policy number and expiration date).

Failure to secure coverage as required under Section 25A of MGL c. 152 can lead to the imposition of criminal penalties of a fine up to \$1,500.00 and/or one-year imprisonment, as well as civil penalties in the form of a STOP WORK ORDER and a fine of up to \$250.00 a day against the violator. Be advised that a copy of this statement may be forwarded to the Office of Investigations of the DIA for insurance coverage verification.

I do hereby certify, under the pains and penalties of perjury that the information provided above is true and correct.

Signature: _____

Date: 12/9/20

Phone #: 617-908-4276

Official use only. Do not write in this area, to be completed by city or town official.

City or Town: _____ Permit/License # _____

Issuing Authority (circle one):

1. Board of Health 2. Building Department 3. City/Town Clerk 4. Licensing Board 5. Selectmen's Office
 6. Other _____

Contact Person: _____ Phone #: _____



CERTIFICATE OF LIABILITY INSURANCE

DATE (MM/DD/YYYY)
12/09/2020

THIS CERTIFICATE IS ISSUED AS A MATTER OF INFORMATION ONLY AND CONFERS NO RIGHTS UPON THE CERTIFICATE HOLDER. THIS CERTIFICATE DOES NOT AFFIRMATIVELY OR NEGATIVELY AMEND, EXTEND OR ALTER THE COVERAGE AFFORDED BY THE POLICIES BELOW. THIS CERTIFICATE OF INSURANCE DOES NOT CONSTITUTE A CONTRACT BETWEEN THE ISSUING INSURER(S), AUTHORIZED REPRESENTATIVE OR PRODUCER, AND THE CERTIFICATE HOLDER.

IMPORTANT: If the certificate holder is an ADDITIONAL INSURED, the policy(ies) must have ADDITIONAL INSURED provisions or be endorsed. If SUBROGATION IS WAIVED, subject to the terms and conditions of the policy, certain policies may require an endorsement. A statement on this certificate does not confer rights to the certificate holder in lieu of such endorsement(s).

PRODUCER Northwood Ins. Agency, Inc. P.O. Box 187 Northborough, MA 01532	CONTACT NAME: Matt Paharik	
	PHONE (A/C, No, Ext):	
E-MAIL ADDRESS:		
INSURER(S) AFFORDING COVERAGE		NAIC #
INSURER A: General Casualty Insurance Co.		
INSURER B:		
INSURER C:		
INSURER D:		
INSURER E:		
INSURER F:		

COVERAGES **CERTIFICATE NUMBER:** **REVISION NUMBER:**

THIS IS TO CERTIFY THAT THE POLICIES OF INSURANCE LISTED BELOW HAVE BEEN ISSUED TO THE INSURED NAMED ABOVE FOR THE POLICY PERIOD INDICATED. NOTWITHSTANDING ANY REQUIREMENT, TERM OR CONDITION OF ANY CONTRACT OR OTHER DOCUMENT WITH RESPECT TO WHICH THIS CERTIFICATE MAY BE ISSUED OR MAY PERTAIN, THE INSURANCE AFFORDED BY THE POLICIES DESCRIBED HEREIN IS SUBJECT TO ALL THE TERMS, EXCLUSIONS AND CONDITIONS OF SUCH POLICIES. LIMITS SHOWN MAY HAVE BEEN REDUCED BY PAID CLAIMS.

INSR LTR	TYPE OF INSURANCE	ADDL SUBR INSD WVD	POLICY NUMBER	POLICY EFF (MM/DD/YYYY)	POLICY EXP (MM/DD/YYYY)	LIMITS
A	<input checked="" type="checkbox"/> COMMERCIAL GENERAL LIABILITY <input type="checkbox"/> CLAIMS-MADE <input checked="" type="checkbox"/> OCCUR Liquor Liability GEN'L AGGREGATE LIMIT APPLIES PER. <input checked="" type="checkbox"/> POLICY <input type="checkbox"/> PRO JECT <input type="checkbox"/> LOC OTHER:		BBP00017300 \$1 MILL/ \$2MILL	12/07/2020 12/07/2020	12/07/2021 12/07/2021	EACH OCCURRENCE \$ 1,000,000 DAMAGE TO RENTED PREMISES (Ea occurrence) \$ 100,000 MED EXP (Any one person) \$ 10,000 PERSONAL & ADV INJURY \$ 2,000,000 GENERAL AGGREGATE \$ 2,000,000 PRODUCTS - COMP/OP AGG \$ 2,000,000 \$
	AUTOMOBILE LIABILITY <input type="checkbox"/> ANY AUTO OWNED AUTOS ONLY <input type="checkbox"/> HIRED AUTOS ONLY <input type="checkbox"/> SCHEDULED AUTOS <input type="checkbox"/> NON-OWNED AUTOS ONLY					COMBINED SINGLE LIMIT (Ea accident) \$ BODILY INJURY (Per person) \$ BODILY INJURY (Per accident) \$ PROPERTY DAMAGE (Per accident) \$ \$
A	<input checked="" type="checkbox"/> UMBRELLA LIAB <input type="checkbox"/> EXCESS LIAB DED RETENTION \$		BUM0008679	12/07/2020	12/07/2021	EACH OCCURRENCE \$ 2,000,000 AGGREGATE \$ 2,000,000 \$
A	WORKERS COMPENSATION AND EMPLOYERS' LIABILITY ANY PROPRIETOR/PARTNER/EXECUTIVE OFFICER/MEMBER EXCLUDED? (Mandatory in NH) If yes, describe under DESCRIPTION OF OPERATIONS below	<input type="checkbox"/> N <input checked="" type="checkbox"/> Y	BWC00017301	12/07/2020	12/07/2021	<input checked="" type="checkbox"/> PER STATUTE <input type="checkbox"/> OTH-ER E.L. EACH ACCIDENT \$ 500,000 E.L. DISEASE - EA EMPLOYEE \$ 500,000 E.L. DISEASE - POLICY LIMIT \$ 500,000

DESCRIPTION OF OPERATIONS / LOCATIONS / VEHICLES (ACORD 101, Additional Remarks Schedule, may be attached if more space is required)
Liquor Liability Coverage: \$1,000,000 Common Cause - \$2,000,000 Aggregate
Premises: The Public House - 280 Franklin Village Drive, Franklin, MA 02038

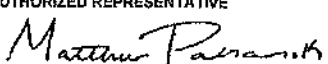
CERTIFICATE HOLDER TOWNFR1 Town of Franklin 355 East Central Street Franklin, MA 02038	CANCELLATION SHOULD ANY OF THE ABOVE DESCRIBED POLICIES BE CANCELLED BEFORE THE EXPIRATION DATE THEREOF, NOTICE WILL BE DELIVERED IN ACCORDANCE WITH THE POLICY PROVISIONS. AUTHORIZED REPRESENTATIVE 
--	--



**COMMUNITY
NEWSPAPER
COMPANY**

GateHouse Media New England

Community Newspaper Co. – Legal Advertising Proof
15 Pacella Park Drive, Randolph, MA 02368 1800-624-7355
phone | 781-961-3045 fax

Order Number: CN13934213

Salesperson: Jeanie Malone

Christopher Timson

Title:	Milford Daily News Legals	Class:	
Start date:	1/6/2021 1/6/2021	Stop date:	
Insertions:	1	#Lines:	61
ag			
Price:	\$100.04		

Payment Information

Receipt#
Pmt. Type:
CC. Number: CC. Exp.:
Invoice Total: \$100.04

FRANKLIN/ Public Hearing 1/20/21

**LEGAL NOTICE
NOTICE OF PUBLIC
HEARING
FRANKLIN, MA**

**New Section 12 All Alcoholic Beverages License - PH
Franklin d/b/a Public House**

The Franklin Town Council will hold a Public Hearing on an application by PH Franklin d/b/a Public House, located at 480 Franklin Village Drive, Franklin, MA for a New All Alcoholic Beverages Restaurant License. The hearing will be held on

Wednesday, January 20th, 2021 at 7:10 PM. This hearing will provide an open forum for the discussion. This meeting will be held remotely via the "ZOOM" platform. Residents can visit the Town Website (Franklinma.gov) and click on the Town Calendar for up to date information on how to access the meeting. If you have any questions, please call the Town Administrator's Office at (508) 520-4949.

Submitted by,
Chrissy Whelton
Licensing Administrator