

CONSTRUCTION PHASE

- INSPECTION AND MAINTENANCE SCHEDULE:

- ### OPERATION AND MAINTENANCE SCHEDULE

CONSTRUCTION PHASE:

1. THE EROSION CONTROL BARRIERS SHALL BE INSPECTED ON A WEEKLY BASIS AND AFTER ALL STORM EVENTS.
2. ONCE THE PARKING LOT HAS BEEN PAVED DAILY INSPECTIONS SHALL BE CONDUCTED TO DETERMINE THE NECESSITY TO REMOVE ANY ACCUMULATED SEDIMENT. THE REMOVAL OF THE ACCUMULATED SEDIMENT SHALL BE COMPLETED ON THE DAY THE DETERMINATION IS MADE.
3. SILT SAKS SHALL BE INSTALLED AT ALL CATCH BASINS, STORMCEPTOR AND CDS UNITS (WITH GRATES). SILT SAKS, ONCE INSTALLED SHALL BE INSPECTED ON A WEEKLY BASIS AND CLEANED AS NECESSARY.
4. THE WATER QUALITY UNITS SHALL BE INSPECTED ON A WEEKLY BASIS AND CLEANED WHEN THE SEDIMENT DEPTH REACHES 8"
5. THE PONDS SHALL BE INSPECTED AFTER EACH STORM EVENT AND CLEANED WHEN 2" OF SEDIMENT HAS ACCUMULATED AT THE INLET. ANY TRASH OR CONSTRUCTION DEBRIS SHALL BE IMMEDIATELY REMOVED.

ADDITIONAL EROSION CONTROLS MAY BE
REQUIRED DEPENDING ON ACTUAL FIELD
CONDITIONS DURING CONSTRUCTION.
BEGIN EROSION CONTROL
AND LIMIT OF WORK

LONG TERM:

1. THE PARKING LOT SHALL BE SWEEPED TWICE PER YEAR WITH ONE BEING AFTER THE LAST WINTER SANDING.
2. THE WATER QUALITY UNITS SHALL BE INSPECTED 4 TIMES PER YEAR AND SEDIMENT REMOVED WHEN THE DEPTH REACHES 8 INCHES.
3. THE PONDS SHALL BE INSPECTED AND PREVENTIVE MAINTENANCE PERFORMED TWICE PER YEAR. THE PONDS SHALL BE INSPECTED AFTER EVERY STORM EVENT EXCEEDING 1 INCH OF RAINFALL FOR THE FIRST 3 MONTHS AND THEN TWICE PER YEAR THEREAFTER AND WHEN THERE ARE DISCHARGES THROUGH THE HIGH OUTLET.
4. DURING INSPECTIONS OF STORM-WATER FACILITIES ANY TRASH OR DEBRIS DISCOVERED SHALL BE IMMEDIATELY REMOVED.

COMPENSATORY—
FLOOD STORAGE
AREA - 406 SQ. FT.

1. COMPOST SOCK SHALL BE INSTALLED PRIOR TO TREE CLEARING OR SITE WORK COMMENCING.
2. ENTRY MAT TO BE INSTALLED.
3. COMPOST SOCK TO REMAIN IN CONTACT WITH THE EARTH. REPAIR OR RESET AS NECESSARY.
4. REFER TO CONSTRUCTION SEQUENCE FOR SLOPE GREATER THAN 3' HORIZONTAL TO 1' VERTICAL.
5. WATER QUALITY UNITS, CATCH BASINS, UNDERGROUND PONDS AND PARKING AREA TO BE CLEANED ONCE CONSTRUCTION IS COMPLETED.
6. ALL SEDIMENT COLLECTED DURING THE CONSTRUCTION PHASE OR POST CONSTRUCTION PHASE SHALL BE DISPOSED OF TO AN APPROVED LOCATION.
7. AFTER ALL DISTURBED AREAS HAVE BEEN STABILIZED THE EROSION CONTROL MEASURES SHALL BE REMOVED.
8. DAMAGED OR DETERIORATED EROSION CONTROL MEASURES SHALL BE REPAIRED OR REPLACED IMMEDIATELY AFTER THEY HAVE BEEN IDENTIFIED.
9. THE CONTRACTOR SHALL BE RESPONSIBLE FOR ALL INSPECTIONS.
10. DUST CONTROL WILL BE BY SPRAYING WATER AS NECESSARY. THE USE OF OILS, PETROLEUM PRODUCTS OR TOXIC LIQUIDS FOR DUST CONTROL IS PROHIBITED.

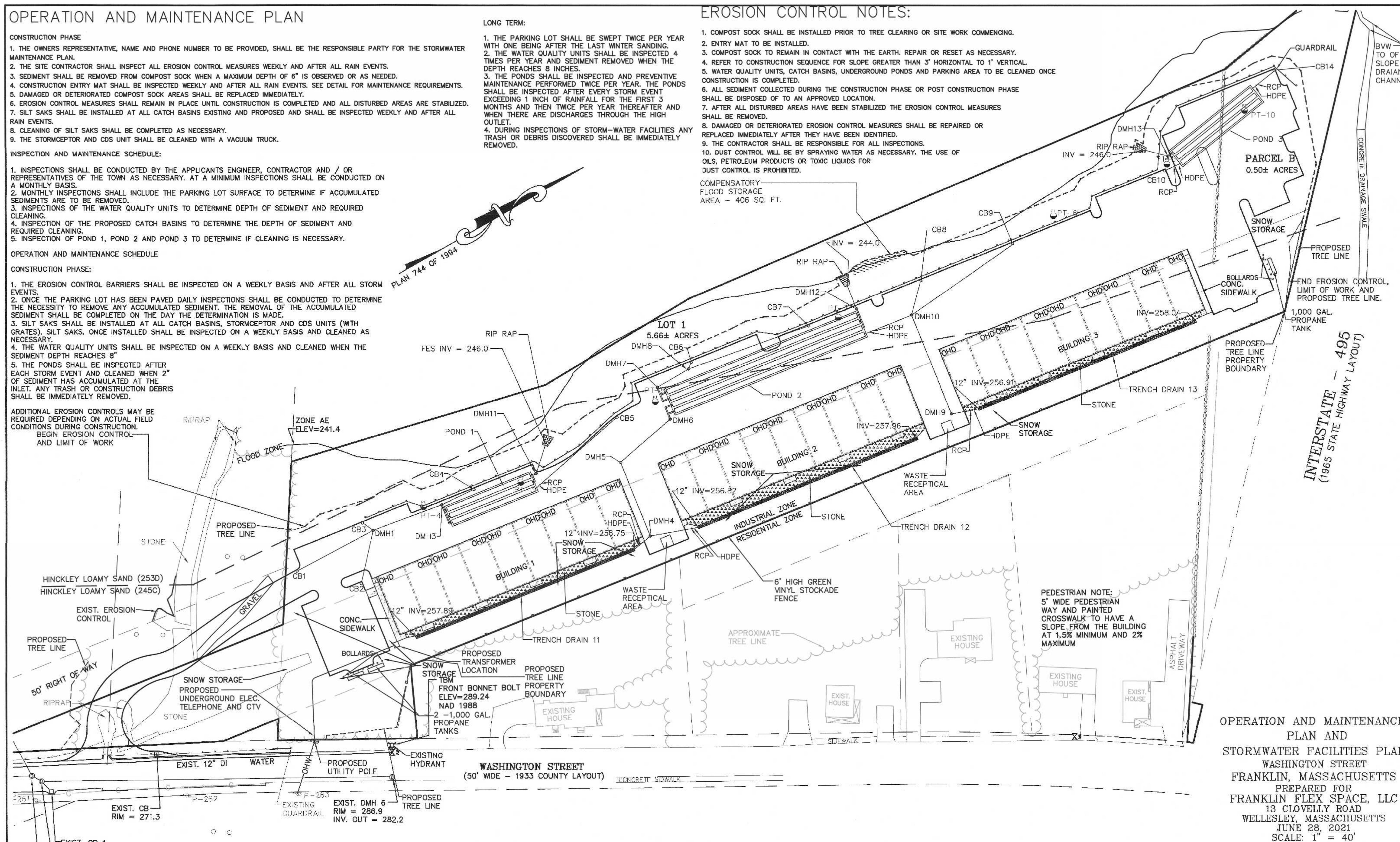

OPERATION AND MAINTENANCE
PLAN AND
STORMWATER FACILITIES PLAN
WASHINGTON STREET
FRANKLIN, MASSACHUSETTS
PREPARED FOR
FRANKLIN FLEX SPACE, LLC
13 CLOVELLY ROAD
WELLESLEY, MASSACHUSETTS
JUNE 28, 2021
SCALE: 1" = 40'

**SITE PLAN APPROVAL
REQUIRED
FRANKLIN PLANNING BOARD**

DATE _____

GRAPHIC SCALE

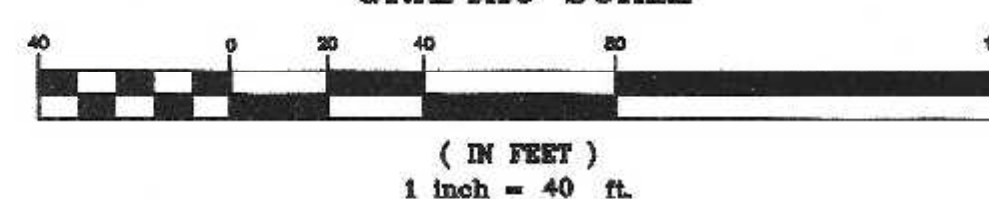

1	11/22/21	REVIEW COMMENTS - SITE LAYOUT	RRG
NO.	DATE	DESCRIPTION	BY

DATE		INT.
5/21	FIELD BY:	BL
BK#	FIELD BOOK	PG# 6
6/21	CALCS BY:	RRG
6/21	DESIGNED BY:	RRG
6/21	DRAWN BY:	COMP
6/21	CHECKED BY:	CAO

**UNITED
CONSULTANTS
INC.**
850 FRANKLIN STREET SUITE 11D
WRENTHAM, MASSACHUSETTS 02093
508-384-8580 FAX 508-384-8566

DATE	JUNE 28, 2021
SCALE	1" = 40'
PROJECT	UC1502
SHEET	1 of 1